

Plot Date: 4/21/2015 2:44:25 PM
 File Name: S:\JLDesign\T00419 - East Portland RFB Project\CAD\PLAN SHEETS\SHIT 12 STREET PLAN - NE 102ND AVE AT NE WYGANT ST\12_PLOT_SHT_12.dgn

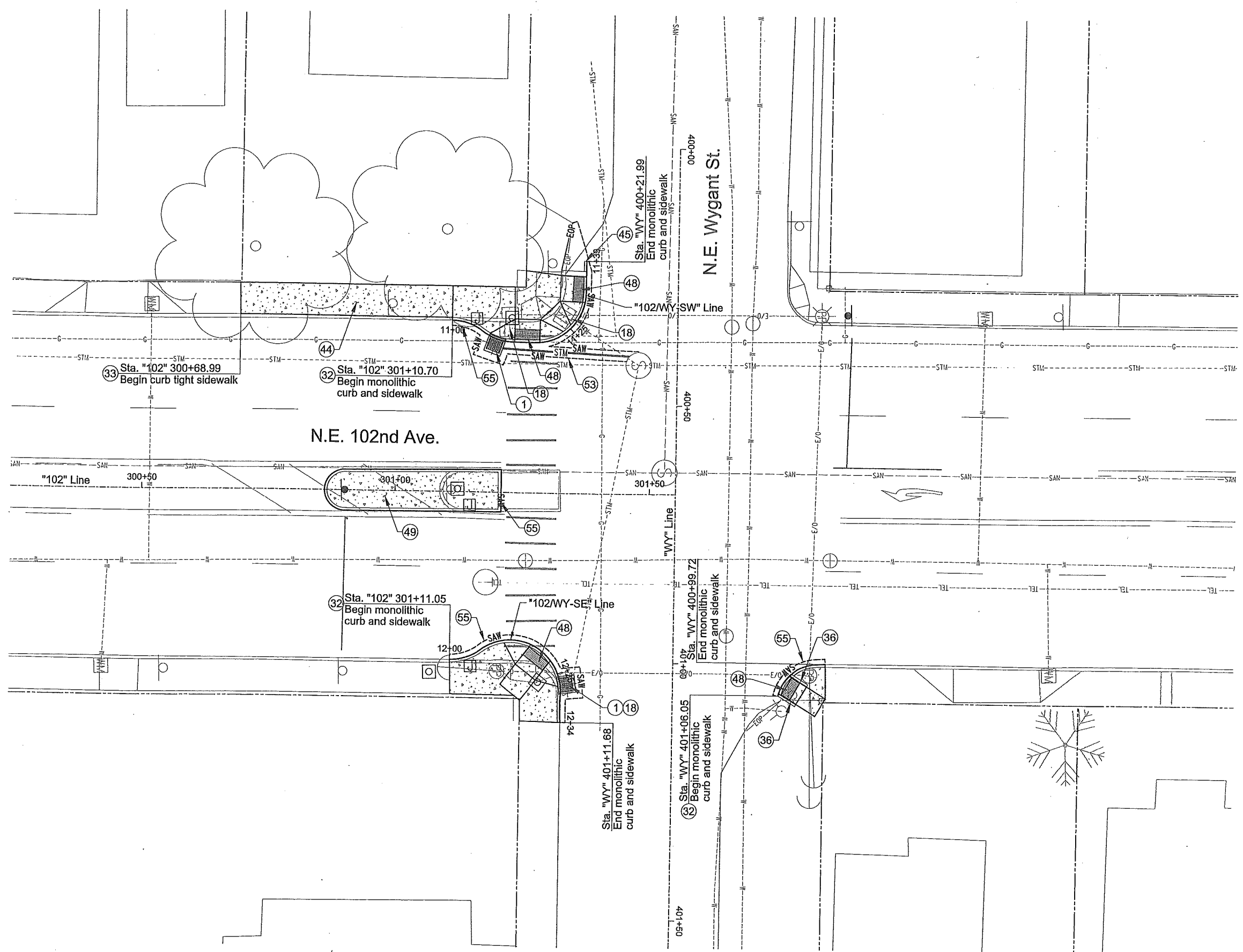

- Construction Notes**
- 1 Install inlet protection - 2. See Std. Drg. No. RD1010.
 - 18 Remove inlet - 3.
 - 32 Construct monolithic curb and sidewalk with 10" AC pavement repair. See Detail "A" on Sht. 2B.
 - 36 Construct Standard Curb. See Std. Drg. No. P-540.
 - 44 Construct concrete sidewalk. See Std. Drg. No. P-551.
 - 45 Construct curb ending. See Std. Drg. No. P-540.
 - 48 Construct monolithic sidewalk ramp. See Sht. 2F-4 and Std. Drg. No. RD755.
 - 49 Construct Type C mountable island, 6" exposure. See Std. Drg. No. RD705.
 - 53 Construct trench resurfacing. See Std. Drg. No. P-517.
 - 55 Construct 10" AC pavement repair. See Std. Drg. No. P-506.

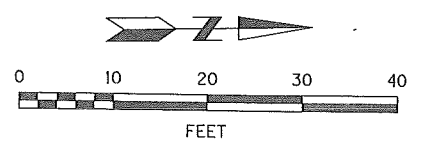

NO.	DATE	DESCRIPTION	APPD.

DESIGNED BY
L. Williams
 CAD BY
C. Shearer
 CHECKED BY
J. Joe

DATE APPROVED
April 2015
 DIV. ENGINEER
S. Townsen

REGISTERED PROFESSIONAL ENGINEER
 0215PE
Jim R. Joe
 JULY 15, 1981
 Expires 06/30/16

APPROVALS:
Bob Gailer
 SUPERVISING ENGINEER
 REG. PROF. ENGR. NO. 14956PE

Steve Townsen
 CITY ENGINEER
 REG. PROF. ENGR. NO. 51538PE

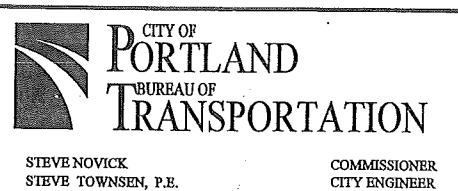

East Portland Rapid Flash Beacon Project
Street Plan
N.E. 102nd Ave.
at N.E. Wygant St.

1/4 SECTION
 2540, 2541
 2640, 2641
 PROJECT NO.
 T00419
 SHEET NO.
12