

C:\25697878 PGE Cont Env Svcs 2013\5000 Technical\RM 13.1\_13.5 FS\RM 13.5 RD\Appendix A-90a\City of Portland Set\F02 Exist.dwg User: Paul\_Flury Plotted: May 29, 2015 - 12:41pm Last Save: May 29, 2015 - 10:59am

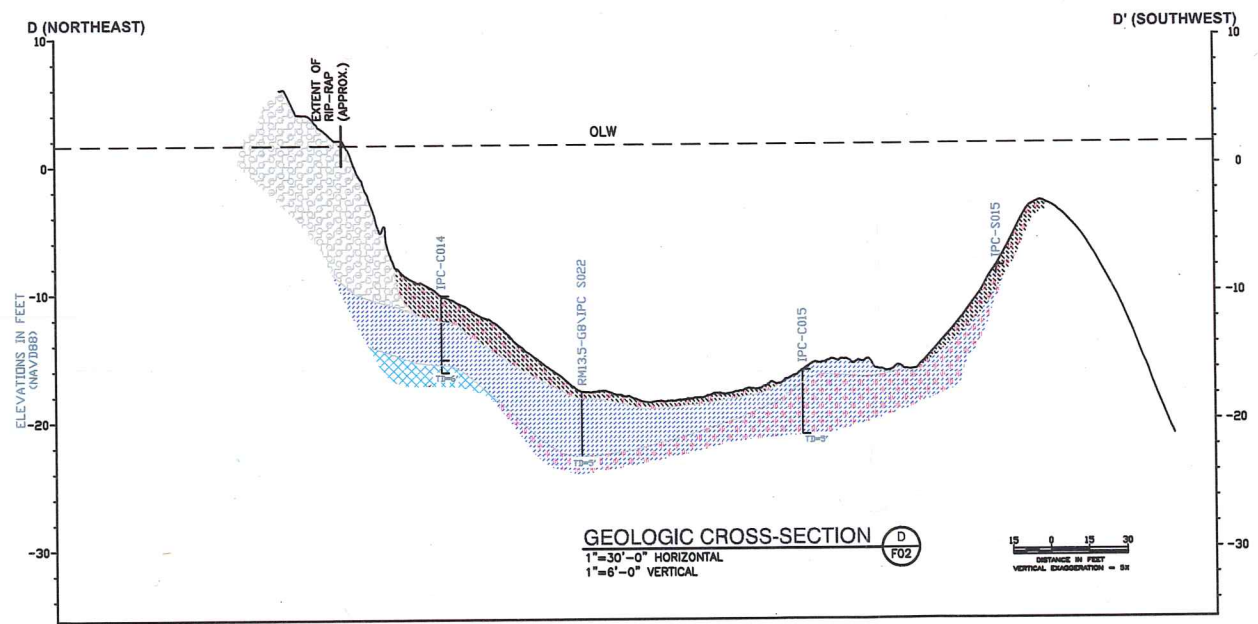
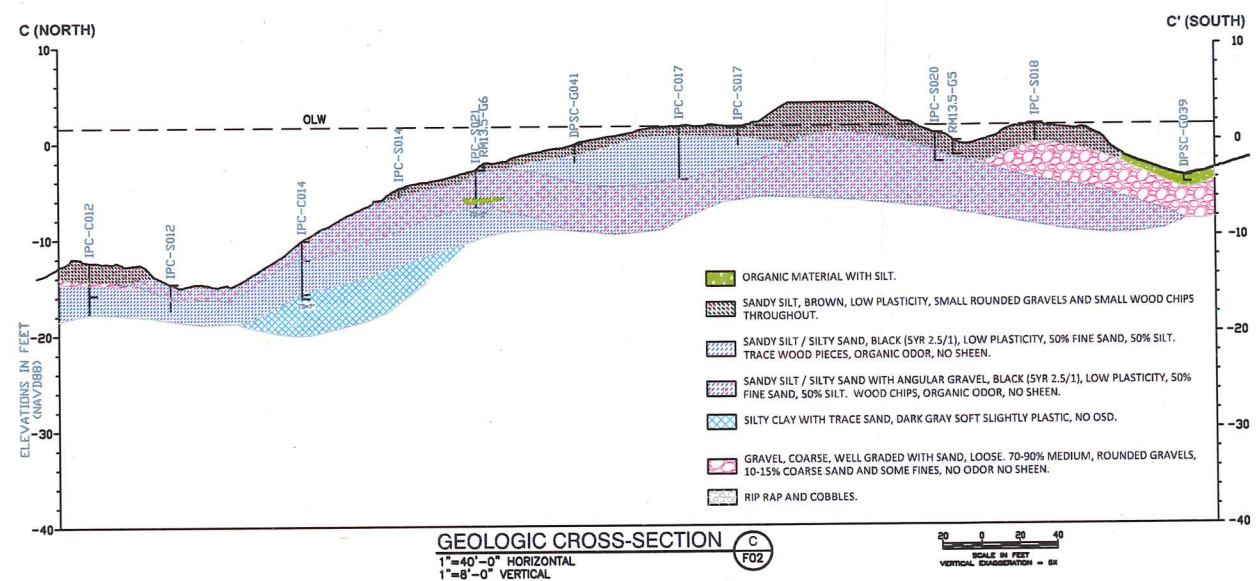
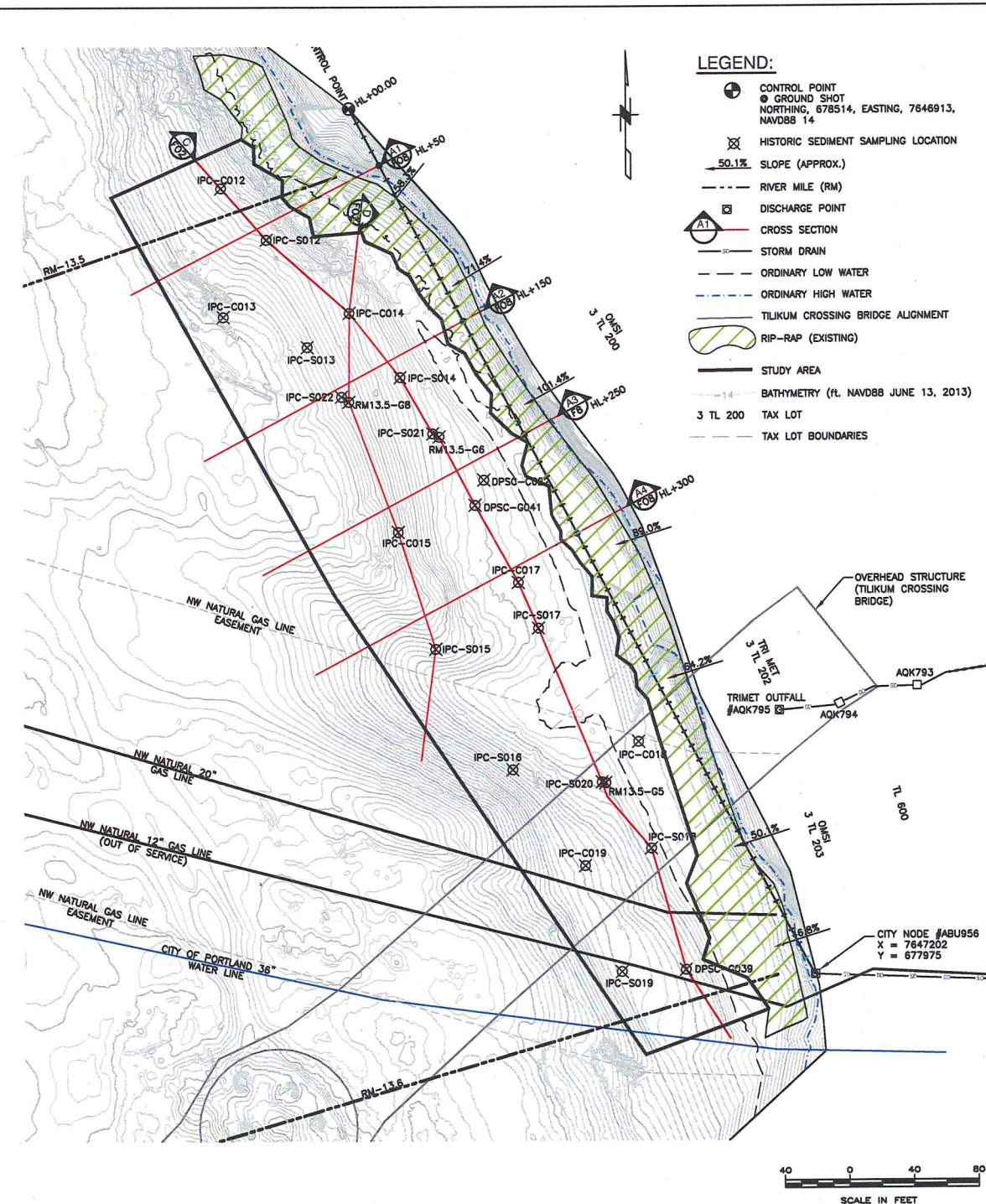

<b>PRELIMINARY NOT FOR CONSTRUCTION</b>		JOB No. 25698205	DESIGNED: HWN	PROJ. ENGINEER: HWN
		SCALE: AS NOTED	DRAWN BY: BJR	APPROVED BY: HWN
No.	DATE	BY	CHECKED BY: GB	DATE: MAY 29, 2015
REVISION				

**AECOM**  
 111 SW Columbia, Suite 1500  
 Portland, Oregon 97201-5814  
 (tel) 503-222-7200  
 (fax) 503-222-4292  
 www.aecom.com

**Portland General Electric**  
 Portland, Oregon

**RIVER MILE 13.5, 90% SEDIMENT CAP DESIGN**

**EXISTING CONDITIONS  
 SITE PLAN - SHEET 1**

DRAWING NUMBER: <b>F02</b>	
CAD FILE NUMBER:	
SHEET: 2 OF 11	REV: