



**City of Portland, Oregon**  
**Bureau of Development Services**  
**Land Use Services**

FROM CONCEPT TO CONSTRUCTION

Amanda Fritz, Commissioner  
Paul L. Scarlett, Director  
Phone: (503) 823-7300  
Fax: (503) 823-5630  
TTY: (503) 823-6868  
[www.portlandoregon.gov/bds](http://www.portlandoregon.gov/bds)

**Date:** February 11, 2014  
**To:** Interested Person  
**From:** Jennifer Kenny, Land Use Services  
503-823-7011 / [Jennifer.Kenny@portlandoregon.gov](mailto:Jennifer.Kenny@portlandoregon.gov)

## **NOTICE OF A TYPE I DECISION ON A PROPOSAL IN YOUR NEIGHBORHOOD**

The Bureau of Development Services has **approved** a proposal in your neighborhood. The reasons for the decision are included in the version located on the BDS website <http://www.portlandonline.com/bds/index.cfm?c=46429>. Click on the District Coalition then scroll to the relevant Neighborhood, and case number. If you disagree with the decision, you can appeal it to the Oregon Land Use Board of Appeals (LUBA) at 775 Summer St NE, Suite 330, Salem, OR 97301-1283. The phone number for LUBA is 1-503-373-1265. Information on how to appeal this decision is listed at the end of this notice.

### **CASE FILE NUMBER: LU 14-101848 HR - WALL BUMP-OUT**

#### **GENERAL INFORMATION**

**Applicant/Rep:** Ingrid E. Slezak  
1934 NE Hancock St / Portland, OR 97212

**Site Address:** 1934 NE HANCOCK ST

**Legal Description:** BLOCK 14 LOT 12 W 10' OF LOT 13, JOHN IRVINGS 1ST ADD  
**Tax Account No.:** R430304280  
**State ID No.:** 1N1E26DD 11700 **Quarter Section:** 2832

**Neighborhood:** Irvington, contact Dean Gisvold at 503-284-3885.  
**Business District:** North-Northeast Business Assoc, Joice Taylor at 503-445-1321.  
**District Coalition:** NE Coalition of Neighborhoods, Claire Adamsick at 503-388-9030.  
**Plan District:** Albina Community  
**Other Designations:** Irvington Historic District  
**Zoning:** R1a, a medium density multi-dwelling zone.  
**Case Type:** Historic Resource Review  
**Procedure:** Type I, an administrative decision with appeal to the Oregon Land Use Board of Appeals (LUBA).

#### **Proposal:**

The applicant seeks Historic Resource Review approval for a 20" bump-out on the west exterior wall to accommodate a zero clearance fireplace. The replacement siding will match the existing siding. Historic Resource Review is required for non-exempt exterior alterations within the historic district.

#### **Relevant Approval Criteria:**

In order to be approved, this proposal must comply with the approval criteria of Title 33. The relevant approval criteria are:

- 33.846.060.G Other Approval Criteria

#### **ANALYSIS**

**Site and Vicinity:** The site is a contributing property within the Irvington Historic District, built in 1901 in the Craftsman style with Victorian details.

Platted in the late Nineteenth Century, today's Irvington Historic District represents the first additions to Portland that employed restrictive covenants from the outset. These included the exclusion of most non-residential uses from the interior of the neighborhood, and where non-residential uses were allowed, such as the fire station and the telephone exchange, the buildings were purposely disguised to appear more residential in character. Other deed restrictions excluded minority groups, established uniform front setbacks, and required minimum expenditure on new buildings. The area developed generally from southwest to northeast and its growth was greatly influenced by the installation of streetcar lines that introduced an easy commuting option to downtown.

The contributing resources in Irvington range in design character from expressions of the late Victorian Era styles, especially Queen Anne, through the many Period Revival modes of the early decades of the Twentieth Century, to a few early modernist examples. There is also a wide diversity in the sizes of lots and houses. In terms of the streetscape, the numbered north-south avenues in Irvington vary dramatically in width, and they mostly form rather long block faces which the houses generally face. The named east-west street block faces are more consistent in length, almost all being traditional 200' Portland blocks. All are lined with mature street trees.

**Zoning:** The R5 single-dwelling zone is intended to preserve land for housing and to provide housing opportunities for individual households. The zone implements the comprehensive plan policies and designations for single-dwelling housing. Minimum lot size is 3,000 square feet, with minimum width and depth dimensions of 36 and 50 feet, respectively. Minimum densities are based on lot size and street configuration. Maximum densities are 1 lot per 5,000 square feet of site area.

The Historic Resource Protection overlay is comprised of Historic and Conservation Districts, as well as Historic and Conservation Landmarks and protects certain historic resources in the region and preserves significant parts of the region's heritage. The regulations implement Portland's Comprehensive Plan policies that address historic preservation. These policies recognize the role historic resources have in promoting the education and enjoyment of those living in and visiting the region. The regulations foster pride among the region's citizens in their city and its heritage. Historic preservation beautifies the city, promotes the city's economic health, and helps to preserve and enhance the value of historic properties.

**Land Use History:** City records indicate there are no prior land use reviews for this site.

**Agency Review:** None of the notified Bureaus has responded with issues or concerns.

**Neighborhood Review:** A "Notice of Proposal in Your Neighborhood" was mailed on January 16, 2014. Dean Gisvold wrote on behalf of the Irvington Community Association's Land Use Committee, stating no objections to the project.

## **ZONING CODE APPROVAL CRITERIA**

### **Chapter 33.846.060 - Historic Resource Review**

#### **Purpose of Historic Resource Review**

Historic Resource Review ensures the conservation and enhancement of the special characteristics of historic resources.

#### **Historic Resource Review Approval Criteria**

Requests for historic resource review will be approved if the review body finds the applicant has shown that all of the approval criteria have been met.

**Findings:** The site is within the Irvington Historic District and the proposal is for non-exempt treatment. Therefore Historic Resource Review approval is required.

The approval criteria are those listed in *33.846.060 G – Other Approval Criteria*.  
*Staff has considered all guidelines and addressed only those applicable to this proposal.*

**The approval criteria are:**

**1. Historic character.** The historic character of the property will be retained and preserved. Removal of historic materials or alteration of features and spaces that contribute to the property's historic significance will be avoided;

**7. Differentiate new from old.** New additions, exterior alterations, or related new construction will not destroy historic materials that characterize a property. New work will be differentiated from the old;

**Findings for 1 and 7:** The proposed alteration is for a minor enlargement on a secondary elevation and will not alter character-defining historic features of the house. Thus, the historic character of the property will be retained and preserved. *These guidelines are therefore met.*

**9. Preserve the form and integrity of historic resources.** New additions and adjacent or related new construction will be undertaken in such a manner that if removed in the future, the essential form and integrity of the historic resource and its environment would be unimpaired; and

**Findings:** Given the relatively small area of the bump-out, it could be removed and the exterior re-sided in order to restore the original architectural design. *This guideline is therefore met.*

**10. Hierarchy of compatibility.** Exterior alterations and additions will be designed to be compatible primarily with the original resource, secondarily with adjacent properties, and finally, if located within a Historic or Conservation District, with the rest of the district. Where practical, compatibility will be pursued on all three levels.

**Findings:** The proposed alteration will be sited in a relatively small area, on a secondary elevation, and does not compromise the character-defining features of the rest of the house. In terms of compatibility with the neighboring properties, the subject resource will retain its original setbacks, height, massing, materials, site coverage, and orientation to the street. Thus, there is no change to the existing compatibility with adjacent properties. Compatibility with the historic district is achieved by the inconspicuousness of this alteration. *This guideline is therefore met.*

## DEVELOPMENT STANDARDS

Unless specifically required in the approval criteria listed above, this proposal does not have to meet the development standards in order to be approved during this review process. The plans submitted for a building or zoning permit must demonstrate that all development standards of Title 33 can be met, or have received an Adjustment or Modification via a land use review prior to the approval of a building or zoning permit.

## CONCLUSIONS

The purpose of the Historic Resource Review process is to ensure that additions, new construction, and exterior alterations to historic resources do not compromise their ability to convey historic significance. This proposal meets the applicable Historic Resource Review criteria and therefore warrants approval.

## ADMINISTRATIVE DECISION

Approval of a 20” bump-out of approximately 31.3 SF alteration on the west exterior wall to accommodate a zero clearance fireplace in the Irvington Historic District, per the approved site plans, Exhibits C-1 through C-3, signed and dated February 4, 2014 subject to the following conditions:

- A. As part of the building permit application submittal, each of the 4 required site plans and any additional drawings must reflect the information and design approved by this land use review as indicated in Exhibits C.1-C.3. The sheets on which this information appears must be labeled, "Proposal and design as approved in Case File # LU 14-101848 HR."

**Staff Planner: Jennifer Kenny**

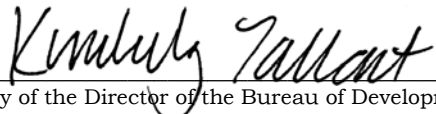
**Decision rendered by:**  **on February 4, 2014.**  
By authority of the Director of the Bureau of Development Services

**Decision mailed February 11, 2014.**

**Procedural Information.** The application for this land use review was submitted on January 7, 2014 and was determined to be complete on January 16, 2014.

*Zoning Code Section 33.700.080* states that Land Use Review applications are reviewed under the regulations in effect at the time the application was submitted, provided that the application is complete at the time of submittal, or complete within 180 days. Therefore this application was reviewed against the Zoning Code in effect on January 7, 2014.

*ORS 227.178* states the City must issue a final decision on Land Use Review applications within 120-days of the application being deemed complete. The 120-day review period may be waived or extended at the request of the applicant. In this case, the applicant did not waive or extend the 120-day review period. Unless further extended by the applicant, **the 120 days will expire on: May 17, 2014.**

**Some of the information contained in this report was provided by the applicant.**

As required by Section 33.800.060 of the Portland Zoning Code, the burden of proof is on the applicant to show that the approval criteria are met. The Bureau of Development Services has independently reviewed the information submitted by the applicant and has included this information only where the Bureau of Development Services has determined the information satisfactorily demonstrates compliance with the applicable approval criteria. This report is the decision of the Bureau of Development Services with input from other City and public agencies.

**Conditions of Approval.** If approved, this project may be subject to a number of specific conditions, listed above. Compliance with the applicable conditions of approval must be documented in all related permit applications. Plans and drawings submitted during the permitting process must illustrate how applicable conditions of approval are met. Any project elements that are specifically required by conditions of approval must be shown on the plans, and labeled as such.

These conditions of approval run with the land, unless modified by future land use reviews. As used in the conditions, the term “applicant” includes the applicant for this land use review, any person undertaking development pursuant to this land use review, the proprietor of the use or development approved by this land use review, and the current owner and future owners of the property subject to this land use review.

**This decision, and any conditions associated with it, is final.** It may be appealed to the Oregon Land Use Board of Appeals (LUBA), within 21 days of the date the decision is mailed, as specified in the Oregon Revised Statute (ORS) 197.830. Among other things, ORS 197.830 requires that a petitioner at LUBA must have submitted written testimony during

the comment period for this land use review. Contact LUBA at 775 Summer St NE Suite 330, Salem, OR 97301-1283 or phone 1-503-373-1265 for further information.

The file and all evidence on this case are available for your review by appointment only. Please call the Request Line at our office, 1900 SW Fourth Avenue, Suite 5000, phone 503-823-7617, to schedule an appointment. I can provide some information over the phone. Copies of all information in the file can be obtained for a fee equal to the cost of services. Additional information about the City of Portland, city bureaus, and a digital copy of the Portland Zoning Code is available on the internet at [www.portlandonline.com](http://www.portlandonline.com).

**Recording the final decision.**

If this Land Use Review is approved, the final decision must be recorded with the Multnomah County Recorder. A building or zoning permit will be issued only after the final decision is recorded. **The final decision may be recorded on or after February 12, 2014.**

The applicant, builder, or a representative may record the final decision as follows:

- By Mail: Send the two recording sheets (sent in separate mailing) and the final Land Use Review decision with a check made payable to the Multnomah County Recorder to: Multnomah County Recorder, P.O. Box 5007, Portland OR 97208. The recording fee is identified on the recording sheet. Please include a self-addressed, stamped envelope.
- In Person: Bring the two recording sheets (sent in separate mailing) and the final Land Use Review decision with a check made payable to the Multnomah County Recorder to the County Recorder's office located at 501 SE Hawthorne Boulevard, #158, Portland OR 97214. The recording fee is identified on the recording sheet.

For further information on recording, please call the County Recorder at 503-988-3034. For further information on your recording documents please call the Bureau of Development Services Land Use Services Division at 503-823-0625.

**Expiration of this approval.** An approval expires three years from the date the final decision is rendered unless a building permit has been issued, or the approved activity has begun.

Where a site has received approval for multiple developments, and a building permit is not issued for all of the approved development within three years of the date of the final decision, a new land use review will be required before a permit will be issued for the remaining development, subject to the Zoning Code in effect at that time.

**Applying for your permits.** A building permit, occupancy permit, or development permit may be required before carrying out an approved project. At the time they apply for a permit, permittees must demonstrate compliance with:

- All conditions imposed herein;
- All applicable development standards, unless specifically exempted as part of this land use review;
- All requirements of the building code; and
- All provisions of the Municipal Code for the City of Portland, and all other applicable ordinances, provisions and regulations of the City.

**EXHIBITS**

NOT ATTACHED UNLESS INDICATED

- A. Applicant's Statement
- B. Zoning Map (attached)
- C. Plans/Drawings:
  1. Site Plan (attached)
  2. Photograph of alteration (attached)
  3. Details
- D. Notification information:
  1. Mailing list

2. Mailed notice
- E. Agency Responses: No responses were received.
- F. Correspondence: Dean Gisvold on behalf of the Irvington Community Association's Land Use Committee, no objections.
- G. Other:
  1. Original LU Application

**The Bureau of Development Services is committed to providing equal access to information and hearings. Please notify us no less than five business days prior to the event if you need special accommodations. Call 503-823-7300 (TTY 503-823-6868).**

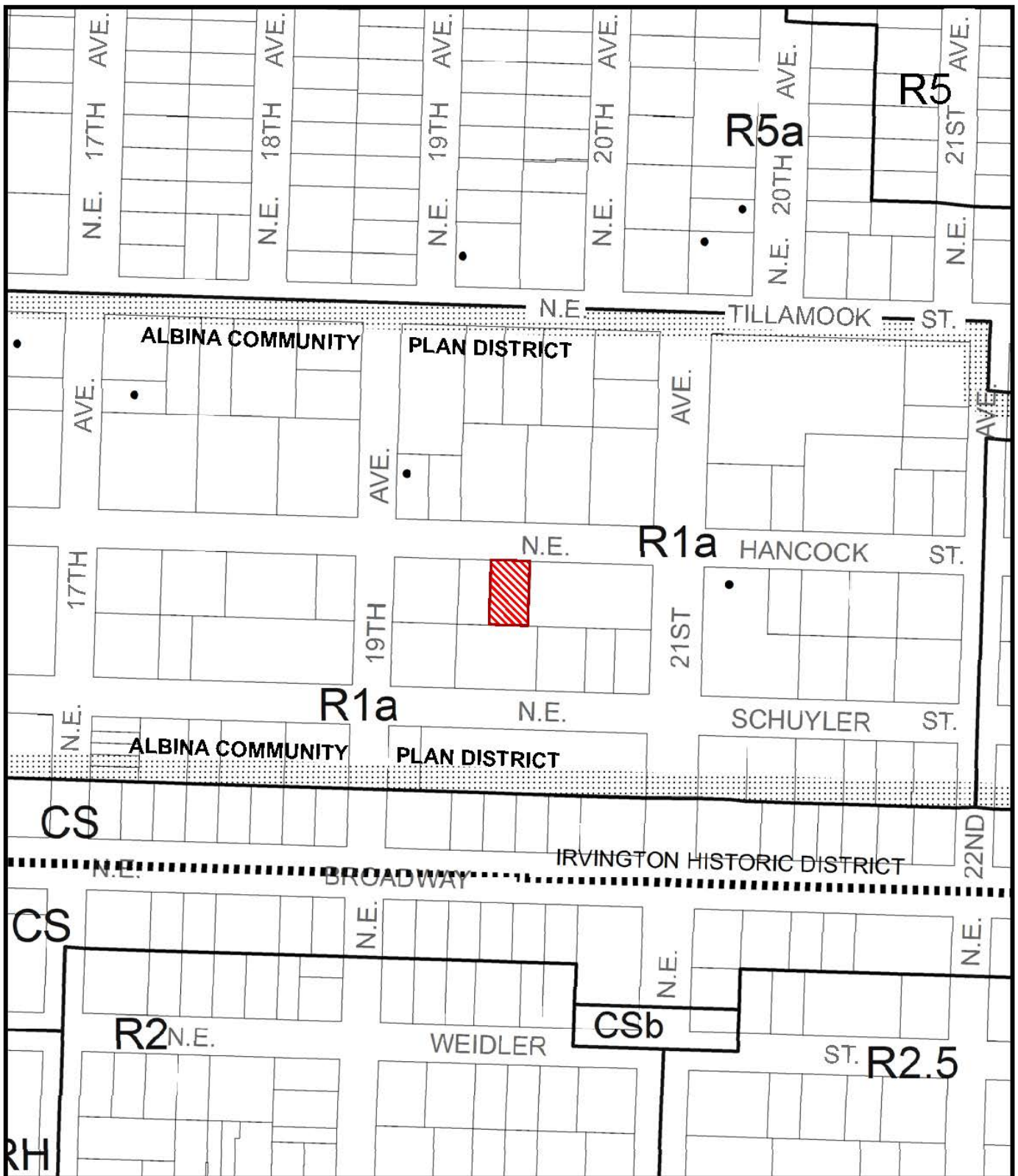

# ZONING



Site



Historic Landmark

This site lies within the:  
**IRVINGTON HISTORIC DISTRICT**  
**ALBINA COMMUNITY PLAN DISTRICT**



File No. LU 14-101848 HR  
 1/4 Section 2832  
 Scale 1 inch = 200 feet  
 State\_Id 1N1E26DD 11700  
 Exhibit B (Jan 07, 2014)

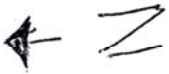

NE HANCOCK ST

\*Approved\*

City of Portland

Bureau of Development Services

Planner

*Jennifer Kenney*  
2/7/14

to the

to all

Area of work

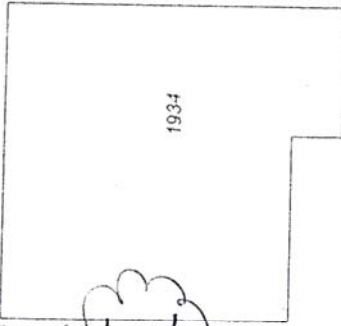

1934

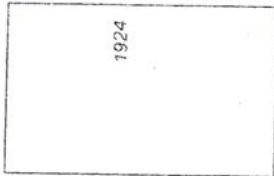

1924

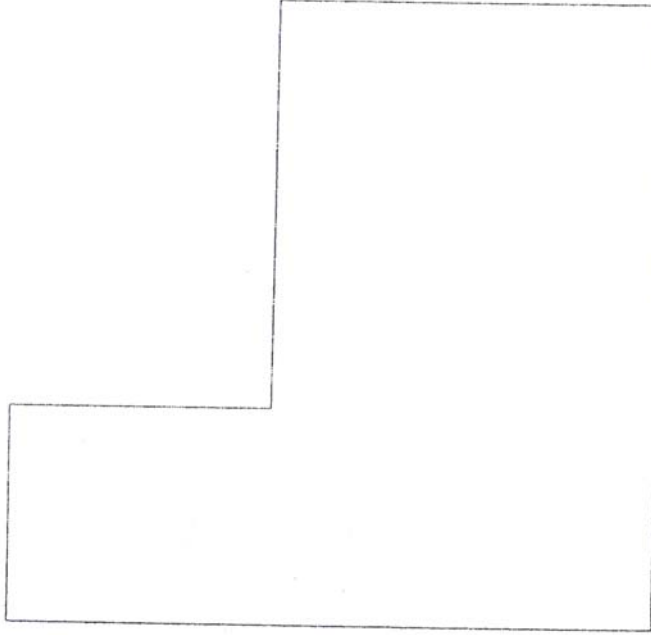

1921+2605

2011

2027

EXHIBIT C-1

LM 14-101848 HRE





\*Approved\*  
 City of Portland  
 Bureau of Development Services  
 Planner: Jennifer Kenny  
 Date: 2/4/14  
 \*This approval applies only to the project presented and is subject to all applicable codes and regulations.

- Replacement siding to match existing house
- Tin roof
- Paint to match existing house

PROPOSED # DOG HOUSE #

LU 14-101848 HR  
 EXHIBIT C-2