



**City of Portland, Oregon**  
**Bureau of Development Services**  
**Land Use Services**  
FROM CONCEPT TO CONSTRUCTION

Chloe Eudaly, Commissioner  
Rebecca Esau, Director  
Phone: (503) 823-7300  
Fax: (503) 823-5630  
TTY: (503) 823-6868  
[www.portlandoregon.gov/bds](http://www.portlandoregon.gov/bds)

**NOTICE OF PROPOSED  
DEVELOPMENT IN AN ENVIRONMENTAL ZONE**

**Date:** January 12, 2018  
**To:** Neighborhood Association and Interested Persons  
**From:** Susan Ellis, City Planner, 503-823-5361, [susan.ellis@portlandoregon.gov](mailto:susan.ellis@portlandoregon.gov)  
**Re:** The City has received a building permit application for development within an **environmental zone**. The purpose of this notice is to inform neighbors and interested persons of permitting activities and projects within the environmental zones that will utilize the Environmental Development Standards of Zoning Code Chapter 33.430. This is not a Land Use Review notice.

**Permit Number:** 17-275682-ZP  
**Project Description:** Proposal for Resource Enhancement within an Environmental Conservation and Protection Zone.

**Primary Contact / Owner:** Steve Bloomquist  
Port of Portland, 503-415-6558 or  
[steve.bloomquist@portofportland.com](mailto:steve.bloomquist@portofportland.com)

**Applicant:** Mike Coyle, Faster Permits  
2000 SW 1<sup>st</sup> Ave, Ste. 420  
Portland, OR 97201

**Site Location:** 7111 NE Alderwood Dr

**Legal Description:** SECTION 17 1N 2E, TL 800 and 500

**Zone:** IG2h,c,p,x **Quarter Section Map:** 2338 **Tax Account #:** R317246 and R317228

The permit is being reviewed for compliance with the following environmental development standards:

- Resource enhancement projects subject to Section 33.430.170

**The site plan is enclosed and displayed on a notice board on site.** Plans may be examined at **BDS Permitting Services, second floor of 1900 SW 4<sup>th</sup> Avenue**, Monday – Wednesday and Fridays from 8:00 AM to 3:00 PM and Thursdays from 8:00 AM to Noon. Copies of the site plans and development standards can be obtained for a fee. The development standards are available online at [www.portlandonline.com/zoningcode](http://www.portlandonline.com/zoningcode).

Any interested person may comment on the application by writing and specifically identifying errors or non-compliance with development standards. Comments should be directed to the staff person noted above. Comments may be used to clarify or improve the accuracy of the site plan, but may not be used by the City to influence the issuance of a permit for a project that meets development standards. **An inspector will visit the site to verify the accuracy of the site plan prior to issuance of any permits.**

**Contact Susan Ellis or the applicant at the above phone numbers or email addresses with any questions. Please reference the permit number 17-275682 ZP on your request.**

**Table 2. Seeding species list**

Grasses
Meadow Balfog
California Dandelion
California Brome
California Fescue
Roman's Fescue
Turkey Tailgrass
Spice Bentgrass
Water Foxtail
Western Yarrow
Riverbank Lupine
Grassy Tarweed

**Table 3. Mitigation plantings**

Species	Total # plants (mitigation for bare and non-ecore impacts)
red-odier dogwood	88
pacific rhododendron	87
Douglas's spirea	87
red currant	87
wine maple	87
<b>Total Shrubs*</b>	<b>436*</b>
Oregon Ash	5
Red Alder	9
Oregon White Oak	53
Black Alder	9
Big Leaf Maple	9
<b>Total Trees</b>	<b>45</b>

\* An additional 700 native bare root shrubs and stakes will be planted on NE slope after vegetation removal as enhancement and bank stabilization.

**Table 1. Tree removal and mitigation**

Tree	Removal		Mitigation	
	Species	Size Range (DBH)	Number	Species
Willow*	Salix sp.	6-12	3	5
Cottonwood	Populus balsamifera	6-12	1	2
Cottonwood	Populus trichocarpa	12-20	1	1
Cottonwood*	Populus balsamifera	20-25	2	4
Cottonwood*	Populus trichocarpa	20-25	2	6
Oak	Quercus garryana	6-12	3	6
Ash	Fraxinus latifolia	12-20	1	1
<b>Total</b>			<b>13</b>	<b>25</b>

\* Dead trees included, mitigation ratio 1:1

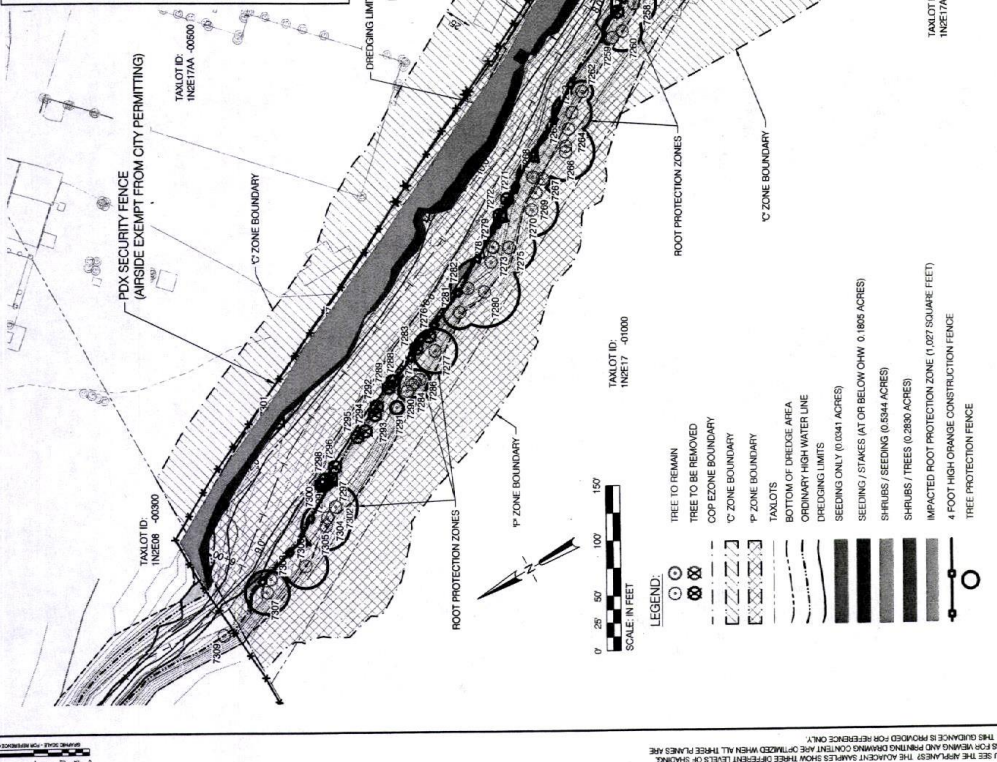

**PORTLAND INTERNATIONAL AIRPORT**  
**McBRIDE SLOUGH WEST ENVIRONMENTAL PLAN CHECK SUPPLEMENTAL**  
**MITIGATION PLAN**

DESIGNED BY: P. BIELDS  
 DRAWN BY: S. BUCHANAN  
 CHECKED BY: J. BUCHANAN  
 DATE: JAN 2018  
 SCALE: 1" = 50'

PROJECT NO: PDX 2017-502  
 SHEET NO: C-11  
 DRAWING NO: PC

DATE: 11/01/18  
 BY: [Signature]  
 CHECKED: [Signature]  
 APPROVED: [Signature]

PRINTED: 11/01/18 11:02:11 AM SHEET: 11/01/18 11:02:11 AM

17-275688 ZP