



**City of Portland, Oregon**  
**Bureau of Development Services**  
**Land Use Services**  
FROM CONCEPT TO CONSTRUCTION

Ted Wheeler, Mayor  
Rebecca Esau, Director  
Phone: (503) 823-7300  
Fax: (503) 823-5630  
TTY: (503) 823-6868  
[www.portlandoregon.gov/bds](http://www.portlandoregon.gov/bds)

**Date:** 3/7/2019  
**To:** Interested Person  
**From:** Tanya Paglia, Land Use Services  
503-823-4989/Tanya.Paglia@portlandoregon.gov

## **NOTICE OF A TYPE II PROPOSAL IN YOUR NEIGHBORHOOD**

Development has been proposed in your neighborhood. The proposed development requires a land use review. The proposal, review process, and information on how to respond to this notice are described below. A copy of the site plan and zoning map is attached. I am the staff person handling the case. Please call me if you have questions regarding this proposal. Please contact the applicant if you have questions regarding any future development on the site.

Because we must publish our decision within 28 days, **we need to receive your written comments by 5 p.m. on 3/28/2019**. Please mail or deliver your comments to the address at the bottom of the page, and include the Case File Number, LU 19-121460 DZ, in your letter. It also is helpful to address your letter to me, Tanya Paglia. You can also e-mail your comments to me at my e-mail address identified above. Please note that all correspondence received will become part of the public record.

## **CASE FILE NUMBER: LU 19-121460 DZ – ROOFTOP MECHANICAL UNITS & STOREFRONT ALTERATIONS**

**Applicant/Owner:** Ryan Mcguire | Pacific Realty Associates LP (PacTrust)  
15350 SW Sequoia Pkwy #300  
Portland, OR 97224

**Site Address:** **1307 NE 102ND AVE**

**Legal Description:** LOT 3 EXC PT IN ST, PARTITION PLAT 1995-11  
**Tax Account No.:** R649750440  
**State ID No.:** 1N2E33AA 00104  
**Quarter Section:** 2940

**Neighborhood:** Hazelwood, contact Arlene Kimura at 503-252-9429.  
**Business District:** Gateway Area Business Association, contact at [info@gabanet.com](mailto:info@gabanet.com)  
**District Coalition:** East Portland Community Office, contact Victor Salinas at 503-823-6694.

**Plan District:** Gateway  
**Other Designations:** None

**Zoning:** **CXd** – Central Commercial with Design Overlay  
**Case Type:** **DZ** – Design Review

**Procedure:** **Type II**, an administrative decision with appeal to the Design Commission.

**Proposal:**

The applicant seeks design review approval for exterior alterations to accompany an interior tenant improvement to an existing building in the Gateway Shopping Center. The alterations will include adding two new roof top HVAC units and one new storefront door to match existing storefront.

Design review is required because the proposal is for exterior alterations in a design overlay zone.

**Relevant Approval Criteria:**

In order to be approved, this proposal must comply with the approval criteria of Title 33, Portland Zoning Code. The relevant criteria are:

- Community Design Guidelines

Zoning Code Section 33.700.080 states that Land Use Review applications are reviewed under the regulations in effect at the time the application was submitted, provided that the application is complete at the time of submittal, or complete within 180 days. This application was submitted on February 15, 2019 and determined to be complete on 3/1/2019.

**DECISION MAKING PROCESS**

The Bureau of Development Services will make a decision on this proposal. After we consider your comments we will do one of the following:

- Approve the proposal;
- Approve the proposal with conditions; or
- Deny the proposal.

The neighborhood association listed on the first page of this notice may take a position on this application. They may also schedule an open meeting prior to making their recommendation to the Bureau of Development Services. Please contact the person listed as the neighborhood contact to determine the time and date of this meeting.

ORS 227.178 states the City must issue a final decision on Land Use Review applications within 120-days of the application being deemed complete. The 120-day review period may be extended at the request of the applicant.

The file and all evidence on this case are available for your review by appointment by making a request online or contacting me.

- Please call the Request Line at our office, 1900 SW Fourth Avenue, Suite 5000, phone 503-823-7617, to schedule an appointment. Copies of all information in the file can be obtained for the cost of making copies during the appointment.
- If you would like to request a copy of the file online, please visit <https://www.portlandoregon.gov/bds/54732>. The fee for this service varies based on the size of the case file and how long it would take to scan or copy documents.
- I can provide some information over the phone or through email.

Additional information about the City of Portland, city bureaus, and a digital copy of the Portland Zoning Code is available on the internet at [www.portlandoregon.gov](http://www.portlandoregon.gov).

**APPEAL PROCESS**

If you disagree with the Bureau of Development Services administrative decision, you can appeal the decision to the Design Commission. This review body will hold a public hearing for the appeal. When the decision is mailed, the criteria used to make the decision and information on how to file an appeal will be included. If you do not send any comments, you can still appeal the decision. There is a 14-day deadline to file an appeal beginning on the day the decision is mailed. The reason for the appeal must be specifically defined in order for the

review body to respond to the appeal. If an appeal is filed, you will be notified of the time and location of the appeal hearing.

There is a fee charged for appeals. Recognized neighborhood associations may qualify for an appeal fee waiver.

**APPEAL OF THE FINAL CITY DECISION**

After an appeal hearing, the review body decision may be appealed to the Oregon Land Use Board of Appeals (LUBA) at 775 Summer St NE, Suite 330, Salem, Oregon 97301-1283. The phone number for LUBA is 1-503-373-1265. Issues that may provide the basis for an appeal to LUBA must be raised prior to the comment deadline or prior to the conclusion of the hearing if a local appeal is requested. If you do not raise an issue with enough specificity to give the Bureau of Development Services an opportunity to respond to it, that may also preclude an appeal to LUBA on that issue.

**The Bureau of Development Services is committed to providing equal access to information and hearings. Please notify us no less than five business days prior to the event if you need special accommodations. Call 503-823-7300 (TTY 503-823-6868).**

**Enclosures:** Zoning Map; Site Plan; Partial Building Sections; Elevation

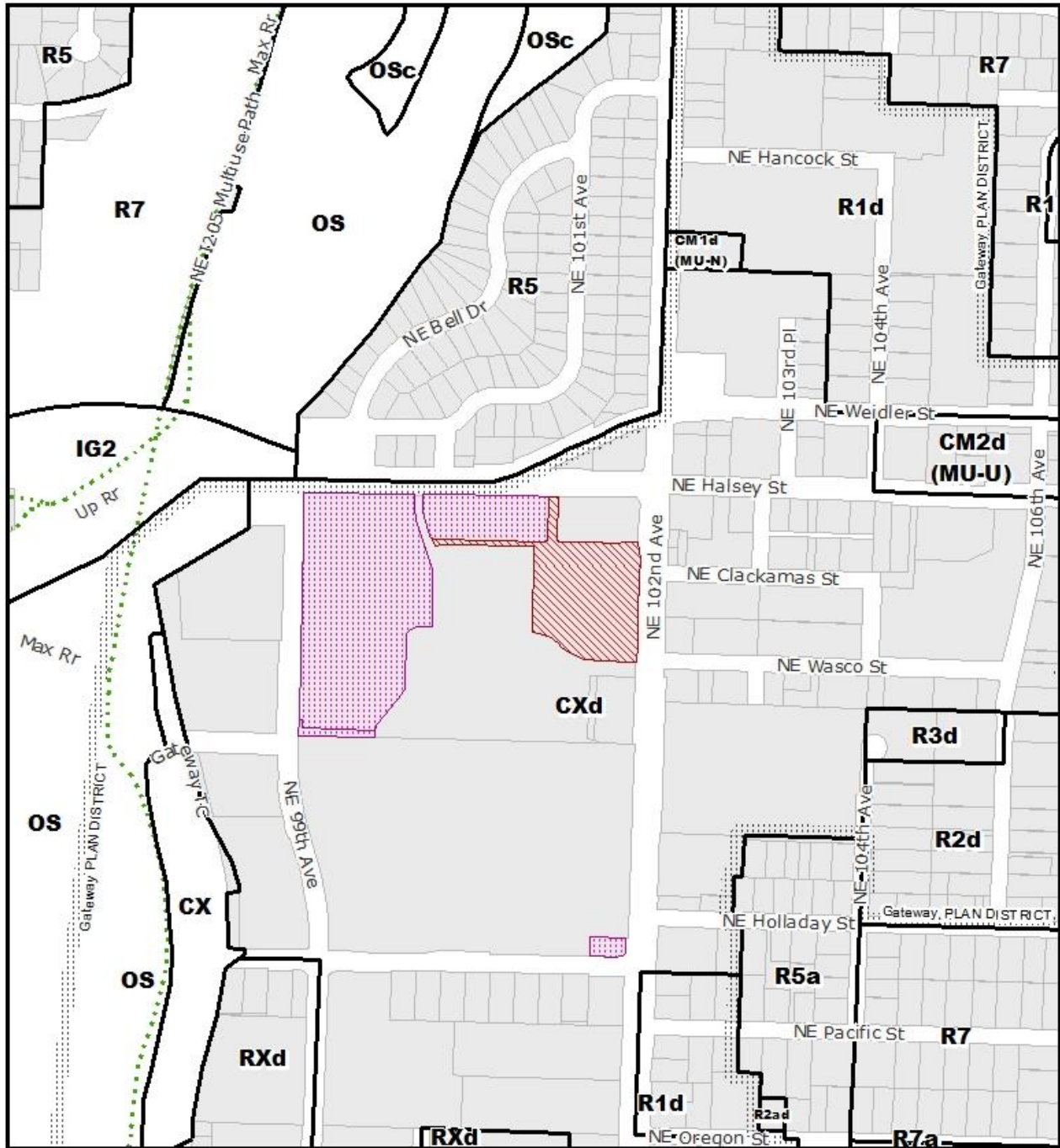

**ZONING**   
 THIS SITE LIES WITHIN THE:  
 GATEWAY PLAN DISTRICT

-  Site
-  Also Owned Parcels
-  Recreational Trails

File No.	LU 19-121460 DZ
1/4 Section	2940
Scale	1 inch = 400 feet
State ID	1N2E33AA 104
Exhibit	B Feb 20, 2019

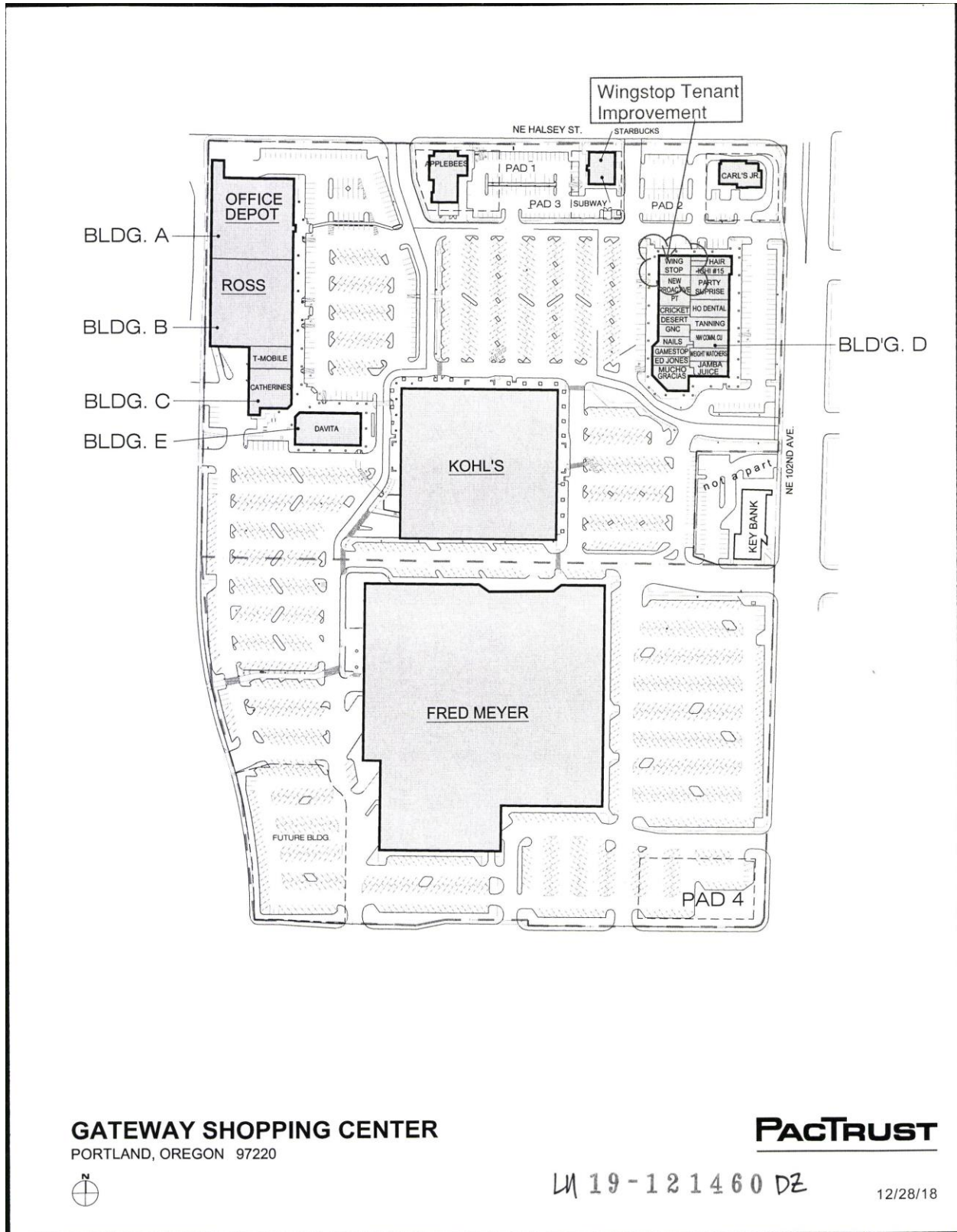

**GATEWAY SHOPPING CENTER**  
PORTLAND, OREGON 97220

**PACTRUST**

LU 19-121460 DZ

12/28/18

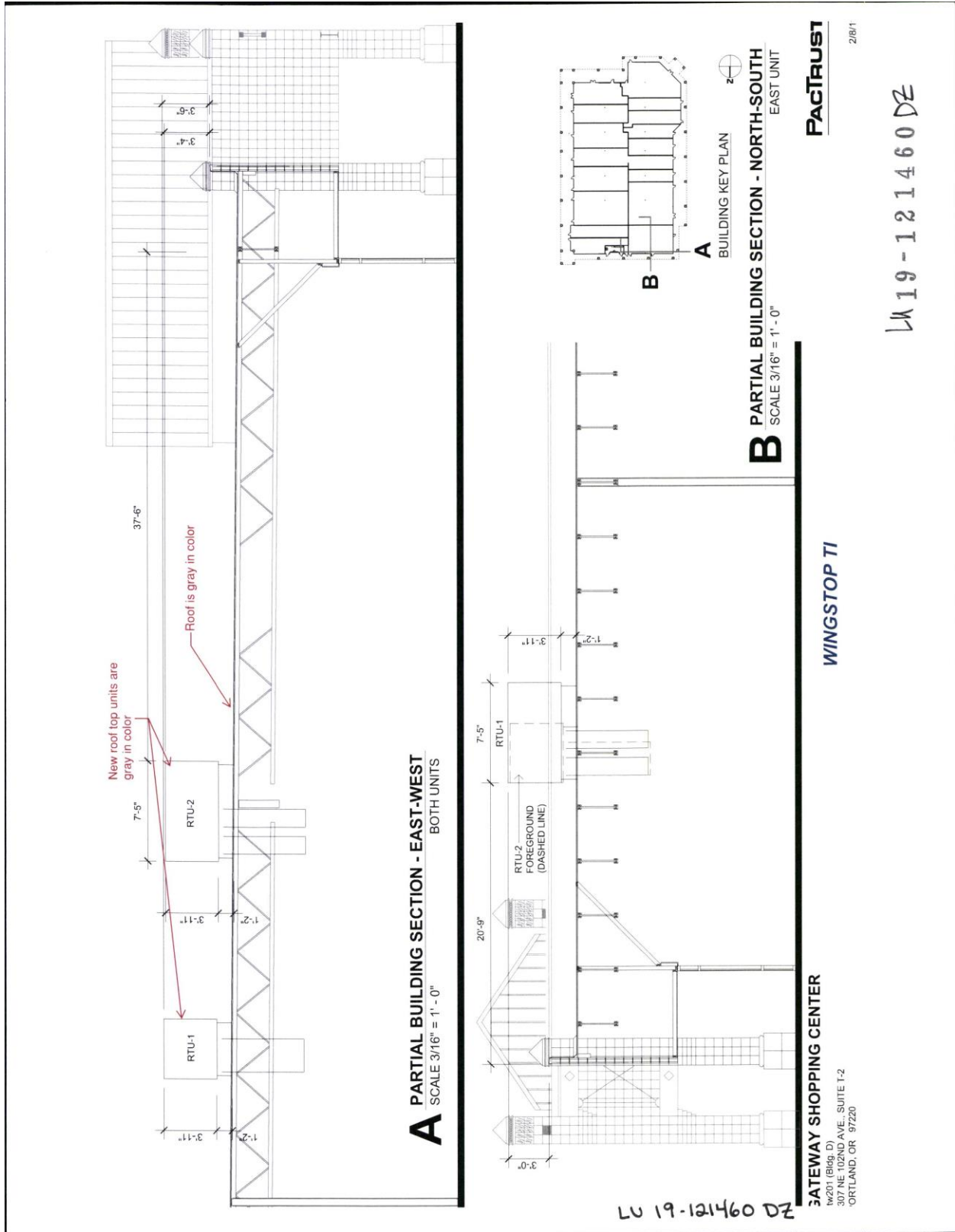

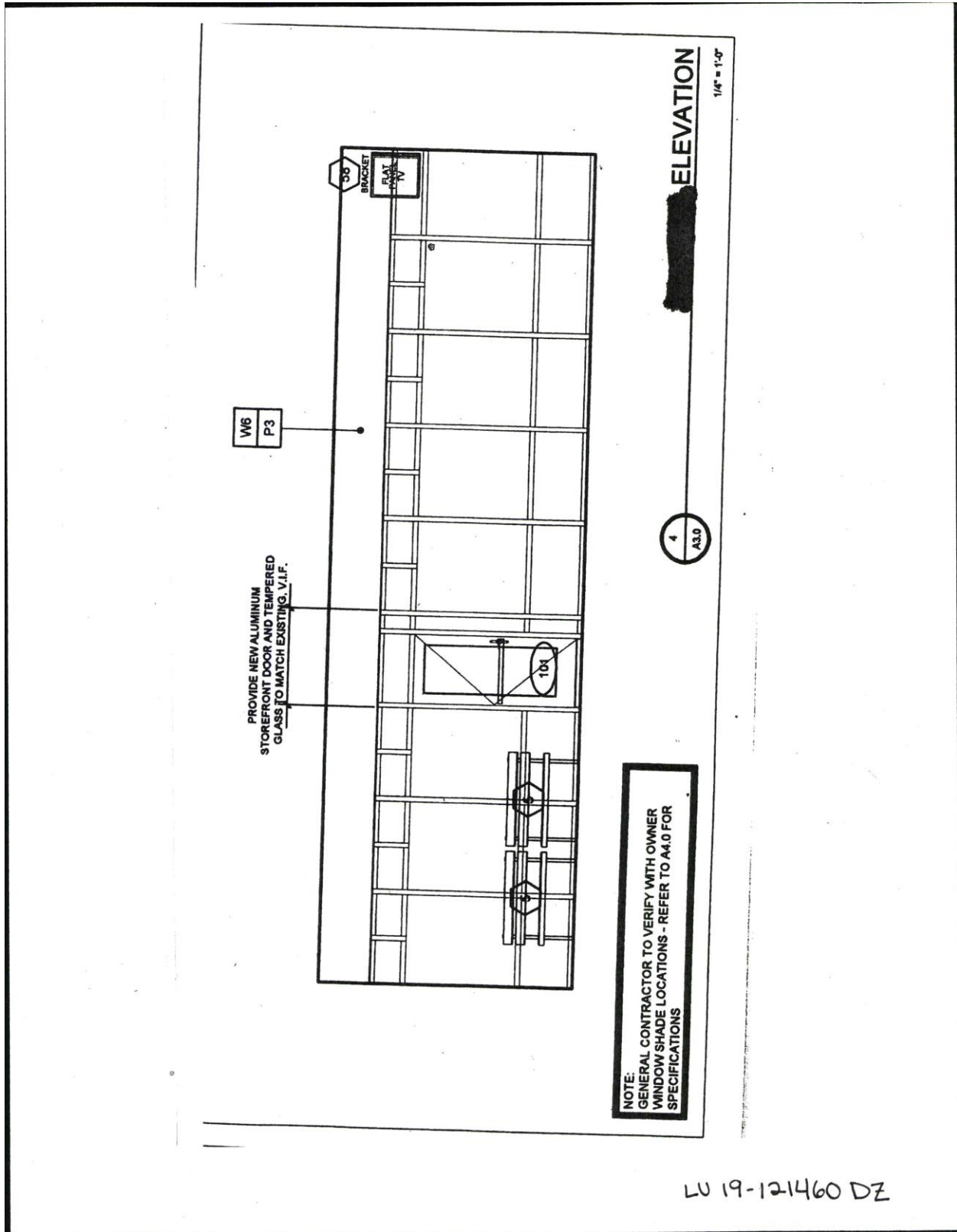

LU 19-121460 DZ