

Fanno Creek Watershed

working for clean rivers

SW 86th Avenue Pump Station Temporary Fanno Creek Trail Closure

JANUARY 23, 2015

CONTACT: Debbie Caselton, 503-823-2831
Debbie.Caselton@portlandoregon.gov

On Monday, February 9, Environmental Services will close a portion of the Fanno Creek Trail at SW 84th Avenue (see map below) for several days in order to locate and measure a section of the Fanno Pressure Sewer. The trail will close again later in the year at the same location to allow work crews to connect the pressure sewer to the new pump station.

When the SW 86th Avenue Pump Station is complete at the end of 2015, it will increase the capacity of the Fanno Basin Sewer System to ensure that the system can handle all wastewater flows during large rain storms. It will protect public health and the health of the Fanno Creek Watershed.

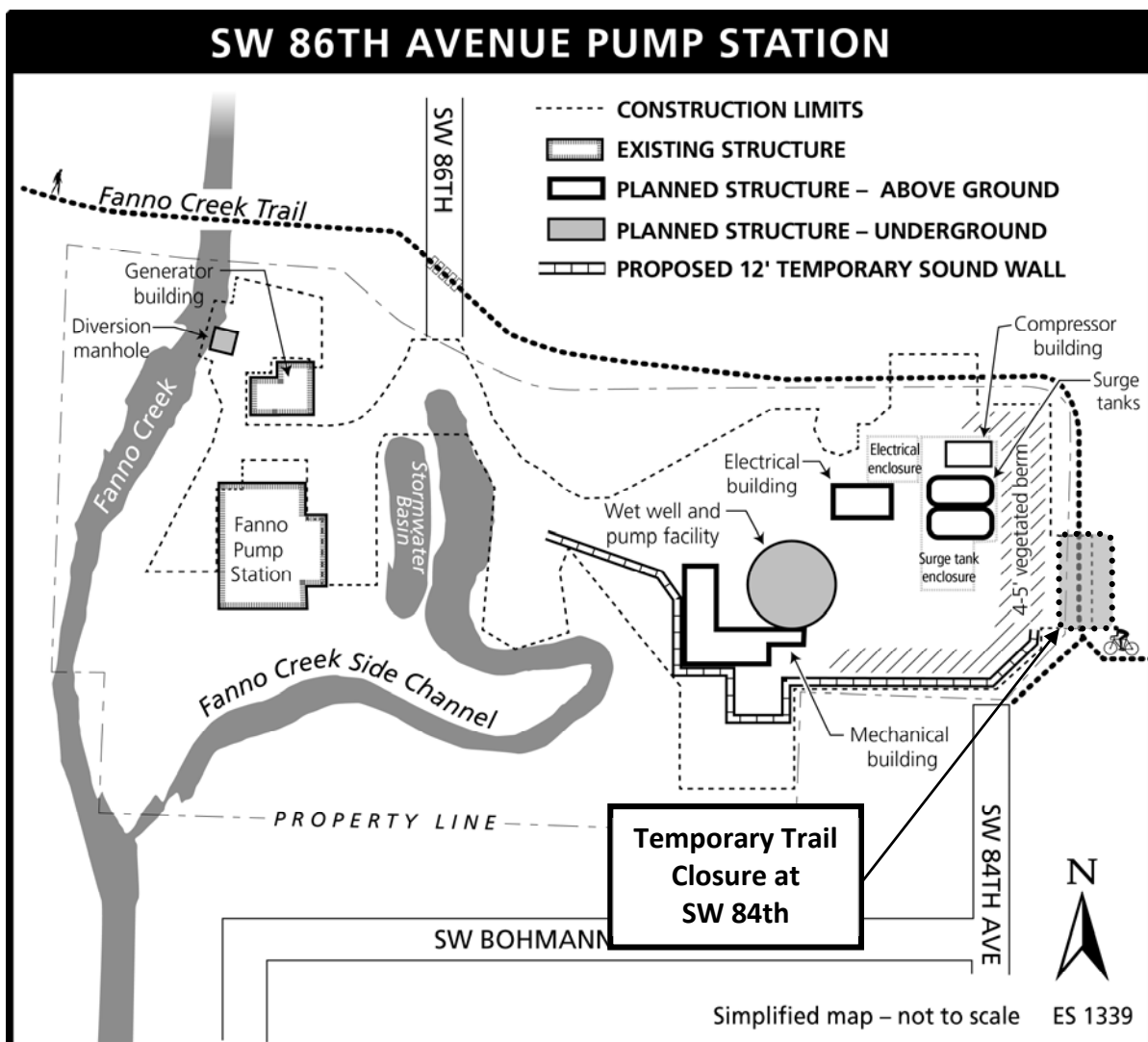

ENVIRONMENTAL SERVICES
CITY OF PORTLAND

working for clean rivers

Over one-third of Portland's 2,500 miles of sewer pipes are more than 80 years old. Projects to replace or repair aging sewers are important for protecting water quality, public health, and the environment. Learn more at www.portlandoregon.gov/bes.