

2219

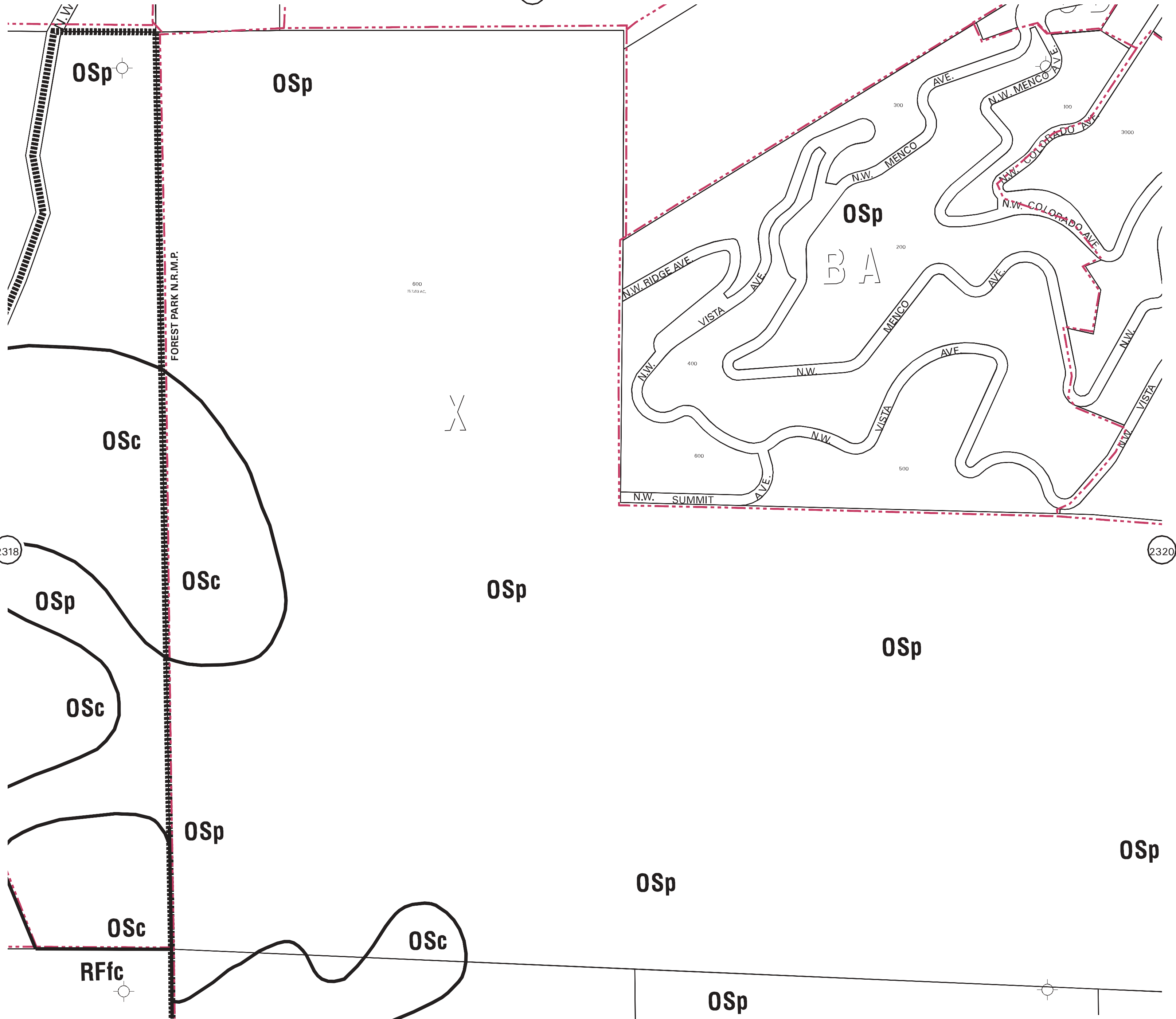



2318



2320

2419

NOTE: This entire 1/4 section lies within the NORTHWEST HILLS PLAN DISTRICT

NOTE: Zoning designations are subject to change; verify zoning prior to development or sales.

-  Plan District Boundary
-  Historic or Conservation District or N.R.M.P. Boundary
-  Zoning Line

<p><b>R10</b> Current Zoning</p> <p> Maximum Potential Zoning as per Comprehensive Plan</p> <p> State ID Map Boundary</p>	ZONING REVISED:	CITY OF PORTLAND BUREAU OF PLANNING
	05-26-2006	
	BASEMAP ACQUIRED:	10 - 2005
	LEGAL DESCRIPTION:	
	NW 1/4 SEC. 14 - 1N - 1W	<b>2319</b>