

ONI-1: HISTORIC KENTON FIRE HOUSE

2209 N SCHOFIELD, PORTLAND OR
EXTERIOR

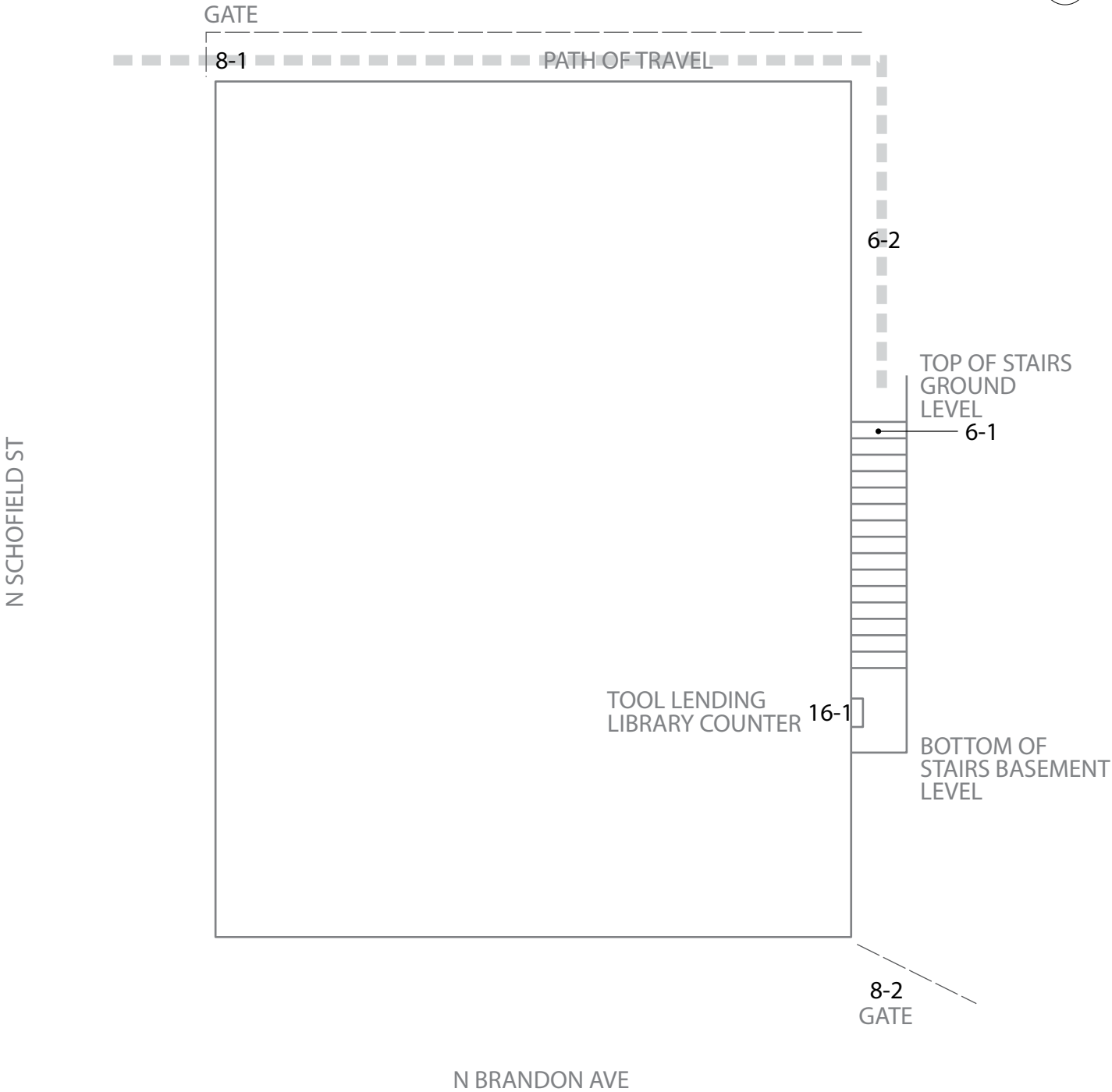

ONI-1: Historic Kenton Firehouse

Exterior	
6 - 1	Stairway Category: 4
Install or modify handrails	\$3,680
Notes: There are no parallel extensions on the top of the stair run (12" min.). Handrails are mounted 1-3/4" from the wall (1-1/2" req.)	
State: ---	
Federal: 505.10.2, 505.5	
Replace stairs	\$4,800
Notes: Tread length is 10-1/2" (11" min.) There are 16 risers.	
State: ---	
Federal: 504.2	
EQUIVALENT FACILITATION CONSIDERATION	\$0
Notes: A call button will be installed at gate 8-2. This will allow a member of the public to receive assistance and access the Tool Lending Library program without having to use stair 6-1.	
State: -	
Federal: -	
6 - 2	Stairway Category: 4
Install or modify handrails	\$690
Notes: Handrails are not provided.	
State: ---	
Federal: 505.10.2, 505.4	
EQUIVALENT FACILITATION CONSIDERATION	\$0
Notes: Alternate entrances on the first floor are provided.	
State: -	
Federal: -	

ONI-1: Historic Kenton Firehouse

Exterior		
8 - 1	Door/Gate	Category: 4
Regrade surface		\$459
Notes: Clear space on the push side of the gate has slopes up to 7.5%. Clear space on the swing side of the gate has slopes up to 6.4% (2% max.)		
State: ---		
Federal: 404.2.4.4		
Provide or modify door kickplate		\$100
Notes: Kick plate is not provided on gate		
State: ---		
Federal: 404.2.10		
EQUIVALENT FACILITATION CONSIDERATION		\$0
Notes: This gate is not accessible. Directional signage on this gate will be installed to route the public to gate 8-2.		
State: -		
Federal: -		
8 - 2	Door/Gate	Category: 1
Regrade surface		\$459
Notes: Clear space on the push side of the gate has slopes up to 9.4% (2% max.)		
State: ---		
Federal: 404.2.4.4		
Provide or modify door kickplate		\$100
Notes: Kick plate is not provided on gate		
State: ---		
Federal: 404.2.10		
16 - 1	Built-in Elements	Category: 2
Provide an accessible path of travel		\$0
Notes: Accessible path of travel to the Tool Lending Library service counter is not provided due to stairs. Equivalent facilitation will be provided by providing a call button at gate 8-2.		
State: ---		
Federal: 206.2		
Provide an accessible counter		\$2,500
Notes: Counter is located 41" above the ground surface (36" max.)		
State: ---		
Federal: 227.3, 403		

ONI-1: HISTORIC KENTON FIRE HOUSE
2209 N SCHOFIELD, PORTLAND OR
1ST FLOOR

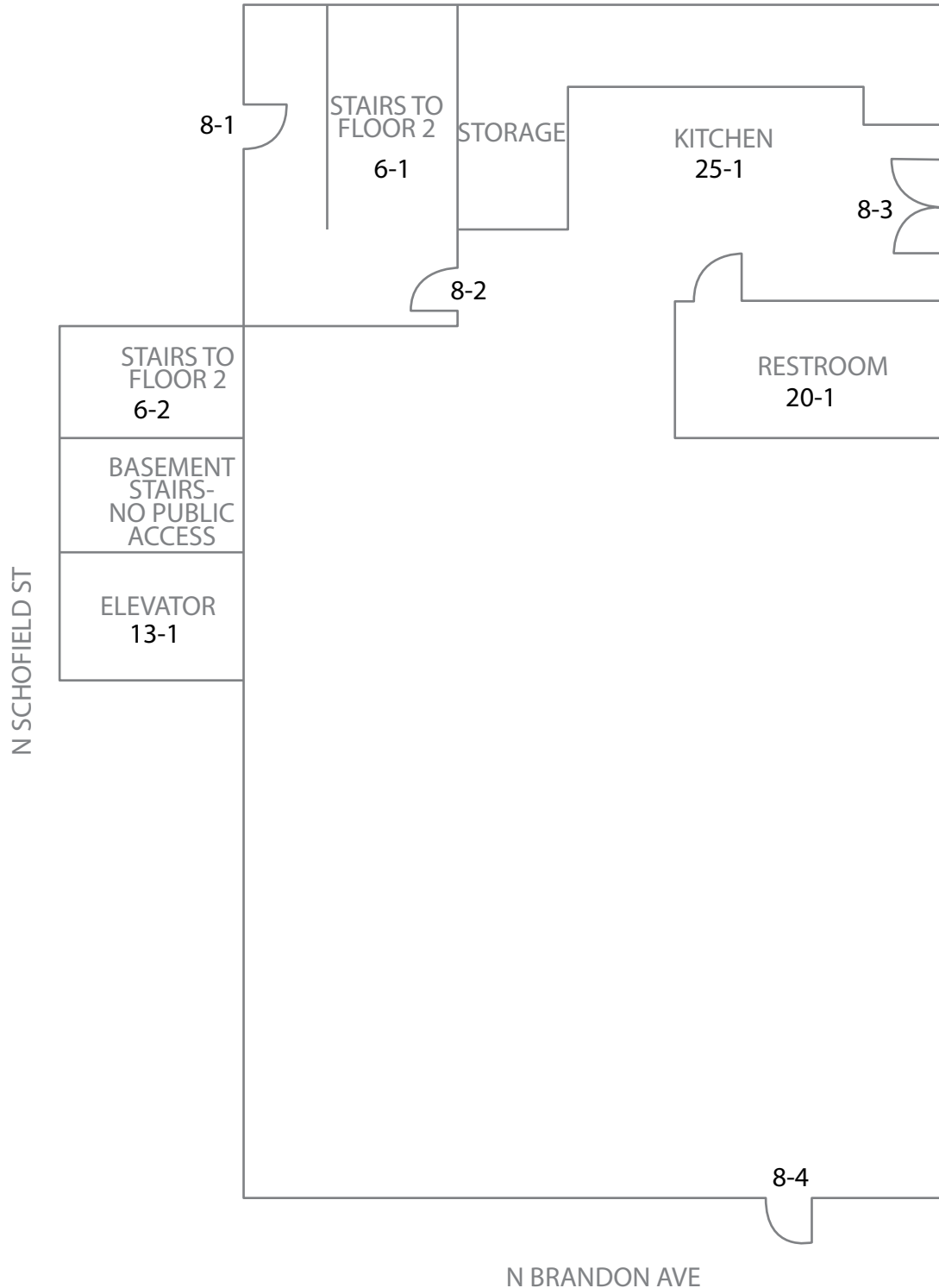

Floor 1		
6 - 1	Stairway	Category: 4
Replace stairs		\$7,200
Notes: Stair has 24 risers. Stair width varies between 34 to 35-3/4" (36" min.) Tread length is 10-1/2" (11" min.)		
State: ---		
Federal: 1009.1, 504.2		
Install or modify handrails		\$5,520
Notes: Handrails are located on one side of the stair run. Top extension is not provided Top surface of the handrail is mounted 33" (34-38" req.) Handrails are located 2" from the wall (1-1/2" req.) Ends of handrails do not return to floor, wall or post.		
State: ---		
Federal: 505.10.2, 505.4		
EQUIVALENT FACILITATION CONSIDERATION		\$0
Notes: Stair access is not required. Second floor is for staff only.		
State: -		
Federal: -		
6 - 2	Stairway	Category: 4
Replace stairs		\$6,300
Notes: Stair has 21 risers. Stair width is 34 -3/4" (44" min.) Tread length is 10-1/2" (11" min.) Risers are 8-1/2" (4-7" req.)		
State: ---		
Federal: 1009.1, 504.2		
Install or modify handrails		\$4,830
Notes: Handrails are not provided. There are 21 risers.		
State: ---		
Federal: 505.10.2, 505.4		
Repair stair nosings		\$420
Notes: Stair nosing projects 1-3/4" (1-1/2" max.)		
State: ---		
Federal: 504.5		
EQUIVALENT FACILITATION CONSIDERATION		\$0
Notes: Stair access is not required. Second floor is for staff only.		
State: -		
Federal: -		

Floor 1		
8 - 1	Door/Gate	Category: 1
Provide sign(s) indicating accessible entries and facilities		\$250
Notes: Keypad is required for entry. International Symbol of Accessibility is not provided on the primary entrance.		
State: ---		
Federal: 216.6		
Modify door window or side light		\$500
Notes: Window in door is located 50-1/4" AFF (43" max.)		
State: ---		
Federal: 404.2.11		
Increase or provide maneuvering or clear floor area		\$175
Notes: Maneuvering clearance on pull-side of the door (front approach) is 40" (60" min.).		
State: ---		
Federal: 404.2.4.1		
Provide two-way communication		\$1,000
Notes: Two-way communication system is provided to gain admittance. The system does not provide both a visual and audible signal.		
State: ---		
Federal: 708		
Provide an accessible path of travel		\$0
Notes: Two doors provide entry (8-1, 8-4) and neither is fully accessible. At least 60% of all public entries are required to be accessible.		
State: -		
Federal: 206.4.1		
Regrade surface		\$255
Notes: Pull-side of the door slope is 4.4% (2% req.).		
State: ---		
Federal: 404.2.4.4		
EQUIVALENT FACILITATION CONSIDERATION		\$0
Notes: Directional signage will be installed to route the public to use door 8-4. Door 8-4 will be the designated accessible entrance.		
State: -		
Federal: -		

ONI-1: Historic Kenton Firehouse

Floor 1		
8 - 2	Door/Gate	Category: 2
Provide additional strike edge clearance		\$3,000
Notes: Strike edge clearance on the pull side of the door is not provided (18" min.) due to banister.		
State: ---		
Federal: 404.2.4.1		
8 - 3	Door/Gate	Category: 4
Provide an accessible path of travel		\$0
Notes: Accessible path of travel is not provided due to stairs. Alternate entrances on the first floor are provided.		
State: ---		
Federal: 206.2.4, 404.1		
8 - 4	Door/Gate	Category: 1
Provide sign(s) indicating accessible entries and facilities		\$250
Notes: Signage indicating the location of the accessible entrance is not provided.		
State: ---		
Federal: 216.6		
Replace or adjust door hardware		\$1,000
Notes: Door hardware is a knob that requires grasping and twisting.		
State: ---		
Federal: 309.4		
Enlarge door opening		\$1,650
Notes: Height of clear opening is 78" (80" min.)		
State: ---		
Federal: 404.2.3.2		

ONI-1: Historic Kenton Firehouse

Floor 1	
13 - 1 Elevator	Category: 4
Enlarge elevator	\$150,000
Notes: Elevator and associated doors are not accessible. Clear width of elevator car door is 25-3/4" (36" min.)	
State: ---	
Federal: 407.4.1	
Adjust elevator operation	\$0
Notes: Cage gates are prohibited.	
State: ---	
Federal: 407.3.1	
Adjust elevator controls and labeling	\$0
Notes: Car controls are not accessible.	
State: ---	
Federal: 308.2.1, 308.3.1, 407.2.1.1, 407.2.1.2, 407.2.1.4, 407.2.1.5	
EQUIVALENT FACILITATION CONSIDERATION	\$0
Notes: Elevator access is not required. Second floor is for staff only.	
State: -	
Federal: -	

ONI-1: Historic Kenton Firehouse

Floor 1	
20 - 1	Single User Restroom Category: 2
Install sign	\$250
Notes: Restroom sign is centered 67" AFF (60" req.) Sign does not have International Symbol of Accessibility.	
State: ---	
Federal: 703, 703.4.1, 703.4.2	
Increase or provide maneuvering or clear floor area	\$175
Notes: Turning space in restroom is 47-1/2" (60" min.).	
State: ---	
Federal: 304.3.1, 306.3, 603.3.2.1	
Replace or reposition fixtures	\$1,500
Notes: Centerline of the water closet is 19" (16-18" req.)	
State: ---	
Federal: 604.9, 604.9.1	
Replace or modify grab bars	\$250
Notes: Side grab bar is 36" (42" min.). Total length of side grab bar from the back wall is 44-1/2" (54" min.)	
State: ---	
Federal: 609.5.1	
Modify lavatory or counter clearances	\$0
Notes: Knee space and toe clearance are not provided under the lavatory counter due to storage items.	
State: ---	
Federal: 306.2, 306.2.3, 306.3, 306.3.3	

ONI-1: Historic Kenton Firehouse

Floor 1	
25 - 1	Kitchen
Category: 2	
Increase or provide maneuvering or clear floor area	\$175
Notes: Floor area near entrance to the kitchen has a slope of 4% (2% max.) Approx. 10 ft.	
State: ---	
Federal: 305.3, 305.5	
Modify operating mechanism	\$250
Notes: Controls are located on the back wall.	
State: ---	
Federal: 309	
Modify lavatory or counter clearances	\$2,500
Notes: Kitchen work surface and sink counter is located 35-1/2" AFF (34" max.) Knee and toe clearance are not provided.	
State: ---	
Federal: 306.2.3, 306.3.3, 804.3.2	
Replace or reposition dispensers or mirrors	\$150
Notes: Paper towel dispenser is mounted 51" AFF (48" max.)	
State: ---	
Federal: 308	

ONI-1: HISTORIC KENTON FIRE HOUSE
2209 N SCHOFIELD, PORTLAND OR
2ND FLOOR

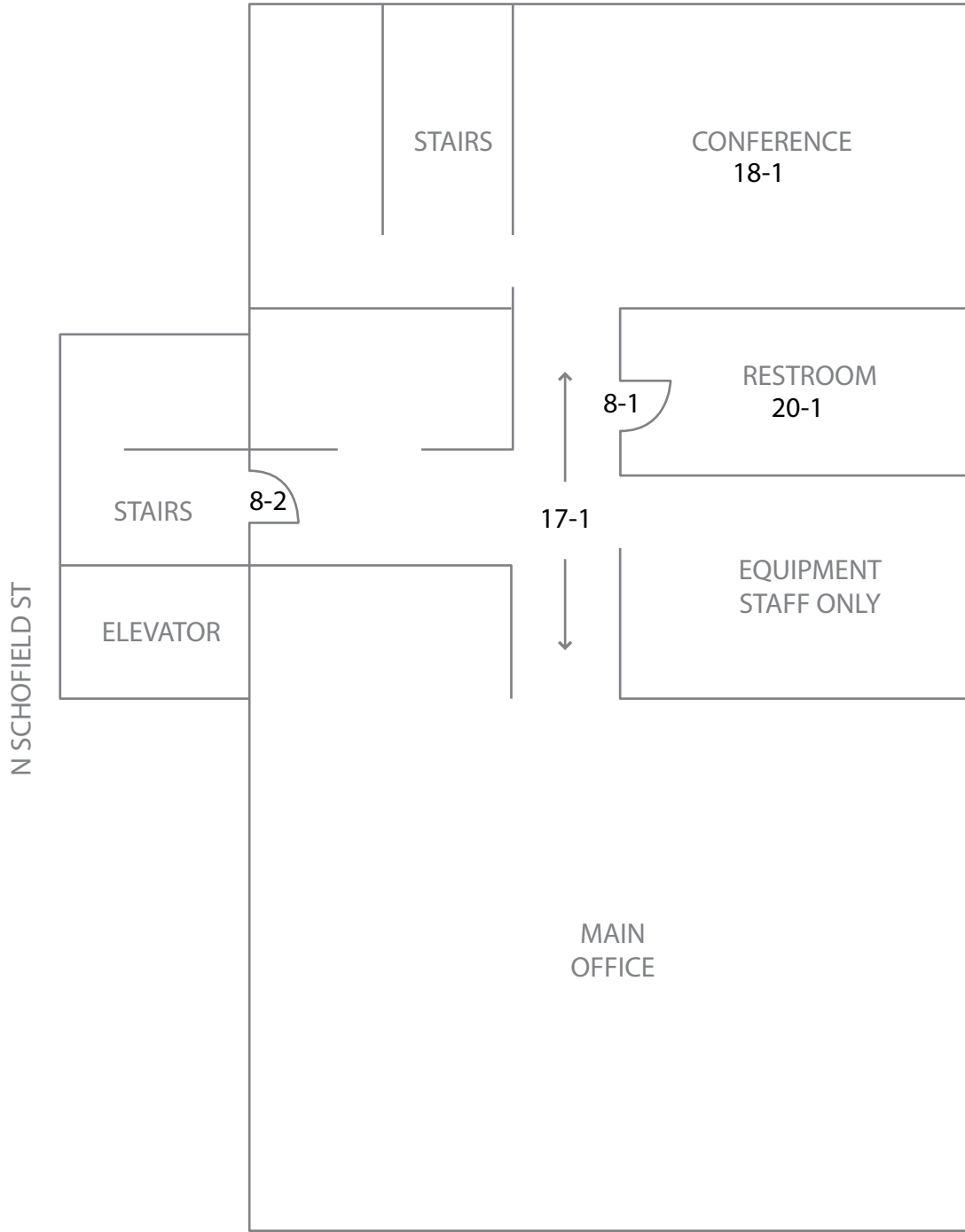

N BRANDON AVE

Floor 2		
8 - 1	Door/Gate	Category: 4
Enlarge door opening		\$1,650
Notes: Width of clear opening is 27-3/4" (32" min.)		
State: ---		
Federal: 404.2.3		
Increase or provide maneuvering or clear floor area		\$175
Notes: Strike edge clearance on the push side of the door is 40-3/4" (48" min.)		
State: ---		
Federal: 404.2.4.1		
EQUIVALENT FACILITATION CONSIDERATION		\$0
Notes: Second floor is for staff only.		
State: -		
Federal: -		
8 - 2	Door/Gate	Category: 4
Install or modify permanent room signs		\$125
Notes: Tactile and Braille EXIT sign is not provided.		
State: ---		
Federal: 703.4.1		
Modify door window or side light		\$500
Notes: Window in door is located 44" AFF (43" max.)		
State: ---		
Federal: 404.2.11		
EQUIVALENT FACILITATION CONSIDERATION		\$0
Notes: Second floor is for staff only.		
State: -		
Federal: -		
17 - 1	Corridor / Aisle	Category: 4
Reposition controls and outlets		\$2,000
Notes: Light switches are mounted 49" AFF and 49-1/2" AFF (48" max.).		
State: ---		
Federal: 309.4		
EQUIVALENT FACILITATION CONSIDERATION		\$0
Notes: Second floor is for staff only.		
State: -		
Federal: -		

ONI-1: Historic Kenton Firehouse

Floor 2		
18 - 1	Room	Category: 4
	Reposition controls and outlets	\$2,000
Notes: Three electrical outlets are located 5" AFF (15-48" req.)		
State: ---		
Federal: 308.2.1		
	EQUIVALENT FACILITATION CONSIDERATION	\$0
Notes: Second floor is for staff only.		
State: -		
Federal: -		
20 - 1	Single User Restroom	Category: 4
	Renovate restroom	\$75,000
Notes: This restroom is not accessible and would require a complete renovation. Restroom is located on the second floor and is accessible only by stairs or a non-compliant elevator. The designated accessible restroom is located on the first floor.		
State: ---		
Federal: 604.8.1.2		
	Install sign	\$250
Notes: No sign directing people to the accessible room is provided.		
State: ---		
Federal: 216.8, 703.7.2.1		
	EQUIVALENT FACILITATION CONSIDERATION	\$0
Notes: Second floor is for staff only.		
State: -		
Federal: -		