



OREGON LIQUOR CONTROL COMMISSION LIQUOR LICENSE APPLICATION



Application is being made for:

LICENSE TYPES

- Full On-Premises Sales (\$402.60/yr)
 - Commercial Establishment
 - Caterer
 - Passenger Carrier
 - Other Public Location
 - Private Club
- Limited On-Premises Sales (\$202.60/yr)
- Off-Premises Sales (\$100/yr)
 - with Fuel Pumps
- Brewery Public House (\$252.60)
- Winery (\$250/yr)
- Other: _____

ACTIONS

- Change Ownership
- New Outlet
- Greater Privilege
- Additional Privilege
- Other 9LOZ

P27503
L188411

CITY AND COUNTY USE ONLY

Date application received: _____

The City Council or County Commission: _____

(name of city or county)

recommends that this license be:

- Granted
- Denied

By: _____ (signature) _____ (date)

Name: _____

Title: _____

OLCC USE ONLY

Application Rec'd by: J

Date: 2-11-14

90-day authority: Yes No

90-DAY AUTHORITY

Check here if you are applying for a change of ownership at a business that has a current liquor license, or if you are applying for an Off-Premises Sales license and are requesting a 90-Day Temporary Authority

APPLYING AS:

- Limited Partnership
- Corporation
- Limited Liability Company
- Individuals

1. Entity or Individuals applying for the license: [See SECTION 1 of the Guide]

① 6000 GLISAN, INC. ③ _____
② _____ ④ _____

2. Trade Name (dba): PUTTER'S BAR & GRILL

3. Business Location: 7305 SE WOODSTOCK PTLO. MULT OR 97206
(number, street, rural route) (city) (county) (state) (ZIP code)

4. Business Mailing Address: SAME
(PO box, number, street, rural route) (city) (state) (ZIP code)

5. Business Numbers: 503 788 1950
(phone)

6. Is the business at this location currently licensed by OLCC? Yes No

7. If yes to whom: _____ Type of License: _____

8. Former Business Name: _____

9. Will you have a manager? Yes No Name: _____
(manager must fill out an Individual History form)

10. What is the local governing body where your business is located? PTLO
(name of city or county)

11. Contact person for this application: PETER GOFOETH 503 348-1522
(name) (phone number(s))
173 NE BRIDGETON RD. PTLO 97211 PETERGOETH@CS.COM
(address) (fax number) (e-mail address)

I understand that if my answers are not true and complete, the **OLCC** may deny my license application.

Applicant(s) Signature(s) and Date:

① Peter Gofoeth, Treas. Date 2/1/14 ③ FEB 11 2014 Date _____
② Melanie Gofoeth Pres. Date 2/2/14 ④ _____ Date _____

REGULATORY FIELD SERVICES
Oregon Liquor Control Commission

REGULATORY FIELD SERVICES
Oregon Liquor Control Commission

FEB 05 2014

RECEIVED

REGULATORY FIELD SERVICES
Oregon Liquor Control Commission

FEB 11 2014

RECEIVED



OREGON LIQUOR CONTROL COMMISSION
BUSINESS INFORMATION

Please Print or Type

Applicant Name: 6000 GLISAN, INC. Phone: 503 348 1522

Trade Name (dba): POTTER'S Bar & Grill

Business Location Address: 7305 SE WOODSTOCK

City: PTLD ZIP Code: 97206

DAYS AND HOURS OF OPERATION

Business Hours:

Sunday	<u>11:30^{AM}</u> to <u>2:30AM</u>
Monday	_____ to _____
Tuesday	_____ to _____
Wednesday	_____ to _____
Thursday	_____ to _____
Friday	_____ to _____
Saturday	_____ to _____

Outdoor Area Hours:

Sunday	<u>11:30AM</u> to <u>9 PM</u>
Monday	_____ to _____
Tuesday	_____ to _____
Wednesday	_____ to _____
Thursday	_____ to _____
Friday	_____ to _____
Saturday	_____ to _____

The outdoor area is used for:

Food service Hours: 11:30AM to 9PM

Alcohol service Hours: " to "

Enclosed, how PATIO w/ FENCE

The exterior area is adequately viewed and/or supervised by Service Permittees.

_____ (Investigator's Initials)

Seasonal Variations: Yes No If yes, explain: _____

ENTERTAINMENT

Check all that apply:

<input type="checkbox"/> Live Music	<input type="checkbox"/> Karaoke
<input checked="" type="checkbox"/> Recorded Music	<input checked="" type="checkbox"/> Coin-operated Games
<input type="checkbox"/> DJ Music	<input checked="" type="checkbox"/> Video Lottery Machines <i>not yet</i>
<input type="checkbox"/> Dancing	<input type="checkbox"/> Social Gaming
<input type="checkbox"/> Nude Entertainers	<input checked="" type="checkbox"/> Pool Tables
	<input type="checkbox"/> Other: _____

DAYS & HOURS OF LIVE OR DJ MUSIC

Sunday	_____ to _____
Monday	_____ to _____
Tuesday	_____ to _____
Wednesday	_____ to _____
Thursday	_____ to _____
Friday	_____ to _____
Saturday	_____ to _____

SEATING COUNT

Restaurant: 30 Outdoor: 20

Lounge: 20 Other (explain): _____

Banquet: _____ Total Seating: 70

OLCC USE ONLY

Investigator Verified Seating: ___(Y)___(N)

Investigator Initials: _____

Date: _____

I understand if my answers are not true and complete, the OLCC may deny my license application.

Applicant Signature: Peter G. Patti Date: 2/1/14



OREGON LIQUOR CONTROL COMMISSION
CORPORATION QUESTIONNAIRE

Please Print or Type

Corporation Name: 6000 GLISAN, INC. Year Incorporated: 1985
 Trade Name (dba): POTTER'S BAR & GRILL
 Business Location Address: 7305 SE WOODSTOCK BLVD.
 City: PORTLAND ZIP Code: 97206

List Corporate Officers:

(name)	<u>WILLENE GOFORTH</u>	<u>PRES</u>
	<u>PETER GOFORTH</u>	<u>SEC-TREAS</u>

List Board of Directors:

(name)	<u>WILLENE GOFORTH</u>
	<u>PETER GOFORTH</u>

List Stockholders: (Note: If any stockholder is another legal entity, that entity may also need to complete another Corporation Questionnaire. See Liquor License Application Guide for more information.)

Stockholders:	Number of Shares Held:	Number of Stock Shares:
<u>WILLENE GOFORTH</u>	<u>50</u>	Issued: <u>100</u>
<u>PETER GOFORTH</u>	<u>50</u>	Unissued: <u>-</u>
		Total Shares Authorized to Issue: <u>100</u>

Server Education Designee: NICK PECK DOB: 5/4/77
 (See Liquor License Application Guide for more information)

I understand that if my answers are not true and complete, the OLCC may deny my license application.
 Officer's Signature: Peter Goforth (name) Sec-Treas (title) Date: 2/7/14

CITY OF PORTLAND LIQUOR OUTLET INFORMATION FORM

Submit to: Theresa Marchetti, Office of Neighborhood Involvement, 1221 SW 4th Av, Ste 110, Portland, OR 97204
(503) 823-3092

City Endorsement Fees are payable at the beginning of the application process: New outlets are \$100.00. All others are \$75.00. Make checks payable to the City of Portland. **You must include the OLCC Liquor Application form, *initialed by your OLCC License Investigator* and all OLCC Individual History forms.** All blanks must be filled in. If the question does not apply, write "N/A" in the space. **All persons who are anticipated to have a financial interest and key personnel must complete City of Portland Personal History forms.** On New Outlet applications, property owners within 300 feet of the location, the Portland Police Bureau and all interested parties are notified by mail (with a copy of this form) and given an opportunity to comment on your application. The OLCC allows the City at least 45 days to complete the recommendation process. A City liquor endorsement is not a confirmation that the property is properly zoned. Call 823-7526 to confirm that the property is properly zoned.

Legal Name of Business: 6000 GLISAN INC.	
DBA or Trade Name: PATTER'S BAR & GRILL	Phone: 503-348-1522
Business Address, including Zip Code 7305 SE WOODSTOCK 97206	
What type of liquor license are you applying for? (Change owner, new outlet, beer & wine, etc.) NEW OUTLET	
Contact person: GOFORTH	Contact phone 503 348 1522 E-mail: PeterGo4th@CS.Com

Please note: New Outlet Package Stores may be subject to the Convenience Store Review process through the Planning Bureau. Call 823-7526 for applicable information, regulations and forms.

DESCRIPTION OF OUTLET:

Type of Operation: (Check all that apply) <input type="checkbox"/> Food Cart/Food Cart Pod <input checked="" type="checkbox"/> Restaurant <input checked="" type="checkbox"/> Sports bar <input type="checkbox"/> Tavern	<input type="checkbox"/> Night Club <input type="checkbox"/> Convenience Store <input type="checkbox"/> Other (Please Describe _____)	Size of Service area: 700 Ft² Existing Building: (circle) YES NO Zoning: CS Structural Changes: (describe): : NONE
---	---	---

Seating Capacity: Restaurant **30** Lounge/Bar **20** Outside Sidewalk ___ Outside patio **20**

Will you be seeking a sidewalk café permit? YES NO - Date Obtained/Applied for / /

Describe Security: **ALARM SYSTEM**

Has an application for a liquor license at this location been received by the City of Portland in the last 2 years? yes no don't know

HOURS OF OPERATION

Sunday through Thursday open **11:30** close **2:30AM** Friday & Saturday open **11:30AM** close **2:30AM**

How late will you have outside seating? **9pm** How late will you have entertainment? **NONE**

HISTORY OF LOCATION

Previous Business Name of this location: **BARKLEY'S FLOWER SHOP**

Name and Address of Property Owner: **PETERGOFORTH TRUST 538 SE BRIDGETON RD. #18 PORTLAND 97211**

ENTERTAINMENT:

<input type="checkbox"/> Dancing <input type="checkbox"/> Karaoke <input type="checkbox"/> Live Music <input checked="" type="checkbox"/> Recorded Music	<input checked="" type="checkbox"/> Video Poker <input type="checkbox"/> Video games/Pinball <input type="checkbox"/> Social Gaming <input type="checkbox"/> Pool Tables (If yes, how many?)	<input type="checkbox"/> Nude Dancers <input type="checkbox"/> DJ Entertainment <input type="checkbox"/> Events (describe) _____ <input type="checkbox"/> Other (describe) _____
---	---	---

The City requires an **Amusement Location Permit** for all locations with amusement devices or pool tables. **Contact the Revenue Bureau for rules and an Amusement Location Permit application form now.** Permits are non-transferable from one owner to another and must be paid before games are placed on the premises. Contact Anne Holm at 503-865-2488.

Use this area to provide any additional information that you wish to be considered on this liquor application.

We are proposing to move Patters from 45th & Woodstock to new location - New Seasons Store is being built in our old location

A false answer or omission of any requested information may result in an unfavorable City recommendation.

Signature: **Peter Goforth** Date: **2/7/14**



Scale: 1" = 176' BES Unit ID

Property Search

Owner Name: BARKLEY, SAM FLORAL
 Site Address: 7305 SE WOODSTOCK BLVD
 State ID: 1S2E17D8 11300
 Account #: P405918

Geocode Address When Taxlot Not Found
 Search is Based on Active Field Only
 Display Taxlot Detail Window

Navigate Query Results

Owner: BARKLEY, SAM FLORAL Site Address: 7305 SE WOOD... State: 1S2E17D8
 GOFORTH, PETE... Site Address: 7305 SE WOOD... State: 1S2E17D8

Bureau of Development Services
 1900 SW 4th Ave. Suite 5000
 Portland, OR 97201

Retail Sales/Service
allowed in CSb
E. Sandy 2.19.14

Search Legend Add Data Selection

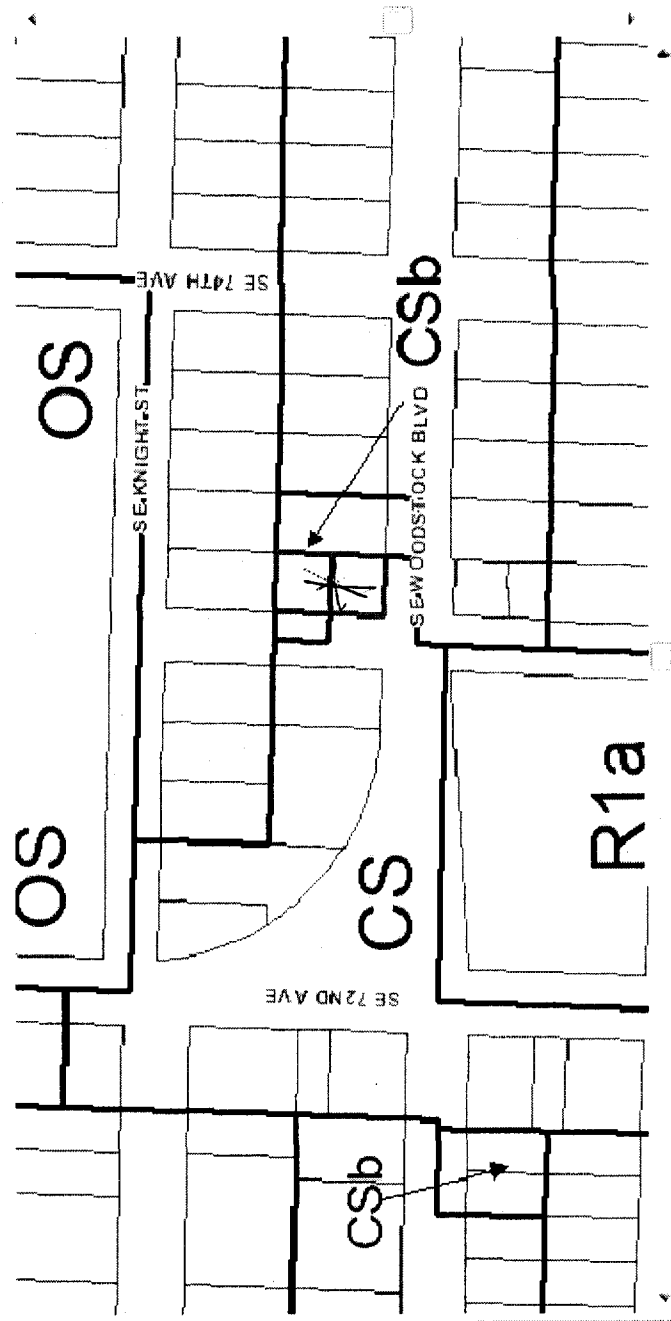

Taxlot Details

Lot Size: Building Size: Map Number: 3638 Zoning Code(s): CS CSb
 Legal Description: CORVALLIS BLK 14 Lot & Block: Historic District:
 Conservation District:
 Mailing Information: BARKLEY, SAM FLORAL 7305 SE WOODSTOCK BLVD PORTLAND, OR 97206
 Jurisdiction: Portland
 NRMP: Draw LUR

Scale 1 inch = 176 feet