



# OREGON LIQUOR CONTROL COMMISSION LIQUOR LICENSE APPLICATION



Application is being made for:

### LICENSE TYPES

- Full On-Premises Sales (\$402.60/yr)
  - Commercial Establishment
  - Caterer
  - Passenger Carrier
  - Other Public Location
  - Private Club
- Limited On-Premises Sales (\$202.60/yr)
- Off-Premises Sales (\$100/yr)
  - with Fuel Pumps
- Brewery Public House (\$252.60)
- Winery (\$250/yr)
- Other: \_\_\_\_\_

### ACTIONS

- Change Ownership
- New Outlet
- Greater Privilege
- Additional Privilege
- Other \_\_\_\_\_

### CITY AND COUNTY USE ONLY

Date application received: \_\_\_\_\_

The City Council or County Commission:

(name of city or county)

recommends that this license be:

- Granted
- Denied

By: \_\_\_\_\_  
(signature) (date)

Name: \_\_\_\_\_

Title: \_\_\_\_\_

### OLCC USE ONLY

Application Rec'd by: [Signature]

Date: 2-27-14

90-day authority:  Yes  No  
Rec'd by Portland  
Liquor Licenses

1. Entity or individuals applying for the license: [See SECTION 1 of the Guide]

① NARUMOL POONSUKWATTANA ③ MAR 04 2014

② Nong's Khao Man Gai LLC ④ PD 100.00  
# 3212 clt [Signature]

2. Trade Name (dba): NONG'S KHAO MAN GAI LLC

3. Business Location: 609 SE ANKENY ST, SUITE C PORTLAND MULTNOMAH OREGON 97214  
(number, street, rural route) (city) (county) (state) (ZIP code)

4. Business Mailing Address: 3583 SE LINCOLN ST PORTLAND OR 97214  
(PO box, number, street, rural route) (city) (state) (ZIP code)

5. Business Numbers: 503-740-2907  
(phone) (fax)

6. Is the business at this location currently licensed by OLCC?  Yes  No

7. If yes to whom: \_\_\_\_\_ Type of License: \_\_\_\_\_

8. Former Business Name: \_\_\_\_\_

9. Will you have a manager?  Yes  No Name: JAMES DE MARTINI  
(manager must fill out an Individual History form)

10. What is the local governing body where your business is located? MULTNOMAH  
(name of city or county)

11. Contact person for this application: NARUMOL POONSUKWATTANA 503-740-2907  
(name) (phone number(s))  
3583 SE LINCOLN ST, PORTLAND, OR 97214 NONG@KMGPD.COM  
(address) (fax number) (e-mail address)

I understand that if my answers are not true and complete, the OLCC may deny my license application.

Applicant(s) Signature(s) and Date:

① [Signature] Date 2/19/2014 ③ \_\_\_\_\_ Date \_\_\_\_\_

② \_\_\_\_\_ Date \_\_\_\_\_ ④ \_\_\_\_\_ Date \_\_\_\_\_



# OREGON LIQUOR CONTROL COMMISSION BUSINESS INFORMATION

Please Print or Type Nongs Khao Man Gai LLC

Applicant Name: NARUMOL POONSUKWATTANA Phone: 503-740-2907

Trade Name (dba): NONG'S KHAO MAN GAI

Business Location Address: 609 SE ANKENY ST, SUITE C

City: PORTLAND, OREGON ZIP Code: 97214

### DAYS AND HOURS OF OPERATION

#### Business Hours:

Sunday	<u>11AM</u> to <u>9PM</u>
Monday	<u>11AM</u> to <u>9PM</u>
Tuesday	<u>11AM</u> to <u>9PM</u>
Wednesday	<u>11AM</u> to <u>9PM</u>
Thursday	<u>11AM</u> to <u>9PM</u>
Friday	<u>11AM</u> to <u>9PM</u>
Saturday	<u>11AM</u> to <u>9PM</u>

#### Outdoor Area Hours:

Sunday	<u>11AM</u> to <u>9PM</u>
Monday	<u>11AM</u> to <u>9PM</u>
Tuesday	<u>11AM</u> to <u>9PM</u>
Wednesday	<u>11AM</u> to <u>9PM</u>
Thursday	<u>11AM</u> to <u>9PM</u>
Friday	<u>11AM</u> to <u>9PM</u>
Saturday	<u>11AM</u> to <u>9PM</u>

The outdoor area is used for:

Food service Hours: 11AM to 9PM

Alcohol service Hours: 11AM to 9PM

Enclosed, how \_\_\_\_\_

The exterior area is adequately viewed and/or supervised by Service Permittees.

\_\_\_\_\_  
(Investigator's Initials)

Seasonal Variations:  Yes  No If yes, explain: \_\_\_\_\_

### ENTERTAINMENT

Check all that apply:

- |  |   |
|--|---|
| <input type="checkbox"/> Live Music        | <input type="checkbox"/> Karaoke                |
| <input type="checkbox"/> Recorded Music    | <input type="checkbox"/> Coin-operated Games    |
| <input type="checkbox"/> DJ Music          | <input type="checkbox"/> Video Lottery Machines |
| <input type="checkbox"/> Dancing           | <input type="checkbox"/> Social Gaming          |
| <input type="checkbox"/> Nude Entertainers | <input type="checkbox"/> Pool Tables            |
|  | <input type="checkbox"/> Other: _____           |

### DAYS & HOURS OF LIVE OR DJ MUSIC

Sunday	_____ to _____
Monday	_____ to _____
Tuesday	_____ to _____
Wednesday	_____ to _____
Thursday	_____ to _____
Friday	_____ to _____
Saturday	_____ to _____

### SEATING COUNT

Restaurant: 30 Outdoor: 8

Lounge: \_\_\_\_\_ Other (explain): \_\_\_\_\_

Banquet: \_\_\_\_\_ Total Seating: 38

#### OLCC USE ONLY

Investigator Verified Seating: (Y) (N)

Investigator Initials: \_\_\_\_\_

Date: \_\_\_\_\_

I understand if my answers are not true and complete, the OLCC may deny my license application.

Applicant Signature: [Signature] Date: 2/19/14

1-800-452-OLCC (6522)

[www.oregon.gov/olcc](http://www.oregon.gov/olcc)

(rev. 12/07)

OREGON LIQUOR CONTROL COMMISSION  
LIMITED LIABILITY COMPANY QUESTIONNAIRE



Please Print or Type

LLC Name: NONG'S KHAO MAN GAI LLC Year Filed: 2011  
Trade Name (dba): NONG'S KHAO MAN GAI  
Business Location Address: 609 SE ANKENY ST SUITE C  
City: PORTLAND ZIP Code: 97214

List Members of LLC:

Percentage of Membership Interest:

1. NARUMOL POONSUKWATTANA  
(managing member)

100%

2. \_\_\_\_\_  
(members)

3. \_\_\_\_\_

4. \_\_\_\_\_

5. \_\_\_\_\_

6. \_\_\_\_\_

(Note: If any LLC member is another legal entity, that entity must also complete an LLC, Limited Partnership or Corporation Questionnaire. If the LLC has officers, please list them on a separate sheet of paper with their titles.)

Server Education Designee: NARUMOL POONSUKWATTANA DOB: 01/07/1980

I understand that if my answers are not true and complete, the OLCC may deny my license application.

Signature: Nuel Puel MANAGING MEMBER Date: 2/25/14  
(name) (title)

# CITY OF PORTLAND LIQUOR OUTLET INFORMATION FORM

Submit to: Theresa Marchetti, Office of Neighborhood Involvement, 1221 SW 4<sup>th</sup> Av, Ste 110, Portland, OR 97204

(503) 823-3092

City Endorsement Fees are payable at the beginning of the application process: New outlets are \$100.00. All others are \$75.00. Make checks payable to the City of Portland. You must include the OLCC Liquor Application form, *initialed by your OLCC License Investigator* and all OLCC Individual History forms. All blanks must be filled in. If the question does not apply, write "N/A" in the space. All persons who are anticipated to have a financial interest and key personnel must complete City of Portland Personal History forms. On New Outlet applications, property owners within 300 feet of the location, the Portland Police Bureau and all interested parties are notified by mail (with a copy of this form) and given an opportunity to comment on your application. The OLCC allows the City at least 45 days to complete the recommendation process. A City liquor endorsement is not a confirmation that the property is properly zoned. Call 823-7526 to confirm that the property is properly zoned.

Legal Name of Business: <u>NONG'S KHAO MANGAI LLC</u>	
DBA or Trade Name: <u>NONG'S KHAO MANGAI</u>	Phone: <u>503-740-2907</u> Fax: _____
Business Address, including Zip Code <u>609 SE ANKENY ST SUITE C PORTLAND OR 97214</u>	
What type of liquor license are you applying for? (Change owner, new outlet, beer & wine, etc.) <u>NEW OUTLET</u>	
Contact person: <u>NONG</u>	Contact phone: <u>503-442-1301</u> E-mail: <u>NONG@KMGPOX.COM</u>

Please note: New Outlet Package Stores may be subject to the Convenience Store Review process through the Planning Bureau. Call 823-7526 for applicable information, regulations and forms.

**DESCRIPTION OF OUTLET:**

Type of Operation: ( Check all that apply ) <input type="checkbox"/> Food Cart/Food Cart Pod <input checked="" type="checkbox"/> Restaurant <input type="checkbox"/> Sports bar <input type="checkbox"/> Tavern	<input type="checkbox"/> Night Club <input type="checkbox"/> Convenience Store <input type="checkbox"/> Other (Please Describe _____)	Size of Service area: _____ Existing Building: (circle) YES / NO Zoning: _____ Structural Changes: (describe): :
---	---	---

Seating Capacity: Restaurant 30 Lounge/Bar \_\_\_\_\_ Outside Sidewalk 6 Outside patio \_\_\_\_\_  
 Will you be seeking a sidewalk café permit? (YES) / NO - Date Obtained/Applied for 03/07/2014

Describe Security: DOOR  
 Has an application for a liquor license at this location been received by the City of Portland in the last 2 years?  yes  no  don't know

**HOURS OF OPERATION**  
 Sunday through Thursday open 11AM close 9PM Friday & Saturday open 11AM close 9PM  
 How late will you have outside seating? 9PM How late will you have entertainment? \_\_\_\_\_

**HISTORY OF LOCATION**  
 Previous Business Name of this location: ORIGAMI CATERING  
 Name and Address of Property Owner: Pitman Properties IV, LLC 1535 SE Third Ave, Portland, OR 97214

**ENTERTAINMENT:**

<input type="checkbox"/> Dancing <input type="checkbox"/> Karaoke <input type="checkbox"/> Live Music <input type="checkbox"/> Recorded Music	<input type="checkbox"/> Video Poker <input type="checkbox"/> Video games/Pinball <input type="checkbox"/> Social Gaming <input type="checkbox"/> Pool Tables (If yes, how many?)	<input type="checkbox"/> Nude Dancers <input type="checkbox"/> DJ Entertainment <input type="checkbox"/> Events (describe) _____ <input type="checkbox"/> Other (describe) _____
--	--	---

The City requires an **Amusement Location Permit** for all locations with amusement devices or pool tables. **Contact the Revenue Bureau for rules and an Amusement Location Permit application form now.** Permits are non-transferable from one owner to another and must be paid before games are placed on the premises. Contact Anne Holm at 503-865-2488.

Use this area to provide any additional information that you wish to be considered on this liquor application.

---



---

**A false answer or omission of any requested information may result in an unfavorable City recommendation.**

Signature: Nue PRO Date: 03/04/2014



Scale: 1" = 135'

BES UNIT ID

Property Search

Owner Name ABBY'S TABLE LLC C/O ABIGAIL F.

Site Address

State ID INJE35CC 1300

Account # P642274

Search Clear PortlandMaps

Geocode Address When Taxlot Not Found

Search is Based on Active Field Only

Hide Personal Property Accounts

Display Taxlot Detail Window

Navigate Query Results



Owner Site Address State

ABBY'S TABLE LLC 609 SE ANKENY ST INJE3

DIR PROPERTIE... 609 SE ANKENY ST INJE3

PACIFIC PIE CO... INJE3

City of Portland

Bureau of Development Services

Land Use Service Division

1900 SW 4th Ave, Suite 500C

Portland, OR 97201

*Retail Sales/Service allowed in EXd*  
*Sanbury 3.4.14*

Search Legend Add Data Selection

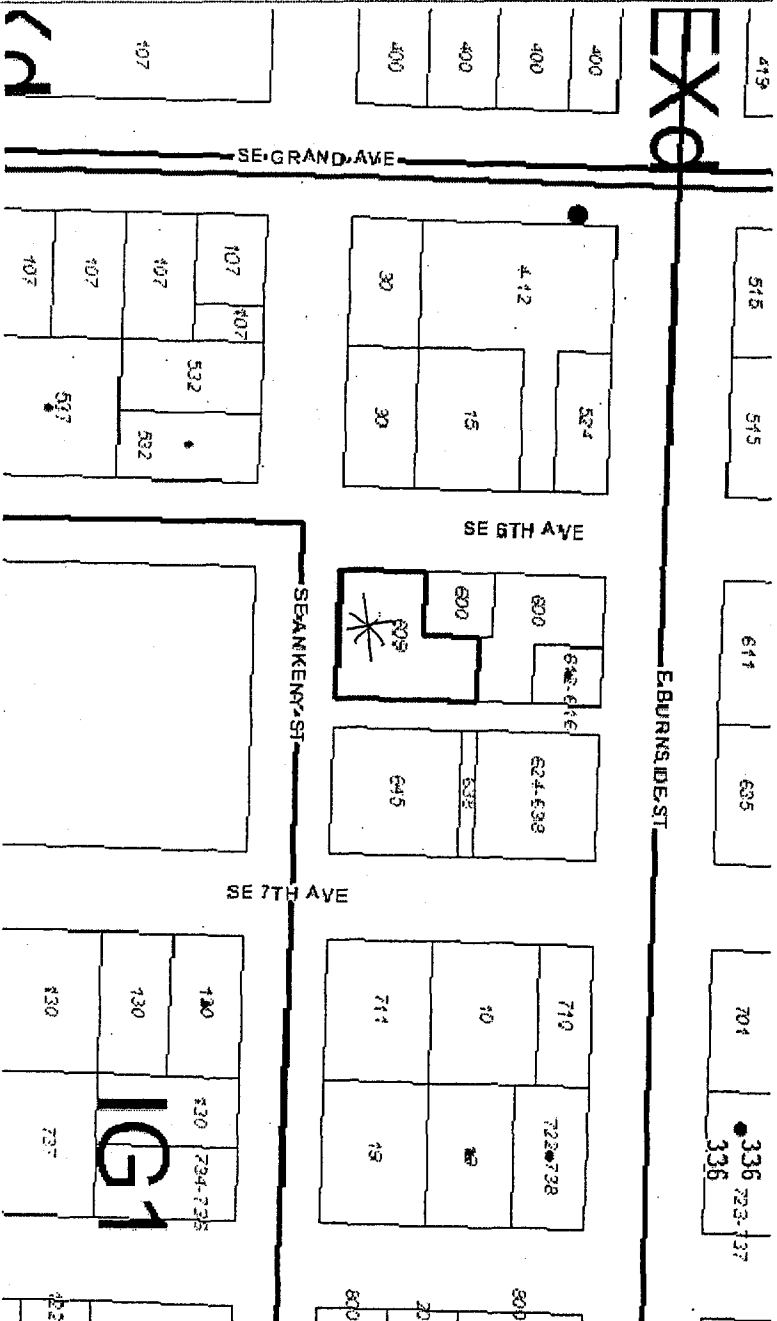

Taxlot Details

Lot Size: Building Size: Map Number: Zoning Code(s):

107 3031 EXd

Legal Description: Lot & Block:

EAST PORTLAND BLK 146

Historic District: Conservation District:

Central Eastside

Mailing Information: Jurisdiction:

ABBY'S TABLE LLC C/O ABIGAIL FARMARTINO  
609 SE ANKENY ST SITE A  
PORTLAND, OR 97214  
Portland

Plan District: Tax Map: Zon:

CENTRAL CITY

Subdistrict: LUR Case His

CENTRAL EASTSIDE LU 10-1433

SubArea: E

NDMP: Draw LUR

Scale 1 inch = 135 feet