



# OREGON LIQUOR CONTROL COMMISSION LIQUOR LICENSE APPLICATION

Application is being made for:

### LICENSE TYPES

- Full On-Premises Sales (\$402.60/yr)
  - Commercial Establishment
  - Caterer
  - Passenger Carrier
  - Other Public Location
  - Private Club
- Limited On-Premises Sales (\$202.60/yr)
- Off-Premises Sales (\$100/yr)
  - with Fuel Pumps
- Brewery Public House (\$252.60)
- Winery (\$250/yr)
- Other: \_\_\_\_\_

### ACTIONS

- Change Ownership
  - New Outlet
  - Greater Privilege
  - Additional Privilege
  - Other \_\_\_\_\_

# 188190(L)  
# 50744(P)

### 90-DAY AUTHORITY

Check here if you are applying for a change of ownership at a business that has a current liquor license, or if you are applying for an Off-Premises Sales license and are requesting a 90-Day Temporary Authority

### APPLYING AS:

- Limited Partnership
- Corporation
- Limited Liability Company
- Individuals

### CITY AND COUNTY USE ONLY

Date application received: \_\_\_\_\_

The City Council or County Commission:

(name of city or county)

recommends that this license be:

- Granted
- Denied

By: \_\_\_\_\_ (signature) \_\_\_\_\_ (date)

Name: \_\_\_\_\_

Title: \_\_\_\_\_

### OLCC USE ONLY

Application Rec'd by: CM

Date: 4/1/14

90-day authority:  Yes  No

1. Entity or Individuals applying for the license: [See SECTION 1 of the Guide]

① Hawthorne Lobster House LLC

2. Trade Name (dba): Hawthorne Lobster House

3. Business Location: 2422 SE Hawthorne Portland Multnomah OR 97214  
(number, street, rural route) (city) (county) (state) (ZIP code)

4. Business Mailing Address: SAME  
(PO box, number, street, rural route) (city) (state) (ZIP code)

5. Business Numbers: 503-231-8245 503-943-2121  
(phone) (fax)

6. Is the business at this location currently licensed by OLCC?  Yes  No Business closed 12/2013

7. If yes to whom: Township and Range Type of License: Full on premises

8. Former Business Name: Township and Range

9. Will you have a manager?  Yes  No Name: Owners will manage  
(manager must fill out an Individual History form)

10. What is the local governing body where your business is located? Multnomah  
(name of city or county)

11. Contact person for this application: Rodney Scott 503-502-6784  
(name) (phone number(s))  
2422 SE Hawthorne Portland 97214 - 503-943-2121 Rodney2007@hotmail.com  
(address) (fax number) (e-mail address)

I understand that if my answers are not true and complete, the OLCC may deny my license application.

Applicant(s) Signature(s) and Date:

① [Signature] Date 3/20/14 ③ Rodney Scott Date 3/20/14

② [Signature] Date 3/24/14 ④ Wick Scott Date 3/24/14

⑤ [Signature] Date 3/25/14

1-800-452-OLCC (6522) • www.oregon.gov/olcc

(rev. 08/20 )

Rec'd by Portland  
Liquor Licenses

APR 08 2014

PD 75.00  
\* CASH



**OREGON LIQUOR CONTROL COMMISSION  
BUSINESS INFORMATION**

Please Print or Type

Applicant Name: HAWTHORNE Lobster House LLC Phone: 503-231-8245

Trade Name (dba): Hawthorne Lobster House

Business Location Address: 2422 SE Hawthorne

City: Portland ZIP Code: 97214

**DAYS AND HOURS OF OPERATION**

**Business Hours:**

Sunday 4:30 to 10:00 pm  
 Monday 4:30 to 10:00 pm  
 Tuesday 4:30 to 10:00 pm  
 Wednesday 4:30 to 10:00 pm  
 Thursday 4:30 to 10:00 pm  
 Friday 4:30 to 10:00 pm  
 Saturday 4:30 to 10:00 pm

**Outdoor Area Hours:**

Sunday 4:30 to 9 pm  
 Monday 4:30 to 9 pm  
 Tuesday 4:30 to 9 pm  
 Wednesday 4:30 to 9 pm  
 Thursday 4:30 to 9 pm  
 Friday 4:30 to 9 pm  
 Saturday 4:30 to 9 pm

The outdoor area is used for:

Food service Hours: 4:30 to 9 pm  
 Alcohol service Hours: 4:30 to 9 pm  
 Enclosed, how \_\_\_\_\_

The exterior area is adequately viewed and/or supervised by Service Permittees.

\_\_\_\_\_  
(Investigator's Initials)

Seasonal Variations:  Yes  No If yes, explain: \_\_\_\_\_

**ENTERTAINMENT**

Check all that apply:

- Live Music
- Recorded Music
- DJ Music
- Dancing
- Nude Entertainers
- Karaoke
- Coin-operated Games
- Video Lottery Machines
- Social Gaming
- Pool Tables
- Other: \_\_\_\_\_

**DAYS & HOURS OF LIVE OR DJ MUSIC**

Sunday \_\_\_\_\_ to \_\_\_\_\_  
 Monday \_\_\_\_\_ to \_\_\_\_\_  
 Tuesday \_\_\_\_\_ to \_\_\_\_\_  
 Wednesday \_\_\_\_\_ to \_\_\_\_\_  
 Thursday \_\_\_\_\_ to \_\_\_\_\_  
 Friday \_\_\_\_\_ to \_\_\_\_\_  
 Saturday \_\_\_\_\_ to \_\_\_\_\_

**SEATING COUNT**

Restaurant: 62 Outdoor: 32  
 Lounge: 10 Other (explain): \_\_\_\_\_  
 Banquet: 40 Total Seating: 154

**OLCC USE ONLY**

Investigator Verified Seating: (M) (N)  
 Investigator Initials: \_\_\_\_\_  
 Date: \_\_\_\_\_

I understand if my answers are not true and complete, the OLCC may deny my license application.

Applicant Signature: \_\_\_\_\_ Date: \_\_\_\_\_

OREGON LIQUOR CONTROL COMMISSION  
LIMITED LIABILITY COMPANY QUESTIONNAIRE



Please Print or Type

LLC Name: Hawthorne Lobster House LLC Year Filed: 2014

Trade Name (dba): Hawthorne Lobster House

Business Location Address: 2422 SE Hawthorne

City: Portland OR ZIP Code: 97214

List Members of LLC:

Percentage of Membership Interest:

- |  |               |
|--|---------------|
| 1. <u>Rodney Scott</u><br><small>(managing member)</small> | <u>25.5 %</u> |
| 2. <u>Vicki Scott</u><br><small>(members)</small>          | <u>25.5 %</u> |
| 3. <u>April Garstin</u>                                    | <u>9%</u>     |
| 4. <u>Michelle Riesgaard</u>                               | <u>20%</u>    |
| 5. <u>Roger Mumm</u>                                       | <u>20%</u>    |
| 6. _____   | _____         |

(Note: If any LLC member is another legal entity, that entity must also complete an LLC, Limited Partnership or Corporation Questionnaire. If the LLC has officers, please list them on a separate sheet of paper with their titles.)

Server Education Designee: Michelle Riesgaard DOB: 5/22/68

I understand that if my answers are not true and complete, the OLCC may deny my license application.

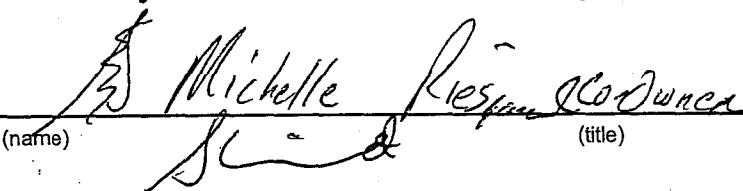
Signature:  Date: 4/1/14  
(name) (title)

# CITY OF PORTLAND LIQUOR OUTLET INFORMATION FORM

Submit to: Theresa Marchetti, Office of Neighborhood Involvement, 1221 SW 4<sup>th</sup> Av, Ste 110, Portland, OR 97204  
(503) 823-3092

City Endorsement Fees are payable at the beginning of the application process: New outlets are \$100.00. All others are \$75.00. Make checks payable to the City of Portland. You must include the OLCC Liquor Application form, *initialed by your OLCC License Investigator* and all OLCC Individual History forms. All blanks must be filled in. If the question does not apply, write "N/A" in the space. All persons who are anticipated to have a financial interest and key personnel must complete City of Portland Personal History forms. On New Outlet applications, property owners within 300 feet of the location, the Portland Police Bureau and all interested parties are notified by mail (with a copy of this form) and given an opportunity to comment on your application. The OLCC allows the City at least 45 days to complete the recommendation process. A City liquor endorsement is not a confirmation that the property is properly zoned. Call 823-7526 to confirm that the property is properly zoned.

Legal Name of Business: Hawthorne Lobster House LLC

DBA or Trade Name: Hawthorne Lobster House Phone: 503-231-8245 Fax: \_\_\_\_\_

Business Address, including Zip Code 2422 SE Hawthorne

What type of liquor license are you applying for? (Change owner, new outlet, beer & wine, etc.) Change owner

Contact person: Michelle Riesgaard Contact phone: 503-314-6617 E-mail: ShellyRiesgaard@gmail.com

Please note: New Outlet Package Stores may be subject to the Convenience Store Review process through the Planning Bureau. Call 823-7526 for applicable information, regulations and forms.

**DESCRIPTION OF OUTLET:**

Type of Operation: ( Check all that apply ) <input type="checkbox"/> Food Cart/Food Cart Pod <input checked="" type="checkbox"/> Restaurant <input type="checkbox"/> Sports bar <input type="checkbox"/> Tavern	<input type="checkbox"/> Night Club <input type="checkbox"/> Convenience Store <input type="checkbox"/> Other (Please Describe _____)	Size of Service area: _____ Existing Building: (circle) <u>YES</u> / NO Zoning: _____ Structural Changes: (describe): : _____
---	---	--

Seating Capacity: Restaurant 102 Lounge/Bar 10 Outside Sidewalk \_\_\_\_\_ Outside patio 30

Will you be seeking a sidewalk café permit? YES (NO) Date Obtained/Applied for:  / /

Describe Security: 24 Hour Response Security System

Has an application for a liquor license at this location been received by the City of Portland in the last 2 years?  yes  no  don't know

**HOURS OF OPERATION**

Sunday through Thursday open 4:30 pm close 10:00 pm Friday & Saturday open 4:30 pm close 10:00 pm

How late will you have outside seating? Stop seating @ 9:00 pm How late will you have entertainment? N/A

**HISTORY OF LOCATION**

Previous Business Name of this location: Township and Range

Name and Address of Property Owner: 2422 Street LLC

**ENTERTAINMENT:**

<input type="checkbox"/> Dancing <input type="checkbox"/> Karaoke <input type="checkbox"/> Live Music <input type="checkbox"/> Recorded Music	<input type="checkbox"/> Video Poker <input type="checkbox"/> Video games/Pinball <input type="checkbox"/> Social Gaming <input type="checkbox"/> Pool Tables (if yes, how many?)	<input type="checkbox"/> Nude Dancers <input type="checkbox"/> DJ Entertainment <input type="checkbox"/> Events (describe) _____ <input type="checkbox"/> Other (describe) _____
--	--	---

The City requires an Amusement Location Permit for all locations with amusement devices or pool tables. Contact the Revenue Bureau for rules and an Amusement Location Permit application form now. Permits are non-transferable from one owner to another and must be paid before games are placed on the premises. Contact Anne Holm at 503-865-2488.

Use this area to provide any additional information that you wish to be considered on this liquor application.

A false answer or omission of any requested information may result in an unfavorable City recommendation.

Signature: [Signature] Date: 4/1/14

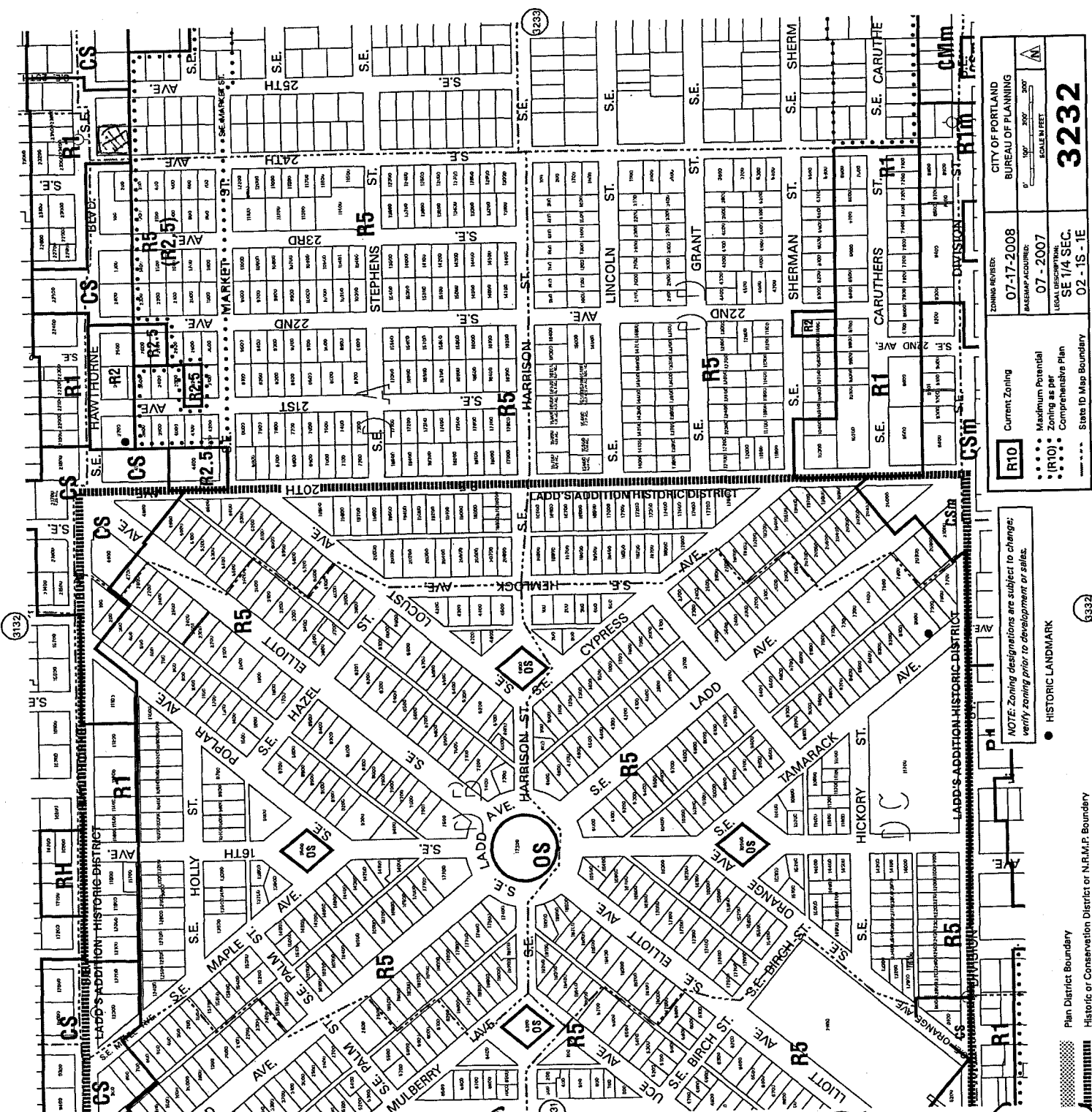

ZONING REVISION:	07-17-2008	CITY OF PORTLAND
BASEMAP ACQUIRED:	07 - 2007	BUREAU OF PLANNING
LEGAL DESCRIPTION:	SE 1/4 SEC.	
SCALE:	1" = 100'	
DATE:	02 - 15 - 1E	
		SCALE IN FEET
		<b>3232</b>

**R10** Current Zoning

- Medium Density Multi Dwelling
- Zoning as per
- Comprehensive Plan
- State ID Map Boundary

NOTE: Zoning designations are subject to change; verify zoning prior to development or sales.

• HISTORIC LANDMARK

Plan District Boundary  
 Historic or Conservation District or N.R.M.P. Boundary  
 Zoning Line

*Defines the Site*

*Questions: Contact Planning (BDS) 503-823-2877 K. Jennings*

*Zoning: R1 - Medium Density Multi Dwelling*  
*Retail Sales & Service Use is a legal*  
*Nonconforming Use at this site. Nonconforming Uses may*  
*continue to operate. Changes in operations are allowed*  
*however, nonconforming uses in residential zones may*  
*operations into the period of 11PM to 6*

Bureau of Development Services  
 1900 SW 4th Ave. Suite 5000  
 Portland, OR 97201 4/8/2014