



OREGON LIQUOR CONTROL COMMISSION LIQUOR LICENSE APPLICATION

Application is being made for:

LICENSE TYPES

- Full On-Premises Sales (\$402.60/yr)
 - Commercial Establishment
 - Caterer
 - Passenger Carrier
 - Other Public Location
 - Private Club
- Limited On-Premises Sales (\$202.60/yr)
- Off-Premises Sales (\$100/yr)
 - with Fuel Pumps
- Brewery Public House (\$252.60)
- Winery (\$250/yr)
- Other: _____

ACTIONS

- Change Ownership
- New Outlet
- Greater Privilege
- Additional Privilege
- Other _____

*L# 195784
P# 715*

90-DAY AUTHORITY

Check here if you are applying for a change of ownership at a business that has a current liquor license, or if you are applying for an Off-Premises Sales license and are requesting a 90-Day Temporary Authority

APPLYING AS:

- Limited Partnership
- Corporation
- Limited Liability Company
- Individuals

CITY AND COUNTY USE ONLY

Date application received: _____

The City Council or County Commission:

(name of city or county)

recommends that this license be:

- Granted
- Denied

By: _____
(signature) (date)

Name: _____

Title: _____

OLCC USE ONLY

Application Rec'd by: *CM*

Date: *4-9-14*

90-day authority: Yes No

1. Entity or Individuals applying for the license: [See SECTION 1 of the Guide]

① BREKKEN, LLC ③ _____

② _____ ④ _____

2. Trade Name (dba): The New Portland Rose Restuarant & Lounge

3. Business Location: 8728 North Lombard St Portland Multnomah Oregon 97203
(number, street, rural route) (city) (county) (state) (ZIP code)

4. Business Mailing Address: 2930 NW McDaniel Rd Portland Oregon 97229
(PO box, number, street, rural route) (city) (state) (ZIP code)

5. Business Numbers: 503-997-6523
(phone) (fax)

6. Is the business at this location currently licensed by OLCC? Yes No

7. If yes to whom: Heather Yee of Yee Investments Type of License: Full Service on Premise

8. Former Business Name: The New Portland Rose Restuarant and Lounge

9. Will you have a manager? Yes No Name: _____
(manager must fill out an Individual History form)

10. What is the local governing body where your business is located? City of Portland County of Multnomah
(name of city or county)

11. Contact person for this application: Laurie Lee Brekken 503-997-6523
(name) (phone number(s))
2930 NW McDaniel Rd Portland, Oregon 97229 na LaurieBrekken@gmail.com
(address) (fax number) (e-mail address)

I understand that if my answers are not true and complete, the OLCC may deny my license application.

Applicant(s) Signature(s) and Date:

① *Laurie Lee Brekken* Date 4-1-2014 ③ _____

② _____ Date _____ ④ _____

*Rec'd by Portland
Liquor Licenses*

APR 17 2014

*PD 75.00
12.00*



OREGON LIQUOR CONTROL COMMISSION
BUSINESS INFORMATION

Please Print or Type

Applicant Name: Laurie Lee Brekken for Brekken LLC Phone: 503-997-6523

Trade Name (dba): The New Portland Rose

Business Location Address: 8728 N. Lombard

City: Portland ZIP Code: 97203

DAYS AND HOURS OF OPERATION

Business Hours:

Sunday 7:30 AM to 2:30 AM
Monday 7:30 AM to 2:30 AM
Tuesday 7:30 AM to 2:30 AM
Wednesday 7:30 AM to 2:30 AM
Thursday 7:30 AM to 2:30 AM
Friday 7:30 AM to 2:30 AM
Saturday 7:30 AM to 2:30 AM

Outdoor Area Hours:

Sunday See to
Monday Below to
Tuesday to
Wednesday to
Thursday to
Friday to
Saturday to

The outdoor area is used for:

- Food service Hours: NA to
Alcohol service Hours: to
Enclosed, how

The exterior area is adequately viewed and/or supervised by Service Permittees.

(Investigator's Initials)

The outdoor area is in back for smoking - No seating

Seasonal Variations: Yes No If yes, explain:

ENTERTAINMENT

Check all that apply:

- Live Music Karaoke
Recorded Music Coin-operated Games
DJ Music Video Lottery Machines
Dancing Social Gaming
Nude Entertainers Pool Tables
Other: Magic Shows

DAYS & HOURS OF LIVE OR DJ MUSIC

Sunday 2 pm to 4 pm
Monday to
Tuesday to
Wednesday to
Thursday 9 to 12 AM
Friday 9 PM to 12 AM
Saturday 2 pm to 4 pm AND 9 pm to 12 AM

SEATING COUNT

Restaurant: 48 Outdoor:
Lounge: 20 Other (explain):
Banquet: 0 Total Seating: 68 / 102 future
(at this time) will be 34 approx

OLCC USE ONLY
Investigator Verified Seating: (Y) (N)
Investigator Initials:
Date:

I understand if my answers are not true and complete, the OLCC may deny my license application.

Applicant Signature: Laurie Brekken Date: 4-4-2014

OREGON LIQUOR CONTROL COMMISSION
LIMITED LIABILITY COMPANY QUESTIONNAIRE



Please Print or Type

LLC Name: BREKKEN, LLC Year Filed: 2014

Trade Name (dba): THE NEW PORTLAND ROSE

Business Location Address: 8728 N LOMBARD

City: PORTLAND ZIP Code: 97203

List Members of LLC:

Percentage of Membership Interest:

- 1. LAURIE LEE BREKKEN
(managing member)
- 2. _____
(members)
- 3. _____
- 4. _____
- 5. _____
- 6. _____

100

(Note: If any LLC member is another legal entity, that entity must also complete an LLC, Limited Partnership or Corporation Questionnaire. If the LLC has officers, please list them on a separate sheet of paper with their titles.)

Server Education Designee: LAURIE LEE BREKKEN DOB: 02/03/1961

I understand that if my answers are not true and complete, the OLCC may deny my license application.

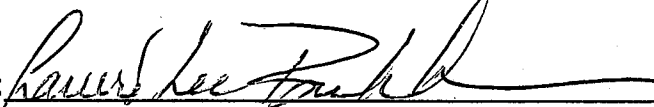
Signature:  Date: 04-04-2014
(name) (title)

CITY OF PORTLAND LIQUOR OUTLET INFORMATION FORM

Submit to: Theresa Marchetti, Office of Neighborhood Involvement, 1221 SW 4th Av, Ste 110, Portland, OR 97204

(503) 823-3092

City Endorsement Fees are payable at the beginning of the application process: New outlets are \$100.00. All others are \$75.00. Make checks payable to the City of Portland. You must include the OLCC Liquor Application form, *initialed by your OLCC License Investigator* and all OLCC Individual History forms. All blanks must be filled in. If the question does not apply, write "N/A" in the space. All persons who are anticipated to have a financial interest and key personnel must complete City of Portland Personal History forms. On New Outlet applications, property owners within 300 feet of the location, the Portland Police Bureau and all interested parties are notified by mail (with a copy of this form) and given an opportunity to comment on your application. The OLCC allows the City at least 45 days to complete the recommendation process. A City liquor endorsement is not a confirmation that the property is properly zoned. Call 823-7526 to confirm that the property is properly zoned.

Legal Name of Business: <u>Brekken LLC</u>		
DBA or Trade Name: <u>The New Portland Rose Resturant and Lounge</u>	Phone: <u>503-997-6523</u>	Fax: <u>na</u>
Business Address, including Zip Code <u>8728 N Lombard Portland, Oregon 97203</u>		
What type of liquor license are you applying for? (Change owner, new outlet, beer & wine, etc.) <u>Change of Ownership</u>		
Contact person: <u>Laurie Brekken</u>	Contact phone: <u>503-997-6523</u>	E-mail: <u>LaurieBrekken@gmail.com</u>

Please note: New Outlet Package Stores may be subject to the Convenience Store Review process through the Planning Bureau. Call 823-7526 for applicable information, regulations and forms.

DESCRIPTION OF OUTLET:

Type of Operation: (Check all that apply) <input type="checkbox"/> Food Cart/Food Cart Pod <input checked="" type="checkbox"/> Restaurant <input type="checkbox"/> Sports bar <input checked="" type="checkbox"/> Tavern	<input type="checkbox"/> Night Club <input type="checkbox"/> Convenience Store <input type="checkbox"/> Other (Please Describe)	Size of Service area: <u>4500 sq ft</u> Existing Building: <u>YES</u> Zoning: <u>commercial</u> Structural Changes: (describe) :
----------------------------------------------------------------------------------------------------------------------------------------------------------------------------------------------------------------------------------------	---------------------------------------------------------------------------------------------------------------------------------------	-------------------------------------------------------------------------------------------------------------------------------------------

Seating Capacity: Restaurant 64 Lounge/Bar 36 Outside Sidewalk na Outside patio na
 Will you be seeking a sidewalk café permit? NO – Date Obtained/Applied for _____
 Describe Security: cameras throughout business (interior & exterior) and well trained service professionals
 Has an application for a liquor license at this location been received by the City of Portland in the last 2 years? NO

HOURS OF OPERATION

Sunday through Thursday open 7:30 am close 2:30 am Friday & Saturday open 7:30 am close 2:30 am
 How late will you have outside seating? no How late will you have entertainment? 12 am

HISTORY OF LOCATION

Previous Business Name of this location: The New Portland Rose
 Name and Address of Property Owner: Heather Yee of Yee Investments 8800 N Lombard Portland, Oregon 97203

ENTERTAINMENT:

<input checked="" type="checkbox"/> Dancing <input checked="" type="checkbox"/> Karaoke <input checked="" type="checkbox"/> Live Music <input checked="" type="checkbox"/> Recorded Music	<input checked="" type="checkbox"/> Video Poker <input type="checkbox"/> Video games/Pinball <input type="checkbox"/> Social Gaming <input type="checkbox"/> Pool Tables (If yes, how many?)	<input type="checkbox"/> Nude Dancers <input type="checkbox"/> DJ Entertainment <input type="checkbox"/> Events (describe) _____ <input checked="" type="checkbox"/> Other (describe) <u>magic shows</u>
----------------------------------------------------------------------------------------------------------------------------------------------------------------------------------------------------	-------------------------------------------------------------------------------------------------------------------------------------------------------------------------------------------------------	-------------------------------------------------------------------------------------------------------------------------------------------------------------------------------------------------------------------

The City requires an **Amusement Location Permit** for all locations with amusement devices or pool tables. **Contact the Revenue Bureau for rules and an Amusement Location Permit application form now.** Permits are non-transferable from one owner to another and must be paid before games are placed on the premises. Contact Anne Holm at 503-865-2488.

Use this area to provide any additional information that you wish to be considered on this liquor application.

There is a rented pool table in bar now, I will not be keeping it. There are numerous changes I want to make. One of the biggest is to make it a family friendly eating and entertainment gathering spot. I look forward to working closely with the community to make it a safe, fun, friendly, place for all ages to visit. It's been a dream of mine for years to transform the New Portland Rose into a diner that folks are not afraid to go in! My years of experience make me confident I can make that happen.

A false answer or omission of any requested information may result in an unfavorable City recommendation.

Signature: Laurie Brekken Date: April 10th, 2014

City of Portland
 Bureau of Development Services
 Land Use Service Division
 1900 SW 4th Ave. Suite 5000
 Portland, OR 97201

K. States
 4/17/14

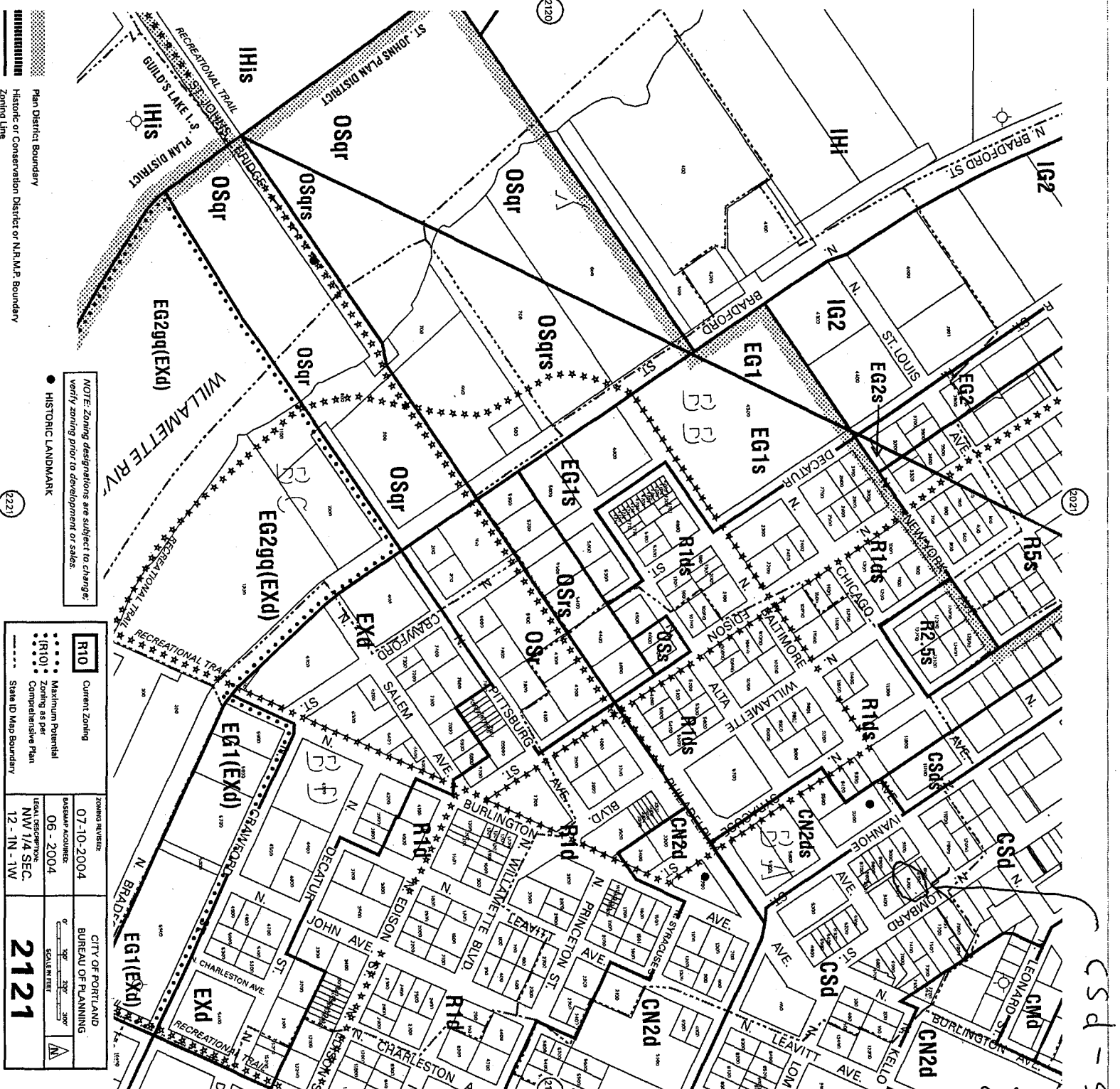

CSD - storefront
 Commercial
 design
 overlay
 CS
 Allotons
 Retail
 street
 service,
 including
 restaurants,
 bars and
 taverns