



OREGON LIQUOR CONTROL COMMISSION LIQUOR LICENSE APPLICATION

Application is being made for:

LICENSE TYPES

- Full On-Premises Sales (\$402.60/yr)
 - Commercial Establishment
 - Caterer
 - Passenger Carrier
 - Other Public Location
 - Private Club
- Limited On-Premises Sales (\$202.60/yr)
- Off-Premises Sales (\$100/yr)
 - with Fuel Pumps
- Brewery Public House (\$252.60)
- Winery (\$250/yr)
- Other: _____

ACTIONS

- Change Ownership
- New Outlet
- Greater Privilege
- Additional Privilege
- Other _____

Rec'd by **Portland**
Liquor Licenses

APR 25 2014

PD 100⁰⁰-ms
1014410140

90-DAY AUTHORITY

Check here if you are applying for a change of ownership at a business that has a current liquor license, or if you are applying for an Off-Premises Sales license and are requesting a 90-Day Temporary Authority

APPLYING AS:

- Limited Partnership
- Corporation
- Limited Liability Company
- Individuals

CITY AND COUNTY USE ONLY

Date application received: _____

The City Council or County Commission:

(name of city or county)

recommends that this license be:

- Granted
- Denied

By: _____
(signature) (date)

Name: _____

Title: _____

OLCC USE ONLY

Application Rec'd by: CAO

Date: 4/24/14

90-day authority: Yes No

1. Entity or Individuals applying for the license: [See SECTION 1 of the Guide]

- ① Twin Eddies, LLC ③ _____
- ② _____ ④ _____

2. Trade Name (dba): ICONIC

3. Business Location: 2226 NE Broadway Portland Mult OR 97232
(number, street, rural route) (city) (county) (state) (ZIP code)

4. Business Mailing Address: 3270 SW Cedar Hills Blvd #102 Beaverton OR 97005
(PO box, number, street, rural route) (city) (state) (ZIP code)

5. Business Numbers: 360.910.6851 (503) 748.2329
(phone) (fax)

6. Is the business at this location currently licensed by OLCC? Yes No

7. If yes to whom: _____ Type of License: _____ ✓

8. Former Business Name: _____

9. Will you have a manager? Yes No Name: Christopher McCall
(manager must fill out an Individual History form)

10. What is the local governing body where your business is located? Portland
(name of city or county)

11. Contact person for this application: Christopher McCall 360.910.6851
(name) (phone number(s))
3270 SW CEDAR HILLS BLVD #102 Beav OR 97005 (503) 748-2329 cmccall@gmail.com
(address) (fax number) (e-mail address)

I understand that if my answers are not true and complete, the OLCC may deny my license application.

Applicant(s) Signature(s) and Date:

- ① [Signature] Date Apr 23 14 ③ _____ Date _____
- ② _____ Date _____ ④ _____ Date _____



OREGON LIQUOR CONTROL COMMISSION
BUSINESS INFORMATION

Please Print or Type

Applicant Name: Twin Eddies, LLC Phone: 360.910.6851

Trade Name (dba): Iconic

Business Location Address: 2226 NE Broadway

City: Portland OR ZIP Code: 97232

DAYS AND HOURS OF OPERATION

Table with columns for Business Hours, Outdoor Area Hours, and The outdoor area is used for. Includes checkboxes for Food service, Alcohol service, and Enclosed, how.

Seasonal Variations: Yes No If yes, explain: Patio seating only available during good weather months

ENTERTAINMENT

- Check all that apply: Live Music, Recorded Music, DJ Music, Dancing, Nude Entertainers, Karaoke, Coin-operated Games, Video Lottery Machines, Social Gaming, Pool Tables, Other.

DAYS & HOURS OF LIVE OR DJ MUSIC

Table for days and hours of live or DJ music with columns for Sunday through Saturday.

SEATING COUNT

Restaurant: 60 Outdoor: 20
Lounge: Other (explain):
Banquet: Total Seating: 80

OLCC USE ONLY
Investigator Verified Seating: (Y) (N)
Investigator Initials:
Date:

I understand if my answers are not true and complete, the OLCC may deny my license application.

Applicant Signature: [Signature] Date: Apr 22nd 2014

OREGON LIQUOR CONTROL COMMISSION
LIMITED LIABILITY COMPANY QUESTIONNAIRE



Please Print or Type

LLC Name: Twin Eddies, LLC Year Filed: 2014

Trade Name (dba): Iconic

Business Location Address: 2226 NE Broadway

City: Portland ZIP Code: 97232

List Members of LLC:

Percentage of Membership Interest:

1. Christopher E McCall
(managing member)

50%

2. Gregory E McCall
(members)

50%

3. _____

4. _____

5. _____

6. _____

(Note: If any LLC member is another legal entity, that entity must also complete an LLC, Limited Partnership or Corporation Questionnaire. If the LLC has officers, please list them on a separate sheet of paper with their titles.)

Server Education Designee: [Signature] DOB: 9/19/1979

I understand that if my answers are not true and complete, the OLCC may deny my license application.

Signature: [Signature] Date: Apr 22nd, 2014
(name) (title)

CITY OF PORTLAND LIQUOR OUTLET INFORMATION FORM

Submit to: Theresa Marchetti, Office of Neighborhood Involvement, 1221 SW 4th Av, Ste 110, Portland, OR 97204
(503) 823-3092

City Endorsement Fees are payable at the beginning of the application process: New outlets are \$100.00. All others are \$75.00. Make checks payable to the City of Portland. You must include the OLCC Liquor Application form, *initialed by your OLCC License Investigator* and all OLCC Individual History forms. All blanks must be filled in. If the question does not apply, write "N/A" in the space. All persons who are anticipated to have a financial interest and key personnel must complete City of Portland Personal History forms. On New Outlet applications, property owners within 300 feet of the location, the Portland Police Bureau and all interested parties are notified by mail (with a copy of this form) and given an opportunity to comment on your application. The OLCC allows the City at least 45 days to complete the recommendation process. A City liquor endorsement is not a confirmation that the property is properly zoned. Call 823-7526 to confirm that the property is properly zoned.

Legal Name of Business: Turn Eddies LLC

DBA or Trade Name: ICONIC Phone: 360 910 6851 Fax: 503 748 2329

Business Address, including Zip Code: 2226 NE Broadway, Portland OR 97232

What type of liquor license are you applying for? (Change owner, new outlet, beer & wine, etc.) New outlet

Contact person: Chris McCall Contact phone: 360 910 6851 E-mail: cemccall@gmail.com

Please note: New Outlet Package Stores may be subject to the Convenience Store Review process through the Planning Bureau. Call 823-7526 for applicable information, regulations and forms.

DESCRIPTION OF OUTLET:

Type of Operation: (Check all that apply) <input type="checkbox"/> Food Cart/Food Cart Pod <input checked="" type="checkbox"/> Restaurant <input type="checkbox"/> Sports bar <input type="checkbox"/> Tavern	<input type="checkbox"/> Night Club <input type="checkbox"/> Convenience Store <input type="checkbox"/> Other (Please Describe _____)	Size of Service area: <u>1800</u> Existing Building: (circle) <u>YES</u> / NO Zoning: _____ Structural Changes: (describe): : <u>NONE</u>
---	---	---

Seating Capacity: Restaurant 60 Lounge/Bar Outside Sidewalk 20 Outside patio

Will you be seeking a sidewalk café permit? YES / NO - Date Obtained/Applied for: / / Future

Describe Security: CCTV and Alarm

Has an application for a liquor license at this location been received by the City of Portland in the last 2 years? yes no don't know

HOURS OF OPERATION

Weekdays Sunday through Thursday open 3pm close 2:30am Sunday Friday & Saturday open 8am close 2:30am

How late will you have outside seating? 2:30am How late will you have entertainment? N/A Close

HISTORY OF LOCATION

Previous Business Name of this location: Meiji En Japanese Cuisine

Name and Address of Property Owner: Sixty One Two, LLC

ENTERTAINMENT:

<input type="checkbox"/> Dancing <input type="checkbox"/> Karaoke <input type="checkbox"/> Live Music <input checked="" type="checkbox"/> Recorded Music	<input checked="" type="checkbox"/> Video Poker <input type="checkbox"/> Video games/Pinball <input type="checkbox"/> Social Gaming <input type="checkbox"/> Pool Tables (If yes, how many?)	<input type="checkbox"/> Nude Dancers <input type="checkbox"/> DJ Entertainment <input type="checkbox"/> Events (describe) _____ <input type="checkbox"/> Other (describe) _____
---	---	---

The City requires an Amusement Location Permit for all locations with amusement devices or pool tables. Contact the Revenue Bureau for rules and an Amusement Location Permit application form now. Permits are non-transferable from one owner to another and must be paid before games are placed on the premises. Contact Anne Holm at 503-865-2488.

Use this area to provide any additional information that you wish to be considered on this liquor application.

A false answer or omission of any requested information may result in an unfavorable City recommendation.

Signature:  Date: Apr 24, 2014

City of Portland
 Bureau of
 Development Services
 Date 1/25/14
 Approved by
 Planning and Zoning Review

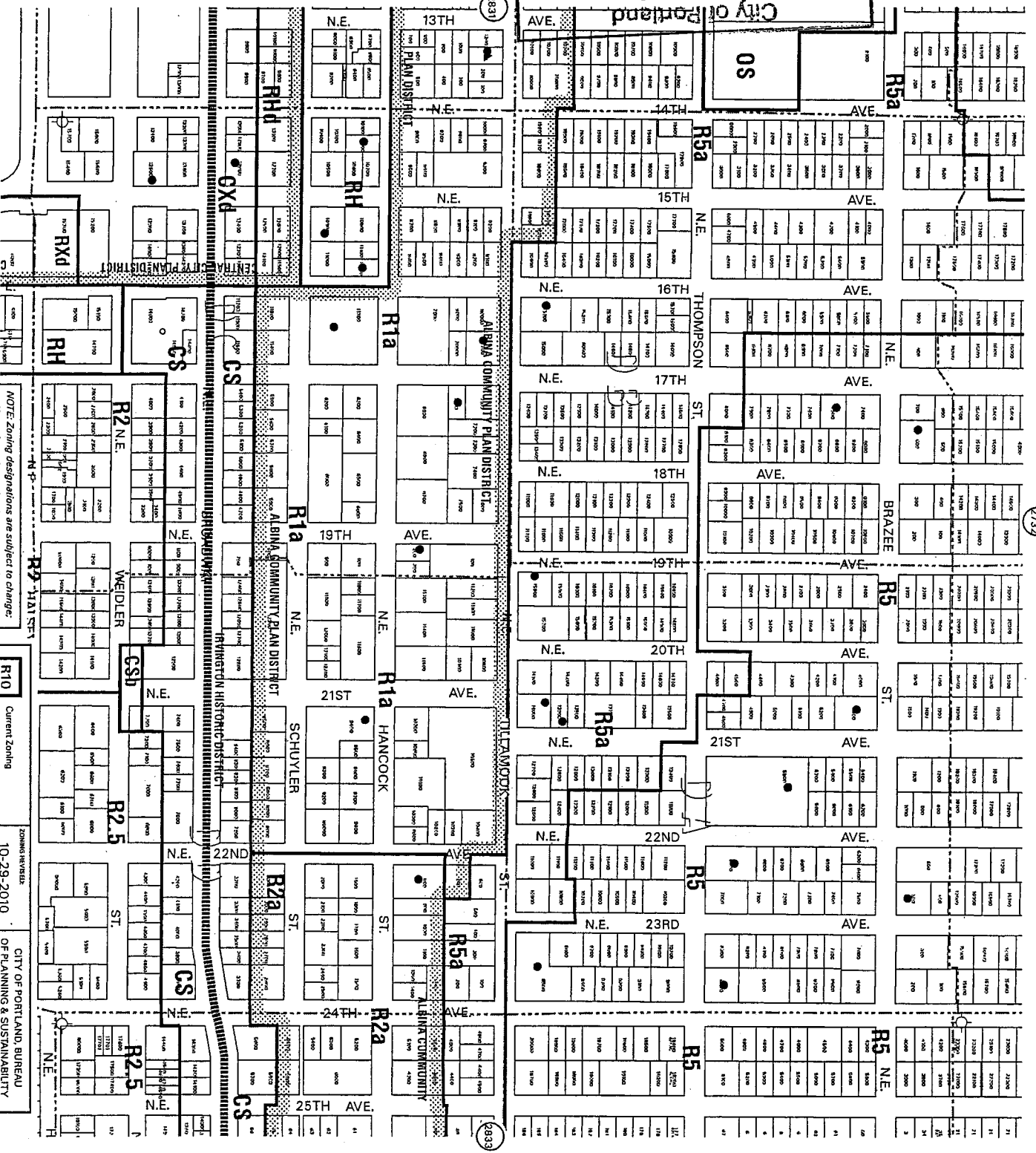

Plan District Boundary
 Historic or Conservation District or N.R.M.F. Boundary
 HISTORIC LANDMARK
 CONSERVATION LANDMARK
 R10 Current Zoning
 Maximum Potential
 Zoning as per
 Comprehensive Plan
 State of Main Document
 ZONING REVISION
 10-29-2010
 CITY OF PORTLAND, BUREAU
 OF PLANNING & SUSTAINABILITY
 SCALE: 1" = 30'

2832