



OREGON LIQUOR CONTROL COMMISSION LIQUOR LICENSE APPLICATION

Application is being made for:

LICENSE TYPES

- Full On-Premises Sales (\$402.60/yr)
 - Commercial Establishment
 - Caterer
 - Passenger Carrier
 - Other Public Location
 - Private Club
- Limited On-Premises Sales (\$202.60/yr)
- Off-Premises Sales (\$100/yr)
 - with Fuel Pumps
- Brewery Public House (\$252.60)
- Winery (\$250/yr)
- Other: _____

ACTIONS

- Change Ownership
- New Outlet
- Greater Privilege
- Additional Privilege
- Other _____

Rec'd by Portland
Liquor Licenses

AUG 19 2014

PD cho
312954
cc 312754/\$100

90-DAY AUTHORITY

Check here if you are applying for a change of ownership at a business that has a current liquor license, or if you are applying for an Off-Premises Sales license and are requesting a 90-Day Temporary Authority

APPLYING AS:

- Limited Partnership
- Corporation
- Limited Liability Company
- Individuals

CITY AND COUNTY USE ONLY

Date application received: _____

The City Council or County Commission:

(name of city or county)

recommends that this license be:

- Granted
- Denied

By: _____
(signature) (date)

Name: _____

Title: _____

OLCC USE ONLY

Application Rec'd by: CM

Date: 8/19/14

90-day authority: Yes No

1. Entity or Individuals applying for the license: [See SECTION 1 of the Guide]

① Beer City Bottle Shop, LLC ③ _____

② _____ ④ _____

2. Trade Name (dba): Beer City Bottle Shop

3. Business Location: 4212 N Mississippi Ave Portland Mult. OR 97217
(number, street, rural route) (city) (county) (state) (ZIP code)

4. Business Mailing Address: 5145 NE 49th Ave Portland OR 97218
(PO box, number, street, rural route) (city) (state) (ZIP code)

5. Business Numbers: None yet
(phone) (fax)

6. Is the business at this location currently licensed by OLCC? Yes No

7. If yes to whom: _____ Type of License: _____

8. Former Business Name: _____

9. Will you have a manager? Yes No Name: MA
(manager must fill out an Individual History form)

10. What is the local governing body where your business is located? Portland
(name of city or county)

11. Contact person for this application: Pam Adkins 503-957-2390
(name) (phone number(s))

5145 NE 49th Ave Portland, OR 97218 NA Beercitybottleshop@hotmail.com
(address) (fax number) (e-mail address)

I understand that if my answers are not true and complete, the OLCC may deny my license application.

Applicant(s) Signature(s) and Date:

① Pam Adkins Date 8/18/14 ③ _____ Date _____

② [Signature] Date 8/18/14 ④ _____ Date _____



OREGON LIQUOR CONTROL COMMISSION BUSINESS INFORMATION

Please Print or Type

Applicant Name: ~~XXXXXXXXXX~~ Beer City Bottle Shop, LLC Phone: 503-957-2390

Trade Name (dba): Beer City Bottle Shop

Business Location Address: 4212 N Mississippi

City: Portland ZIP Code: 97217

DAYS AND HOURS OF OPERATION

Business Hours:

Sunday 1pm to 8pm
 Monday 3pm to 9pm
 Tuesday 3pm to 9pm
 Wednesday 3pm to 9pm
 Thursday 3pm to 9pm
 Friday 12pm to 10pm
 Saturday 12pm to 10pm

Outdoor Area Hours:

Sunday 1pm to 8pm
 Monday 3pm to 9pm
 Tuesday 3pm to 9pm
 Wednesday 3pm to 9pm
 Thursday 3pm to 9pm
 Friday 12pm to 10pm
 Saturday 12pm to 10pm

Will wait until 2015 to apply for city sidewalk cafe permit

The outdoor area is used for:

- Food service Hours: open to close
- Alcohol service Hours: open to close
- Enclosed, how _____

The exterior area is adequately viewed and/or supervised by Service Permittees.
 _____ (Investigator's Initials)

Seasonal Variations: Yes No If yes, explain: _____

ENTERTAINMENT

- Check all that apply:
- Live Music
 - Recorded Music
 - DJ Music
 - Dancing
 - Nude Entertainers
 - Karaoke
 - Coin-operated Games
 - Video Lottery Machines
 - Social Gaming
 - Pool Tables
 - Other: _____

DAYS & HOURS OF LIVE OR DJ MUSIC

Sunday _____ to _____
 Monday _____ to _____
 Tuesday _____ to _____
 Wednesday _____ to _____
 Thursday _____ to _____
 Friday _____ to _____
 Saturday _____ to _____

SEATING COUNT

Restaurant: 20-25 Outdoor: 4
 Lounge: 0 Other (explain): 0
 Banquet: 0 Total Seating: 20-29

OLCC USE ONLY

Investigator Verified Seating: ____ (Y) ____ (N)
 Investigator Initials: _____
 Date: _____

I understand if my answers are not true and complete, the OLCC may deny my license application.

Applicant Signature: *Samela Ad* Date: 8/18/14

OREGON LIQUOR CONTROL COMMISSION
LIMITED LIABILITY COMPANY QUESTIONNAIRE



Please Print or Type

LLC Name: Beer City Bottle Shop, LLC Year Filed: 2014

Trade Name (dba): Beer City Bottle Shop

Business Location Address: 4212 N Mississippi Ave

City: Portland ZIP Code: 97217

List Members of LLC:

Percentage of Membership Interest:

- | | |
|--------------------------------------|------------|
| 1. <u>NK</u>
(managing member) | _____ |
| 2. <u>Pamela Adkins</u>
(members) | <u>50%</u> |
| 3. <u>Mary K. Plass</u> | <u>50%</u> |
| 4. _____ | _____ |
| 5. _____ | _____ |
| 6. _____ | _____ |

(Note: If any LLC member is another legal entity, that entity must also complete an LLC, Limited Partnership or Corporation Questionnaire. If the LLC has officers, please list them on a separate sheet of paper with their titles.)

Server Education Designee: Pamela Adkins DOB: 11/20/1972

I understand that if my answers are not true and complete, the OLCC may deny my license application.

Signature: Pamela Adkins (name) Member (title) Date: 8/18/14

CITY OF PORTLAND LIQUOR OUTLET INFORMATION FORM

Submit to: Theresa Marchetti, Office of Neighborhood Involvement, 1221 SW 4th Av, Ste 110, Portland, OR 97204
(503) 823-3092

City Endorsement Fees are payable at the beginning of the application process: New outlets are \$100.00. All others are \$75.00. Make checks payable to the City of Portland. **You must include the OLCC Liquor Application form, *initialed by your OLCC License Investigator* and all OLCC Individual History forms.** All blanks must be filled in. If the question does not apply, write "N/A" in the space. All persons who are anticipated to have a financial interest and key personnel must complete City of Portland Personal History forms. On New Outlet applications, property owners within 300 feet of the location, the Portland Police Bureau and all interested parties are notified by mail (with a copy of this form) and given an opportunity to comment on your application. The OLCC allows the City at least 45 days to complete the recommendation process. A City liquor endorsement is not a confirmation that the property is properly zoned. Call 823-7526 to confirm that the property is properly zoned.

Legal Name of Business: Beer City Bottle Shop, LLC (cell)

DBA or Trade Name: Beer City Bottle Shop Phone: 503-957-2390 Fax: NA

Business Address, including Zip Code: 4212 N Mississippi Ave Portland OR 97217

What type of liquor license are you applying for? (Change owner, new outlet, beer & wine, etc.) New outlet - limited on/off premise

Contact person: Pamela Adkins Contact phone: 503-957-2390 E-mail: beercitybottleshop@hotmail.com

Please note: New Outlet Package Stores may be subject to the Convenience Store Review process through the Planning Bureau. Call 823-7526 for applicable information, regulations and forms.

DESCRIPTION OF OUTLET:

Type of Operation: (Check all that apply) <input type="checkbox"/> Food Cart/Food Cart Pod <input type="checkbox"/> Restaurant <input type="checkbox"/> Sports bar <input type="checkbox"/> Tavern	<input type="checkbox"/> Night Club <input type="checkbox"/> Convenience Store <input checked="" type="checkbox"/> Other (Please Describe <u>Bottleshop/Taproom</u>)	Size of Service area: <u>500 sqft (approx)</u> Existing Building: (circle) <u>YES</u> / NO Zoning: <u>CS</u> Structural Changes: (describe): : <u>N/A</u>
--	---	---

Seating Capacity: Restaurant 20-25 Lounge/Bar Outside Sidewalk 4 Outside patio

Will you be seeking a sidewalk café permit? YES / NO - Date Obtained/Applied for / / future date TBD

Describe Security: owner/operator

Has an application for a liquor license at this location been received by the City of Portland in the last 2 years? yes no don't know

HOURS OF OPERATION

Sunday through Thursday open 3pm close 9pm Friday & Saturday open 12pm close 10pm

How late will you have outside seating? 10pm How late will you have entertainment? NA

HISTORY OF LOCATION

Previous Business Name of this location: Pasta Works

Name and Address of Property Owner: Jim Winkler 210 SW Morrison, Ste 600

Portland, OR 97204

ENTERTAINMENT:

<input type="checkbox"/> Dancing <input type="checkbox"/> Karaoke <input type="checkbox"/> Live Music <input checked="" type="checkbox"/> Recorded Music	<input type="checkbox"/> Video Poker <input type="checkbox"/> Video games/Pinball <input type="checkbox"/> Social Gaming <input type="checkbox"/> Pool Tables (If yes, how many?)	<input type="checkbox"/> Nude Dancers <input type="checkbox"/> DJ Entertainment <input type="checkbox"/> Events (describe) _____ <input type="checkbox"/> Other (describe) _____
---	--	---

The City requires an **Amusement Location Permit** for all locations with amusement devices or pool tables. **Contact the Revenue Bureau for rules and an Amusement Location Permit application form now.** Permits are non-transferable from one owner to another and must be paid before games are placed on the premises. Contact Anne Holm at 503-865-2488.

Use this area to provide any additional information that you wish to be considered on this liquor application.

A false answer or omission of any requested information may result in an unfavorable City recommendation.

Signature: Pamela Adkins

Date: 8/18/14

Property Search

Owner Name: PASTAWORKS LLC
 Site Address: 4212 N MISSISSIPPI AVE
 State ID: JN1E2JCA 7100
 Account #: P633261

Search Clear PortlandMaps

- Geocode Address When Taxlot Not Found
- Search is Based on Active Field Only
- Hide Personal Property Accounts
- Display Taxlot Detail Window

Navigate Query Results

Owner: PASTAWORKS LLC 4212 N MISSISSIPPI AVE JN1E2JCA 7100
 Site Address: State

City of Portland
 Bureau of
 Development Services
 Development Services Center
 1910 SW Fishb. Ave., Suite 5000
 Portland, OR 97201

Amada Rhoads
 503-823-7837

Search Legend Add Data Selection

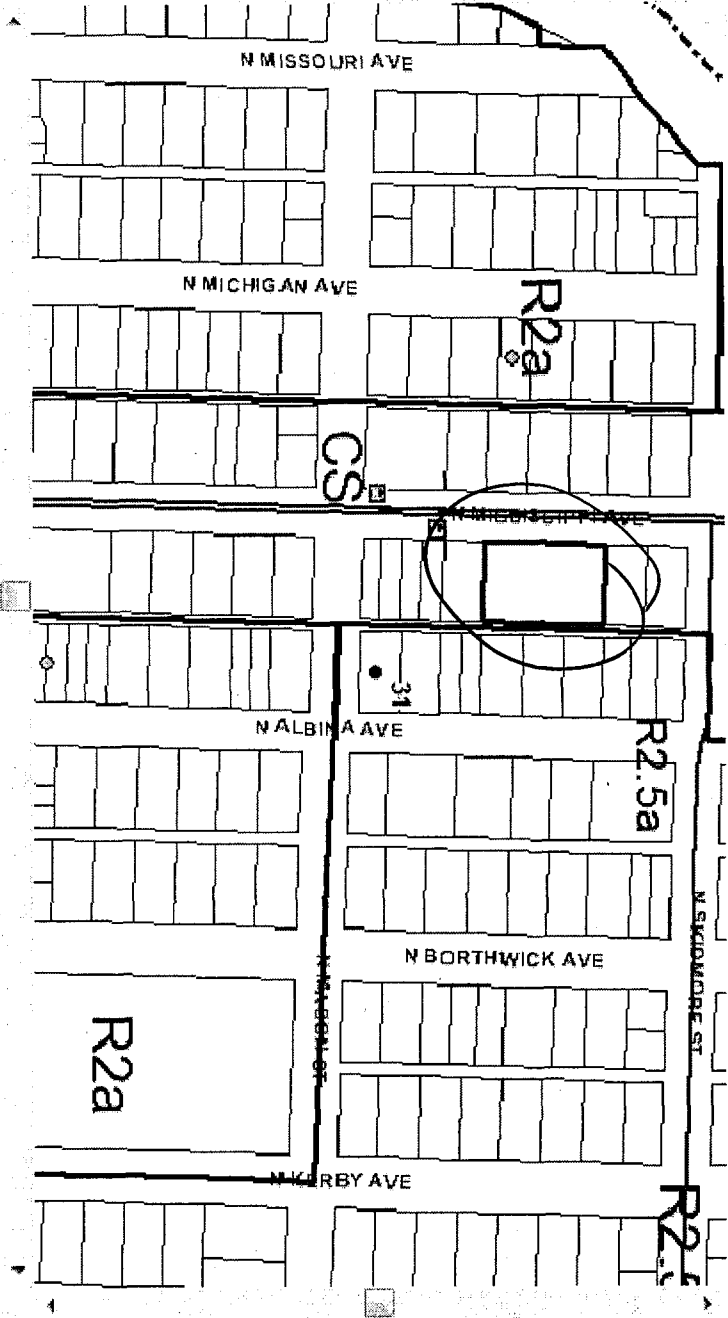

Taxlot Details

Lot Size: Building Size: Map Number: 2639
 Legal Description: MULTNOMAH, BLOCK 12, LOT 688&10
 Lot & Block:

Mailing Information:
 PASTAWORKS LLC
 3735 SE HAWTHORNE BLVD
 PORTLAND, OR 97214

Zoning Code(s): CS

Historic District:
 Conservation District:
 MISSISSIPPI CONSERVATIO
 Jurisdiction: Portland

Subdistrict:
 Subarea:
 NRMP:

1/4 Section Map Tax Map Zon

LUR Case His
 LU 06-1032
 PC 05-1625
 PC 7600
 VZ 093-69
 Draw LUR

Scale 1 inch = 235 feet

This site is zoned storefront commercial, which allows retail uses. Jul 14 8/19/14