



OREGON LIQUOR CONTROL COMMISSION LIQUOR LICENSE APPLICATION

DT

Application is being made for:

LICENSE TYPES

- Full On-Premises Sales (\$402.60/yr)
 - Commercial Establishment
 - Caterer
 - Passenger Carrier
 - Other Public Location
 - Private Club
- Limited On-Premises Sales (\$202.60/yr)
- Off-Premises Sales (\$100/yr)
 - with Fuel Pumps
- Brewery Public House (\$252.60)
- Winery (\$250/yr)
- Other: _____

ACTIONS

- Change Ownership
- New Outlet
- Greater Privilege
- Additional Privilege
- Other _____

90-DAY AUTHORITY

Check here if you are applying for a change of ownership at a business that has a current liquor license, or if you are applying for an Off-Premises Sales license and are requesting a 90-Day Temporary Authority

APPLYING AS:

- Limited Partnership
- Corporation
- Limited Liability Company
- Individuals

CITY AND COUNTY USE ONLY

Date application received: _____

The City Council or County Commission:

(name of city or county)

recommends that this license be:

- Granted
- Denied

By: _____
(signature) (date)

Name: _____

Title: _____

OLCC USE ONLY

Application Rec'd by:

Date: 2-24-17

90-day authority: Yes No

1. Entity or Individuals applying for the license: [See SECTION 1 of the Guide]

① RANDY LL CORPORATION ③ _____

② _____ ④ _____

2. Trade Name (dba): 82ND GAS FOR LESS

3. Business Location: 5322 SE 82ND AVE, PORTLAND, MULTNOMAH, OREGON 97266
(number, street, rural route) (city) (county) (state) (ZIP code)

4. Business Mailing Address: 5322 SE 82ND AVE., PORTLAND, OREGON 97266
(PO box, number, street, rural route) (city) (state) (ZIP code)

5. Business Numbers: (503)772-5353
(phone) (fax)

6. Is the business at this location currently licensed by OLCC? Yes No

7. If yes to whom: _____ Type of License: _____

8. Former Business Name: _____

9. Will you have a manager? Yes No Name: CHRISTIAN PREZCOP
(manager must fill out an Individual History form)

10. What is the local governing body where your business is located? PORTLAND, OREGON 97266 ✓
(name of city or county)

11. Contact person for this application: WAEL RAFEH (818)355-7433
(name) (phone number(s))
5322 SE 82ND AVE., PORTLAND, OR 97266 (503)772-5353 portlandmobil@gmail.com
(address) (fax number) (e-mail address)

I understand that if my answers are not true and complete, the OLCC may deny my license application.

Applicant(s) Signature(s) and Date:

① Date 02-15-2017 ③ _____

② Date 02-15-2017 ④ _____

Initials: Date: FEB 16 2017
Oregon Liquor Control Commission

Rec'd by Portland
Liquor Licenses
MAR 08 2017
PD 100
1350

RECEIVED



OREGON LIQUOR CONTROL COMMISSION
BUSINESS INFORMATION

Please Print or Type

Applicant Name: RANDY LL CORPORATION Phone: (503) 772-5353

Trade Name (dba): 2ND GAS FOR LESS

Business Location Address: 5322 SE 2ND AVE.

City: PORTLAND ZIP Code: 97266

DAYS AND HOURS OF OPERATION

Business Hours:

Sunday 7:00 AM to 10:00 PM
Monday 6:00 AM to 10:00 PM
Tuesday 11 to 11
Wednesday 11 to 11
Thursday 11 to 11
Friday 11 to 11
Saturday 7:00 AM to 10:00 PM

Outdoor Area Hours:

Sunday to
Monday to
Tuesday to
Wednesday to
Thursday to
Friday to
Saturday to

The outdoor area is used for:

- Food service Hours: to
Alcohol service Hours: to
Enclosed, how

The exterior area is adequately viewed and/or supervised by Service Permittees.

(Investigator's Initials)

Seasonal Variations: Yes No If yes, explain:

ENTERTAINMENT

Check all that apply:

- Live Music Karaoke
Recorded Music Coin-operated Games
DJ Music Video Lottery Machines
Dancing Social Gaming
Nude Entertainers Pool Tables
Other:

DAYS & HOURS OF LIVE OR DJ MUSIC

Sunday to
Monday to
Tuesday to
Wednesday to
Thursday to
Friday to
Saturday to

SEATING COUNT

Restaurant: Outdoor:
Lounge: Other (explain):
Banquet: Total Seating:

OLCC USE ONLY
Investigator Verified Seating: (Y) (N)
Investigator Initials:
Date:

I understand if my answers are not true and complete, the OLCC may deny my license application.

Applicant Signature: Date: 9-15-2017



OREGON LIQUOR CONTROL COMMISSION CORPORATION QUESTIONNAIRE

886679-94

Please Print or Type

Corporation Name: RANDY LL CORPORATION Year Incorporated: 2012 ✓

Trade Name (dba): 82ND GAS FOR LESS

Business Location Address: 5322 SE 82ND AVE.

City: PORTLAND, OR ZIP Code: 97266

List Corporate Officers:

<u>RANADI RAFEH</u>	<u>PRESIDENT</u>
(name)	(title)
<u>Wael RAFEH</u>	<u>REGISTERED AGENT/SECRETARY</u>
_____	_____
_____	_____

List Board of Directors:

(name) _____

List Stockholders: (Note: If any stockholder is another legal entity, that entity may also need to complete another Corporation Questionnaire. See Liquor License Application Guide for more information.)

<u>Stockholders:</u>	<u>Number of Shares Held:</u>	Number of Stock Shares:
<u>Wael RAFEH</u>	<u>200</u>	<div style="border: 1px solid black; padding: 5px;"> Issued: _____ Unissued: _____ Total Shares Authorized to Issue: _____ </div>
<u>RANADI RAFEH</u>	<u>800</u>	
_____	_____	
_____	_____	

Server Education Designee: _____ **DOB:** _____
(See Liquor License Application Guide for more information)

I understand that if my answers are not true and complete, the OLCC may deny my license application.

Officer's Signature: [Signature] secretary Date: 2-15-2017
(name) (title)

CITY OF PORTLAND LIQUOR OUTLET INFORMATION FORM

PLEASE SUBMIT TO: Liquor Licensing Notification Program, 1221 SW 4th Avenue, Suite #110, Portland OR 97204

On New Outlet applications, property owners within 300 feet of the location, the Portland Police Bureau and all interested parties are notified by mail (with a copy of this form) and given an opportunity to comment on your application. The OLCC allows the City at least 45 days to complete the recommendation process. Submission of a complete operating plan can expedite the time required to process. A City liquor endorsement is not a confirmation that the property is properly zoned. Call (503) - 823-7526 to confirm that the property is properly zoned.

On submission of this form, you must also include the following:

- OLCC Liquor Application Form, initialed by your OLCC License Investigator
- OLCC Individual History Forms (all persons anticipated to have a financial interest, or key personnel are required)
- City Endorsement Fees

City Endorsement Fees are payable at the beginning of the application process (please make checks payable to City of Portland): New outlets are \$100.00, all others are \$75.00. All blank sections must be filled in. If the question does not apply, write "N/A" in the space.

LEGAL NAME OF BUSINESS: RANDY LL CORPORATION

DBA OR TRADE NAME: 82ND GAS FOR LESS PHONE: (503) 772-5353 FAX: _____

BUSINESS ADDRESS (Including ZIP Code): 5322 SE 82ND AVE, PORTLAND, OR 97266

WHAT TYPE OF LIQUOR ARE YOU APPLYING FOR? (Change of owner, new outlet, beer & wine, etc.): BEER & WINE.

CONTACT PERSON: WAEI RAFEH PHONE: (818) 355-7433 EMAIL: _____

DESCRIPTION OF OUTLET

TYPE OF OPERATION (CHECK ALL THAT APPLY)

- | | |
|---|---|
| <input type="checkbox"/> Food Cart | <input type="checkbox"/> Night Club |
| <input type="checkbox"/> Restaurant | <input type="checkbox"/> Sports Bar |
| <input checked="" type="checkbox"/> Convenience Store | <input checked="" type="checkbox"/> Other: <u>GAS STATION</u> |

SIZE OF SERVICE AREA: 600 SF.

EXISTING BUILDING: Yes No

ZONING: COMMERCIAL

STRUCTURAL CHANGES (DESCRIBE): N/A.

RESTAURANT SEATING CAPACITY: N/A LOUNGE SEATING CAPACITY: N/A OUTSIDE SEATING CAPACITY: N/A.

DESCRIBE SECURITY: CAMERA SYSTEM

HAS AN APPLICATION FOR A LIQUOR LICENSE AT THIS LOCATION BEEN RECEIVED BY THE CITY OF PORTLAND IN THE LAST TWO (2) YEARS?
 Yes No I Don't Know

HOURS OF OPERATION

SUNDAY - THURSDAY OPEN: 6:00 AM CLOSE: 10:00 PM FRIDAY & SATURDAY OPEN: 6:00 AM CLOSE: 10:00 PM.

HOW LATE WILL THERE BE OUTSIDE SEATING? N/A HOW LATE WILL THERE BE ENTERTAINMENT? N/A

HISTORY OF LOCATION

PREVIOUS BUSINESS NAME OF THIS LOCATION: _____

NAME & ADDRESS OF PROPERTY OWNER: WAEI & RANADI RAFEH / 930 NW 12th AVE, PORTLAND, #101
OR 2809 NE 115th AVE, PORTLAND, OR, 97209

ENTERTAINMENT

TYPE OF ENTERTAINMENT (CHECK ALL THAT APPLY)

- | | | | |
|--|---|---|---|
| <input type="checkbox"/> Dancing | <input type="checkbox"/> Video Poker | <input type="checkbox"/> Live Music | <input type="checkbox"/> Nude Dancers |
| <input type="checkbox"/> Karaoke | <input type="checkbox"/> Video Games/Pinball | <input type="checkbox"/> Recorded Music | <input type="checkbox"/> DJ Entertainment |
| <input type="checkbox"/> Pool Tables (How Many): _____ | <input type="checkbox"/> Events (Describe): _____ | <input type="checkbox"/> Other: _____ | |

The City requires an Amusement Location Permit for all locations with amusement devices or pool tables. Contact the Revenue Bureau for rules and an Amusement Location Permit application form now. Permits are non-transferable from one owner to another and must be paid before games are placed on the premises. Contact Anne Holm at 503-865-2488. The City of Portland will notify affected nearby neighbors and a copy of this form will be included in our mailing.

Use this area to provide any additional information that you wish to be considered on this liquor application

A false answer or omission of any requested information may result in an unfavorable City recommendation.

SIGNATURE: _____

DATE: 3-1-2017

Property Search

OWNER: D JAK FAMILY L P TO RA
Site Address: 5322 SF 82ND AVE
Site ID: 1S2E15BC 8800
Account #: R167820

- Search
- Clear
- Portland Maps
- Geocode Address When Taxlot Not
- Search is Based on Active Held On
- Hide Personal Property Accounts
- Display Taxlot Detail Window

OWNER: D JAK FAM 5322 SF 82ND AVE 1S2E15BC

Bureau of Development Services
1900 SW 4th Ave., Suite 5000
Portland, OR 97201

EX allows for
Retail Sales & Service
uses, limited to 15 hours/day
max unless convenience store
J. Maria Slavarente
City Planner
(503) 823-7353

EXD

- Danielle Behnam
Associate Planner
(503) 823-7449
3/7/17

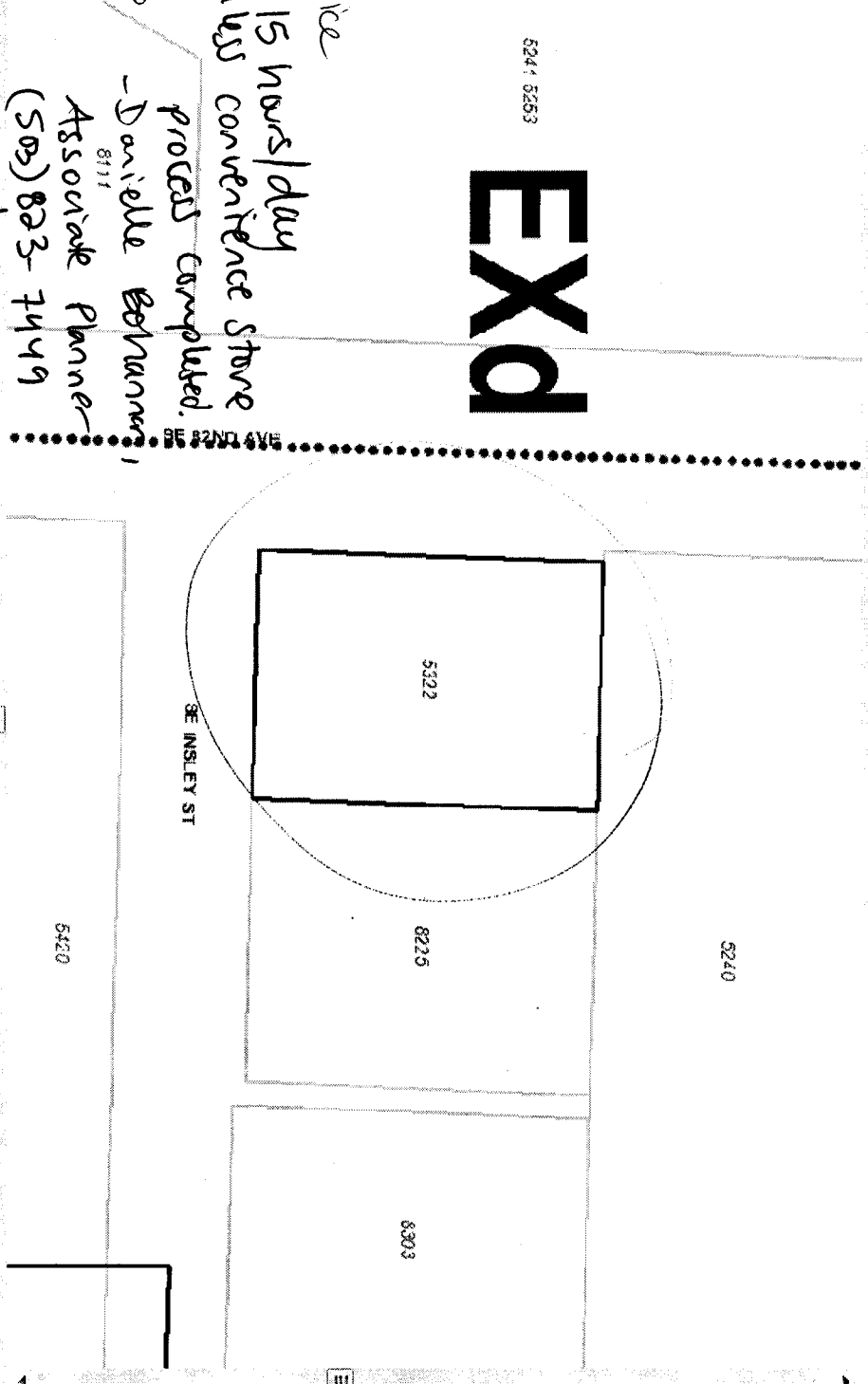

Taxlot Details

Lot Size: 15370 sqft
Building Size: 736 sqft
Main Number: 3539
Zone Code(s): EXD

Legal Description: GARDEN, LOT 1-4 TI 8800
Lot & Block: 1-4 TI 8f
Historic District:

Main Information:
T D JAK FAMILY L P TO RANDY LL CORPORATION
Jurisdiction: Portland
Conservation District:

1/4 Section
Tax Map
Zoning Map
Plan District:
LUR Case Hist (1 Case)
LUR 00-00100 DZN

Subarea:
NRMIP:
Draw LURS
LUR