



OREGON LIQUOR CONTROL COMMISSION
LIQUOR LICENSE APPLICATION

Pending

Application is being made for:
LICENSE TYPES: Full On-Premises Sales, Commercial Establishment, etc.
ACTIONS: Change Ownership, New Outlet, etc.
CITY AND COUNTY USE ONLY: Date application received, City Council or County Commission.
90-DAY AUTHORITY: Check here if you are applying for a change of ownership...
APPLYING AS: Limited Partnership, Corporation, Limited Liability Company, Individuals

1. Entity or Individuals applying for the license: [See SECTION 1 of the Guide]
1 North End Saloon, LLC
2 Nathan Krause
3 Jennifer Hegberg
4 Harold Hegberg
2. Trade Name (dba): North End Saloon LLC
3. Business Location: 500 NW Davis St Portland Multnomah OR 97209
4. Business Mailing Address: 500 NW Davis St Portland Multnomah OR 97209
5. Business Numbers: 503-206-8219
6. Is the business at this location currently licensed by OLCC? Yes No
7. If yes to whom: Davis St Tavern, LLC Type of License: Full On Premise
8. Former Business Name: Davis St Tavern
9. Will you have a manager? Yes No Name: Bryant Coleman
10. What is the local governing body where your business is located? Portland
11. Contact person for this application: Jason Haggart 503-539-3635
930 NW Naito Parkway K19 Portland 97209 jhaggart007@gmail.com

I understand that if my answers are not true and complete, the OLCC may deny my license application.
Applicant(s) Signature(s) and Date:
1 Jason Haggart Date 3/6/17
2 RECEIVED Date 3/6/17
3 Jennifer Hegberg Date 3/6/17
4 Harold Hagg Date 3/6/17



OREGON LIQUOR CONTROL COMMISSION BUSINESS INFORMATION

Please Print or Type

Applicant Name: North End Saloon, LLC Phone: 503-206-8219

Trade Name (dba): North End Saloon

Business Location Address: 500 NW Davis St.

City: Portland OR ZIP Code: 97209

DAYS AND HOURS OF OPERATION

Business Hours:

Sunday	<u>9:00am</u> to <u>11pm</u>
Monday	<u>11am</u> to <u>2am</u>
Tuesday	<u>11am</u> to <u>2am</u>
Wednesday	<u>11am</u> to <u>2am</u>
Thursday	<u>11am</u> to <u>2am</u>
Friday	<u>9am</u> to <u>2am</u>
Saturday	<u>9am</u> to <u>2am</u>

Outdoor Area Hours:

Sunday	<u>9am</u> to <u>11pm</u>
Monday	<u>11am</u> to <u>2am</u>
Tuesday	<u>11am</u> to <u>2am</u>
Wednesday	<u>11am</u> to <u>2am</u>
Thursday	<u>11am</u> to <u>2am</u>
Friday	<u>9am</u> to <u>2am</u>
Saturday	<u>9am</u> to <u>2am</u>

The outdoor area is used for:

Food service Hours: 9 to 2am
 Alcohol service Hours: 9 to 2am
 Enclosed, how _____

The exterior area is adequately viewed and/or supervised by Service Permittees.

(Investigator's Initials)

Seasonal Variations: Yes No If yes, explain: _____

ENTERTAINMENT

Check all that apply:

- | | |
|--|---|
| <input checked="" type="checkbox"/> Live Music | <input checked="" type="checkbox"/> Karaoke |
| <input type="checkbox"/> Recorded Music | <input checked="" type="checkbox"/> Coin-operated Games |
| <input type="checkbox"/> DJ Music | <input type="checkbox"/> Video Lottery Machines |
| <input checked="" type="checkbox"/> Dancing | <input checked="" type="checkbox"/> Social Gaming |
| <input type="checkbox"/> Nude Entertainers | <input checked="" type="checkbox"/> Pool Tables |
| | <input type="checkbox"/> Other: _____ |

DAYS & HOURS OF LIVE OR DJ MUSIC

Sunday	_____ to _____
Monday	_____ to _____
Tuesday	_____ to _____
Wednesday	_____ to _____
Thursday	<u>7pm</u> to <u>12:00 AM</u>
Friday	<u>7pm</u> to <u>12:00 AM</u>
Saturday	<u>7pm</u> to <u>12:00 AM</u>

SEATING COUNT

Restaurant: 70 Outdoor: 20
 Lounge: _____ Other (explain): _____
 Banquet: 70 Total Seating: _____

OLCC USE ONLY

Investigator Verified Seating: ____ (Y) ____ (N)
 Investigator Initials: _____
 Date: _____

I understand if my answers are not true and complete, the OLCC may deny my license application.

Applicant Signature: [Signature] Date: 3/6/17

OREGON LIQUOR CONTROL COMMISSION
LIMITED LIABILITY COMPANY QUESTIONNAIRE



127153799

Please Print or Type

LLC Name: North End Saloon, LLC Year Filed: 2017 2016

Trade Name (dba): North End Saloon

Business Location Address: 500 NW Davis St.

City: Portland OR ZIP Code: 97209

List Members of LLC:

Percentage of Membership Interest:

List Members of LLC:	Percentage of Membership Interest:
1. <u>Jason R. Haggart</u> (managing member)	<u>40%</u>
2. <u>Nathan Krause</u> (members)	<u>40%</u>
3. <u>Jennifer Hegberg</u>	<u>10%</u>
4. <u>Harold Hegberg</u>	<u>10%</u>
5. _____	_____
6. _____	_____

(Note: If any LLC member is another legal entity, that entity must also complete an LLC, Limited Partnership or Corporation Questionnaire. If the LLC has officers, please list them on a separate sheet of paper with their titles.)

Server Education Designee: Jason Haggart DOB: 05/03/1973

I understand that if my answers are not true and complete, the OLCC may deny my license application.

Signature: Jason Haggart (name) Member (title) Date: 3/6/17

CITY OF PORTLAND LIQUOR OUTLET INFORMATION FORM

PLEASE SUBMIT TO: Liquor Licensing Notification Program, 1221 SW 4th Avenue, Suite #110, Portland OR 97204

On New Outlet applications, property owners within 300 feet of the location, the Portland Police Bureau and all interested parties are notified by mail (with a copy of this form) and given an opportunity to comment on your application. The OLCC allows the City at least 45 days to complete the recommendation process. Submission of a complete operating plan can expedite the time required to process. A City liquor endorsement is not a confirmation that the property is properly zoned. Call (503) - 823-7526 to confirm that the property is properly zoned.

On submission of this form, you must also include the following:

- OLCC Liquor Application Form, initialed by your OLCC License Investigator
- OLCC Individual History Forms (all persons anticipated to have a financial interest, or key personnel are required)
- City Endorsement Fees

City Endorsement Fees are payable at the beginning of the application process (please make checks payable to City of Portland): New outlets are \$100.00, all others are \$75.00. All blank sections must be filled in. If the question does not apply, write "N/A" in the space.

LEGAL NAME OF BUSINESS: North End Saloon, LLC

DBA OR TRADE NAME: North End Saloon PHONE: 503-206-8219 FAX: _____

BUSINESS ADDRESS (Including ZIP Code): _____

WHAT TYPE OF LIQUOR ARE YOU APPLYING FOR? (Change of owner, new outlet, beer & wine, etc.): Change of Owner

CONTACT PERSON: Jason Maggert PHONE: 503-206-8219 EMAIL: jmaggert007@gmail.com

DESCRIPTION OF OUTLET

TYPE OF OPERATION (CHECK ALL THAT APPLY)

- Food Cart Night Club
 Restaurant Sports Bar
 Convenience Store Other: _____

SIZE OF SERVICE AREA: ~5800 sq ft

EXISTING BUILDING: Yes No

ZONING: Commercial

STRUCTURAL CHANGES (DESCRIBE): N/A

RESTAURANT SEATING CAPACITY: 150 LOUNGE SEATING CAPACITY: ~50 OUTSIDE SEATING CAPACITY: ~20

DESCRIBE SECURITY: We will have security camera, alarm & door staff during business hours

HAS AN APPLICATION FOR A LIQUOR LICENSE AT THIS LOCATION BEEN RECEIVED BY THE CITY OF PORTLAND IN THE LAST TWO (2) YEARS?
 Yes No I Don't Know

HOURS OF OPERATION

SUNDAY - THURSDAY OPEN: 9am CLOSE: 2am FRIDAY & SATURDAY OPEN: 9am CLOSE: 2am

HOW LATE WILL THERE BE OUTSIDE SEATING? 11pm HOW LATE WILL THERE BE ENTERTAINMENT? 2am

HISTORY OF LOCATION

PREVIOUS BUSINESS NAME OF THIS LOCATION: Davis St. Tavern

NAME & ADDRESS OF PROPERTY OWNER: Chris

ENTERTAINMENT

TYPE OF ENTERTAINMENT (CHECK ALL THAT APPLY)

- Dancing Video Poker Live Music Nude Dancers
 Karaoke Video Games/Pinball Recorded Music DJ Entertainment
 Pool Tables (How Many): NO (maybe) Events (Describe): _____ Other: _____

The City requires an Amusement Location Permit for all locations with amusement devices or pool tables. Contact the Revenue Bureau for rules and an Amusement Location Permit application form now. Permits are non-transferable from one owner to another and must be paid before games are placed on the premises. Contact Anne Holm at 503-865-2488. The City of Portland will notify affected nearby neighbors and a copy of this form will be included in our mailing.

Use this area to provide any additional information that you wish to be considered on this liquor application

A false answer or omission of any requested information may result in an unfavorable City recommendation.

SIGNATURE: Jason Maggert DATE: 3/21/17

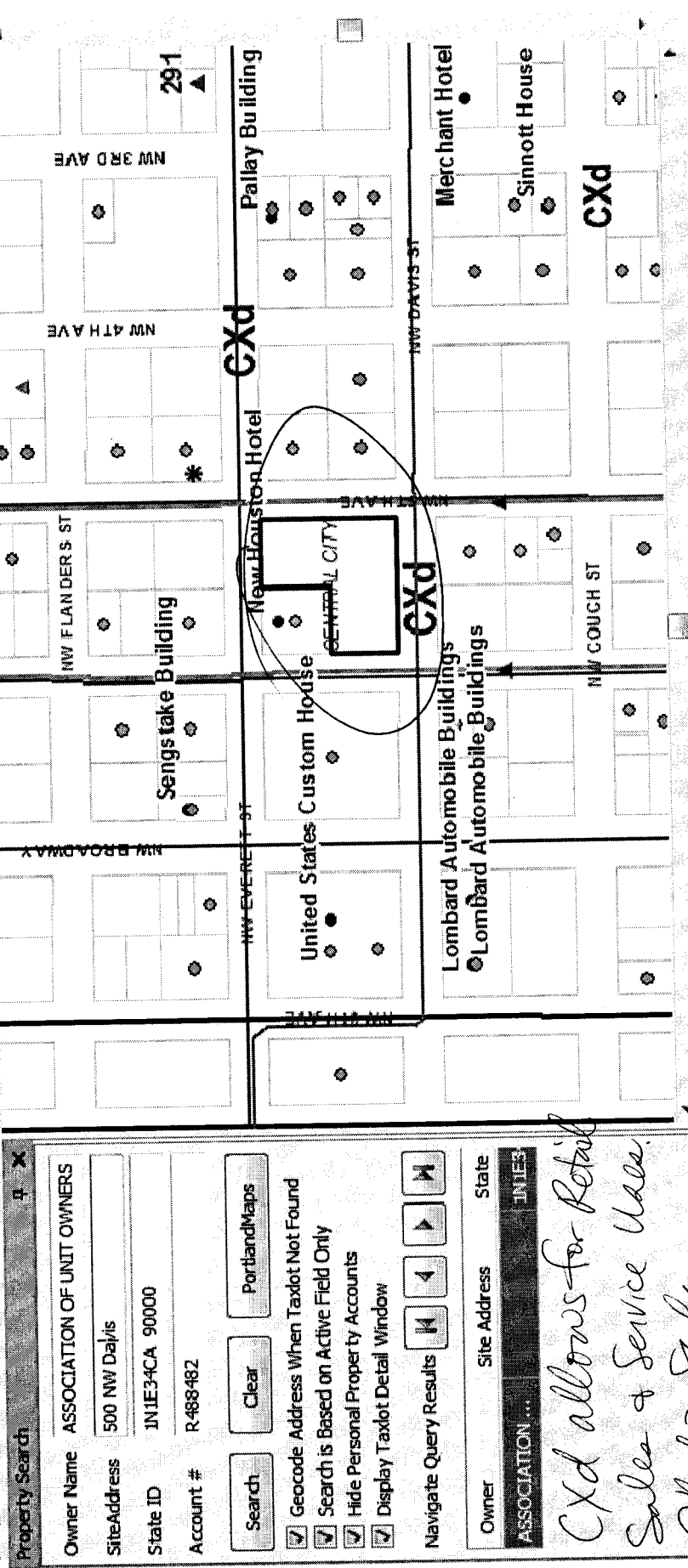

Property Search

Owner Name: ASSOCIATION OF UNIT OWNERS
 SiteAddress: 500 NW Dalvis
 State ID: 1N1E34CA 90000
 Account #: R488482

Search Clear PortlandMaps

Geocode Address When Taxlot Not Found
 Search is Based on Active Field Only
 Hide Personal Property Accounts
 Display Taxlot Detail Window

Navigate Query Results

Owner: ASSOCIATION ... State: IN1E3

CXd allows for Retail Sales & Service Uses.

John Sailer
Malina Susarenko, City Planner
(503) 823-7353

Taxlot Details

Map Number: 3029 | Zoning Code(s): CXd
 Lot & Block: M, GENERAL
 Historic District: Conservation District: Jurisdiction: Portland

NET OWNERS OF FAC: M, GENERAL

Section Map Tax Map Zoning Map

LUR Case History: (4 Cases)
 LU 07-166150 DZ
 LUR 97-01149 DZ, AD
 LUR 97-01150 PR
 LUR 98-01039 DZ

Plan District: CENTRAL CITY
 SubDistrict: RIVER DISTRICT
 SubArea: NRMP:

Scale 1 inch = 242 feet

Search Legend Add Data Selection