



OREGON LIQUOR CONTROL COMMISSION
LIQUOR LICENSE APPLICATION

PR

Application is being made for:
LICENSE TYPES
Full On-Premises Sales (\$402.60/yr)
Commercial Establishment
Caterer
Passenger Carrier
Other Public Location
Private Club
Limited On-Premises Sales (\$202.60/yr)
Off-Premises Sales (\$100/yr) with Fuel Pumps
Brewery Public House (\$252.60)
Winery (\$250/yr)
Other:
ACTIONS
Change Ownership
New Outlet
Greater Privilege
Additional Privilege
Other
Rec'd by Portland Liquor Licenses
APR 13 2017
PD \$100 ok
1001
90-DAY AUTHORITY
Check here if you are applying for a change of ownership...
APPLYING AS:
Limited Partnership
Corporation
Limited Liability Company
Individuals

CITY AND COUNTY USE ONLY
Date application received:
The City Council or County Commission:
(name of city or county)
recommends that this license be:
Granted Denied
By: (signature) (date)
Name:
Title:
OLCC USE ONLY
Application Rec'd by:
Date: 4-19-17
90-day authority: Yes No

1. Entity or Individuals applying for the license: [See SECTION 1 of the Guide]
1 KURSMATCHPOOLE, LLC
2
3
4
5 Business Location: 2006 NE Alberta Street, Portland, Multnomah, Oregon, 97211
6 Business Mailing Address: 3090 SE Division Street, Portland, Oregon 97202
7 Business Numbers: 503-893-2601
8 Is the business at this location currently licensed by OLCC? Yes No
9 If yes to whom: Type of License:
10 Former Business Name: N/A
11 Will you have a manager? Yes No Name:
12 What is the local governing body where your business is located? City of Portland
13 Contact person for this application: Alexander Kurnellas
3090 SE Division Street
971-302-6899
info@imperialbottleshop.com

I understand that if my answers are not true and complete, the OLCC may deny my license application.
Applicant(s) Signature(s) and Date:
1 [Signature] Date 04/10/17
2 [Signature] Date
RECEIVED APR 13 2017



OREGON LIQUOR CONTROL COMMISSION BUSINESS INFORMATION

Please Print or Type

Applicant Name: KURS MATCH POOLE, LLC Phone: 503-893-2601

Trade Name (dba): Imperial Bottle Shop and Taproom

Business Location Address: 2006 NE Alberta St

City: Portland, OR ZIP Code: 97211

DAYS AND HOURS OF OPERATION

Business Hours:

Sunday	<u>12 PM</u> to <u>10 PM</u>
Monday	<u>12 PM</u> to <u>10 PM</u>
Tuesday	<u>12 PM</u> to <u>10 PM</u>
Wednesday	<u>12 PM</u> to <u>10 PM</u>
Thursday	<u>12 PM</u> to <u>10 PM</u>
Friday	<u>12 PM</u> to <u>12 AM</u>
Saturday	<u>12 PM</u> to <u>12 AM</u>

Outdoor Area Hours:

Sunday	<u>12 PM</u> to <u>10 PM</u>
Monday	<u>12 PM</u> to <u>10 PM</u>
Tuesday	<u>12 PM</u> to <u>10 PM</u>
Wednesday	<u>12 PM</u> to <u>10 PM</u>
Thursday	<u>12 PM</u> to <u>10 PM</u>
Friday	<u>12 PM</u> to <u>12 AM</u>
Saturday	<u>12 PM</u> to <u>12 AM</u>

The outdoor area is used for:

- Food service Hours: _____ to _____
- Alcohol service Hours: 12 PM to 10 PM
- Enclosed, how _____

The exterior area is adequately viewed and/or supervised by Service Permittees.

_____ (Investigator's Initials)

Seasonal Variations: Yes No If yes, explain: _____

ENTERTAINMENT

Check all that apply:

- Live Music
- Recorded Music
- DJ Music
- Dancing
- Nude Entertainers
- Karaoke
- Coin-operated Games
- Video Lottery Machines
- Social Gaming
- Pool Tables
- Other: _____

DAYS & HOURS OF LIVE OR DJ MUSIC

Sunday	_____ to _____
Monday	_____ to _____
Tuesday	_____ to _____
Wednesday	_____ to _____
Thursday	_____ to _____
Friday	_____ to _____
Saturday	_____ to _____

SEATING COUNT

Restaurant: _____ Outdoor: 18

Lounge: 49 Other (explain): _____

Banquet: _____ Total Seating: 67

OLCC USE ONLY	
Investigator Verified Seating: _____ (Y) _____ (N)	
Investigator Initials: _____	
Date: _____	

I understand if my answers are not true and complete, the OLCC may deny my license application.

Applicant Signature: [Signature] Date: 04/11/17

1-800-452-OLCC (6522)

www.oregon.gov/olcc

(rev. 12/07)

OREGON LIQUOR CONTROL COMMISSION
LIMITED LIABILITY COMPANY QUESTIONNAIRE



1280283-96

Please Print or Type

LLC Name: KURSMATCHPOOLE, LLC Year Filed: 2017 ✓

Trade Name (dba): Imperial Bottle Shop & Taproom

Business Location Address: 2006 NE Alberta Street

City: Portland, OR ZIP Code: 97211

List Members of LLC:

Percentage of Membership Interest:

- | | |
|--|------------|
| 1. <u>Peach & Bear, LLC</u>
(managing member) | <u>50%</u> |
| 2. <u>SMATCH, LLC</u>
(members) | <u>50%</u> |
| 3. _____ | _____ |
| 4. _____ | _____ |
| 5. _____ | _____ |
| 6. _____ | _____ |

(Note: If any LLC member is another legal entity, that entity must also complete an LLC, Limited Partnership or Corporation Questionnaire. If the LLC has officers, please list them on a separate sheet of paper with their titles.)

Server Education Designee: Shawn Alyson Stackpoole DOB: 07-10-80

I understand that if my answers are not true and complete, the OLCC may deny my license application.

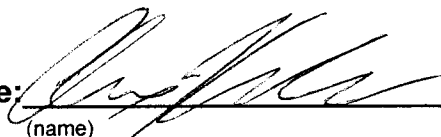
Signature:  member
(name) (title) Date: 04/10/17

OREGON LIQUOR CONTROL COMMISSION
LIMITED LIABILITY COMPANY QUESTIONNAIRE



907283-96

Please Print or Type

LLC Name: Peach & Bear LLC Year Filed: 2013 ✓

Trade Name (dba): Imperial Bottle Shop & Taproom

Business Location Address: 3090 SE Division Street

City: Portland ZIP Code: 97202

List Members of LLC:

Percentage of Membership Interest:

- | | |
|--|-----------|
| 1. <u>Alexander C Kurnellas</u>
(managing member) | <u>50</u> |
| 2. <u>Shawn A. Stackpoole</u>
(members) | <u>50</u> |
| 3. _____ | _____ |
| 4. _____ | _____ |
| 5. _____ | _____ |
| 6. _____ | _____ |

(Note: If any LLC member is another legal entity, that entity must also complete an LLC, Limited Partnership or Corporation Questionnaire. If the LLC has officers, please list them on a separate sheet of paper with their titles.)

Server Education Designee: Shawn A Stackpoole DOB: 07-10-80

I understand that if my answers are not true and complete, the OLCC may deny my license application.

Signature:  member Date: 04/10/17
(name) (title)

CITY OF PORTLAND LIQUOR OUTLET INFORMATION FORM

PLEASE SUBMIT TO: Liquor Licensing Notification Program, 1221 SW 4th Avenue, Suite #110, Portland OR 97204

On New Outlet applications, property owners within 300 feet of the location, the Portland Police Bureau and all interested parties are notified by mail (with a copy of this form) and given an opportunity to comment on your application. The OLCC allows the City at least 45 days to complete the recommendation process. Submission of a complete operating plan can expedite the time required to process. A City liquor endorsement is not a confirmation that the property is properly zoned. Call (503) - 823-7526 to confirm that the property is properly zoned.

On submission of this form, you must also include the following:

- OLCC Liquor Application Form, initialed by your OLCC License Investigator
- OLCC Individual History Forms (all persons anticipated to have a financial interest, or key personnel are required)
- City Endorsement Fees

City Endorsement Fees are payable at the beginning of the application process (please make checks payable to City of Portland): New outlets are \$100.00, all others are \$75.00. All blank sections must be filled in. If the question does not apply, write "N/A" in the space.

LEGAL NAME OF BUSINESS: KURSMATCHPOOLE, LLC

DBA OR TRADE NAME: Imperial Bottle Shop & Taproom PHONE: 971-302-6899 FAX: N/A

BUSINESS ADDRESS (Including ZIP Code): 2006 NE Alberta Street, Portland, OR 97211

WHAT TYPE OF LIQUOR ARE YOU APPLYING FOR? (Change of owner, new outlet, beer & wine, etc.): new outlet, beer & wine

CONTACT PERSON: Alexander Kurnellas PHONE: 971-302-6899 EMAIL: info@imperialbottleshop.com

DESCRIPTION OF OUTLET

TYPE OF OPERATION (CHECK ALL THAT APPLY)

- Food Cart Night Club
 Restaurant Sports Bar
 Convenience Store Other: Beer bar & bottle shop

SIZE OF SERVICE AREA: 1,650 sf

EXISTING BUILDING: Yes No

ZONING: commerical

STRUCTURAL CHANGES (DESCRIBE): N/A

RESTAURANT SEATING CAPACITY: 61 LOUNGE SEATING CAPACITY: 49 OUTSIDE SEATING CAPACITY: 12

DESCRIBE SECURITY: alarm system, three cameras, 1-2 bartenders on site

HAS AN APPLICATION FOR A LIQUOR LICENSE AT THIS LOCATION BEEN RECEIVED BY THE CITY OF PORTLAND IN THE LAST TWO (2) YEARS?
 Yes No I Don't Know

HOURS OF OPERATION

SUNDAY - THURSDAY OPEN: noon CLOSE: 10pm FRIDAY & SATURDAY OPEN: noon CLOSE: 12am

HOW LATE WILL THERE BE OUTSIDE SEATING? 10PM HOW LATE WILL THERE BE ENTERTAINMENT? N/A

HISTORY OF LOCATION

PREVIOUS BUSINESS NAME OF THIS LOCATION: do not know

NAME & ADDRESS OF PROPERTY OWNER: 20 Alberta South LLC, PO Box 12145 Portland, OR 97212

ENTERTAINMENT

TYPE OF ENTERTAINMENT (CHECK ALL THAT APPLY)

- Dancing Video Poker Live Music Nude Dancers
 Karaoke Video Games/Pinball Recorded Music DJ Entertainment
 Pool Tables (How Many): _____ Events (Describe): _____ Other: _____

The City requires an **Amusement Location Permit** for all locations with amusement devices or pool tables. **Contact the Revenue Bureau for rules and an Amusement Location Permit application form now.** Permits are non-transferable from one owner to another and must be paid before games are placed on the premises. Contact Anne Holm at 503-865-2488. The City of Portland will notify affected nearby neighbors and a copy of this form will be included in our mailing.

Use this area to provide any additional information that you wish to be considered on this liquor application

N/A

A false answer or omission of any requested information may result in an unfavorable City recommendation.

SIGNATURE: _____

DATE: 04/10/17

File Edit View Drawing Help

Database Search Panel

Owner: Nat 20 ALBERTA SOUTH LLC %
 Street Address: 2000 NE ALBERTA ST
 State ID: 1N1E23AD 7600
 Account #: R295349

- Search
- Clear
- Portland Maps
- Geocode Address When Lat/Long Not
- Search is Based on Active Field Only
- Hide Personal Property Accounts
- Display Tax/Parcel Detail Window

Owner: 20 ALBERTA... 2000 NE AL... 1N1E...

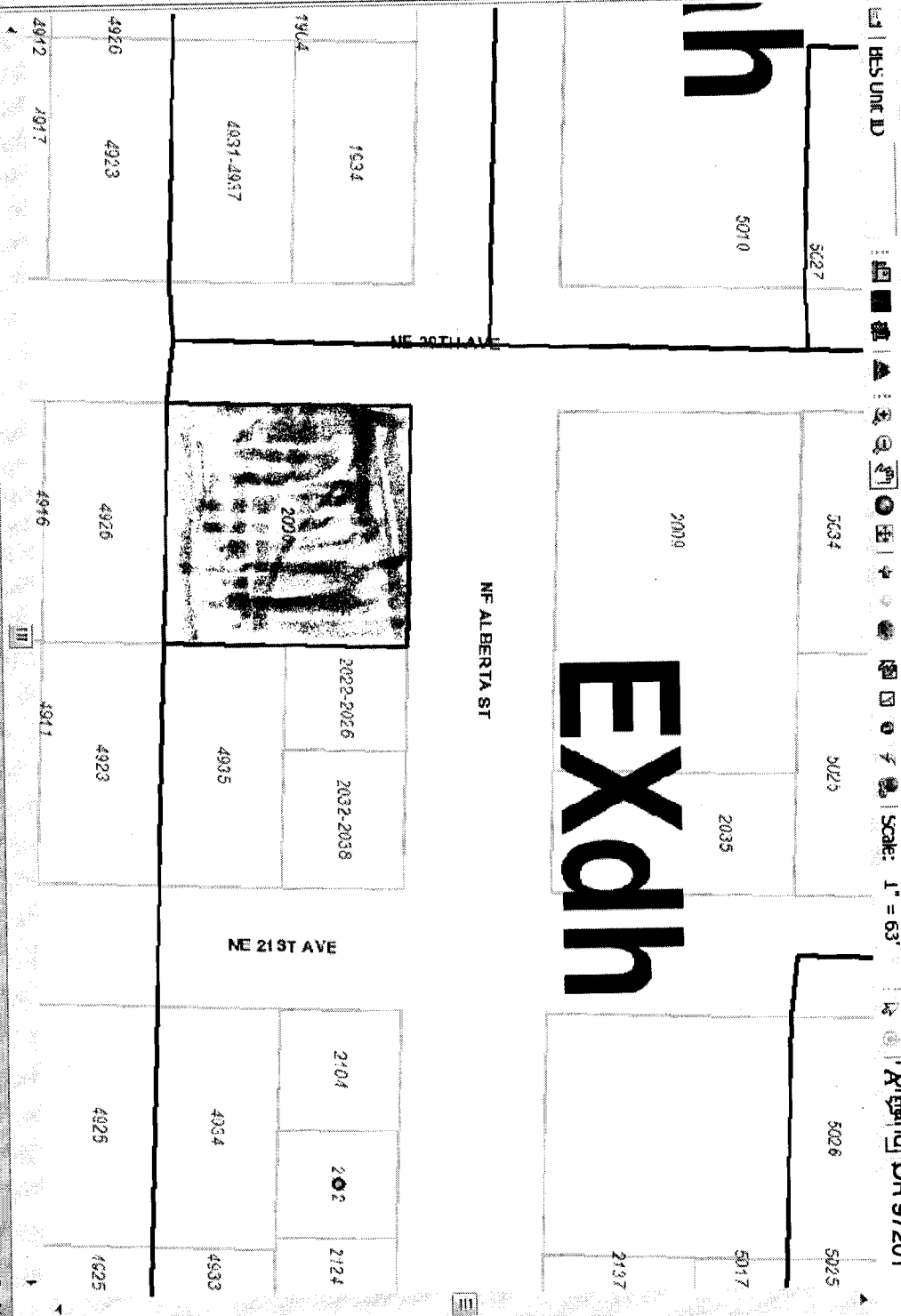

Tax/Parcel Details

Lot Size: 10000 sqft Building Size: 10000 sqft Main Number: 2532
 Legal Description: VERNON, BLOCK 37, LOT 182 Lot & Block: 182
 Main Information: 20 ALBERTA SOUTH LLC % Conservation District: 37
 Jurisdiction: Portland

1/4 Section Tax Map Zoning Map
 Plat District: LUR Case Hist(1 Case)
 SubDistrict: EA 15-219711 APPT
 SubArea: LUR

Search Legend Add Data Sel < >

Retail Sales & Service allowed by right in EXDn zoning. 4-17-17 Thomas bbb

Scale 1 inch = 63 feet