



OREGON LIQUOR CONTROL COMMISSION LIQUOR LICENSE APPLICATION

DT

Application is being made for:

LICENSE TYPES

- Full On-Premises Sales (\$402.60/yr)
- Commercial Establishment
- Caterer
- Passenger Carrier
- Other Public Location
- Private Club
- Limited On-Premises Sales (\$202.60/yr)
- Off-Premises Sales (\$100/yr)
 - with Fuel Pumps
- Brewery Public House (\$252.60)
- Winery (\$250/yr)
- Other: _____

ACTIONS

- Change Ownership
- New Outlet
- Greater Privilege
- Additional Privilege
- Other _____

Rec'd by Portland
Liquor Licenses
MAY 08 2017
PD \$100

90-DAY AUTHORITY

Check here if you are applying for a change of ownership at a business that has a current liquor license, or if you are applying for an Off-Premises Sales license and are requesting a 90-Day Temporary Authority

APPLYING AS:

- Limited Partnership
- Corporation
- Limited Liability Company
- Individuals

CITY AND COUNTY USE ONLY

Date application received: _____

The City Council or County Commission: _____

(name of city or county)

recommends that this license be:

- Granted
- Denied

By: _____
(signature) (date)

Name: _____

Title: _____

OLCC USE ONLY

Application Rec'd by: [Signature]

Date: 4-18-17

90-day authority: Yes No

1. Entity or Individuals applying for the license: [See SECTION 1 of the Guide]

① Steven Straub, Inc. ③ _____

② _____ ④ _____

2. Trade Name (dba): Gateway Liquor Store

3. Business Location: 10320 NE Halsey St. Portland, Multnomah
(number, street, rural route) (city) (county) (state) (ZIP code)

4. Business Mailing Address: 10320 NE Halsey St. OR 97220
(PO box, number, street, rural route) (city) (state) (ZIP code)

5. Business Numbers: 503-252-4561 503-254-4170
(phone) (fax)

6. Is the business at this location currently licensed by OLCC? Yes No

7. If yes to whom: _____ Type of License: _____

8. Former Business Name: _____

9. Will you have a manager? Yes No Name: _____
(manager must fill out an Individual History form)

10. What is the local governing body where your business is located? City of Portland - Multnomah
(name of city or county)

11. Contact person for this application: Steven W. Straub 503-928-2751
(name) (phone number(s))
14222 SE Oakfield Rd. 503-254-4170 gatewayliquorstore@gmail.com
(address) (city, state, ZIP) (fax number) (e-mail address)

I understand that if my answers are not true and complete, the OLCC may deny my license application.

Applicant(s) Signature(s) and Date:

① [Signature] Date 3/30/17

② _____ Date _____

RECEIVED

Date APR 18 2017

Initials: _____
Oregon Liquor Control Commission



OREGON LIQUOR CONTROL COMMISSION BUSINESS INFORMATION

Please Print or Type

Applicant Name: Steven Straub, Inc Phone: 503-252-4561
 Trade Name (dba): Gateway Liquor Store 503-928-2751 (cell)
 Business Location Address: 10320 NE Halsey St.
 City: Portland ZIP Code: 97220

DAYS AND HOURS OF OPERATION

Business Hours:

Sunday 12:00 to 5:00
 Monday 11:00 to 8:00
 Tuesday 11:00 to 8:00
 Wednesday 11:00 to 8:00
 Thursday 11:00 to 8:00
 Friday 10:00 to 9:00
 Saturday 10:00 to 9:00

Outdoor Area Hours:

Sunday _____ to _____
 Monday N/A to A
 Tuesday N/A to A
 Wednesday _____ to _____
 Thursday _____ to _____
 Friday _____ to _____
 Saturday _____ to _____

The outdoor area is used for:

Food service Hours: _____ to _____
 Alcohol service Hours: N/A to _____
 Enclosed, how _____

The exterior area is adequately viewed and/or supervised by Service Permittees.

(Investigator's Initials)

Seasonal Variations: Yes No If yes, explain: _____

ENTERTAINMENT

Check all that apply:

- Live Music Karaoke
 Recorded Music Coin-operated Games
 DJ Music Video Lottery Machines
 Dancing Social Gaming
 Nude Entertainers Pool Tables
 Other: _____

DAYS & HOURS OF LIVE OR DJ MUSIC

Sunday _____ to _____
 Monday N/A to A
 Tuesday N/A to A
 Wednesday _____ to _____
 Thursday _____ to _____
 Friday _____ to _____
 Saturday _____ to _____

SEATING COUNT

Restaurant: _____ Outdoor: _____
 Lounge: _____ Other (explain): N/A
 Banquet: _____ Total Seating: _____

OLCC USE ONLY

Investigator Verified Seating: _____ (Y) _____ (N)
 Investigator Initials: _____
 Date: _____

I understand if my answers are not true and complete, the OLCC may deny my license application.

Applicant Signature: Steven Straub Date: 3-30-17

1-800-452-OLCC (6522)

www.oregon.gov/olcc

(rev. 12/07)



OREGON LIQUOR CONTROL COMMISSION
CORPORATION QUESTIONNAIRE

1291983-96 ✓

Please Print or Type

Corporation Name: Steven Straub, INC Year Incorporated: 2017

Trade Name (dba): Gateway Liquor Store

Business Location Address: 10320 NE Halsey St.

City: Portland, OR ZIP Code: 97220

List Corporate Officers:

Steve Straub
(name)

President
(title)

List Board of Directors:

(name) N/A

List Stockholders: (Note: If any stockholder is another legal entity, that entity may also need to complete another Corporation Questionnaire. See Liquor License Application Guide for more information.)

Stockholders:	Number of Shares Held:	Number of Stock Shares:
<u>N/A</u>		Issued: _____
		Unissued: _____
		Total Shares Authorized to Issue: _____

Server Education Designee: _____ DOB: _____
(See Liquor License Application Guide for more information)

I understand that if my answers are not true and complete, the OLCC may deny my license application.

Officer's Signature: [Signature] Date: 3/30/17
(name) (title)

CITY OF PORTLAND LIQUOR OUTLET INFORMATION FORM

PLEASE SUBMIT TO: Liquor Licensing Notification Program, 1221 SW 4th Avenue, Suite #110, Portland OR 97204

On New Outlet applications, property owners within 300 feet of the location, the Portland Police Bureau and all interested parties are notified by mail (with a copy of this form) and given an opportunity to comment on your application. The OLCC allows the City at least 45 days to complete the recommendation process. Submission of a complete operating plan can expedite the time required to process. A City liquor endorsement is not a confirmation that the property is properly zoned. Call (503) - 823-7526 to confirm that the property is properly zoned.

On submission of this form, you must also include the following:

- OLCC Liquor Application Form, initialed by your OLCC License Investigator
- OLCC Individual History Forms (all persons anticipated to have a financial interest, or key personnel are required)
- City Endorsement Fees

City Endorsement Fees are payable at the beginning of the application process (please make checks payable to City of Portland): New outlets are \$100.00, all others are \$75.00. All blank sections must be filled in. If the question does not apply, write "N/A" in the space.

LEGAL NAME OF BUSINESS: CATEWAY LIQUOR STORE

DBA OR TRADE NAME: Cateway Liquor Store PHONE: 503-254-4170 FAX: 503-254-4170

BUSINESS ADDRESS (Including ZIP Code): 10320 NE Ambrey Street, Portland OR 97200

WHAT TYPE OF LIQUOR ARE YOU APPLYING FOR? (Change of owner, new outlet, beer & wine, etc.): BEER & WINE

CONTACT PERSON: Steve Straub PHONE: 503-928-2251 EMAIL: straub65@gmail.com

DESCRIPTION OF OUTLET

TYPE OF OPERATION (CHECK ALL THAT APPLY)

- | | |
|--|---|
| <input type="checkbox"/> Food Cart | <input type="checkbox"/> Night Club |
| <input type="checkbox"/> Restaurant | <input type="checkbox"/> Sports Bar |
| <input type="checkbox"/> Convenience Store | <input type="checkbox"/> Other: <u>Liquor Store</u> |

SIZE OF SERVICE AREA: 1400 SQ FT

EXISTING BUILDING: Yes No

ZONING: CED

STRUCTURAL CHANGES (DESCRIBE): None

RESTAURANT SEATING CAPACITY: NA LOUNGE SEATING CAPACITY: NA OUTSIDE SEATING CAPACITY: NA

DESCRIBE SECURITY: Video Security 24 hr, Window Bars & Glass Top & 24 hr ADT monitoring

HAS AN APPLICATION FOR A LIQUOR LICENSE AT THIS LOCATION BEEN RECEIVED BY THE CITY OF PORTLAND IN THE LAST TWO (2) YEARS?
 Yes No I Don't Know

HOURS OF OPERATION

SUNDAY - THURSDAY OPEN: 10:00 AM CLOSE: 8:00 PM FRIDAY & SATURDAY OPEN: 10:00 AM CLOSE: 9:00 PM

HOW LATE WILL THERE BE OUTSIDE SEATING? NA HOW LATE WILL THERE BE ENTERTAINMENT? NA

HISTORY OF LOCATION

PREVIOUS BUSINESS NAME OF THIS LOCATION: CATEWAY LIQUOR

NAME & ADDRESS OF PROPERTY OWNER: SAX CATEWAY PROPERTIES LLC

ENTERTAINMENT

TYPE OF ENTERTAINMENT (CHECK ALL THAT APPLY)

- | | | | |
|--|---|---|---|
| <input type="checkbox"/> Dancing | <input type="checkbox"/> Video Poker | <input type="checkbox"/> Live Music | <input type="checkbox"/> Nude Dancers |
| <input type="checkbox"/> Karaoke | <input type="checkbox"/> Video Games/Pinball | <input type="checkbox"/> Recorded Music | <input type="checkbox"/> DJ Entertainment |
| <input type="checkbox"/> Pool Tables (How Many): _____ | <input type="checkbox"/> Events (Describe): _____ | <input type="checkbox"/> Other: <u>NA</u> | |

The City requires an Amusement Location Permit for all locations with amusement devices or pool tables. Contact the Revenue Bureau for rules and an Amusement Location Permit application form now. Permits are non-transferable from one owner to another and must be paid before games are placed on the premises. Contact Anne Holm at 503-865-2488. The City of Portland will notify affected nearby neighbors and a copy of this form will be included in our mailing.

Use this area to provide any additional information that you wish to be considered on this liquor application

A false answer or omission of any requested information may result in an unfavorable City recommendation.

SIGNATURE: [Signature] DATE: 05/03/2017

Property Search

Owner Name: Saxe Gateway Properties LLC
 Site Address: 10320 NE Halsey St
 State ID: IN2E348B 1400
 Account #: R249660

- Geocode Address When Taxlot Not Found
- Search is Based on Active Field Only
- Hide Personal Property Accounts
- Display Taxlot Detail Window

Navigate Query Results

Owner: Saxe Gateway
 Site Address: 10320 NE Halsey St
 State: IN

Bureau of Development Services
 Land Use Service Division
 1800 SW 4th Ave, Suite 5008
 Portland, OR 97201

Retail Sales v service allowed in Cxd zoning & Gateway plan district
John Dwyer, 5-3-17

Search Legend Add Data Selection

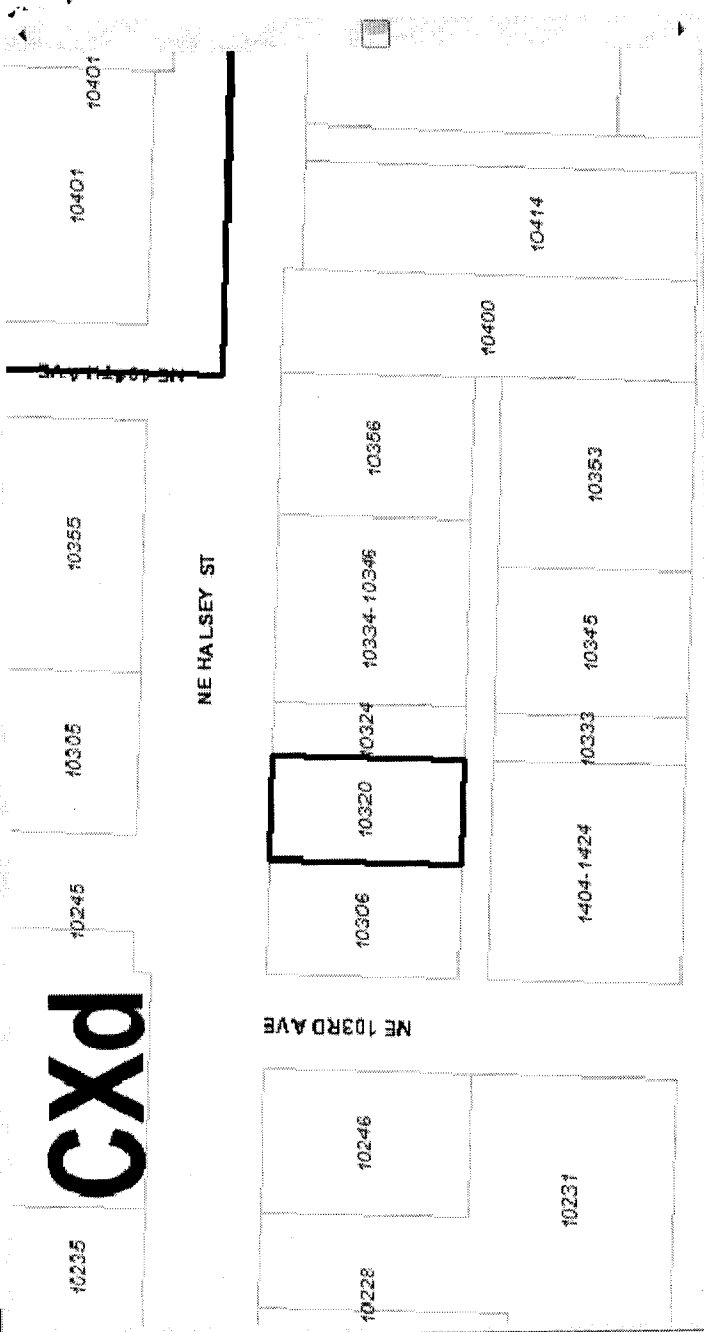

Taxlot Details

Lot Size: 5500 sqft
 Building Size: 5305 sqft
 Map Number: 2941
 Lot & Block: 3&4
 Zoning Code(s): Cxd

Legal Description: POWERS ADD, BLOCK 2, LOT 3&4
 Conservation District:
 Historic District:
 SubArea:
 Jurisdiction: Portland

Mailing Information:
 Saxe Gateway Properties LLC
 4714 SW Snyder Pl
 Portland, OR 97221

Plan District: GATEWAY
 SubDistrict:
 LUR Case No: LU 07-1697
 Tax Map:
 Draw LUR

Scale 1 inch = 100 feet