



OREGON LIQUOR CONTROL COMMISSION
LIQUOR LICENSE APPLICATION

DT

Application is being made for:

LICENSE TYPES

Full On-Premises Sales (\$402.60/yr)

Commercial Establishment

Caterer

Passenger Carrier

Other Public Location

Private Club

Limited On-Premises Sales (\$202.60/yr)

Off-Premises Sales (\$100/yr)

with Fuel Pumps

Brewery Public House (\$252.60)

Winery (\$250/yr)

Other: _____

ACTIONS

Change Ownership

New Outlet

Greater Privilege

Additional Privilege

Other _____

Rec'd by Portland
Liquor Licenses

MAY 10 2017

PD 100⁰⁰ AS

1211

90-DAY AUTHORITY

Check here if you are applying for a change of ownership at a business that has a current liquor license, or if you are applying for an Off-Premises Sales license and are requesting a 90-Day Temporary Authority

APPLYING AS:

Limited Partnership

Corporation

Limited Liability Company

Individuals

CITY AND COUNTY USE ONLY

Date application received: _____

The City Council or County Commission: _____

(name of city or county)

recommends that this license be:

Granted Denied

By: _____ (signature) _____ (date)

Name: _____

Title: _____

OLCC USE ONLY

Application Rec'd by: AS

Date: 5-3-17

90-day authority: Yes No

1. Entity or Individuals applying for the license: [See SECTION 1 of the Guide]

① The Outer Rim, LLC ③ _____

② Gateway Brewing, Inc ④ _____

2. Trade Name (dba): Bikes and Beer

3. Business Location: 10625 NE Halsey Portland Mult OR 97220
(number, street, rural route) (city) (county) (state) (ZIP code)

4. Business Mailing Address: 10625 NE Halsey Portland OR 97220
(PO box, number, street, rural route) (city) (state) (ZIP code)

5. Business Numbers: (503) 278-3235 NA
(phone) (fax)

6. Is the business at this location currently licensed by OLCC? Yes No

7. If yes to whom: NA Type of License: NA

8. Former Business Name: NA

9. Will you have a manager? Yes No Name: Brandon Fite
(manager must fill out an Individual History form)

10. What is the local governing body where your business is located? City of Portland ✓
(name of city or county)

11. Contact person for this application: Karen Sheley (503) 957-2522
(name) (phone number(s))
114 NE 133rd Ave Portland 97230 Karen@gatewaybrewingpdx.com
(address) (fax number) (e-mail address)

I understand that if my answers are not true and complete, the OLCC may deny my license application.

Applicant(s) Signature(s) and Date:

① Charles P Jones Date 03-27-17 ③ _____

② Karen Sheley Date 3-27-17 ④ _____

RECEIVED

Date 27 2017

Initials: AS

Oregon Liquor Control Commission



OREGON LIQUOR CONTROL COMMISSION
BUSINESS INFORMATION

Please Print or Type

Applicant Name: The Outer Rim LLC
Bikes and Beer Phone: (503) 957-2522

Trade Name (dba): Bikes and Beer

Business Location Address: 10625 NE Halsey St

City: Portland ZIP Code: 97089

DAYS AND HOURS OF OPERATION

Business Hours:

Sunday	<u>9</u>	to	<u>10</u>
Monday	<u>9</u>	to	<u>10</u>
Tuesday	<u>9</u>	to	<u>10</u>
Wednesday	<u>9</u>	to	<u>10</u>
Thursday	<u>9</u>	to	<u>10</u>
Friday	<u>9</u>	to	<u>10</u>
Saturday	<u>9</u>	to	<u>10</u>

Outdoor Area Hours:

Sunday	<u>9</u>	to	<u>10</u>
Monday	<u>9</u>	to	<u>10</u>
Tuesday	<u>9</u>	to	<u>10</u>
Wednesday	<u>9</u>	to	<u>10</u>
Thursday	<u>9</u>	to	<u>10</u>
Friday	<u>9</u>	to	<u>10</u>
Saturday	<u>9</u>	to	<u>10</u>

The outdoor area is used for:

Food service Hours: 9 to 10

Alcohol service Hours: 9 to 10

Enclosed, how fence

The exterior area is adequately viewed and/or supervised by Service Permittees.

_____ (Investigator's Initials)

Seasonal Variations: Yes No If yes, explain: _____

ENTERTAINMENT

Check all that apply:

<input type="checkbox"/> Live Music	<input type="checkbox"/> Karaoke
<input type="checkbox"/> Recorded Music	<input type="checkbox"/> Coin-operated Games
<input type="checkbox"/> DJ Music	<input type="checkbox"/> Video Lottery Machines
<input type="checkbox"/> Dancing	<input type="checkbox"/> Social Gaming
<input type="checkbox"/> Nude Entertainers	<input type="checkbox"/> Pool Tables
	<input type="checkbox"/> Other: _____

DAYS & HOURS OF LIVE OR DJ MUSIC

Sunday	_____	to	_____
Monday	_____	to	_____
Tuesday	_____	to	_____
Wednesday	_____	to	_____
Thursday	_____	to	_____
Friday	_____	to	_____
Saturday	_____	to	_____

SEATING COUNT

Restaurant: _____ Outdoor: 30

Lounge: _____ Other (explain): bike shop 30
retail area

Banquet: _____ Total Seating: _____

OLCC USE ONLY

Investigator Verified Seating: ____ (Y) ____ (N)

Investigator Initials: _____

Date: _____

I understand if my answers are not true and complete, the OLCC may deny my license application.

Applicant Signature: Karen Shelley Date: 4/4/2017

OREGON LIQUOR CONTROL COMMISSION
LIMITED LIABILITY COMPANY QUESTIONNAIRE



583461-99

Please Print or Type

LLC Name: The Outer Rim LLC Year Filed: 2009 ✓

Trade Name (dba): ~~The Outer Rim~~ Bikes and Beer

Business Location Address: 10625 NE Halsey St 97220

City: Portland ZIP Code: 97089

List Members of LLC:	Percentage of Membership Interest:
1. <u>CHARLES P JONES</u> (managing member)	<u>100%</u>
2. _____ (members)	_____
3. _____	_____
4. _____	_____
5. _____	_____
6. _____	_____

(Note: If any LLC member is another legal entity, that entity must also complete an LLC, Limited Partnership or Corporation Questionnaire. If the LLC has officers, please list them on a separate sheet of paper with their titles.)

Server Education Designee: Brandon Fite DOB: 10/31/87

I understand that if my answers are not true and complete, the OLCC may deny my license application.

Signature: Charles P Jones, Owner Date: 04-12-17
(name) (title)



OREGON LIQUOR CONTROL COMMISSION
CORPORATION QUESTIONNAIRE

1025612-97

Please Print or Type

Corporation Name: Gateway Brewing Inc Year Incorporated: 2014 ✓

Trade Name (dba): Gateway Brewing, Inc

Business Location Address: 114 NE 133rd Ave

City: Portland ZIP Code: 97230

List Corporate Officers:

Joel Sheley
(name)

Karen Sheley

President
(title)

Treasurer

List Board of Directors:

NA
(name)

List Stockholders: (Note: If any stockholder is another legal entity, that entity may also need to complete another Corporation Questionnaire. See Liquor License Application Guide for more information.)

Stockholders:	Number of Shares Held:	Number of Stock Shares:
<u>Joel Sheley</u>	<u>55</u>	Issued: <u>100</u>
<u>Karen Sheley</u>	<u>45</u>	Unissued: <u>0</u>
		Total Shares Authorized to Issue: <u>100</u>

Server Education Designee: Karen Sheley DOB: 7-6-1969
(See Liquor License Application Guide for more information)

I understand that if my answers are not true and complete, the OLCC may deny my license application.

Officer's Signature: Karen Sheley (name) Treasurer-Officer (title) Date: 4/4/2017

CITY OF PORTLAND LIQUOR OUTLET INFORMATION FORM

PLEASE SUBMIT TO: Liquor Licensing Notification Program, 1221 SW 4th Avenue, Suite #110, Portland OR 97204

On New Outlet applications, property owners within 300 feet of the location, the Portland Police Bureau and all interested parties are notified by mail (with a copy of this form) and given an opportunity to comment on your application. The OLCC allows the City at least 45 days to complete the recommendation process. Submission of a complete operating plan can expedite the time required to process. A City liquor endorsement is not a confirmation that the property is properly zoned. Call (503) - 823-7526 to confirm that the property is properly zoned.

On submission of this form, you must also include the following:

- OLCC Liquor Application Form, initialed by your OLCC License Investigator
- OLCC Individual History Forms (all persons anticipated to have a financial interest, or key personnel are required)
- City Endorsement Fees

City Endorsement Fees are payable at the beginning of the application process (please make checks payable to City of Portland): New outlets are \$100.00, all others are \$75.00. All blank sections must be filled in. If the question does not apply, write "N/A" in the space.

LEGAL NAME OF BUSINESS: Outer Run LLC + Gateway Brewing Inc

DBA OR TRADE NAME: Bikes + Beer PHONE: 503 957-2522 FAX: NA

BUSINESS ADDRESS (Including ZIP Code): 10625 NE Halsey Ave 97230

WHAT TYPE OF LIQUOR ARE YOU APPLYING FOR? (Change of owner, new outlet, beer & wine, etc.): new outlet

CONTACT PERSON: Karen Sheley PHONE: 503-957- EMAIL: Karen@

DESCRIPTION OF OUTLET

TYPE OF OPERATION (CHECK ALL THAT APPLY)

Food Cart Night Club

Restaurant Sports Bar

Convenience Store Other: bike shop

SIZE OF SERVICE AREA: 2522 gatewaybrewingpdx.com
Asd 2910 sq ft.

EXISTING BUILDING: Yes No

ZONING: Csd

STRUCTURAL CHANGES (DESCRIBE): none

RESTAURANT SEATING CAPACITY: 30 LOUNGE SEATING CAPACITY: X OUTSIDE SEATING CAPACITY: 30

DESCRIBE SECURITY: fenced area, cameras, signage

HAS AN APPLICATION FOR A LIQUOR LICENSE AT THIS LOCATION BEEN RECEIVED BY THE CITY OF PORTLAND IN THE LAST TWO (2) YEARS?
 Yes No I Don't Know

HOURS OF OPERATION

SUNDAY - THURSDAY OPEN: 9am CLOSE: 10pm FRIDAY & SATURDAY OPEN: 9am CLOSE: 10pm

HOW LATE WILL THERE BE OUTSIDE SEATING? 10pm HOW LATE WILL THERE BE ENTERTAINMENT? None

HISTORY OF LOCATION

PREVIOUS BUSINESS NAME OF THIS LOCATION: Florist

NAME & ADDRESS OF PROPERTY OWNER: Newmark Properties 621 SW Morrison St
Suite 750 Portland 97205

ENTERTAINMENT

TYPE OF ENTERTAINMENT (CHECK ALL THAT APPLY)

Dancing Video Poker Live Music Nude Dancers

Karaoke Video Games/Pinball Recorded Music DJ Entertainment

Pool Tables (How Many): _____ Events (Describe): _____ Other: _____

The City requires an **Amusement Location Permit** for all locations with amusement devices or pool tables. **Contact the Revenue Bureau for rules and an Amusement Location Permit application form now.** Permits are non-transferable from one owner to another and must be paid before games are placed on the premises. Contact Anne Holm at 503-865-2488. The City of Portland will notify affected nearby neighbors and a copy of this form will be included in our mailing.

Use this area to provide any additional information that you wish to be considered on this liquor application

A false answer or omission of any requested information may result in an unfavorable City recommendation.

SIGNATURE: Karen Sheley

DATE: 5/5/2017

Property Search
 Owner: NAR NEWMARK PROPERTIES L
 Site Address: 10625 NE HALSLEY ST
 State ID: INZE27CC 1900
 Account #: RL110615

- Search
- Clear
- Portland Maps
- Geocode Address When I click on
- Search is based on Active Field Only
- Hide Personal Property Accounts
- Display Taxlot Detail Window

Navigate Query Re [Left Arrow] [Right Arrow] [Home] [End]

Owner: NEWMARK P... 10625 NE H... INZE

City of Portland
 Bureau of Development Services
 Land Use Service Division
 1900 SW 4th Ave. Suite 5000
 Portland, OR 97201

Retail Sales + Service
 allowed by right
 in CS zone

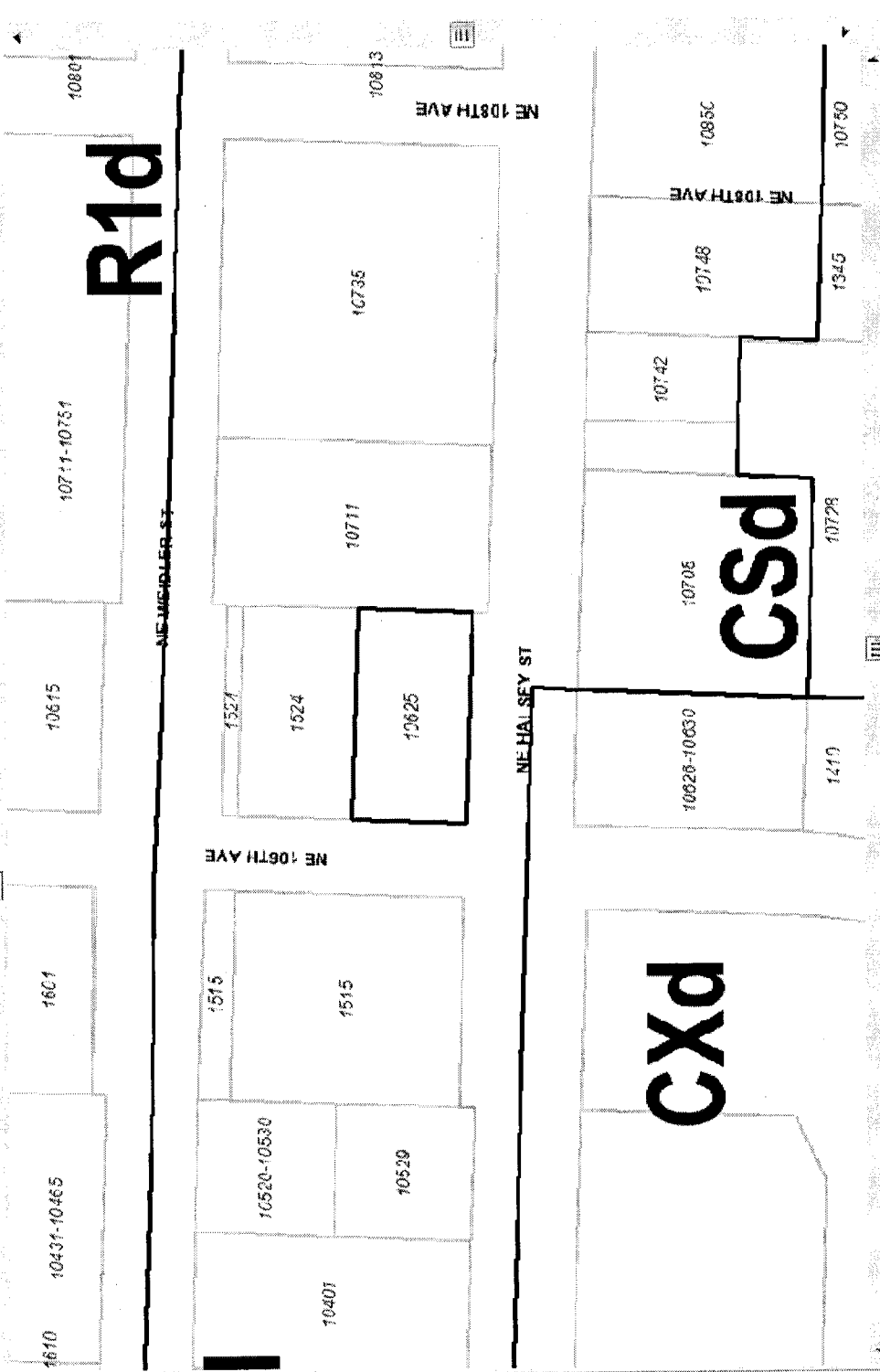

Taxlot Details

Lot Size: 10332 sqft
 Building Size: 2910 sqft
 Main Number: 2871
 Zoning Code(s): CSD

Local Description: ALISTIN AC, LOT 4 TI 1900
 Lot & Block: 4 TH 1900
 Historic District: 1900
 Conservation District:

Mailing Information:
 NEWMARK PROPERTIES LLC ATTN
 MELLES NEWMAR

Jurisdiction: Portland

SubArea:
 NRMP:

PHL District: GATEWAY
 SubDistrict:
 LUR Case History:

1/4 Section
 Tax Map
 Zoning Map

Draw LURS LUR

Search Legend Add Data Sel

Jamie Stevens - City Planner
Jamie Stevens