



OREGON LIQUOR CONTROL COMMISSION  
LIQUOR LICENSE APPLICATION

*DM*

Application is being made for:

**LICENSE TYPES**

Full On-Premises Sales (\$402.60/yr)  
 Commercial Establishment  
 Caterer  
 Passenger Carrier  
 Other Public Location  
 Private Club

Limited On-Premises Sales (\$202.60/yr)  
 Off-Premises Sales (\$100/yr)  
 with Fuel Pumps  
 Brewery Public House (\$252.60)  
 Winery (\$250/yr)  
 Other: \_\_\_\_\_

**ACTIONS**

Change Ownership  
 New Outlet  
 Greater Privilege  
 Additional Privilege  
 Other \_\_\_\_\_

**90-DAY AUTHORITY**

Check here if you are applying for a change of ownership at a business that has a current liquor license, or if you are applying for an Off-Premises Sales license and are requesting a 90-Day Temporary Authority

**APPLYING AS:**

Limited Partnership  Corporation  Limited Liability Company  Individuals

L 237508  
P 50560

**CITY AND COUNTY USE ONLY**

Date application received: \_\_\_\_\_

The City Council or County Commission: \_\_\_\_\_  
 (name of city or county)

recommends that this license be:

Granted  Denied

By: \_\_\_\_\_ (signature) \_\_\_\_\_ (date)

Name: \_\_\_\_\_

Title: \_\_\_\_\_

---

**OLCC USE ONLY**

Application Rec'd by: *[Signature]*

Date: 5-16-17

90-day authority:  Yes  No

Rec'd by Portland  
Liquor Licenses

1. Entity or Individuals applying for the license: [See SECTION 1 of the Guide]

① Lauren Carr Lulupearl, Inc

② William Carr

2. Trade Name (dba): Artemis Foods suite 204

3. Business Location: 1610 SE 3rd Ave Portland Multnomah OR 97214  
 (number, street, rural route) (city) (county) (state) (ZIP code)

4. Business Mailing Address: Same as above  
 (PO box, number, street, rural route) (city) (state) (ZIP code)

5. Business Numbers: 503-233-8539  
 (phone) (fax)

6. Is the business at this location currently licensed by OLCC?  Yes  No

7. If yes to whom: B. Grace Hennicks Type of License: Full on Premises Sales

8. Former Business Name: Artemis Foods Caterer

9. Will you have a manager?  Yes  No Name: \_\_\_\_\_  
 (manager must fill out an Individual History form)

10. What is the local governing body where your business is located? Portland  
 (name of city or county)

11. Contact person for this application: Lauren Carr 503-866-0857  
 (name) (phone number(s))  
4181 Chapman Way Lake Oswego, OR 97035 laurenmcarr@yahoo.com  
 (address) (fax number) (e-mail address)

I understand that if my answers are not true and complete, the OLCC may deny my license application.

Applicant(s) Signature(s) and Date:

① *[Signature]* Date 4/25/17

② *[Signature]* Date 4/25/17



# OREGON LIQUOR CONTROL COMMISSION BUSINESS INFORMATION

Please Print or Type

Applicant Name: Lulu Pearl, Inc Phone: 503-866-0857

Trade Name (dba): Artemis Foods

Business Location Address: 1610 SE 3rd Ave Ste 204

City: Portland ZIP Code: 97214

### DAYS AND HOURS OF OPERATION

#### Business Hours:

Sunday	<u>8</u>	to	<u>5</u>
Monday	<u>8</u>	to	<u>5</u>
Tuesday	<u>8</u>	to	<u>5</u>
Wednesday	<u>8</u>	to	<u>5</u>
Thursday	<u>8</u>	to	<u>5</u>
Friday	<u>8</u>	to	<u>5</u>
Saturday	<u>8</u>	to	<u>5</u>

#### Outdoor Area Hours:

Sunday	_____	to	_____
Monday	_____	to	_____
Tuesday	_____	to	_____
Wednesday	_____	to	_____
Thursday	_____	to	_____
Friday	_____	to	_____
Saturday	_____	to	_____

The outdoor area is used for:

- Food service Hours: \_\_\_\_\_ to \_\_\_\_\_
- Alcohol service Hours: \_\_\_\_\_ to \_\_\_\_\_
- Enclosed, how \_\_\_\_\_

The exterior area is adequately viewed and/or supervised by Service Permittees.

\_\_\_\_\_  
(Investigator's Initials)

Seasonal Variations:  Yes  No If yes, explain: \_\_\_\_\_

### ENTERTAINMENT

Check all that apply:

- Live Music
- Recorded Music
- DJ Music
- Dancing
- Nude Entertainers
- Karaoke
- Coin-operated Games
- Video Lottery Machines
- Social Gaming
- Pool Tables
- Other: \_\_\_\_\_

### DAYS & HOURS OF LIVE OR DJ MUSIC

Sunday	_____	to	_____
Monday	_____	to	_____
Tuesday	_____	to	_____
Wednesday	_____	to	_____
Thursday	_____	to	_____
Friday	_____	to	_____
Saturday	_____	to	_____

### SEATING COUNT

Restaurant: \_\_\_\_\_ Outdoor: \_\_\_\_\_  
 Lounge: \_\_\_\_\_ Other (explain): \_\_\_\_\_  
 Banquet: \_\_\_\_\_ Total Seating: \_\_\_\_\_

#### OLCC USE ONLY

Investigator Verified Seating: \_\_\_\_ (Y) \_\_\_\_ (N)

Investigator Initials: \_\_\_\_\_

Date: \_\_\_\_\_

I understand if my answers are not true and complete, the OLCC may deny my license application.

Applicant Signature: [Signature] Date: 4/25/17

1-800-452-OLCC (6522)

[www.oregon.gov/olcc](http://www.oregon.gov/olcc)

(rev. 12/07)



OREGON LIQUOR CONTROL COMMISSION  
CORPORATION QUESTIONNAIRE

1309865-99

Please Print or Type

Corporation Name: Lulupearl, Inc Year Incorporated: 2017 ✓

Trade Name (dba): Artemis Foods

Business Location Address: 11010 SE 3<sup>rd</sup> Ave Ste 204

City: Portland ZIP Code: 97214

List Corporate Officers:

Lauren Carr  
(name)

Gail Carr

President  
(title)

Secretary

List Board of Directors:

(name)

List Stockholders: (Note: If any stockholder is another legal entity, that entity may also need to complete another Corporation Questionnaire. See Liquor License Application Guide for more information.)

Stockholders: William Carr

Number of Shares Held: 10

Number of Stock Shares:	
Issued:	_____
Unissued:	_____
Total Shares Authorized to Issue:	_____

Server Education Designee: Lauren Carr DOB: 11/19/72  
(See Liquor License Application Guide for more information)

I understand that if my answers are not true and complete, the OLCC may deny my license application.

Officer's Signature: [Signature] President Date: 5/1/17  
(name) (title)

1-800-452-OLCC (6522)

www.oregon.gov/olcc

(rev. 08/11)

# CITY OF PORTLAND LIQUOR OUTLET INFORMATION FORM

PLEASE SUBMIT TO: Liquor Licensing Notification Program, 1221 SW 4<sup>th</sup> Avenue, Suite #110, Portland OR 97204

On New Outlet applications, property owners within 300 feet of the location, the Portland Police Bureau and all interested parties are notified by mail (with a copy of this form) and given an opportunity to comment on your application. The OLCC allows the City at least 45 days to complete the recommendation process. Submission of a complete operating plan can expedite the time required to process. A City liquor endorsement is not a confirmation that the property is properly zoned. Call (503) - 823-7526 to confirm that the property is properly zoned.

On submission of this form, you must also include the following:

- OLCC Liquor Application Form, initialed by your OLCC License Investigator
- OLCC Individual History Forms (all persons anticipated to have a financial interest, or key personnel are required)
- City Endorsement Fees

City Endorsement Fees are payable at the beginning of the application process (please make checks payable to City of Portland): New outlets are \$100.00, all others are \$75.00. All blank sections must be filled in. If the question does not apply, write "N/A" in the space.

LEGAL NAME OF BUSINESS: Lulupearl, Inc

DBA OR TRADE NAME: Artemis Foods PHONE: 503-233-8539 FAX: n/a

BUSINESS ADDRESS (Including ZIP Code): 1610 SE 3rd Ave Portland, OR 97214

WHAT TYPE OF LIQUOR ARE YOU APPLYING FOR? (Change of owner, new outlet, beer & wine, etc.): Change of owner

CONTACT PERSON: Lauren Carr PHONE: 503-233-8539 EMAIL: lauren@artemisfoods.com

## DESCRIPTION OF OUTLET

TYPE OF OPERATION (CHECK ALL THAT APPLY)

- Food Cart  Night Club  
 Restaurant  Sports Bar  
 Convenience Store  Other: Catering

SIZE OF SERVICE AREA: n/a

EXISTING BUILDING: n/a  Yes  No

ZONING: IG-1

STRUCTURAL CHANGES (DESCRIBE): n/a

RESTAURANT SEATING CAPACITY: n/a LOUNGE SEATING CAPACITY: n/a OUTSIDE SEATING CAPACITY: n/a

DESCRIBE SECURITY: n/a

HAS AN APPLICATION FOR A LIQUOR LICENSE AT THIS LOCATION BEEN RECEIVED BY THE CITY OF PORTLAND IN THE LAST TWO (2) YEARS?  
 Yes  No  I Don't Know

## HOURS OF OPERATION

SUNDAY - THURSDAY OPEN: 8:00 CLOSE: 5 FRIDAY & SATURDAY OPEN: 8 CLOSE: 5

HOW LATE WILL THERE BE OUTSIDE SEATING? n/a HOW LATE WILL THERE BE ENTERTAINMENT? n/a

## HISTORY OF LOCATION

PREVIOUS BUSINESS NAME OF THIS LOCATION: Artemis Foods, Inc

NAME & ADDRESS OF PROPERTY OWNER: Grace Hendricks, 1610 SE 3rd Ave Portland, OR 97214

## ENTERTAINMENT

TYPE OF ENTERTAINMENT (CHECK ALL THAT APPLY)

- Dancing  Video Poker  Live Music  Nude Dancers  
 Karaoke  Video Games/Pinball  Recorded Music  DJ Entertainment  
 Pool Tables (How Many): \_\_\_\_\_  Events (Describe): \_\_\_\_\_  Other: \_\_\_\_\_

The City requires an **Amusement Location Permit** for all locations with amusement devices or pool tables. **Contact the Revenue Bureau for rules and an Amusement Location Permit application form now.** Permits are non-transferable from one owner to another and must be paid before games are placed on the premises. Contact Anne Holm at 503-865-2488. The City of Portland will notify affected nearby neighbors and a copy of this form will be included in our mailing.

Use this area to provide any additional information that you wish to be considered on this liquor application

A false answer or omission of any requested information may result in an unfavorable City recommendation.

SIGNATURE: [Signature] DATE: 5/22/17

1610 SE 3<sup>rd</sup> Avenue is zoned "IG1" General Industrial and is located within the Central City Plan District, Central Eastside sub district. Manufacturing and Production uses, such as catering, are an allowed use in the IG1 zone. Brandon Rogers, City Planner, City of Portland Oregon 05/22/17

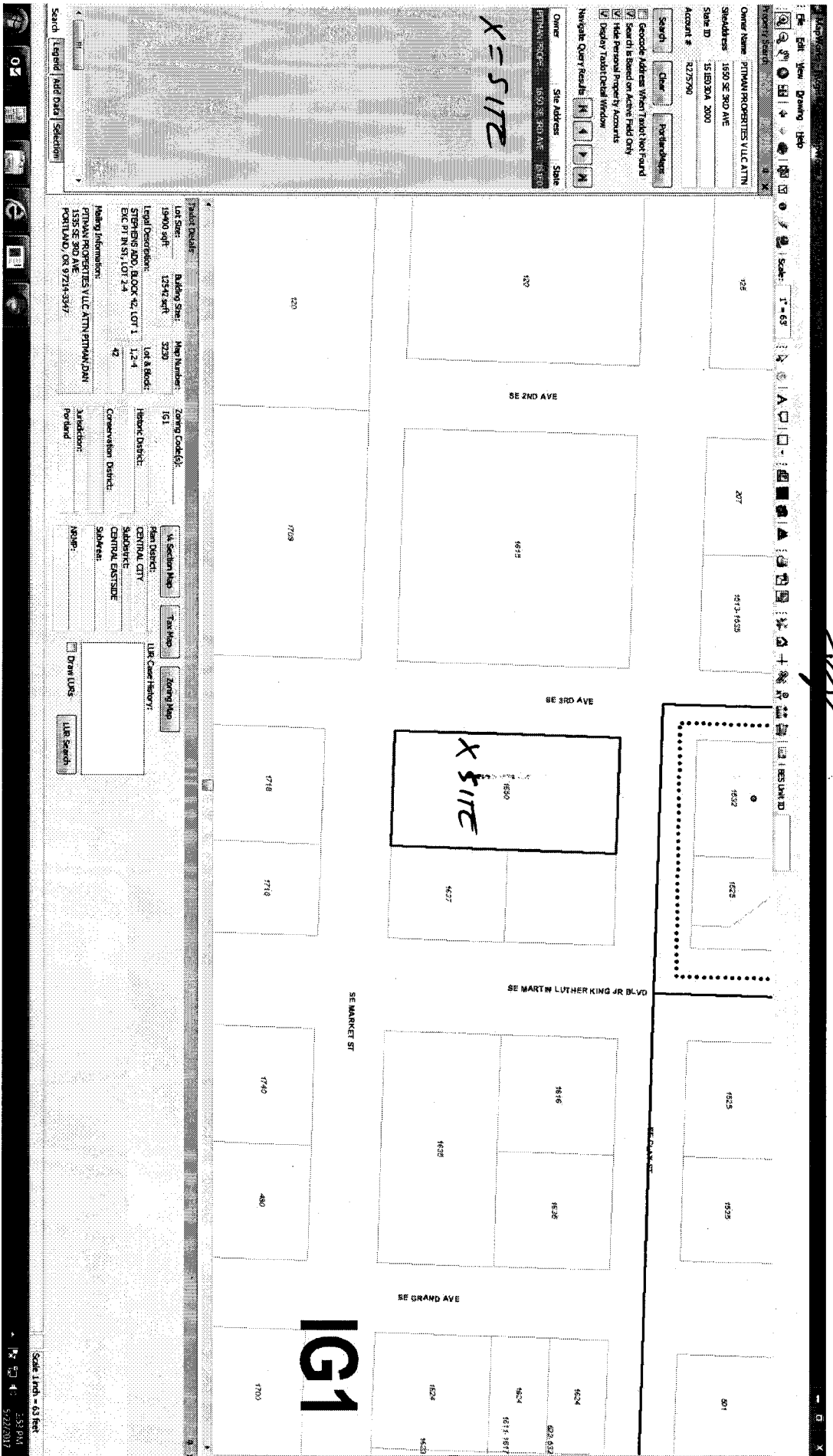

City of Portland  
 Bureau of Development Services  
 Land Use Service Division  
 1900 SW 4th Ave, Suite 5000  
 Portland, OR 97201