



OREGON LIQUOR CONTROL COMMISSION
LIQUOR LICENSE APPLICATION

Pending

Application is being made for:

LICENSE TYPES

- Full On-Premises Sales (\$402.60/yr)
Commercial Establishment
Caterer
Passenger Carrier
Other Public Location
Private Club
Limited On-Premises Sales (\$202.60/yr)
Off-Premises Sales (\$100/yr) with Fuel Pumps
Brewery Public House (\$252.60)
Winery (\$250/yr)
Other:

ACTIONS

- Change Ownership
New Outlet
Greater Privilege
Additional Privilege
Other

* Pendleton Master File *

90-DAY AUTHORITY

Check here if you are applying for a change of ownership at a business that has a current liquor license, or if you are applying for an Off-Premises Sales license and are requesting a 90-Day Temporary Authority

APPLYING AS:

- Limited Partnership
Corporation
Limited Liability Company
Individuals

CITY AND COUNTY USE ONLY

Date application received:

The City Council or County Commission:

(name of city or county)

recommends that this license be:

- Granted
Denied

By: (signature) (date)

Name:

Title:

OLCC USE ONLY

Application Rec'd by:

Date:

90-day authority: Yes No Rec'd by Portland Liquor Licenses

1. Entity or Individuals applying for the license: [See SECTION 1 of the Guide]

1 PENDLETON WOOLEN MILLS, INC. 3

2 4

2. Trade Name (dba): PENDLETON

3. Business Location: 825 SW YAMHILL PORTLAND MULTNOMAH OR 97205
(number, street, rural route) (city) (county) (state) (ZIP code)

4. Business Mailing Address: 220 NW BROADWAY PORTLAND OR 97209
(PO box, number, street, rural route) (city) (state) (ZIP code)

5. Business Numbers: (no number in service yet at the business location)
(phone) (fax)

6. Is the business at this location currently licensed by OLCC? Yes No

7. If yes to whom: Type of License:

8. Former Business Name:

9. Will you have a manager? Yes No Name: Robin Crowell
(manager must fill out an Individual History form)

10. What is the local governing body where your business is located? City of Portland
(name of city or county)

11. Contact person for this application: Carrie Poust Legal Coordinator 503-535-5339
(name) (phone number(s))
220 NW Broadway, Portland OR 97209 503-535-5599 carrie.poust@penwool.com
(address) (fax number) (e-mail address)

I understand that if my answers are not true and complete, the OLCC may deny my license application.

Applicant(s) Signature(s) and Date:

1 [Signature] Date 5/3/17 3

2 Date 4

RECEIVED

MAY 09 2017

Initials: [Signature] Date
Oregon Liquor Control Commission (rev. 08/2011)



OREGON LIQUOR CONTROL COMMISSION BUSINESS INFORMATION

Please Print or Type

Applicant Name: PENDLETON WOOLEN MILLS, INC. Phone: 503-535-5339

Trade Name (dba): PENDLETON

Business Location Address: 825 SW Yamhill

City: Portland ZIP Code: 97205

DAYS AND HOURS OF OPERATION

Business Hours:

Sunday	<u>12</u> to <u>5</u>
Monday	<u>9:30</u> to <u>5:30</u>
Tuesday	_____ to _____
Wednesday	_____ to _____
Thursday	_____ to _____
Friday	_____ to _____
Saturday	<u>10</u> to <u>5</u>

Outdoor Area Hours:

N/A

Sunday	_____ to _____
Monday	_____ to _____
Tuesday	_____ to _____
Wednesday	_____ to _____
Thursday	_____ to _____
Friday	_____ to _____
Saturday	_____ to _____

The outdoor area is used for:

- Food service Hours: _____ to _____
- Alcohol service Hours: _____ to _____
- Enclosed, how _____

The exterior area is adequately viewed and/or supervised by Service Permittees.

(Investigator's Initials)

Seasonal Variations: Yes No If yes, explain: _____

ENTERTAINMENT

Check all that apply:

NONE

- Live Music
- Recorded Music
- DJ Music
- Dancing
- Nude Entertainers
- Karaoke
- Coin-operated Games
- Video Lottery Machines
- Social Gaming
- Pool Tables
- Other: _____

DAYS & HOURS OF LIVE OR DJ MUSIC

N/A

Sunday	_____ to _____
Monday	_____ to _____
Tuesday	_____ to _____
Wednesday	_____ to _____
Thursday	_____ to _____
Friday	_____ to _____
Saturday	_____ to _____

SEATING COUNT

Restaurant: _____ Outdoor: NONE

Lounge: _____ Other (explain): _____

Banquet: _____ Total Seating: _____

OLCC USE ONLY

Investigator Verified Seating: _____ (Y) _____ (N)

Investigator Initials: _____

Date: _____

I understand if my answers are not true and complete, the OLCC may deny my license application.

Applicant Signature: [Signature] Date: 5/3/07

1-800-452-OLCC (6522)

www.oregon.gov/olcc

(rev. 12/07)

CITY OF PORTLAND LIQUOR OUTLET INFORMATION FORM

PLEASE SUBMIT TO: Liquor Licensing Notification Program, 1221 SW 4th Avenue, Suite #110, Portland OR 97204

On New Outlet applications, property owners within 300 feet of the location, the Portland Police Bureau and all interested parties are notified by mail (with a copy of this form) and given an opportunity to comment on your application. The OLCC allows the City at least 45 days to complete the recommendation process. Submission of a complete operating plan can expedite the time required to process. A City liquor endorsement is not a confirmation that the property is properly zoned. Call (503) - 823-7526 to confirm that the property is properly zoned.

On submission of this form, you must also include the following:

- OLCC Liquor Application Form, initialed by your OLCC License Investigator
- OLCC Individual History Forms (all persons anticipated to have a financial interest, or key personnel are required)
- City Endorsement Fees

City Endorsement Fees are payable at the beginning of the application process (please make checks payable to City of Portland): New outlets are \$100.00, all others are \$75.00. All blank sections must be filled in. If the question does not apply, write "N/A" in the space.

LEGAL NAME OF BUSINESS: Pendleton Woolen Mills, Inc.

DBA OR TRADE NAME: Pendleton PHONE: no service yet FAX: 503-535-5599

BUSINESS ADDRESS (including ZIP Code): 825 SW Yamhill, Portland, OR 97205

WHAT TYPE OF LIQUOR ARE YOU APPLYING FOR? (Change of owner, new outlet, beer & wine, etc.): Off-Premises (beer), for new outlet

CONTACT PERSON: Carrie Poust PHONE: 503-535-5339 EMAIL: carrie.poust@penwool.com

DESCRIPTION OF OUTLET

TYPE OF OPERATION (CHECK ALL THAT APPLY)

- Food Cart Night Club
 Restaurant Sports Bar
 Convenience Store Other: retail store

SIZE OF SERVICE AREA: 3,191 sq ft

EXISTING BUILDING: Yes No

ZONING: CXd

STRUCTURAL CHANGES (DESCRIBE): tenant improvements

RESTAURANT SEATING CAPACITY: N/A LOUNGE SEATING CAPACITY: N/A OUTSIDE SEATING CAPACITY: N/A

DESCRIBE SECURITY: Protection 1 alarm system

HAS AN APPLICATION FOR A LIQUOR LICENSE AT THIS LOCATION BEEN RECEIVED BY THE CITY OF PORTLAND IN THE LAST TWO (2) YEARS?
 Yes No I Don't Know

HOURS OF OPERATION

~~SUNDAY~~ ~~THURSDAY~~ OPEN: Mon-Sat 10-8:00 ~~CLOSE~~ Sun 11-6:00 FRIDAY & SATURDAY OPEN: _____ CLOSE: _____

HOW LATE WILL THERE BE OUTSIDE SEATING? N/A HOW LATE WILL THERE BE ENTERTAINMENT? N/A

HISTORY OF LOCATION

PREVIOUS BUSINESS NAME OF THIS LOCATION: None

NAME & ADDRESS OF PROPERTY OWNER: West Park Avenue LLC, c/o TMT Development, 760 SW 9th, Ste 2250, Portland 97205

ENTERTAINMENT

TYPE OF ENTERTAINMENT (CHECK ALL THAT APPLY) None

- Dancing Video Poker Live Music Nude Dancers
 Karaoke Video Games/Pinball Recorded Music DJ Entertainment
 Pool Tables (How Many): _____ Events (Describe): _____ Other: _____

The City requires an **Amusement Location Permit** for all locations with amusement devices or pool tables. **Contact the Revenue Bureau for rules and an Amusement Location Permit application form now.** Permits are non-transferable from one owner to another and must be paid before games are placed on the premises. Contact Anne Holm at 503-865-2488. The City of Portland will notify affected nearby neighbors and a copy of this form will be included in our mailing.

Use this area to provide any additional information that you wish to be considered on this liquor application

Pendleton wants the ability to sell Pendleton Pale Ale and Pendleton Pilsner, which are licensed beer products and the result of a collaboration between Pendleton and Rogue Ales.

A false answer or omission of any requested information may result in an unfavorable City recommendation.

SIGNATURE: Carrie Poust DATE: 6/1/2017

Property Search

Owner Name: WEST PARK AVENUE LLC %TMT D
 Site Address: 728 SW 9TH AVE
 State ID: 1N1E34CC 9700
 Account #: R246979

Geocode Address When Text Not Found
 Search is Based on Active Field Only
 Hide Personal Property Accounts
 Display Textot Detail Window

Navigate's Query Results

Owner: WEST PARK AVENUE... 728 SW 9TH AVE 1N1E34CC

City of Portland
 Bureau of Development Services
 Land Use Service Division
 1500 SW 4th Ave, Suite 5000
 Portland, OR 97201

Per 33.130.100 &
 Table 130-1 and
 33.570.116, retail
 sales and service
 uses are allowed by
 right in the CX
 zone and sites with
 CX zoning in the
 Central City Plan
 District, Downton
 Subdistrict.
 P. Burns
 City Planner
 503-823-7348

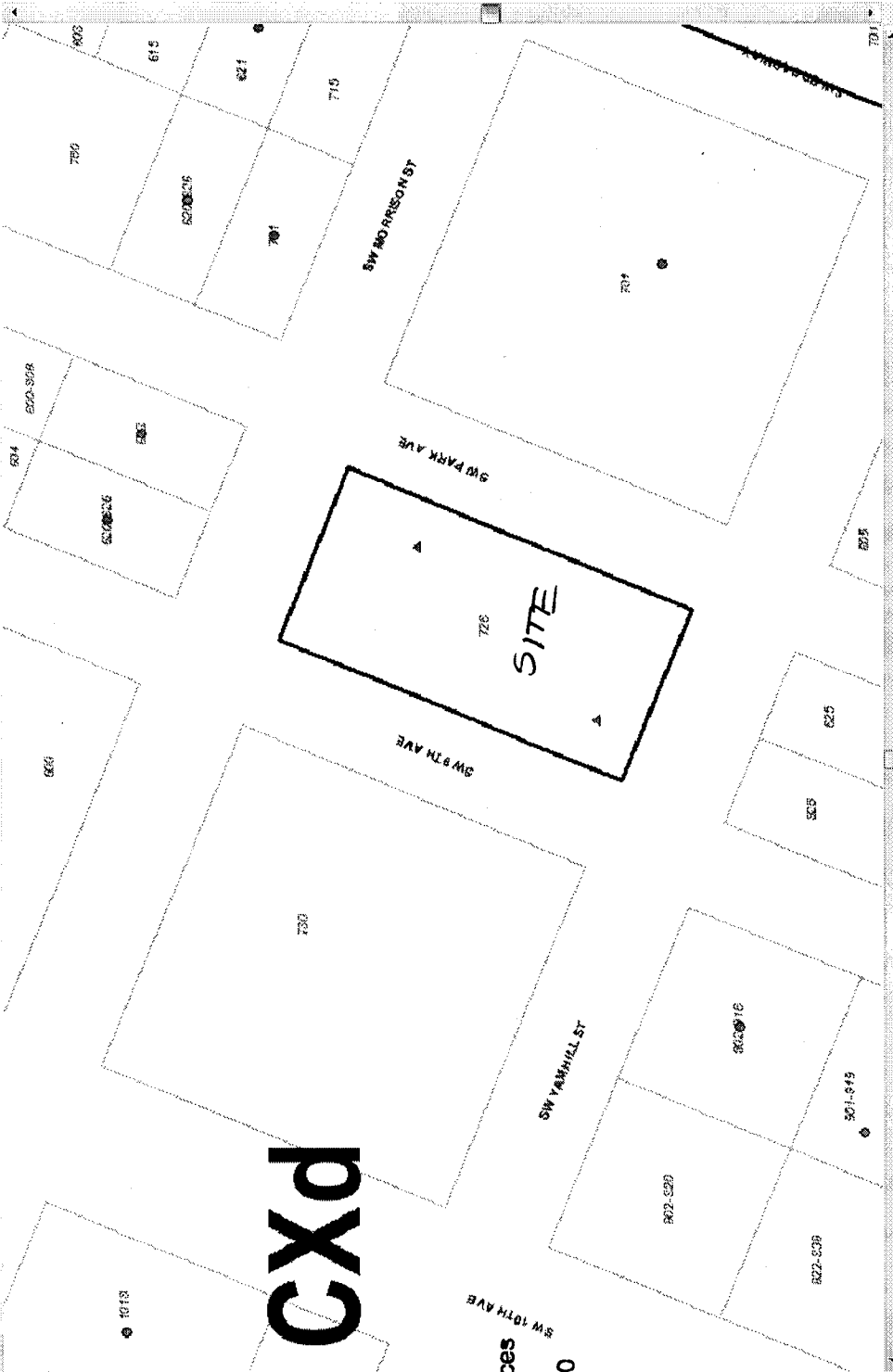

CXd

Taxlot Details

Lot Size: 20000 sqft
 Building Size: 470790 sqft
 Map Number: 3029
 Lot & Block: 1-4
 Legal Description: PORTLAND, PORTLAND PARK BLOCKS, BLOCK 4, LOT 1-4

Zoning Code(s):
 Old: CXd
 New: CXd

Historic District:
 Conservation District:

Jurisdiction: Portland

Mailing Information:
 WEST PARK AVENUE LLC %TMT DEVELOPMENT
 760 SW 9TH AVE #2250
 PORTLAND, OR 97205-2584

% Section Map: Tax Map: Zoning Map

Plan District: CENTRAL CITY
 Subdistrict: DOWNTOWN
 Subareas: N14P-

LUR Case History: (23 Cases)
 DZ 13-81
 DZ 087-90
 DZ 116-84
 DZ 117-88
 DZ 89-85

Draw LURs