



OREGON LIQUOR CONTROL COMMISSION LIQUOR LICENSE APPLICATION

DM

Application is being made for:

LICENSE TYPES

- Full On-Premises Sales (\$402.60/yr)
- Commercial Establishment
 - Caterer
 - Passenger Carrier
 - Other Public Location
 - Private Club
- Limited On-Premises Sales (\$202.60/yr)
- Off-Premises Sales (\$100/yr)
 - with Fuel Pumps
- Brewery Public House (\$252.60)
- Winery (\$250/yr)
- Other: _____

ACTIONS

- Change Ownership
- New Outlet
- Greater Privilege
- Additional Privilege
- Other _____

90-DAY AUTHORITY

Check here if you are applying for a change of ownership at a business that has a current liquor license, or if you are applying for an Off-Premises Sales license and are requesting a 90-Day Temporary Authority

APPLYING AS:

- Limited Partnership
- Corporation
- Limited Liability Company
- Individuals

CITY AND COUNTY USE ONLY

Date application received: _____

The City Council or County Commission:

(name of city or county)

recommends that this license be:

- Granted
- Denied

By: _____
(signature) (date)

Name: _____

Title: _____

OLCC USE ONLY

Application Rec'd by: *JA*

Date: *6-29-17*

90-day authority: Yes No

1. Entity or Individuals applying for the license: [See SECTION 1 of the Guide]

① Protopaco LLC ③ _____
 ② _____ ④ _____

2. Trade Name (dba): Night Light Lounge

3. Business Location: 2100 SE Clinton St Portland Multnomah OR 97202
(number, street, rural route) (city) (county) (state) (ZIP code)

4. Business Mailing Address: 4050 SE Gladstone St Portland OR 97202
(PO box, number, street, rural route) (city) (state) (ZIP code)

5. Business Numbers: (360) 317-6607
(phone)

6. Is the business at this location currently licensed by OLCC? Yes No

7. If yes to whom: Galactic Unicorn Inc Type of License: Full On-Premises Sales

8. Former Business Name: Night Light Lounge

9. Will you have a manager? Yes No Name: _____
(manager must fill out an Individual History form)

10. What is the local governing body where your business is located? Portland, OR
(name of city or county)

11. Contact person for this application: Paul Stevens (360) 317-6607
(name) (phone number(s))
4050 SE Gladstone St, Portland, OR, 97202 twinkisan@hotmail.com
(address) (fax number) (e-mail address)

I understand that if my answers are not true and complete, the OLCC may deny my license application.

Applicant(s) Signature(s) and Date:

① *Paul Stevens* Date 6/21/17 ③ _____
 ② _____ Date _____ ④ _____

RECEIVED

Date JUN 21 2017

Initials: *JA*
Oregon Liquor Control Commission



OREGON LIQUOR CONTROL COMMISSION BUSINESS INFORMATION

Please Print or Type

Applicant Name: ~~Paul Stevens~~ Protopaco LLC Phone: (360) 317-6607

Trade Name (dba): Night Light Lounge

Business Location Address: 2100 SE Clinton St

City: Portland ZIP Code: 97202

DAYS AND HOURS OF OPERATION

Business Hours:

Sunday	<u>10:00am</u>	to	<u>2:30am</u>
Monday	<u>2:00pm</u>	to	<u>2:30am</u>
Tuesday	<u>2:00pm</u>	to	<u>2:30am</u>
Wednesday	<u>2:00pm</u>	to	<u>2:30am</u>
Thursday	<u>2:00pm</u>	to	<u>2:30am</u>
Friday	<u>2:00pm</u>	to	<u>2:30am</u>
Saturday	<u>10:00am</u>	to	<u>2:30am</u>

Outdoor Area Hours:

Sunday	<u>10:00am</u>	to	<u>2:30am</u>
Monday	<u>2:00pm</u>	to	<u>2:30am</u>
Tuesday	<u>2:00pm</u>	to	<u>2:30am</u>
Wednesday	<u>2:00pm</u>	to	<u>2:30am</u>
Thursday	<u>2:00pm</u>	to	<u>2:30am</u>
Friday	<u>2:00pm</u>	to	<u>2:30am</u>
Saturday	<u>10:00am</u>	to	<u>2:30am</u>

The outdoor area is used for:

- Food service Hours: 2:00pm to 2:30am
- Alcohol service Hours: 2:00pm to 2:30am
- Enclosed, how Fencing

The exterior area is adequately viewed and/or supervised by Service Permittees.

_____ (Investigator's Initials)

Seasonal Variations: Yes No If yes, explain: _____

ENTERTAINMENT

Check all that apply:

- | | |
|--|---|
| <input type="checkbox"/> Live Music | <input type="checkbox"/> Karaoke |
| <input type="checkbox"/> Recorded Music | <input type="checkbox"/> Coin-operated Games |
| <input type="checkbox"/> DJ Music | <input type="checkbox"/> Video Lottery Machines |
| <input type="checkbox"/> Dancing | <input type="checkbox"/> Social Gaming |
| <input type="checkbox"/> Nude Entertainers | <input type="checkbox"/> Pool Tables |
| | <input type="checkbox"/> Other: _____ |

DAYS & HOURS OF LIVE OR DJ MUSIC

Sunday	_____	to	_____
Monday	_____	to	_____
Tuesday	_____	to	_____
Wednesday	_____	to	_____
Thursday	_____	to	_____
Friday	_____	to	_____
Saturday	_____	to	_____

SEATING COUNT

Restaurant: 55 Outdoor: 43

Lounge: _____ Other (explain): _____

Banquet: _____ Total Seating: 98

OLCC USE ONLY

Investigator Verified Seating: _____(Y) _____(N)

Investigator Initials: _____

Date: _____

I understand if my answers are not true and complete, the OLCC may deny my license application.

Applicant Signature: [Signature] Date: 6/21/17

OREGON LIQUOR CONTROL COMMISSION
LIMITED LIABILITY COMPANY QUESTIONNAIRE



1320730-99

Please Print or Type

LLC Name: Protopaco LLC Year Filed: 2017 ✓

Trade Name (dba): Night Light Lounge

Business Location Address: 2100 SE Clinton St

City: Portland ZIP Code: 97202

List Members of LLC:

Percentage of Membership Interest:

1. <u>Paul Stevens</u> (managing member)	<u>100</u>
2. _____ (members)	_____
3. _____	_____
4. _____	_____
5. _____	_____
6. _____	_____

(Note: If any LLC member is another legal entity, that entity must also complete an LLC, Limited Partnership or Corporation Questionnaire. If the LLC has officers, please list them on a separate sheet of paper with their titles.)

Server Education Designee: Paul Stevens DOB: 05-21-1980

I understand that if my answers are not true and complete, the OLCC may deny my license application.

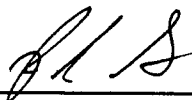
Signature:  Date: 6/24/17
(name) (title)

CITY OF PORTLAND LIQUOR OUTLET INFORMATION FORM

PLEASE SUBMIT TO: Liquor Licensing Notification Program, 1221 SW 4th Avenue, Suite #110, Portland OR 97204

On New Outlet applications, property owners within 300 feet of the location, the Portland Police Bureau and all interested parties are notified by mail (with a copy of this form) and given an opportunity to comment on your application. The OLCC allows the City at least 45 days to complete the recommendation process. Submission of a complete operating plan can expedite the time required to process. A City liquor endorsement is not a confirmation that the property is properly zoned. Call (503) - 823-7526 to confirm that the property is properly zoned.

On submission of this form, you must also include the following:

- OLCC Liquor Application Form, initialed by your OLCC License Investigator
- OLCC Individual History Forms (all persons anticipated to have a financial interest, or key personnel are required)
- City Endorsement Fees

City Endorsement Fees are payable at the beginning of the application process (please make checks payable to City of Portland): New outlets are \$100.00, all others are \$75.00. All blank sections must be filled in. If the question does not apply, write "N/A" in the space.

LEGAL NAME OF BUSINESS: Protopaco LLC

DBA OR TRADE NAME: Night Light Lounge PHONE: 360 317 6607 FAX: _____

BUSINESS ADDRESS (Including ZIP Code): 2100 SE Clinton St, 97202

WHAT TYPE OF LIQUOR ARE YOU APPLYING FOR? (Change of owner, new outlet, beer & wine, etc.): Change of owner

CONTACT PERSON: Paul Stevens PHONE: 360 317 6607 EMAIL: todos los temas pdx@gmail.com

DESCRIPTION OF OUTLET

TYPE OF OPERATION (CHECK ALL THAT APPLY)

<input type="checkbox"/> Food Cart	<input type="checkbox"/> Night Club	SIZE OF SERVICE AREA: <u>2000 sq ft</u>
<input checked="" type="checkbox"/> Restaurant	<input type="checkbox"/> Sports Bar	EXISTING BUILDING: <input checked="" type="checkbox"/> Yes <input type="checkbox"/> No
<input type="checkbox"/> Convenience Store	<input type="checkbox"/> Other: _____	ZONING: _____
		STRUCTURAL CHANGES (DESCRIBE): <u>N/A</u>

RESTAURANT SEATING CAPACITY: 55 LOUNGE SEATING CAPACITY: _____ OUTSIDE SEATING CAPACITY: 43

DESCRIBE SECURITY: Video Security System

HAS AN APPLICATION FOR A LIQUOR LICENSE AT THIS LOCATION BEEN RECEIVED BY THE CITY OF PORTLAND IN THE LAST TWO (2) YEARS?
 Yes No I Don't Know

HOURS OF OPERATION

SUNDAY - THURSDAY OPEN: 2:00 CLOSE: 2:30 FRIDAY & SATURDAY OPEN: 2:00 CLOSE: 2:30

HOW LATE WILL THERE BE OUTSIDE SEATING? 12:00 HOW LATE WILL THERE BE ENTERTAINMENT? _____

HISTORY OF LOCATION

PREVIOUS BUSINESS NAME OF THIS LOCATION: N/A

NAME & ADDRESS OF PROPERTY OWNER: N/A

ENTERTAINMENT

TYPE OF ENTERTAINMENT (CHECK ALL THAT APPLY)

<input type="checkbox"/> Dancing	<input type="checkbox"/> Video Poker	<input type="checkbox"/> Live Music	<input type="checkbox"/> Nude Dancers
<input type="checkbox"/> Karaoke	<input type="checkbox"/> Video Games/Pinball	<input type="checkbox"/> Recorded Music	<input type="checkbox"/> DJ Entertainment
<input type="checkbox"/> Pool Tables (How Many): _____	<input type="checkbox"/> Events (Describe): _____	<input type="checkbox"/> Other: _____	

The City requires an **Amusement Location Permit** for all locations with amusement devices or pool tables. **Contact the Revenue Bureau for rules and an Amusement Location Permit application form now.** Permits are non-transferable from one owner to another and must be paid before games are placed on the premises. Contact Anne Holm at 503-865-2488. The City of Portland will notify affected nearby neighbors and a copy of this form will be included in our mailing.

Use this area to provide any additional information that you wish to be considered on this liquor application

A false answer or omission of any requested information may result in an unfavorable City recommendation.

SIGNATURE: [Signature] DATE: 6/29/17

Retail Sales and Services uses are allowed in the CN1 zone, and are limited to 5,000 square feet per use. Laura Lehman, City Planner, 503-823-7391

City of Portland
 Bureau of Development Services
 Land Use Service Division
 1900 SW 4th Ave, Suite 5000
 Portland, OR 97201

L. Lehman 6.30.12

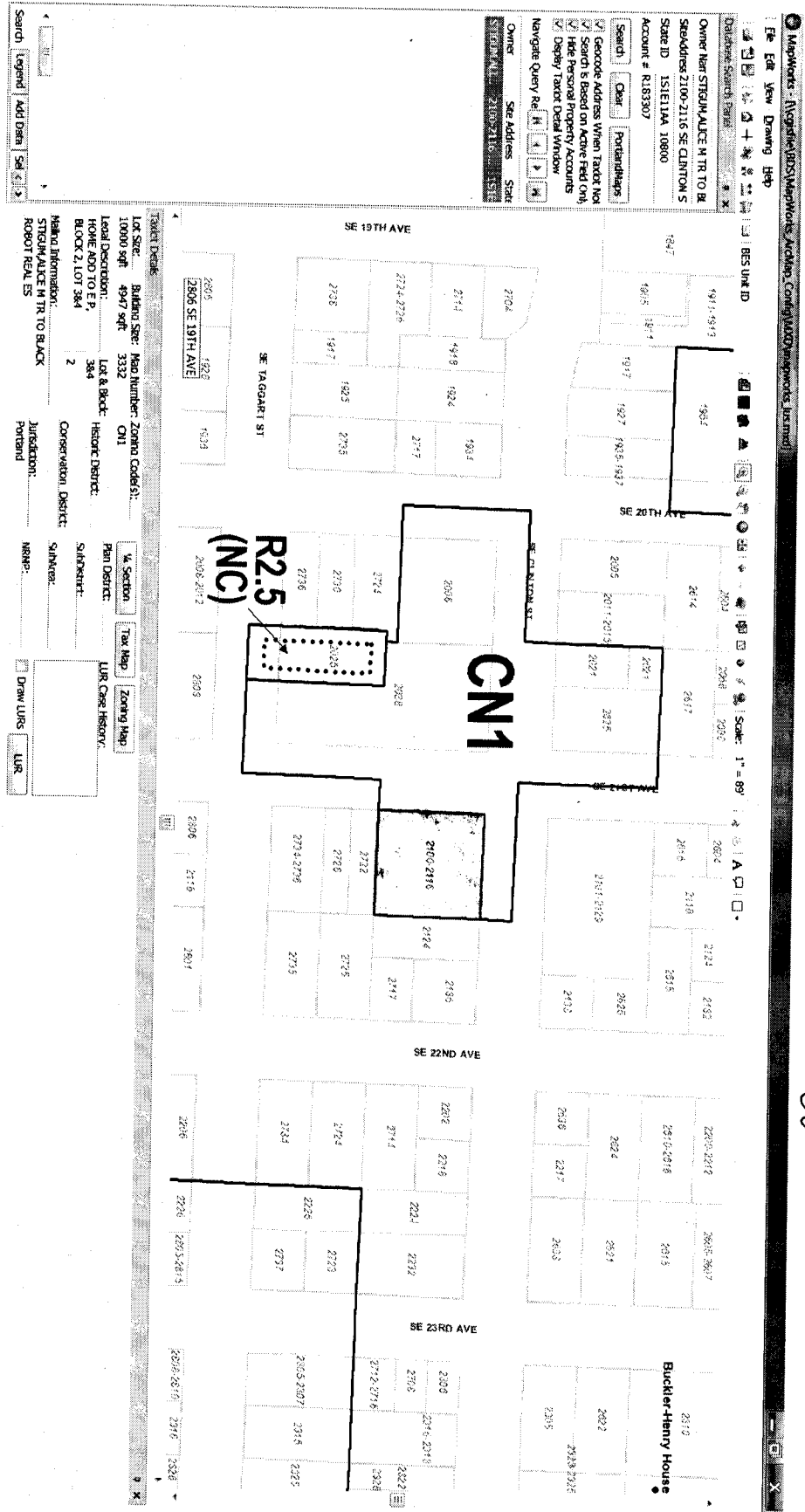

Parcel Details:
 Lot Size: 10000 sqft
 Building Spec: 4947 sqft
 Lot & Block: 384
 Legal Description: HOME ADD TO E P, BLOCK 2, LOT 384
 Main Information: SE 19TH AVE TR TO BLACK ROBOT RCL 55
 Zoning Code: CN1
 Historic District: 384
 Conservation District: 2
 Jurisdiction: Portland
 MRSP: Draw LURS LUR

Scale 1 inch = 89 feet