



# OREGON LIQUOR CONTROL COMMISSION LIQUOR LICENSE APPLICATION

PR

Application is being made for:

|  |  |
|--|--|
| <b>LICENSE TYPES</b><br><input type="checkbox"/> Full On-Premises Sales (\$402.60/yr)<br><input type="checkbox"/> Commercial Establishment<br><input type="checkbox"/> Caterer<br><input type="checkbox"/> Passenger Carrier<br><input type="checkbox"/> Other Public Location<br><input type="checkbox"/> Private Club<br><input checked="" type="checkbox"/> Limited On-Premises Sales (\$202.60/yr)<br><input checked="" type="checkbox"/> Off-Premises Sales (\$100/yr)<br><input type="checkbox"/> with Fuel Pumps<br><input type="checkbox"/> Brewery Public House (\$252.60)<br><input type="checkbox"/> Winery (\$250/yr)<br><input type="checkbox"/> Other: _____ | <b>ACTIONS</b><br><input type="checkbox"/> Change Ownership<br><input checked="" type="checkbox"/> New Outlet<br><input type="checkbox"/> Greater Privilege<br><input type="checkbox"/> Additional Privilege<br><input type="checkbox"/> Other _____ |
|--|--|

Rec'd by Portland Liquor Licenses  
JUL 14 2017  
PD CC \$100  
# 952764

**90-DAY AUTHORITY**  
 Check here if you are applying for a change of ownership at a business that has a current liquor license, or if you are applying for an Off-Premises Sales license and are requesting a 90-Day Temporary Authority

**APPLYING AS:**  
 Limited Partnership     Corporation     Limited Liability Company     Individuals

**CITY AND COUNTY USE ONLY**

Date application received: \_\_\_\_\_

The City Council or County Commission: \_\_\_\_\_  
(name of city or county)

recommends that this license be:  
 Granted     Denied

By: \_\_\_\_\_  
(signature) (date)

Name: \_\_\_\_\_

Title: \_\_\_\_\_

---

**OLCC USE ONLY**

Application Rec'd by: [Signature]

Date: 7-12-17

90-day authority:  Yes     No

1. Entity or Individuals applying for the license: [See SECTION 1 of the Guide]  
 ① POUR LLC ③ \_\_\_\_\_  
 ② \_\_\_\_\_ ④ \_\_\_\_\_

2. Trade Name (dba): POUR WINE BAR

3. Business Location: 2755 NE BROADWAY PORTLAND, OR 97232  
(number, street, rural route) (city) (county) (state) (ZIP code)

4. Business Mailing Address: 2755 NE BROADWAY PORTLAND, OR 97232  
(PO box, number, street, rural route) (city) (state) (ZIP code)

5. Business Numbers: 503.318.8216  
(phone)

6. Is the business at this location currently licensed by OLCC?  Yes  No

7. If yes to whom: \_\_\_\_\_ Type of License: \_\_\_\_\_

8. Former Business Name: \_\_\_\_\_

9. Will you have a manager?  Yes  No Name: \_\_\_\_\_  
(manager must fill out an Individual History form)

10. What is the local governing body where your business is located? PORTLAND  
(name of city or county)

11. Contact person for this application: NICOLE CARLSON 503.318.8216  
(name) (phone number(s))  
2755 NE BROADWAY CARLSON.NICOLE@yattco.com  
(address) (fax number) (e-mail address)

I understand that if my answers are not true and complete, the OLCC may deny my license application.

**Applicant(s) Signature(s) and Date:**

① Nicole Carlson Date 7/5/17 ③ \_\_\_\_\_ Date \_\_\_\_\_  
 ② \_\_\_\_\_ Date \_\_\_\_\_ ④ \_\_\_\_\_ Date \_\_\_\_\_

RECEIVED  
(rev. 08/2011)

JUL 06 2017



OREGON LIQUOR CONTROL COMMISSION  
BUSINESS INFORMATION

Please Print or Type

Applicant Name: POUR LLC Phone: 503.318.8266

Trade Name (dba): POUR WINE BAR

Business Location Address: 2755 NE BROADWAY

City: PORTLAND, OR ZIP Code: 97232

**DAYS AND HOURS OF OPERATION**

Business Hours:

|           |                       |
|-----------|-----------------------|
| Sunday    | <u>CLOSED</u>         |
| Monday    | <u>4</u> to <u>10</u> |
| Tuesday   | <u>4</u> to <u>10</u> |
| Wednesday | <u>4</u> to <u>10</u> |
| Thursday  | <u>4</u> to <u>11</u> |
| Friday    | <u>4</u> to <u>12</u> |
| Saturday  | <u>4</u> to <u>12</u> |

Outdoor Area Hours: SPRING/SUMMER

|           |                       |
|-----------|-----------------------|
| Sunday    | <u>CLOSED</u>         |
| Monday    | <u>4</u> to <u>10</u> |
| Tuesday   | <u>4</u> to <u>10</u> |
| Wednesday | <u>4</u> to <u>10</u> |
| Thursday  | <u>4</u> to <u>10</u> |
| Friday    | <u>4</u> to <u>10</u> |
| Saturday  | <u>4</u> to <u>10</u> |

The outdoor area is used for:

Food service Hours: 4 to 10  
 Alcohol service Hours: 4 to 10  
 Enclosed, how \_\_\_\_\_

The exterior area is adequately viewed and/or supervised by Service Permittees.

\_\_\_\_\_  
(Investigator's Initials)

Seasonal Variations:  Yes  No If yes, explain: THE OUTDOOR SPACE IS USED ONLY IN THE SPRING-SUMMER

**ENTERTAINMENT**

Check all that apply:

- Live Music
- Recorded Music
- DJ Music
- Dancing
- Nude Entertainers
- Karaoke
- Coin-operated Games
- Video Lottery Machines
- Social Gaming
- Pool Tables
- Other: \_\_\_\_\_

**DAYS & HOURS OF LIVE OR DJ MUSIC**

— NA —  
 Sunday \_\_\_\_\_ to \_\_\_\_\_  
 Monday \_\_\_\_\_ to \_\_\_\_\_  
 Tuesday \_\_\_\_\_ to \_\_\_\_\_  
 Wednesday \_\_\_\_\_ to \_\_\_\_\_  
 Thursday \_\_\_\_\_ to \_\_\_\_\_  
 Friday \_\_\_\_\_ to \_\_\_\_\_  
 Saturday \_\_\_\_\_ to \_\_\_\_\_

**SEATING COUNT**

Restaurant: 24 Outdoor: 8  
 Lounge: \_\_\_\_\_ Other (explain): \_\_\_\_\_  
 Banquet: \_\_\_\_\_ Total Seating: \_\_\_\_\_

**OLCC USE ONLY**  
 Investigator Verified Seating: \_\_\_\_ (Y) \_\_\_\_ (N)  
 Investigator Initials: \_\_\_\_\_  
 Date: \_\_\_\_\_

I understand if my answers are not true and complete, the OLCC may deny my license application.

Applicant Signature: Wade Carlson Date: 7/5/2017



OREGON LIQUOR CONTROL COMMISSION  
LIMITED LIABILITY COMPANY QUESTIONNAIRE

1233170-91

Please Print or Type

LLC Name: POUR LLC Year Filed: 2016 ✓

Trade Name (dba): POUR WINE BAR

Business Location Address: 2755 NE BROADWAY

City: PORTLAND ZIP Code: 97232

List Members of LLC:

Percentage of Membership Interest:

1. NICOLE CARLSON  
(managing member)

100%

2. \_\_\_\_\_  
(members)

\_\_\_\_\_

3. \_\_\_\_\_

\_\_\_\_\_

4. \_\_\_\_\_

\_\_\_\_\_

5. \_\_\_\_\_

\_\_\_\_\_

6. \_\_\_\_\_

\_\_\_\_\_

(Note: If any LLC member is another legal entity, that entity must also complete an LLC, Limited Partnership or Corporation Questionnaire. If the LLC has officers, please list them on a separate sheet of paper with their titles.)

Server Education Designee: NICOLE CARLSON DOB: 12/27/1982

I understand that if my answers are not true and complete, the OLCC may deny my license application.

Signature: Nicole Carlson Date: 7/5/2017  
(name) (title)

# CITY OF PORTLAND LIQUOR OUTLET INFORMATION FORM

PLEASE SUBMIT TO: Liquor Licensing Notification Program, 1221 SW 4<sup>th</sup> Avenue, Suite #110, Portland OR 97204

On New Outlet applications, property owners within 300 feet of the location, the Portland Police Bureau and all interested parties are notified by mail (with a copy of this form) and given an opportunity to comment on your application. The OLCC allows the City at least 45 days to complete the recommendation process. Submission of a complete operating plan can expedite the time required to process. A City liquor endorsement is not a confirmation that the property is properly zoned. Call (503) - 823-7526 to confirm that the property is properly zoned.

On submission of this form, you must also include the following:

- OLCC Liquor Application Form, initialed by your OLCC License Investigator
- OLCC Individual History Forms (all persons anticipated to have a financial interest, or key personnel are required)
- City Endorsement Fees

City Endorsement Fees are payable at the beginning of the application process (please make checks payable to City of Portland): New outlets are \$100.00, all others are \$75.00. All blank sections must be filled in. If the question does not apply, write "N/A" in the space.

LEGAL NAME OF BUSINESS: POUR LLC

DBA OR TRADE NAME: POUR PHONE: 503.318.8244 FAX: /

BUSINESS ADDRESS (Including ZIP Code): 2755 NE BROADWAY PORTLAND, OR 97232

WHAT TYPE OF LIQUOR ARE YOU APPLYING FOR? (Change of owner, new outlet, beer & wine, etc.): /

CONTACT PERSON: NICOLE CARLSON PHONE: 503.318.8244 EMAIL: CARLSON.NICOLE@YATTOO.COM

### DESCRIPTION OF OUTLET

TYPE OF OPERATION (CHECK ALL THAT APPLY)

- Food Cart  Night Club  
 Restaurant  Sports Bar  
 Convenience Store  Other: /

SIZE OF SERVICE AREA: 800

EXISTING BUILDING:  Yes  No

ZONING: Commercial

STRUCTURAL CHANGES (DESCRIBE): NONE

RESTAURANT SEATING CAPACITY: 25 LOUNGE SEATING CAPACITY: / OUTSIDE SEATING CAPACITY: 8

DESCRIBE SECURITY: SUMMER SPRING

HAS AN APPLICATION FOR A LIQUOR LICENSE AT THIS LOCATION BEEN RECEIVED BY THE CITY OF PORTLAND IN THE LAST TWO (2) YEARS?  
 Yes  No  I Don't Know

### HOURS OF OPERATION

SUNDAY - THURSDAY OPEN: 4pm CLOSE: 10pm FRIDAY & SATURDAY OPEN: 4pm CLOSE: 10pm

HOW LATE WILL THERE BE OUTSIDE SEATING? 10pm HOW LATE WILL THERE BE ENTERTAINMENT? NA

### HISTORY OF LOCATION

PREVIOUS BUSINESS NAME OF THIS LOCATION: POUR WINE BAR

NAME & ADDRESS OF PROPERTY OWNER: FALLGREN RENTALS PO. BOX 28221 PORTLAND, OR 97228

### ENTERTAINMENT

TYPE OF ENTERTAINMENT (CHECK ALL THAT APPLY)

- Dancing  Video Poker  Live Music  Nude Dancers  
 Karaoke  Video Games/Pinball  Recorded Music  DJ Entertainment  
 Pool Tables (How Many): /  Events (Describe): /  Other: /

The City requires an **Amusement Location Permit** for all locations with amusement devices or pool tables. **Contact the Revenue Bureau for rules and an Amusement Location Permit application form now.** Permits are non-transferable from one owner to another and must be paid before games are placed on the premises. Contact Anne Holm at 503-865-2488. The City of Portland will notify affected nearby neighbors and a copy of this form will be included in our mailing.

Use this area to provide any additional information that you wish to be considered on this liquor application

\_\_\_\_\_

A false answer or omission of any requested information may result in an unfavorable City recommendation.

SIGNATURE: Nicole Carlson DATE: 7/14/17

Property Search

Owner Name: ~~FAULGREEN RENTALS INC %PINGR~~

Site Address: 2755 NE BROADWAY

State ID: OR JNE25CG 9500

Account #: R170543

Search Clear Portland Maps

- Geocode Address When Taxlot Not Found
- Search is Based on Active Field Only
- Hide Personal Property Accounts
- Display Taxlot Detail Window

Navigate Query Results

Owner: FALLGREEN RENTALS INC %PINGR

Site Address: 2755 NE BROADWAY

State: OR

*CS Zone allows for Retail Sales & Service here.*

*J. Mala Susarawala, City Planner*

*J. Mala Susarawala*  
 City of Portland  
 Bureau of Development Services  
 Land Use Service Division  
 1900 SW 4th Ave, Suite 5000  
 Portland, OR 97201

(503) 823-7300

Search Legend Add Data Selection

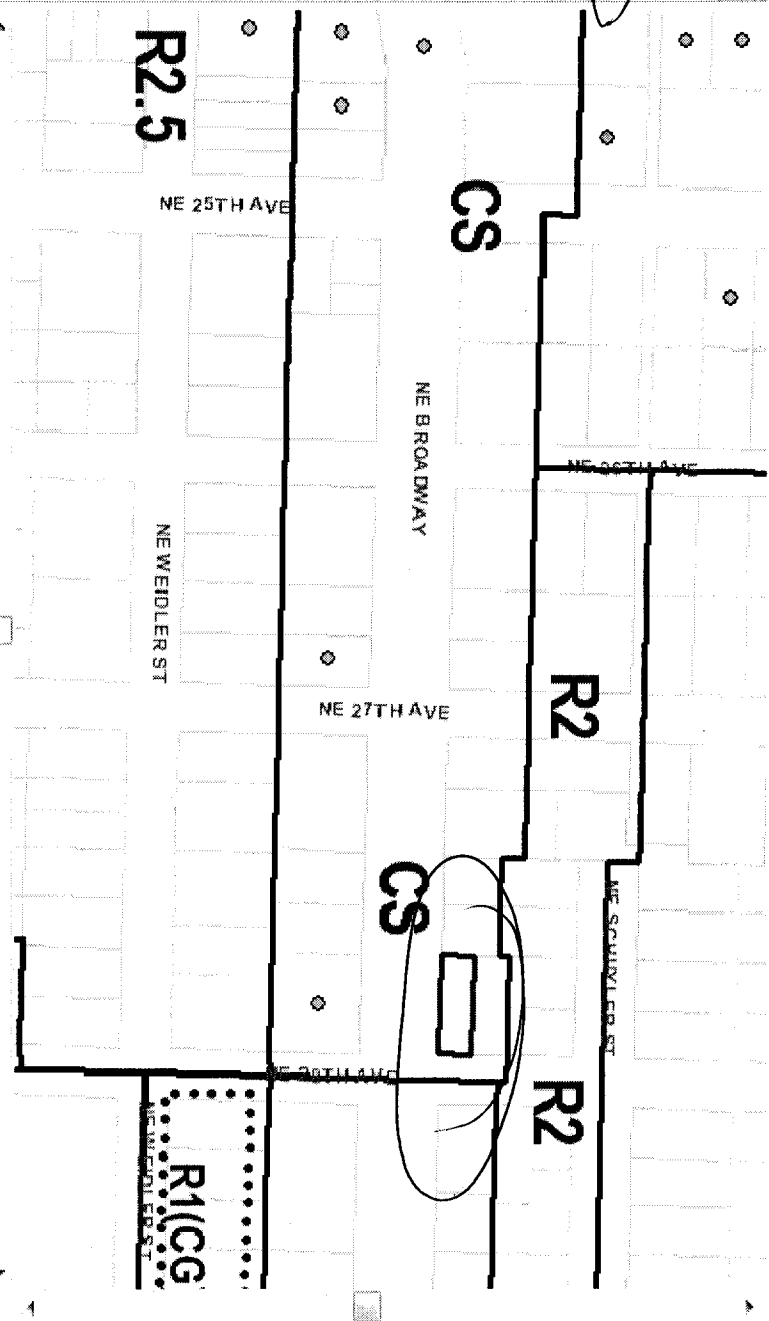

Taxlot Details

Lot Size: 3109 sqft  
 Building Size: 3468 sqft  
 Map Number: 2833  
 Legal Description: GLENSIDE, BLOCK 2, LOT 3 EXC PT IN ST  
 Lot & Block: 2 3

Mailing Information:  
 FAULGREEN RENTALS INC %PINGREE  
 NORTHWEST  
 1927 NW 18TH AVE #7

Conservation District:  
 Jurisdiction: Portland

1/4 Section Map Tax Map Zoning

Plan District: LUR Case Histo

Subdistrict: VZ 283-66

Subarea: NRMP: Draw LURS

Scale 1 inch = 189 feet