



**OREGON LIQUOR CONTROL COMMISSION
LIQUOR LICENSE APPLICATION**

DM

Application is being made for:

LICENSE TYPES

Full On-Premises Sales (\$402.60/yr)

Commercial Establishment

Caterer

Passenger Carrier

Other Public Location

Private Club

Limited On-Premises Sales (\$202.60/yr)

Off-Premises Sales (\$100/yr)

with Fuel Pumps

Brewery Public House (\$252.60)

Winery (\$250/yr)

Other: _____

ACTIONS

Change Ownership

New Outlet

Greater Privilege

Additional Privilege

Other

Rec'd by Portland
Liquor Licenses

JUL 19 2017

PD \$100 ce
083740

90-DAY AUTHORITY

Check here if you are applying for a change of ownership at a business that has a current liquor license, or if you are applying for an Off-Premises Sales license and are requesting a 90-Day Temporary Authority

APPLYING AS:

Limited Partnership Corporation Limited Liability Company Individuals

CITY AND COUNTY USE ONLY

Date application received: _____

The City Council or County Commission: _____

(name of city or county)

recommends that this license be:

Granted Denied

By: _____ (signature) _____ (date)

Name: _____

Title: _____

OLCC USE ONLY

Application Rec'd by: *[Signature]*

Date: 7-16-17

90-day authority: Yes No

1. Entity or Individuals applying for the license: [See SECTION 1 of the Guide]

① Rod Rumford _____ ③ _____

② _____ ④ _____

2. Trade Name (dba): Portlandia Wine Club

3. Business Location: 2738 SE 15th Ave, Portland, Multnomah County, OR 97202

(number, street, rural route) (city) (county) (state) (ZIP code)

4. Business Mailing Address: 2738 SE 15th Ave, Portland, OR 97202

(PO box, number, street, rural route) (city) (state) (ZIP code)

5. Business Numbers: 503 803 0990

(phone) (fax)

6. Is the business at this location currently licensed by OLCC? Yes No

7. If yes to whom: _____ Type of License: _____

8. Former Business Name: _____

9. Will you have a manager? Yes No Name: _____

(manager must fill out an Individual History form)

10. What is the local governing body where your business is located? Portland, Oregon *(MULTNOMAH)*

(name of city or county)

11. Contact person for this application: Rod Rumford 503 803 0990

(name) (phone number(s))

2738 SE 15th Ave, Portland, OR 97202 htrod97213@gmail.com

(address) (fax number) (e-mail address)

I understand that if my answers are not true and complete, the OLCC may deny my license application.

Applicant(s) Signature(s) and Date:

① *[Signature]* Date 6/26/2017 ③

② _____ Date _____ ④

RECEIVED

JUL 26 2017



OREGON LIQUOR CONTROL COMMISSION BUSINESS INFORMATION

Please Print or Type

Applicant Name: ROD RUMFORD Phone: 503 803-0990

Trade Name (dba): PORTLANDIA WINE CLUB

Business Location Address: 2738 SE 15th AVE.

City: PORTLAND ZIP Code: 97202

DAYS AND HOURS OF OPERATION

Business Hours:

Sunday	_____	to	_____
Monday	<u>9</u>	to	<u>5:00</u>
Tuesday	<u>9</u>	to	<u>5:00</u>
Wednesday	<u>9</u>	to	<u>5:00</u>
Thursday	<u>9</u>	to	<u>5:00</u>
Friday	<u>5</u>	to	<u>5:00</u>
Saturday	_____	to	_____

Outdoor Area Hours:

Sunday	_____	to	_____
Monday	_____	to	_____
Tuesday	_____	to	_____
Wednesday	_____	to	_____
Thursday	_____	to	_____
Friday	_____	to	_____
Saturday	_____	to	_____

The outdoor area is used for:

- Food service Hours: _____ to _____
- Alcohol service Hours: _____ to _____
- Enclosed, how _____

The exterior area is adequately viewed and/or supervised by Service Permittees.

(Investigator's Initials)

Seasonal Variations: Yes No If yes, explain: _____

ENTERTAINMENT

Check all that apply: N/A

- | | |
|--|---|
| <input type="checkbox"/> Live Music | <input type="checkbox"/> Karaoke |
| <input type="checkbox"/> Recorded Music | <input type="checkbox"/> Coin-operated Games |
| <input type="checkbox"/> DJ Music | <input type="checkbox"/> Video Lottery Machines |
| <input type="checkbox"/> Dancing | <input type="checkbox"/> Social Gaming |
| <input type="checkbox"/> Nude Entertainers | <input type="checkbox"/> Pool Tables |
| | <input type="checkbox"/> Other: _____ |

DAYS & HOURS OF LIVE OR DJ MUSIC

Sunday	_____	to	_____
Monday	_____	to	_____
Tuesday	_____	to	_____
Wednesday	_____	to	_____
Thursday	_____	to	_____
Friday	_____	to	_____
Saturday	_____	to	_____

SEATING COUNT

Restaurant: _____ Outdoor: _____

Lounge: _____ Other (explain): _____

Banquet: _____ Total Seating: _____

OLCC USE ONLY	
Investigator Verified Seating: _____ (Y) _____ (N)	
Investigator Initials: _____	
Date: _____	

I understand if my answers are not true and complete, the OLCC may deny my license application.

Applicant Signature: Rod Rumford Date: 6/26/2017

1-800-452-OLCC (6522)

www.oregon.gov/olcc

(rev. 12/07)

CITY OF PORTLAND LIQUOR OUTLET INFORMATION FORM

PLEASE SUBMIT TO: Liquor Licensing Notification Program, 1221 SW 4th Avenue, Suite #110, Portland OR 97204

On New Outlet applications, property owners within 300 feet of the location, the Portland Police Bureau and all interested parties are notified by mail (with a copy of this form) and given an opportunity to comment on your application. The OLCC allows the City at least 45 days to complete the recommendation process. Submission of a complete operating plan can expedite the time required to process. A City liquor endorsement is not a confirmation that the property is properly zoned. Call (503) - 823-7526 to confirm that the property is properly zoned.

On submission of this form, you must also include the following:

- OLCC Liquor Application Form, initialed by your OLCC License Investigator
- OLCC Individual History Forms (all persons anticipated to have a financial interest, or key personnel are required)
- City Endorsement Fees

City Endorsement Fees are payable at the beginning of the application process (please make checks payable to City of Portland): New outlets are \$100.00, all others are \$75.00. All blank sections must be filled in. If the question does not apply, write "N/A" in the space.

Portlandia Wine Club

LEGAL NAME OF BUSINESS: _____

DBA OR TRADE NAME: Portlandia Wine Club PHONE: 503 803 0990 FAX: _____

BUSINESS ADDRESS (Including ZIP Code): 2738 SE 15th Ave., Portland, Or 97202

WHAT TYPE OF LIQUOR ARE YOU APPLYING FOR? (Change of owner, new outlet, beer & wine, etc.): Wine retail/off premise

CONTACT PERSON: Rod Rumford PHONE: 503 803 0990 EMAIL: Htrod97213@gmail.com

DESCRIPTION OF OUTLET

TYPE OF OPERATION (CHECK ALL THAT APPLY)

<input type="checkbox"/> Food Cart	<input type="checkbox"/> Night Club	SIZE OF SERVICE AREA: <u>23'X23'</u>
<input type="checkbox"/> Restaurant	<input type="checkbox"/> Sports Bar	EXISTING BUILDING: <input checked="" type="checkbox"/> Yes <input type="checkbox"/> No
<input type="checkbox"/> Convenience Store	<input type="checkbox"/> Other: <u>retail wine</u>	ZONING: <u>Commercial</u>

STRUCTURAL CHANGES (DESCRIBE): _____

RESTAURANT SEATING CAPACITY: _____ LOUNGE SEATING CAPACITY: _____ OUTSIDE SEATING CAPACITY: _____

DESCRIBE SECURITY: ADP Security

HAS AN APPLICATION FOR A LIQUOR LICENSE AT THIS LOCATION BEEN RECEIVED BY THE CITY OF PORTLAND IN THE LAST TWO (2) YEARS?
 Yes No I Don't Know

HOURS OF OPERATION
SUNDAY - THURSDAY OPEN: 8:00 CLOSE: 5:00 FRIDAY & SATURDAY OPEN: 8:00 CLOSE: 5:00

HOW LATE WILL THERE BE OUTSIDE SEATING? _____ HOW LATE WILL THERE BE ENTERTAINMENT? _____

HISTORY OF LOCATION

PREVIOUS BUSINESS NAME OF THIS LOCATION: _____

NAME & ADDRESS OF PROPERTY OWNER: LLC 2738 SE 15, Portland, Or 97202 (Rod Rumford and partners on deed)

ENTERTAINMENT

TYPE OF ENTERTAINMENT (CHECK ALL THAT APPLY)

<input type="checkbox"/> Dancing	<input type="checkbox"/> Video Poker	<input type="checkbox"/> Live Music	<input type="checkbox"/> Nude Dancers
<input type="checkbox"/> Karaoke	<input type="checkbox"/> Video Games/Pinball	<input type="checkbox"/> Recorded Music	<input type="checkbox"/> DJ Entertainment
<input type="checkbox"/> Pool Tables (How Many): _____	<input type="checkbox"/> Events (Describe): _____	<input type="checkbox"/> Other: _____	

The City requires an **Amusement Location Permit** for all locations with amusement devices or pool tables. Contact the Revenue Bureau for rules and an Amusement Location Permit application form now. Permits are non-transferable from one owner to another and must be paid before games are placed on the premises. Contact Anne Holm at 503-865-2488. The City of Portland will notify affected nearby neighbors and a copy of this form will be included in our mailing.

Use this area to provide any additional information that you wish to be considered on this liquor application

A false answer or omission of any requested information may result in an unfavorable City recommendation.

SIGNATURE: Rod Rumford DATE: 7/18/2017

Property Search

Owner: Nan 2738 SE 15TH LLC

Site Address: 2738 SE 15TH AVE

State ID: TSTTL18B 8100

Account #: R287488

Search Clear PortlandMaps

Geocode Address When Taxlot Not

Search is Based on Active Field Only

Hide Personal Property Accounts

Display Taxlot Detail Window

Navigate Query Rel. [Home] [Back] [Forward] [Refresh]

Owner: Site Address: State: 2738 SE 15... 2738 SE 15... 15TH

*EG1 zone always for retail uses up to 60,000 sq ft bldg area (includes exterior storage & display areas).
 @ Proser Saha
 J Malia Susaranta
 City Planner
 City of Portland*

Bureau of Development Services
 Land Use Service Division
 1900 SW 4th Ave. Suite 5000
 Portland, OR 97201
 503-823-7333

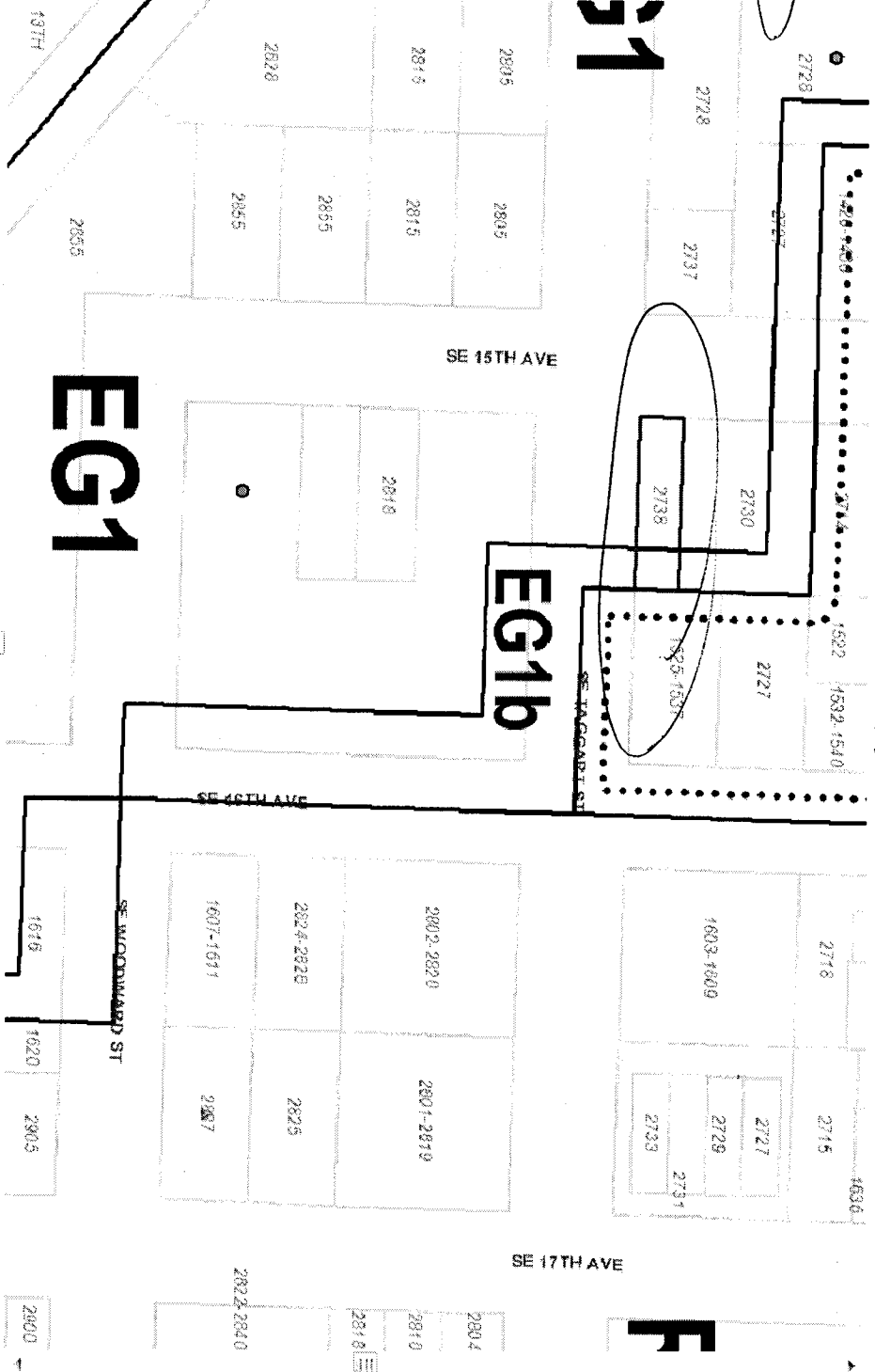

Taxlot Details

Lot Sre: 2500 sqft Building Sre: 1850 sqft Map Number: 3332 Zoning Code(s): EGI
 Legal Description: TIBBETTS ADD, BLOCK 18, S 1/2 OF LOT 1
 Lot & Block: 1
 Historic District:
 Conservation District:
 Subarea:
 NRMP:
 Jurisdiction: Portland

1/4 Section Tax Map Zoning Map
 Plan District: LUR Case Histo (1 Case) VZ 108-78
 SubDistrict:
 Draw LURS LUR