



# OREGON LIQUOR CONTROL COMMISSION LIQUOR LICENSE APPLICATION

PR

Application is being made for:

- LICENSE TYPES**
- Full On-Premises Sales (\$402.60/yr)
  - Commercial Establishment
  - Caterer
  - Passenger Carrier
  - Other Public Location
  - Private Club
  - Limited On-Premises Sales (\$202.60/yr)
  - Off-Premises Sales (\$100/yr)
    - with Fuel Pumps
  - Brewery Public House (\$252.60)
  - Winery (\$250/yr)
  - Other: BRW & BRWNC

- ACTIONS**
- Change Ownership
  - New Outlet
  - Greater Privilege
  - Additional Privilege
  - Other \_\_\_\_\_

Rec'd by Portland  
Liquor Licenses

JUL 26 2017  
PD 100<sup>00</sup> TBS  
# 1021

**90-DAY AUTHORITY**

Check here if you are applying for a change of ownership at a business that has a current liquor license, or if you are applying for an Off-Premises Sales license and are requesting a 90-Day Temporary Authority

**APPLYING AS:**

Limited Partnership     Corporation     Limited Liability Company     Individuals

**CITY AND COUNTY USE ONLY**

Date application received: \_\_\_\_\_

The City Council or County Commission: \_\_\_\_\_

(name of city or county)

recommends that this license be:

Granted     Denied

By: \_\_\_\_\_

(signature) (date)

Name: \_\_\_\_\_

Title: \_\_\_\_\_

**OLCC USE ONLY**

Application Rec'd by: W

Date: 6-26-17

90-day authority:  Yes     No

1. Entity or Individuals applying for the license: [See SECTION 1 of the Guide]
  - ① VanPort Brewing Company, LLC ③ \_\_\_\_\_
  - ② \_\_\_\_\_ ④ \_\_\_\_\_
2. Trade Name (dba): VanPort Brewing
3. Business Location: 215 NE Dekum St. Portland, Multnomah, OR, 97211

(number, street, rural route) (city) (county) (state) (ZIP code)
4. Business Mailing Address: 215 NE Dekum St. Portland, OR 97211

(PO box, number, street, rural route) (city) (state) (ZIP code)
5. Business Numbers: 503-975-6583, fax NA

(phone) (fax)
6. Is the business at this location currently licensed by OLCC?  Yes     No
7. If yes to whom: \_\_\_\_\_ Type of License: \_\_\_\_\_
8. Former Business Name: \_\_\_\_\_
9. Will you have a manager?  Yes     No    Name: \_\_\_\_\_
 

(manager must fill out an Individual History form)
10. What is the local governing body where your business is located? Portland, OR, Multnomah County

(name of city or county)
11. Contact person for this application: Robert Shunk 503-975-6583

(name) (phone number(s))

215 NE Dekum St. Portland, OR 97211    NA    vanportbrewing@gmail.com

(address) (fax number) (e-mail address)

I understand that if my answers are not true and complete, the OLCC may deny my license application.

**Applicant(s) Signature(s) and Date:**

① [Signature] Date 6/27/17 ③ \_\_\_\_\_

② \_\_\_\_\_ Date \_\_\_\_\_ ④ \_\_\_\_\_

RECEIVED  
Date  
JUN 19 2017



# OREGON LIQUOR CONTROL COMMISSION BUSINESS INFORMATION

Please Print or Type VanPort Brewing Company, LLC  
 Applicant Name: Robert Shunk Phone: 503-975-6284  
 Trade Name (dba): VanPort Brewing  
 Business Location Address: 215 NE Dekum St.  
 City: Portland ZIP Code: 97211

### DAYS AND HOURS OF OPERATION

<b>Business Hours:</b>	<b>Outdoor Area Hours:</b> <u>NA</u>	<b>The outdoor area is used for:</b> <u>NA</u>
Sunday <u>9</u> to <u>5</u>	Sunday _____ to _____	<input type="checkbox"/> Food service Hours: _____ to _____
Monday <u>9</u> to <u>5</u>	Monday _____ to _____	<input type="checkbox"/> Alcohol service Hours: _____ to _____
Tuesday <u>9</u> to <u>5</u>	Tuesday _____ to _____	<input type="checkbox"/> Enclosed, how _____
Wednesday <u>9</u> to <u>5</u>	Wednesday _____ to _____	The exterior area is adequately viewed and/or supervised by Service Permittees.
Thursday <u>9</u> to <u>5</u>	Thursday _____ to _____	_____ (Investigator's Initials)
Friday <u>9</u> to <u>5</u>	Friday _____ to _____	
Saturday <u>9</u> to <u>5</u>	Saturday _____ to _____	

Seasonal Variations:  Yes  No If yes, explain: \_\_\_\_\_

### ENTERTAINMENT

Check all that apply:

<input type="checkbox"/> Live Music	<input type="checkbox"/> Karaoke
<input type="checkbox"/> Recorded Music	<input type="checkbox"/> Coin-operated Games
<input type="checkbox"/> DJ Music	<input type="checkbox"/> Video Lottery Machines
<input type="checkbox"/> Dancing	<input type="checkbox"/> Social Gaming
<input type="checkbox"/> Nude Entertainers	<input type="checkbox"/> Pool Tables
	<input type="checkbox"/> Other: _____

### DAYS & HOURS OF LIVE OR DJ MUSIC

Sunday	_____ to _____
Monday	_____ to _____
Tuesday	_____ to _____
Wednesday	_____ to _____
Thursday	_____ to _____
Friday	_____ to _____
Saturday	_____ to _____

### SEATING COUNT

Restaurant: \_\_\_\_\_ Outdoor: \_\_\_\_\_  
 Lounge: \_\_\_\_\_ Other (explain): \_\_\_\_\_  
 Banquet: \_\_\_\_\_ Total Seating: \_\_\_\_\_

**OLCC USE ONLY**  
 Investigator Verified Seating: \_\_\_\_ (Y) \_\_\_\_ (N)  
 Investigator Initials: \_\_\_\_\_  
 Date: \_\_\_\_\_

I understand if my answers are not true and complete, the OLCC may deny my license application.  
 Applicant Signature: [Signature] Date: 6/12/17

OREGON LIQUOR CONTROL COMMISSION  
LIMITED LIABILITY COMPANY QUESTIONNAIRE



1069307-95

Please Print or Type

LLC Name: VanPort Brewing Company, LLC Year Filed: 2014 ✓

Trade Name (dba): VanPort Brewing

Business Location Address: 215 NE Dekum St.

City: Portland ZIP Code: 97211

List Members of LLC:

Percentage of Membership Interest:

1. <u>Robert Shunk, Founder and Principle</u> <u>(managing member)</u>	<u>25.5%</u>
2. <u>Dan OverBay, Founder and Principle</u> <u>(members)</u>	<u>25.5%</u>
3. <u>Paul &amp; Sibyl Barnum</u>	<u>1.9%</u>
4. _____	_____
5. _____	_____
6. _____	_____

(Note: If any LLC member is another legal entity, that entity must also complete an LLC, Limited Partnership or Corporation Questionnaire. If the LLC has officers, please list them on a separate sheet of paper with their titles.)

Server Education Designee: Robert Shunk DOB: 08/14/1966

I understand that if my answers are not true and complete, the OLCC may deny my license application.

Signature: [Signature] (name) Founder & Principle (title) Date: 4/13/17

# CITY OF PORTLAND LIQUOR OUTLET INFORMATION FORM

PLEASE SUBMIT TO: Liquor Licensing Notification Program, 1221 SW 4<sup>th</sup> Avenue, Suite #110, Portland OR 97204

On New Outlet applications, property owners within 300 feet of the location, the Portland Police Bureau and all interested parties are notified by mail (with a copy of this form) and given an opportunity to comment on your application. The OLCC allows the City at least 45 days to complete the recommendation process. Submission of a complete operating plan can expedite the time required to process. A City liquor endorsement is not a confirmation that the property is properly zoned. Call (503) - 823-7526 to confirm that the property is properly zoned.

On submission of this form, you must also include the following:

- OLCC Liquor Application Form, initialed by your OLCC License Investigator
- OLCC Individual History Forms (all persons anticipated to have a financial interest, or key personnel are required)
- City Endorsement Fees

City Endorsement Fees are payable at the beginning of the application process (please make checks payable to City of Portland): New outlets are \$100.00, all others are \$75.00. All blank sections must be filled in. If the question does not apply, write "N/A" in the space.

LEGAL NAME OF BUSINESS: Van Port Brewing LLC

DBA OR TRADE NAME: Van Port Brewing PHONE: 503-975-6294 FAX: \_\_\_\_\_

BUSINESS ADDRESS (Including ZIP Code): 215 NE Dekum St.

WHAT TYPE OF LIQUOR ARE YOU APPLYING FOR? (Change of owner, new outlet, beer & wine, etc.): new beer brewery

CONTACT PERSON: Robert Shunk PHONE: 503-975-6294 EMAIL: vanportbrewing@gmail.com

## DESCRIPTION OF OUTLET

TYPE OF OPERATION (CHECK ALL THAT APPLY)

- Food Cart  Night Club  
 Restaurant  Sports Bar  
 Convenience Store  Other: Brewery

SIZE OF SERVICE AREA: \_\_\_\_\_

EXISTING BUILDING:  Yes  No

ZONING: R5h

STRUCTURAL CHANGES (DESCRIBE): n/a

RESTAURANT SEATING CAPACITY: n/a LOUNGE SEATING CAPACITY: n/a OUTSIDE SEATING CAPACITY: n/a

DESCRIBE SECURITY: production brewery only

HAS AN APPLICATION FOR A LIQUOR LICENSE AT THIS LOCATION BEEN RECEIVED BY THE CITY OF PORTLAND IN THE LAST TWO (2) YEARS?  
 Yes  No  I Don't Know

## HOURS OF OPERATION

SUNDAY - THURSDAY OPEN: n/a CLOSE: \_\_\_\_\_ FRIDAY & SATURDAY OPEN: \_\_\_\_\_ CLOSE: \_\_\_\_\_

HOW LATE WILL THERE BE OUTSIDE SEATING? \_\_\_\_\_ HOW LATE WILL THERE BE ENTERTAINMENT? \_\_\_\_\_

## HISTORY OF LOCATION

PREVIOUS BUSINESS NAME OF THIS LOCATION: n/a

NAME & ADDRESS OF PROPERTY OWNER: Robert Shunk 215 NE Dekum St. 97211

## ENTERTAINMENT

TYPE OF ENTERTAINMENT (CHECK ALL THAT APPLY)

- Dancing  Video Poker  Live Music  Nude Dancers  
 Karaoke  Video Games/Pinball  Recorded Music  DJ Entertainment  
 Pool Tables (How Many): \_\_\_\_\_  Events (Describe): \_\_\_\_\_  Other: \_\_\_\_\_

The City requires an Amusement Location Permit for all locations with amusement devices or pool tables. Contact the Revenue Bureau for rules and an Amusement Location Permit application form now. Permits are non-transferable from one owner to another and must be paid before games are placed on the premises. Contact Anne Holm at 503-865-2488. The City of Portland will notify affected nearby neighbors and a copy of this form will be included in our mailing.

Use this area to provide any additional information that you wish to be considered on this liquor application

A false answer or omission of any requested information may result in an unfavorable City recommendation.

SIGNATURE: \_\_\_\_\_ DATE: 7/26/17

Property Search #

Owner: Marr SHUNK, ROBERT D & SHUN  
 Site Address: 215 NE DEKUM ST  
 State ID: IN1E1SAD 7900  
 Account #: R243898

- Geocode Address When Taxlot Not
- Search is Based on Active Field Only
- Hide Personal Property Accounts
- Display Taxlot Detail Window

Owner: SHUNK, ROBERT ZENDEK, IN1E  
 Site Address: NE DEKUM ST  
 State: IN

City of Portland  
 Bureau of Development Services  
 Land Use Service Division  
 1900 SW 4th Ave, Suite 5000  
 Portland, OR 97201

Search Legend Add Data Sel

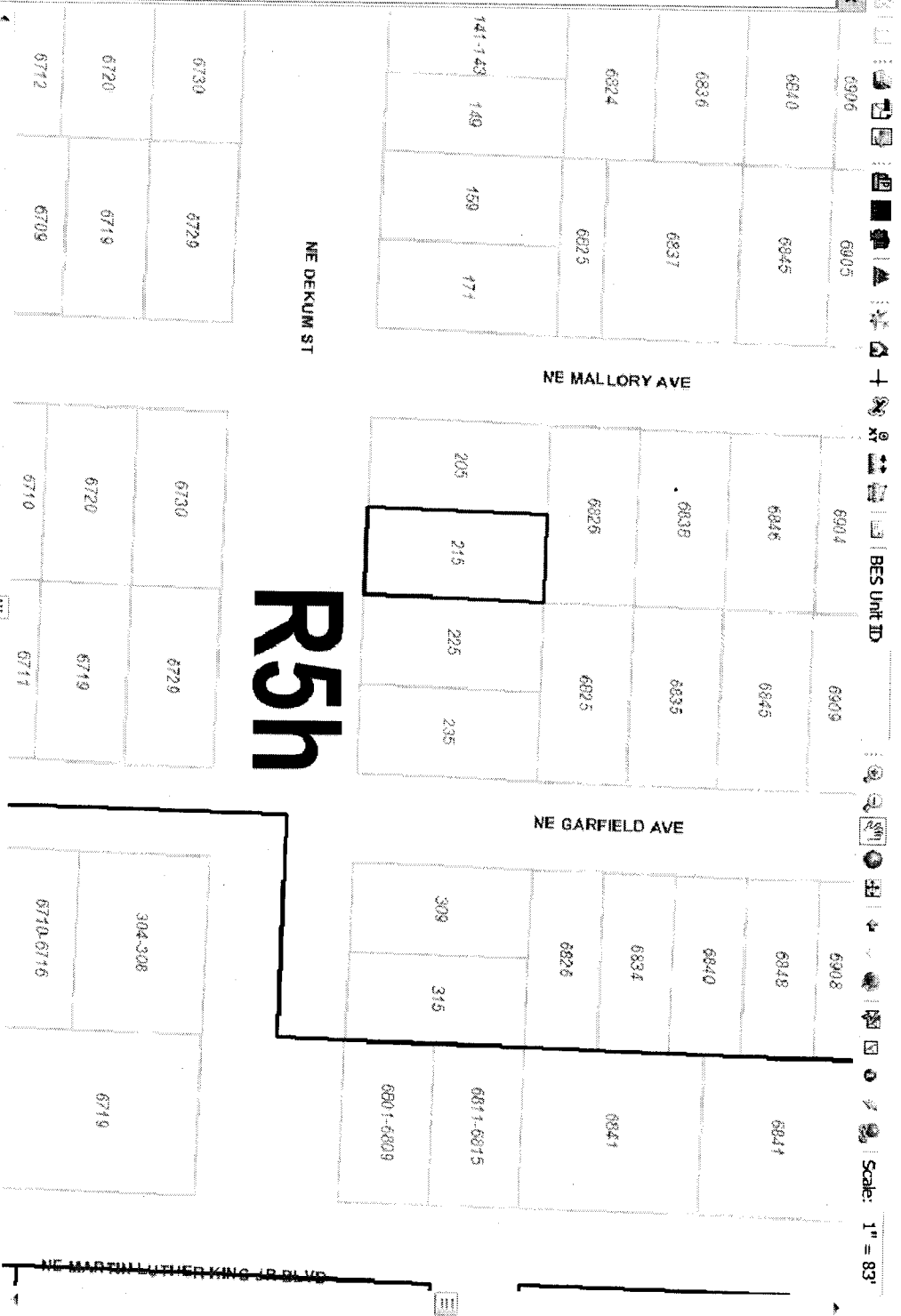

Taxlot Details

Lot Size: 5000 sqft Building Size: 2444 sqft Map Number: 2330 Zoning Code(s): R5h  
 Legal Description: PIEDMONT PK, BLOCK 2, E 1/2 OF LOT 11&12 Lot & Block: 11&12  
 Mailing Information: SHUNK, ROBERT D & SHUNK, ANDREA  
 Jurisdiction: Portland  
 Conservation District: Subarea: NLRWP: Draw LURS: LUR