



# OREGON LIQUOR CONTROL COMMISSION LIQUOR LICENSE APPLICATION

Application is being made for:

### LICENSE TYPES

- Full On-Premises Sales (\$402.60/yr)
  - Commercial Establishment
  - Caterer
  - Passenger Carrier
  - Other Public Location
  - Private Club
- Limited On-Premises Sales (\$202.60/yr)
- Off-Premises Sales (\$100/yr)
  - with Fuel Pumps
- Brewery Public House (\$252.60)
- Winery (\$250/yr)
- Other: \_\_\_\_\_

### ACTIONS

- Change Ownership
- New Outlet
- Greater Privilege
- Additional Privilege
- Other \_\_\_\_\_

### 90-DAY AUTHORITY

Check here if you are applying for a change of ownership at a business that has a current liquor license, or if you are applying for an Off-Premises Sales license and are requesting a 90-Day Temporary Authority

### APPLYING AS:

- Limited Partnership
- Corporation
- Limited Liability Company
- Individuals

### CITY AND COUNTY USE ONLY

Date application received: \_\_\_\_\_

The City Council or County Commission:

(name of city or county)

recommends that this license be:

- Granted
- Denied

By: \_\_\_\_\_  
(signature) (date)

Name: \_\_\_\_\_

Title: \_\_\_\_\_

### OLCC USE ONLY

Application Rec'd by: \_\_\_\_\_

Date: \_\_\_\_\_

90-day authority:  Yes  No

1. Entity or Individuals applying for the license: [See SECTION 1 of the Guide]

① 26 Rue des Arts LLC ③ \_\_\_\_\_  
② \_\_\_\_\_ ④ \_\_\_\_\_

Rec'd by Portland  
Liquor Licenses

2. Trade Name (dba): Le Tap

3. Business Location: 2314 NE Alberta St, Portland, OR 97211  
(number, street, rural route) (city) (county) (state) # Emp 56265

AUG 02 2017  
PD 100-36 JW  
# Emp 56265

4. Business Mailing Address: 503 NE Webster St, Portland, OR 97211  
(PO box, number, street, rural route) (city) (state) (ZIP code)

5. Business Numbers: 310-567-7019  
(phone) (fax)

6. Is the business at this location currently licensed by OLCC?  Yes  No

7. If yes to whom: \_\_\_\_\_ Type of License: \_\_\_\_\_

8. Former Business Name: \_\_\_\_\_

9. Will you have a manager?  Yes  No Name: Self  
(manager must fill out an Individual History form)

10. What is the local governing body where your business is located? Portland, OR  
(name of city or county)

11. Contact person for this application: Laurent Fabrice Albouze 310-567-7019  
(name) (phone number(s))  
503 NE Webster St, Portland, OR 97211 letappdx@gmail.com  
(address) (fax number) (e-mail address)

I understand that if my answers are not true and complete, the OLCC may deny my license application.

Applicant(s) Signature(s) and Date:

① \_\_\_\_\_ Date \_\_\_\_\_ ③ \_\_\_\_\_ Date \_\_\_\_\_

② \_\_\_\_\_ Date \_\_\_\_\_ ④ \_\_\_\_\_ Date \_\_\_\_\_



# OREGON LIQUOR CONTROL COMMISSION BUSINESS INFORMATION

Please Print or Type

Applicant Name: 26 Rue des Arts LLC Phone: 310-567-7019

Trade Name (dba): Le Tap

Business Location Address: 2314 NE Alberta Street

City: Portland, OR ZIP Code: 97211

### DAYS AND HOURS OF OPERATION

#### Business Hours:

|           |           |    |             |
|-----------|-----------|----|-------------|
| Sunday    | <u>12</u> | to | <u>10pm</u> |
| Monday    | <u>12</u> | to | <u>10pm</u> |
| Tuesday   | <u>12</u> | to | <u>10pm</u> |
| Wednesday | <u>12</u> | to | <u>10pm</u> |
| Thursday  | <u>12</u> | to | <u>10pm</u> |
| Friday    | <u>12</u> | to | <u>10pm</u> |
| Saturday  | <u>12</u> | to | <u>10pm</u> |

#### Outdoor Area Hours: same as business hours

|           |       |    |       |
|-----------|-------|----|-------|
| Sunday    | _____ | to | _____ |
| Monday    | _____ | to | _____ |
| Tuesday   | _____ | to | _____ |
| Wednesday | _____ | to | _____ |
| Thursday  | _____ | to | _____ |
| Friday    | _____ | to | _____ |
| Saturday  | _____ | to | _____ |

The outdoor area is used for:

Food service Hours: \_\_\_\_\_ to \_\_\_\_\_

Alcohol service Hours: 12 to 10pm

Enclosed, how \_\_\_\_\_

The exterior area is adequately viewed and/or supervised by Service Permittees.

\_\_\_\_\_  
(Investigator's Initials)

Seasonal Variations:  Yes  No If yes, explain: During winter hours, the cart will open later in the day.

### ENTERTAINMENT

Check all that apply: N/A

- |  |   |
|--|---|
| <input type="checkbox"/> Live Music        | <input type="checkbox"/> Karaoke                |
| <input type="checkbox"/> Recorded Music    | <input type="checkbox"/> Coin-operated Games    |
| <input type="checkbox"/> DJ Music          | <input type="checkbox"/> Video Lottery Machines |
| <input type="checkbox"/> Dancing           | <input type="checkbox"/> Social Gaming          |
| <input type="checkbox"/> Nude Entertainers | <input type="checkbox"/> Pool Tables            |
|  | <input type="checkbox"/> Other: _____           |

### DAYS & HOURS OF LIVE OR DJ MUSIC

N/A

|           |       |    |       |
|-----------|-------|----|-------|
| Sunday    | _____ | to | _____ |
| Monday    | _____ | to | _____ |
| Tuesday   | _____ | to | _____ |
| Wednesday | _____ | to | _____ |
| Thursday  | _____ | to | _____ |
| Friday    | _____ | to | _____ |
| Saturday  | _____ | to | _____ |

### SEATING COUNT

Restaurant: \_\_\_\_\_ Outdoor: 120

Lounge: \_\_\_\_\_ Other (explain): \_\_\_\_\_

Banquet: \_\_\_\_\_ Total Seating: \_\_\_\_\_

|  |  |
|--|--|
| <b>OLCC USE ONLY</b>                             |  |
| Investigator Verified Seating: _____(Y) _____(N) |  |
| Investigator Initials: _____                     |  |
| Date: _____                                      |  |

I understand if my answers are not true and complete, the OLCC may deny my license application.

Applicant Signature: \_\_\_\_\_ Date: \_\_\_\_\_

OREGON LIQUOR CONTROL COMMISSION  
LIMITED LIABILITY COMPANY QUESTIONNAIRE



Please Print or Type

LLC Name: 26 Rue des Arts LLC Year Filed: 2015

Trade Name (dba): Le Tap

Business Location Address: 503 NE Webster Street

City: Portland ZIP Code: 97211

List Members of LLC:

Percentage of Membership Interest:

|  |           |
|--|-----------|
| 1. <u>Laurent Albouze</u><br>(managing member) | <u>50</u> |
| 2. <u>Tyler Ahn</u><br>(members)               | <u>50</u> |
| 3. _____                                       | _____     |
| 4. _____                                       | _____     |
| 5. _____                                       | _____     |
| 6. _____                                       | _____     |

(Note: If any LLC member is another legal entity, that entity must also complete an LLC, Limited Partnership or Corporation Questionnaire. If the LLC has officers, please list them on a separate sheet of paper with their titles.)

Server Education Designee: Laurent Albouze DOB: 08/11/77

I understand that if my answers are not true and complete, the OLCC may deny my license application.

Signature: \_\_\_\_\_ Date: \_\_\_\_\_  
(name) (title)

# CITY OF PORTLAND LIQUOR OUTLET INFORMATION FORM

PLEASE SUBMIT TO: Liquor Licensing Notification Program, 1221 SW 4<sup>th</sup> Avenue, Suite #110, Portland OR 97204

On New Outlet applications, property owners within 300 feet of the location, the Portland Police Bureau and all interested parties are notified by mail (with a copy of this form) and given an opportunity to comment on your application. The OLCC allows the City at least 45 days to complete the recommendation process. Submission of a complete operating plan can expedite the time required to process. A City liquor endorsement is not a confirmation that the property is properly zoned. Call (503) - 823-7526 to confirm that the property is properly zoned.

On submission of this form, you must also include the following:

- OLCC Liquor Application Form, initialed by your OLCC License Investigator
- OLCC Individual History Forms (all persons anticipated to have a financial interest, or key personnel are required)
- City Endorsement Fees

City Endorsement Fees are payable at the beginning of the application process (please make checks payable to City of Portland): New outlets are \$100.00, all others are \$75.00. All blank sections must be filled in. If the question does not apply, write "N/A" in the space.

LEGAL NAME OF BUSINESS: 26 Rue des Arts LLC

DBA OR TRADE NAME: Le Tap PHONE: 3105677019 FAX: \_\_\_\_\_

BUSINESS ADDRESS (Including ZIP Code): 503 NE Webster St, Portland, OR 97211

WHAT TYPE OF LIQUOR ARE YOU APPLYING FOR? (Change of owner, new outlet, beer & wine, etc.): Beer, Wine, Cider

CONTACT PERSON: Laurent Albouze PHONE: 3105677019 EMAIL: letappdx@gmail.com

## DESCRIPTION OF OUTLET

TYPE OF OPERATION (CHECK ALL THAT APPLY)

- Food Cart       Night Club  
 Restaurant       Sports Bar  
 Convenience Store       Other: \_\_\_\_\_

SIZE OF SERVICE AREA: 600 sq ft

EXISTING BUILDING:  Yes       No

ZONING: \_\_\_\_\_

STRUCTURAL CHANGES (DESCRIBE): \_\_\_\_\_

RESTAURANT SEATING CAPACITY: \_\_\_\_\_ LOUNGE SEATING CAPACITY: \_\_\_\_\_ OUTSIDE SEATING CAPACITY: 45

DESCRIBE SECURITY: Lot surrounded by 2 buildings, only one side exit which can be monitored from cart

HAS AN APPLICATION FOR A LIQUOR LICENSE AT THIS LOCATION BEEN RECEIVED BY THE CITY OF PORTLAND IN THE LAST TWO (2) YEARS?  
 Yes       No       I Don't Know

## HOURS OF OPERATION

SUNDAY - THURSDAY OPEN: 12pm CLOSE: 10pm FRIDAY & SATURDAY OPEN: 12pm CLOSE: 10pm

HOW LATE WILL THERE BE OUTSIDE SEATING? 10pm HOW LATE WILL THERE BE ENTERTAINMENT? N/A

## HISTORY OF LOCATION

PREVIOUS BUSINESS NAME OF THIS LOCATION: \_\_\_\_\_

NAME & ADDRESS OF PROPERTY OWNER: \_\_\_\_\_

## ENTERTAINMENT

TYPE OF ENTERTAINMENT (CHECK ALL THAT APPLY)

- Dancing       Video Poker       Live Music       Nude Dancers  
 Karaoke       Video Games/Pinball       Recorded Music       DJ Entertainment  
 Pool Tables (How Many): \_\_\_\_\_  Events (Describe): \_\_\_\_\_  Other: \_\_\_\_\_

The City requires an **Amusement Location Permit** for all locations with amusement devices or pool tables. **Contact the Revenue Bureau for rules and an Amusement Location Permit application form now.** Permits are non-transferable from one owner to another and must be paid before games are placed on the premises. Contact Anne Holm at 503-865-2488. The City of Portland will notify affected nearby neighbors and a copy of this form will be included in our mailing.

Use this area to provide any additional information that you wish to be considered on this liquor application  
Moving the existing business on 15th & Alberta to a new lot. Alcohol license was granted in June to operate.

A false answer or omission of any requested information may result in an unfavorable City recommendation.

SIGNATURE: \_\_\_\_\_ DATE: 07/27/17

Property Search Scale: 1" = 34'

Owner: Narr ALBERTA STREET HOLDING  
 Site Address: 2314 NE ALBERTA ST  
 State ID: 1N1E23AD 1800  
 Account #: R295293

Search    
 Geocode Address When Taxlot Not  
 Search is Based on Active Field Only  
 Hide Personal Property Accounts  
 Display Taxlot Detail Window

Navigate Query Re:

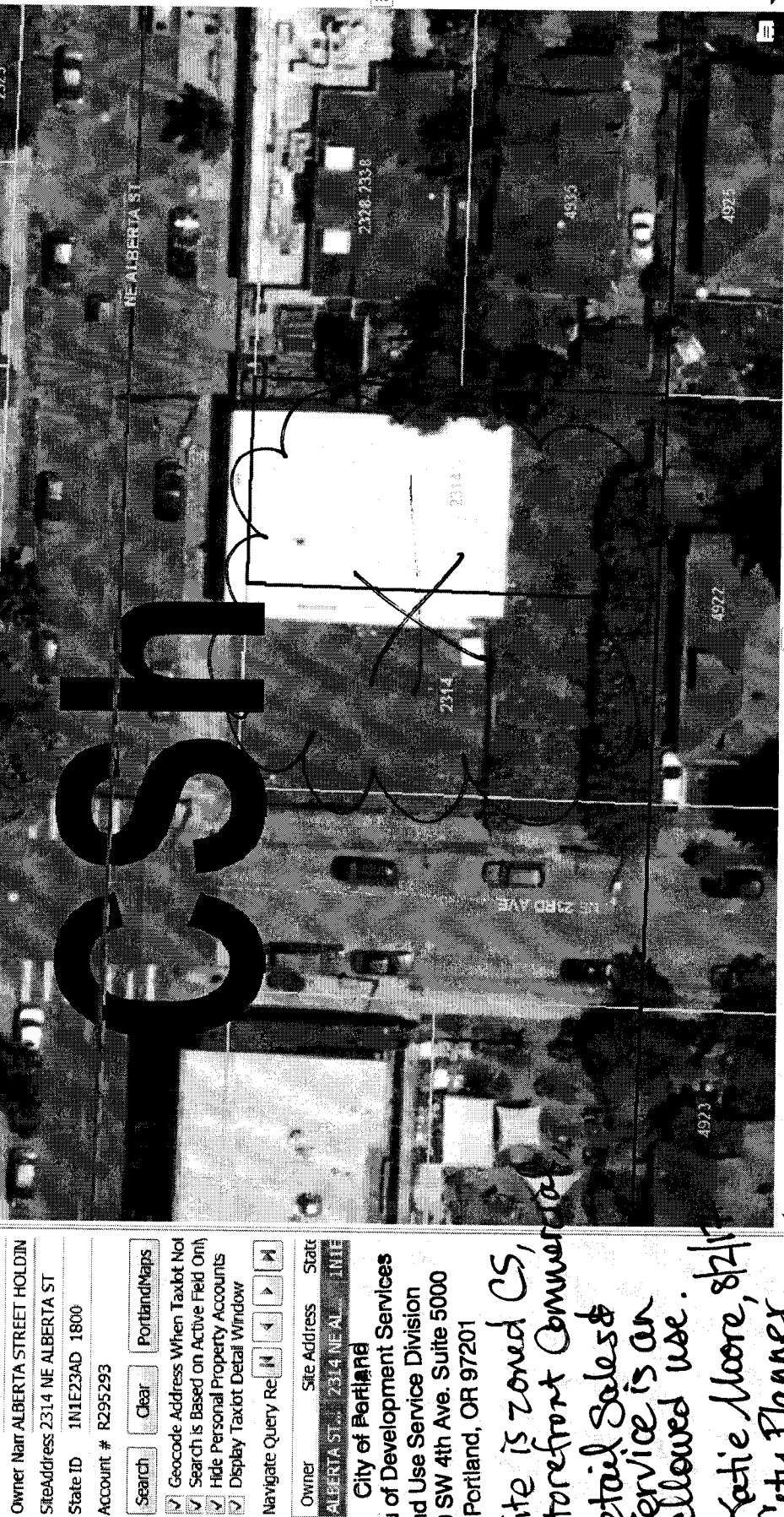

**Taxlot Details**

|   |                          |                        |                     |
|---|--------------------------|------------------------|---------------------|
| Lot Size: 5000 sqft   | Building Size: 3250 sqft | Map Number: 2532       | Zoning Code(s): CSH |
| Legal Description: VERNON, BLOCK 34, E 50' OF LOT 1&2                         | Lot & Block: 182         | Historic District:     |                     |
|   | 34                       | Conservation District: |                     |
| Mailing Information: ALBERTA STREET HOLDINGS LLC<br>333 S STATE ST #V PMB 466 |                          | Jurisdiction: Portland |                     |

Plan District: LUR Case Histo (1 Case)  
 CU 1-78  
 SubDistrict:    
 SubArea: NRMP:

**City of Portland**  
 Bureau of Development Services  
 Land Use Service Division  
 1900 SW 4th Ave, Suite 5000  
 Portland, OR 97201

*Site is zoned CS,  
 storefront Commercial,  
 Retail Sales &  
 Service is an  
 allowed use.*

*Katie Moore, 8/21/14  
 City Planner  
 Katie Moore  
 503-823-7344*