

SEP 15 2017

PD 75
1408



OREGON LIQUOR CONTROL COMMISSION
LIQUOR LICENSE APPLICATION

Application is being made for:		CITY AND COUNTY USE ONLY	
LICENSE TYPES	ACTIONS	Date application received: _____	
<input checked="" type="checkbox"/> Full On-Premises Sales (\$402.60/yr)	<input checked="" type="checkbox"/> Change Ownership	The City Council or County Commission: _____	
<input checked="" type="checkbox"/> Commercial Establishment	<input type="checkbox"/> New Outlet	(name of city or county)	
<input type="checkbox"/> Caterer	<input type="checkbox"/> Greater Privilege	recommends that this license be:	
<input type="checkbox"/> Passenger Carrier	<input type="checkbox"/> Additional Privilege	<input type="checkbox"/> Granted <input type="checkbox"/> Denied	
<input type="checkbox"/> Other Public Location	<input checked="" type="checkbox"/> Other <u>OTD</u>	By: _____	
<input type="checkbox"/> Private Club		(signature) (date)	
<input type="checkbox"/> Limited On-Premises Sales (\$202.60/yr)		Name: _____	
<input type="checkbox"/> Off-Premises Sales (\$100/yr)		Title: _____	
<input type="checkbox"/> with Fuel Pumps		OLCC USE ONLY	
<input type="checkbox"/> Brewery Public House (\$252.60)		Application Rec'd by: _____	
<input type="checkbox"/> Winery (\$250/yr)		Date: <u>9-8-17</u>	
<input checked="" type="checkbox"/> Other: WMBW; Brewery (BRW)		90-day authority: <input type="checkbox"/> Yes <input type="checkbox"/> No	
90-DAY AUTHORITY			
<input type="checkbox"/> Check here if you are applying for a change of ownership at a business that has a current liquor license, or if you are applying for an Off-Premises Sales license and are requesting a 90-Day Temporary Authority			
APPLYING AS:			
<input type="checkbox"/> Limited Partnership <input type="checkbox"/> Corporation <input type="checkbox"/> Limited Liability Company <input type="checkbox"/> Individuals			

1. Entity or Individuals applying for the license: [See SECTION 1 of the Guide]

① Modern Times Drinks, Inc. ③ _____

② _____ ④ _____

2. Trade Name (dba): Modern Times Beer

3. Business Location: 628-630 SE Belmont Street Portland Multnomah OR 97214
(number, street, rural route) (city) (county) (state) (ZIP code)

4. Business Mailing Address: 3725 Greenwood Street San Diego CA 92110
(PO box, number, street, rural route) (city) (state) (ZIP code)

5. Business Numbers: TBD (phone) (fax)

6. Is the business at this location currently licensed by OLCC? Yes No

7. If yes to whom: NW Craftworks LLC Type of License: Brewery Public House

8. Former Business Name: The Commons Brewery

9. Will you have a manager? Yes No Name: TBD
(manager must fill out an Individual History form)

10. What is the local governing body where your business is located? City of Portland
(name of city or county)

11. Contact person for this application: Duke Tufty, NW Alcohol Law (503) 718-2310
(name) (phone number(s))
123 NE Third Ave., Suite 310, Portland, OR 97212 duke@nwalcoholaw.com
(address) (fax number) (e-mail address)

I understand that if my answers are not true and complete, the OLCC may deny my license application.

Applicant(s) Signature(s) and Date:

① Date 8/31/17 ③ _____ RECEIVED

② _____ Date _____ ④ _____ Date SEP 05 2017
(has 08/2011)



OREGON LIQUOR CONTROL COMMISSION
BUSINESS INFORMATION

Please Print or Type

Applicant Name: Modern Times Drinks, Inc. Phone: TBD

Trade Name (dba): Modern Times Beer

Business Location Address: 628-630 SE Belmont Street

City: Portland ZIP Code: 97214

DAYS AND HOURS OF OPERATION

Business Hours:

Sunday 8:00am to 12:00am
Monday 8:00am to 12:00am
Tuesday 8:00am to 12:00am
Wednesday 8:00am to 12:00am
Thursday 8:00am to 12:00am
Friday 8:00am to 12:00am
Saturday 8:00am to 12:00am

Outdoor Area Hours: N/A

Sunday to
Monday to
Tuesday to
Wednesday to
Thursday to
Friday to
Saturday to

The outdoor area is used for:

- Food service Hours: to
Alcohol service Hours: to
Enclosed, how

The exterior area is adequately viewed and/or supervised by Service Permittees.

(Investigator's Initials)

Seasonal Variations: Yes No If yes, explain:

ENTERTAINMENT

Check all that apply:

- Live Music
Recorded Music
DJ Music
Dancing
Nude Entertainers
Karaoke
Coin-operated Games
Video Lottery Machines
Social Gaming
Pool Tables
Other:

DAYS & HOURS OF LIVE OR DJ MUSIC

Sunday to
Monday to
Tuesday to
Wednesday to
Thursday to
Friday to
Saturday to

SEATING COUNT

Restaurant: 36 Outdoor:
Lounge: Other (explain):
Banquet: Total Seating: 36

OLCC USE ONLY
Investigator Verified Seating: (Y) (N)
Investigator Initials:
Date:

I understand if my answers are not true and complete, the OLCC may deny my license application.

Applicant Signature: Date: 8/3/17



OREGON LIQUOR CONTROL COMMISSION
CORPORATION QUESTIONNAIRE

Please Print or Type

Corporation Name: Modern Times Drinks, Inc. Year Incorporated: 2017

Trade Name (dba): Modern Times Beer

Business Location Address: 628-630 SE Belmont St.

City: Portland ZIP Code: 97214

List Corporate Officers:

<u>Jacob McKean</u>	<u>President</u>
(name)	(title)
<u>Chris Sarette</u>	<u>CFO & Secretary</u>
_____	_____
_____	_____

List Board of Directors:

Jacob McKean
(name)
Chris Sarette

David Hahn

Stanley Gold

List Stockholders: (Note: If any stockholder is another legal entity, that entity may also need to complete another Corporation Questionnaire. See Liquor License Application Guide for more information.)

<u>Stockholders:</u>	<u>Number of Shares Held:</u>	Number of Stock Shares: Issued: _____ Unissued: _____ Total Shares Authorized to Issue: _____
<u>Jacob McKean</u>	<u>528,582</u>	
<u>Modern Times Employee Stock Ownership Trust</u> See attached for list of Shareholders with less than 10%	<u>314,292</u>	
_____	_____	

Server Education Designee: _____ **DOB:** _____
(See Liquor License Application Guide for more information)

I understand that if my answers are not true and complete, the OLCC may deny my license application.

Officer's Signature: [Signature] CFO/Secretary Date: 8/31/17
(name) (title)

CITY OF PORTLAND LIQUOR OUTLET INFORMATION FORM

PLEASE SUBMIT TO: Mike Boyer, Office of Neighborhood Involvement, 1221 SW 4th Avenue, Suite #110, Portland OR 97204 - (503) 823-3092

On New Outlet applications, property owners within 300 feet of the location, the Portland Police Bureau and all interested parties are notified by mail (with a copy of this form) and given an opportunity to comment on your application. The OLCC allows the City at least 45 days to complete the recommendation process. Submission of a complete operating plan can expedite the time required to process. A City liquor endorsement is not a confirmation that the property is properly zoned. Call (503) - 823-7526 to confirm that the property is properly zoned.

On submission of this form, you must also include the following:

- OLCC Liquor Application Form, initialed by your OLCC License Investigator
- OLCC Individual History Forms (all persons anticipated to have a financial interest, or key personnel are required)
- City Endorsement Fees

City Endorsement Fees are payable at the beginning of the application process (please make checks payable to City of Portland): New outlets are \$100.00, all others are \$75.00. All blank sections must be filled in. If the question does not apply, write "N/A" in the space.

LEGAL NAME OF BUSINESS: Modern Times Drinks, Inc.
DBA OR TRADE NAME: Modern Times Beer PHONE: TBD FAX: _____
BUSINESS ADDRESS (Including ZIP Code): 628-630 SE Belmont St., Portland, OR 97214
WHAT TYPE OF LIQUOR ARE YOU APPLYING FOR? (Change of owner, new outlet, beer & wine, etc.): Change of Ownership
CONTACT PERSON: Duke Tufty PHONE: 503-718-2310 EMAIL: duke@nwalcohollow.com

DESCRIPTION OF OUTLET

TYPE OF OPERATION (CHECK ALL THAT APPLY)
 Food Cart Night Club
 Restaurant Sports Bar
 Convenience Store Other: Brew Pub
SIZE OF SERVICE AREA: ~3500 Sq.Ft.
EXISTING BUILDING: Yes No
ZONING: IG1
STRUCTURAL CHANGES (DESCRIBE): None occurring at this time of ownership change
RESTAURANT SEATING CAPACITY: 36 LOUNGE SEATING CAPACITY: N/A OUTSIDE SEATING CAPACITY: N/A
DESCRIBE SECURITY: All exterior entrances have deadbolt locks and there will be an alarm system.

HAS AN APPLICATION FOR A LIQUOR LICENSE AT THIS LOCATION BEEN RECEIVED BY THE CITY OF PORTLAND IN THE LAST TWO (2) YEARS?
 Yes No I Don't Know

HOURS OF OPERATION

SUNDAY - THURSDAY OPEN: 6:00am CLOSE: 12:00am FRIDAY & SATURDAY OPEN: 6:00am CLOSE: 12:00am
HOW LATE WILL THERE BE OUTSIDE SEATING? N/A HOW LATE WILL THERE BE ENTERTAINMENT? Until close

HISTORY OF LOCATION

PREVIOUS BUSINESS NAME OF THIS LOCATION: The Commons Brewery
NAME & ADDRESS OF PROPERTY OWNER: Park Addition, LLC - 4206 SE Taggart, Portland, OR 97206

ENTERTAINMENT

TYPE OF ENTERTAINMENT (CHECK ALL THAT APPLY)
 Dancing Video Poker Live Music Nude Dancers
 Karaoke Video Games/Pinball Recorded Music DJ Entertainment
 Pool Tables (How Many): _____ Events (Describe): _____ Other: _____

The City requires an **Amusement Location Permit** for all locations with amusement devices or pool tables. **Contact the Revenue Bureau for rules and an Amusement Location Permit application form now.** Permits are non-transferable from one owner to another and must be paid before games are placed on the premises. Contact Anne Holm at 503-865-2488. The City of Portland will notify affected nearby neighbors and a copy of this form will be included in our mailing.

Use this area to provide any additional information that you wish to be considered on this liquor application

A false answer or omission of any requested information may result in an unfavorable City recommendation.

SIGNATURE:  DATE: 8/23/17

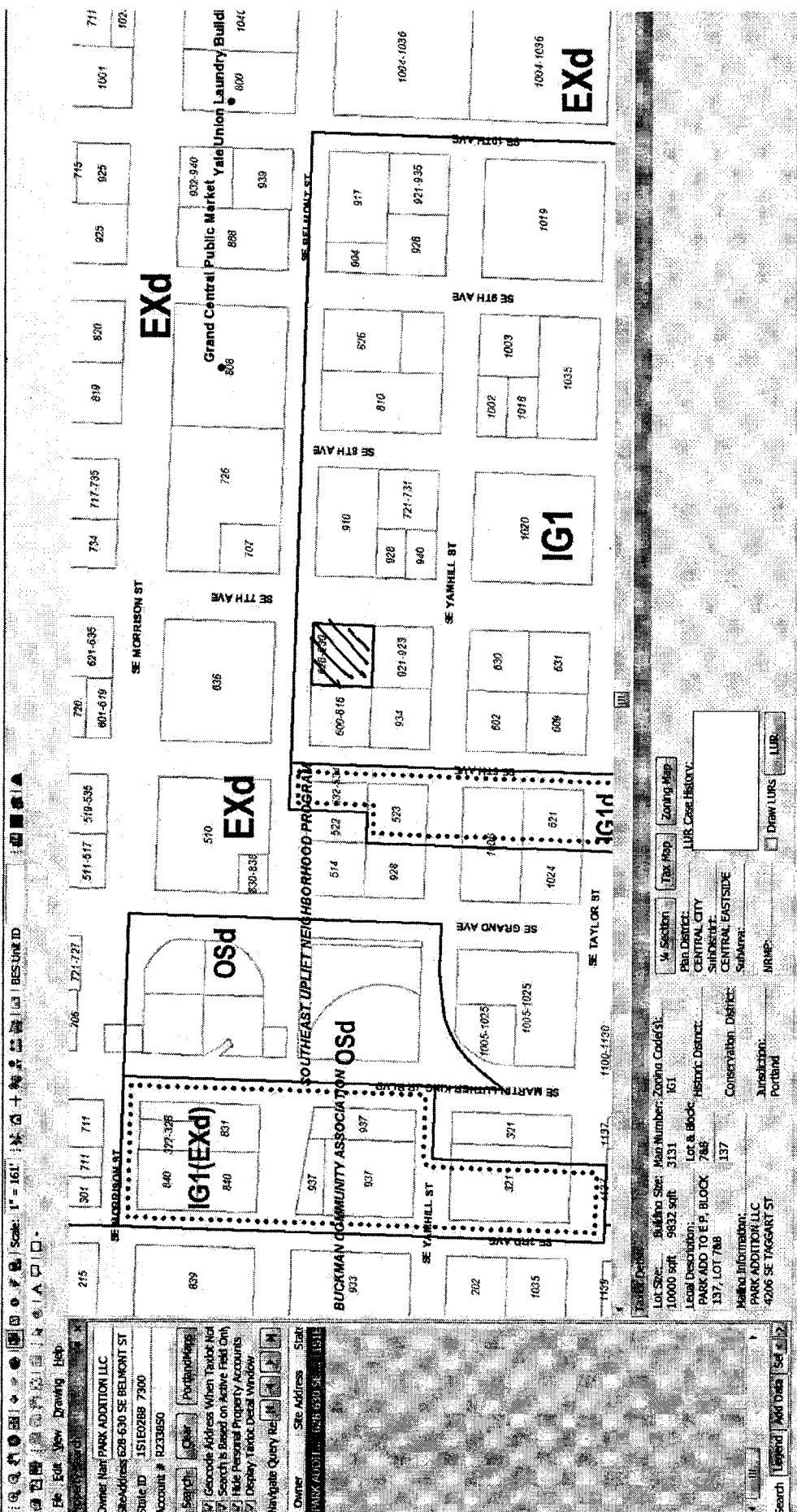

Scale: 1" = 161'
 Owner: PARK ADDITION LLC
 Address: 4206 SE TAGGART ST
 Account #: R233850

Lot 10000 50R 9822 SPT 3131
 Local Description: LOT 768
 Block: 768
 Main Information: PARK ADDITION LLC
 Address: 4206 SE TAGGART ST

Map Information:
 W. Section: Plain District
 Tax Map: CENTRAL CITY
 Zoning Map: SHIRASITE
 LUR Case History: CENTRAL EASTSIDE SUBAREA

Map Information:
 MRHP: _____
 Draw LUR: Draw LUR: LUR:

One Retail Sales and Service or Office use is allowed per site. The square footage of net building area plus the exterior display and storage area may be up to 3,000 square feet.

Breah Pike-Salas, City Planner *BS*

City of Portland
 Bureau of Development Services
 Land Use Service Division
 1900 SW 4th Ave. Suite 500C
 Portland, OR 97201

City of Portland, Oregon 503.823.7389