



OREGON LIQUOR CONTROL COMMISSION LIQUOR LICENSE APPLICATION

Dm

Application is being made for:

LICENSE TYPES

- Full On-Premises Sales (\$402.60/yr)
 - Commercial Establishment
 - Caterer
 - Passenger Carrier
 - Other Public Location
 - Private Club
- Limited On-Premises Sales (\$202.60/yr)
- Off-Premises Sales (\$100/yr)
 - with Fuel Pumps
- Brewery Public House (\$252.60)
- Winery (\$250/yr)
- Other: _____

ACTIONS

- Change Ownership
- New Outlet
- Greater Privilege
- Additional Privilege
- Other _____

Rec'd by Portland
Liquor Licenses

SEP 25 2017

PD \$100 dk
1193

90-DAY AUTHORITY

Check here if you are applying for a change of ownership at a business that has a current liquor license, or if you are applying for an Off-Premises Sales license and are requesting a 90-Day Temporary Authority

APPLYING AS:

- Limited Partnership
- Corporation
- Limited Liability Company
- Individuals

CITY AND COUNTY USE ONLY

Date application received: _____

The City Council or County Commission:

(name of city or county)

recommends that this license be:

- Granted
- Denied

By: _____
(signature) (date)

Name: _____

Title: _____

OLCC USE ONLY

Application Rec'd by: *[Signature]*

Date: 7-31-17

90-day authority: Yes No

1. Entity or Individuals applying for the license: [See SECTION 1 of the Guide]

- ① SEASWEETS POKE, LLC ③ _____
- ② _____ ④ _____

2. Trade Name (dba): SEASWEETS POKE

3. Business Location: 1505 SE 31st AVE. PORTLAND MULTNOMAH OR 97214
(number, street, rural route) (city) (county) (state) (ZIP code)

4. Business Mailing Address: 1505 SE 31st AVE. PORTLAND OR 97214
(PO box, number, street, rural route) (city) (state) (ZIP code)

5. Business Numbers: 503 477 4029
(phone) (fax)

6. Is the business at this location currently licensed by OLCC? Yes No

7. If yes to whom: _____ Type of License: _____

8. Former Business Name: _____

9. Will you have a manager? Yes No Name: DAVID LO, IAN HUNG
(manager must fill out an Individual History form)

10. What is the local governing body where your business is located? PORTLAND
(name of city or county)

11. Contact person for this application: DAVID LO 503 706 6343
(name) (phone number(s))
1505 SE 31st AVE, PORTLAND, OR 97214 hello@seasweetpoke.com
(address) (fax number) (e-mail address)

I understand that if my answers are not true and complete, the OLCC may deny my license application.

Applicant(s) Signature(s) and Date:

- ① *[Signature]* Date 5/29/2017 ③ _____
- ② _____ Date _____ ④ _____

RECEIVED

Date
JUN 30 2017

(rev. 08/2011)

Initials: _____
Oregon Liquor Control Commission



OREGON LIQUOR CONTROL COMMISSION BUSINESS INFORMATION

Please Print or Type

Applicant Name: SEASWEETS POKE, LLC Phone: 503 477 4029

Trade Name (dba): SEASWEETS POKE

Business Location Address: 1505 SE 31ST AVE.

City: PORTLAND ZIP Code: 97214

DAYS AND HOURS OF OPERATION

Business Hours:

Sunday	<u>11 am</u> to <u>9 pm</u>
Monday	<u>11</u> to <u>9</u>
Tuesday	<u>11</u> to <u>9</u>
Wednesday	<u>11</u> to <u>9</u>
Thursday	<u>11</u> to <u>9</u>
Friday	<u>11</u> to <u>9</u>
Saturday	<u>11</u> to <u>9</u>

Outdoor Area Hours:

Sunday	<u>11</u> to <u>9</u>
Monday	<u>11</u> to <u>9</u>
Tuesday	<u>11</u> to <u>9</u>
Wednesday	<u>11</u> to <u>9</u>
Thursday	<u>11</u> to <u>9</u>
Friday	<u>11</u> to <u>9</u>
Saturday	<u>11</u> to <u>9</u>

The outdoor area is used for:

Food service Hours: 11 to 9

Alcohol service Hours: 11 to 9

Enclosed, how _____

The exterior area is adequately viewed and/or supervised by Service Permittees.

(Investigator's Initials)

Seasonal Variations: Yes No If yes, explain: _____

ENTERTAINMENT

Check all that apply:

- | | |
|--|---|
| <input type="checkbox"/> Live Music | <input type="checkbox"/> Karaoke |
| <input type="checkbox"/> Recorded Music | <input type="checkbox"/> Coin-operated Games |
| <input type="checkbox"/> DJ Music | <input type="checkbox"/> Video Lottery Machines |
| <input type="checkbox"/> Dancing | <input type="checkbox"/> Social Gaming |
| <input type="checkbox"/> Nude Entertainers | <input type="checkbox"/> Pool Tables |
| | <input type="checkbox"/> Other: _____ |

DAYS & HOURS OF LIVE OR DJ MUSIC

Sunday	_____ to _____
Monday	_____ to _____
Tuesday	_____ to _____
Wednesday	_____ to _____
Thursday	_____ to _____
Friday	_____ to _____
Saturday	_____ to _____

SEATING COUNT

Restaurant: 32 Outdoor: 6

Lounge: _____ Other (explain): _____

Banquet: _____ Total Seating: _____

OLCC USE ONLY	
Investigator Verified Seating: _____(Y) _____(N)	
Investigator Initials: _____	
Date: _____	

I understand if my answers are not true and complete, the OLCC may deny my license application.

Applicant Signature: [Signature] Date: 5/29/2017

OREGON LIQUOR CONTROL COMMISSION
LIMITED LIABILITY COMPANY QUESTIONNAIRE



1240903-90

Please Print or Type

LLC Name: SEASWEETS POKE, LLC Year Filed: 2016 ✓

Trade Name (dba): SEASWEETS POKE

Business Location Address: 1505 SE 31st AVE.

City: PORTLAND ZIP Code: 97214

List Members of LLC:

Percentage of Membership Interest:

1. DAVID LO
(managing member)

57.1%

2. IAN HUNG
(members)

42.9%

3. _____

4. _____

5. _____

6. _____

(Note: If any LLC member is another legal entity, that entity must also complete an LLC, Limited Partnership or Corporation Questionnaire. If the LLC has officers, please list them on a separate sheet of paper with their titles.)

Server Education Designee: DAVID LO DOB: 3/18/1980

I understand that if my answers are not true and complete, the OLCC may deny my license application.

Signature: [Handwritten Signature]
(name)

MEMBER
(title)

Date: 5/29/2017
DL

CITY OF PORTLAND LIQUOR OUTLET INFORMATION FORM

PLEASE SUBMIT TO: Liquor Licensing Notification Program, 1221 SW 4th Avenue, Suite #110, Portland OR 97204

On New Outlet applications, property owners within 300 feet of the location, the Portland Police Bureau and all interested parties are notified by mail (with a copy of this form) and given an opportunity to comment on your application. The OLCC allows the City at least 45 days to complete the recommendation process. Submission of a complete operating plan can expedite the time required to process. A City liquor endorsement is not a confirmation that the property is properly zoned. Call (503) - 823-7526 to confirm that the property is properly zoned.

On submission of this form, you must also include the following:

- OLCC Liquor Application Form, initialed by your OLCC License Investigator
- OLCC Individual History Forms (all persons anticipated to have a financial interest, or key personnel are required)
- City Endorsement Fees

City Endorsement Fees are payable at the beginning of the application process (please make checks payable to City of Portland): New outlets are \$100.00, all others are \$75.00. All blank sections must be filled in. If the question does not apply, write "N/A" in the space.

LEGAL NAME OF BUSINESS: SEASWEETS POKE, LLC

DBA OR TRADE NAME: SEASWEETS POKE PHONE: 503 477 4029 FAX: _____

BUSINESS ADDRESS (Including ZIP Code): 1505 SE 31st AVE., PORTLAND, OR 97214

WHAT TYPE OF LIQUOR ARE YOU APPLYING FOR? (Change of owner, new outlet, beer & wine, etc.): NEW OUTLET, LIMITED ON-PREMISES

CONTACT PERSON: DAVID LO PHONE: 503 477 4029 EMAIL: hello@seasweetspoke.com

DESCRIPTION OF OUTLET

TYPE OF OPERATION (CHECK ALL THAT APPLY)

- | | |
|--|---------------------------------------|
| <input type="checkbox"/> Food Cart | <input type="checkbox"/> Night Club |
| <input checked="" type="checkbox"/> Restaurant | <input type="checkbox"/> Sports Bar |
| <input type="checkbox"/> Convenience Store | <input type="checkbox"/> Other: _____ |

SIZE OF SERVICE AREA: Approx. 1400 sq. ft.

EXISTING BUILDING: Yes No

ZONING: CS

STRUCTURAL CHANGES (DESCRIBE): N/A

RESTAURANT SEATING CAPACITY: 32 LOUNGE SEATING CAPACITY: N/A OUTSIDE SEATING CAPACITY: 6

DESCRIBE SECURITY: SECURITY CAMERAS

HAS AN APPLICATION FOR A LIQUOR LICENSE AT THIS LOCATION BEEN RECEIVED BY THE CITY OF PORTLAND IN THE LAST TWO (2) YEARS?
 Yes No I Don't Know

HOURS OF OPERATION

SUNDAY - THURSDAY OPEN: 11am CLOSE: 9pm FRIDAY & SATURDAY OPEN: 11am CLOSE: 9pm

HOW LATE WILL THERE BE OUTSIDE SEATING? UNTIL 9pm HOW LATE WILL THERE BE ENTERTAINMENT? N/A

HISTORY OF LOCATION

PREVIOUS BUSINESS NAME OF THIS LOCATION: N/A

NAME & ADDRESS OF PROPERTY OWNER: HAWTHORNE 31 APARTMENTS, LLC

ENTERTAINMENT

3330 NW YEON AVE., SUITE 100, PORTLAND, OR 97210

TYPE OF ENTERTAINMENT (CHECK ALL THAT APPLY)

- | | | | |
|--|---|--|---|
| <input type="checkbox"/> Dancing | <input type="checkbox"/> Video Poker | <input type="checkbox"/> Live Music | <input type="checkbox"/> Nude Dancers |
| <input type="checkbox"/> Karaoke | <input type="checkbox"/> Video Games/Pinball | <input checked="" type="checkbox"/> Recorded Music | <input type="checkbox"/> DJ Entertainment |
| <input type="checkbox"/> Pool Tables (How Many): _____ | <input type="checkbox"/> Events (Describe): _____ | <input type="checkbox"/> Other: _____ | |

The City requires an **Amusement Location Permit** for all locations with amusement devices or pool tables. **Contact the Revenue Bureau for rules and an Amusement Location Permit application form now.** Permits are non-transferable from one owner to another and must be paid before games are placed on the premises. Contact Anne Holm at 503-865-2488. The City of Portland will notify affected nearby neighbors and a copy of this form will be included in our mailing.

Use this area to provide any additional information that you wish to be considered on this liquor application

A false answer or omission of any requested information may result in an unfavorable City recommendation.

SIGNATURE: [Signature] DATE: 9/17/2017

Property Search

Owner: Nan HAWTHORNE 31 APARTM
 Site Address: 1515 SE 31ST AVE
 State ID: ISLEOICA 4900
 Account #: R168815

- Geocode Address When Taxlot Not
 - Search is Based on Active Field Only
 - Hide Personal Property Accounts
 - Display Taxlot Detail Window
- Search Clear PortlandMaps

Owner: Nan Hawthorne
 Site Address: 1515 SE 31ST AVE
 State: OR

Zone: CS, Store Front
 COMMERCIAL.
 RETAIL SALES &
 SERVICE ALLOWED BY
 RIGHT.

Deputy司徒
 City Planner
 503.823.7919

City of Portland
 Bureau of Development Services
 Land Use Service Division
 1900 SW 4th Ave, Suite 5000
 Portland, OR 97201
 9/18/17

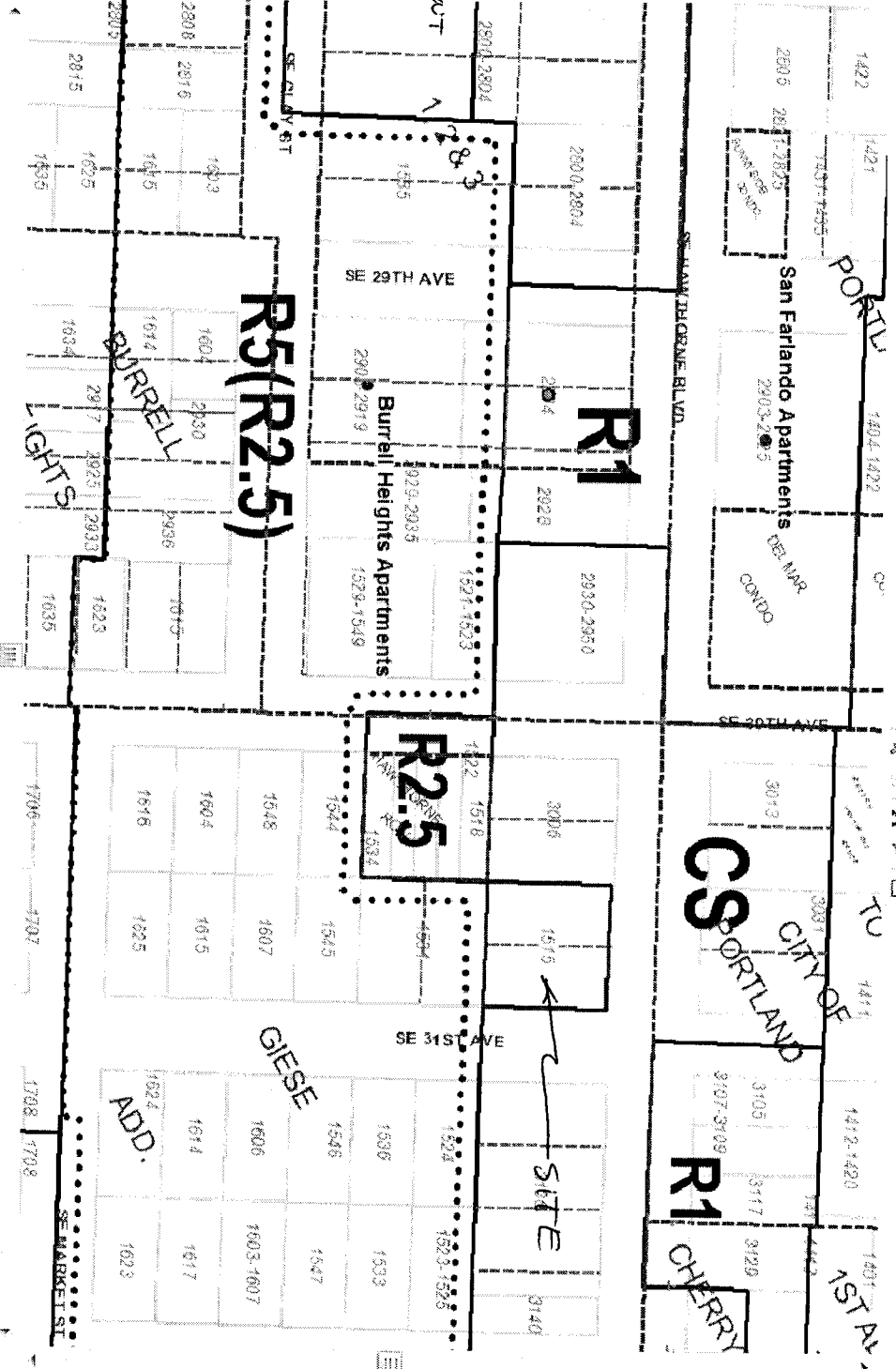

Taxlot Details

Lot Size: 9760 sqft
 Building Size: 24583 sqft
 Main Number: 3233
 Zoning Code(s): CS

Legal Description: GIESE ADD, BLOCK 1, LOT 15816
 15816 EXC PT IN ST 1

Mailing Information: HAWTHORNE 31 APARTMENTS, LLC
 3330 NW YEON AVE #100

1/4 Section
 Tax Map
 Zoning Map

Plan District:
 Subdistrict:
 Subarea:
 Conservation District:

Jurisdiction: Portland

Draw LuRS
 LUR

LUR Case Hist (3 Cases)
 EA 14-183956 APPPT
 LUR 99-00068
 VZ 015-66