



LIQUOR LICENSE APPLICATION

PR

LICENSE FEE: Do not include the license fee with the application (the license fee will be collected at a later time).

APPLICATION: Application is being made for:

- Brewery
- Brewery-Public House
- Distillery
- Full On-Premises, Commercial
- Full On-Premises, Caterer
- Full On-Premises, Passenger Carrier
- Full On-Premises, Other Public Location
- Full On-Premises, Nonprofit Private Club
- Full On-Premises, For-Profit Private Club
- Grower Sales Privilege
- Limited On-Premises
- Off-Premises
- Off-Premises with Fuel Pumps
- Warehouse
- Wholesale Malt Beverage & Wine (WMBW)
- Winery

CITY AND COUNTY USE ONLY

Date application received _____

Name of City or County _____

Recommends this license be ___ Granted ___ Denied

By _____

Date _____

OLCC USE

Application received by [Signature]

Date 9-28-17

License Action:

New Outlet

1. LEGAL ENTITY (example: corporation or LLC) or INDIVIDUAL(S) applying for the license:

Applicant #1 Free Public, SPC	Applicant #2	Rec'd by Portland Liquor Licenses OCT 04 2017 PD 100 ⁰⁰ PPS # <u>CC 052912</u>
Applicant #3	Applicant #4	

2. Trade Name of the Business (the name customers will see):

Free Public Wines

3. Business Location: Number and Street 329 NE Couch St, Suite 209

City <u>Portland</u>	County <u>Multnomah</u>	ZIP <u>97232</u>
----------------------	-------------------------	------------------

4. Is the business at this location currently licensed by the OLCC? Yes No

5. Mailing Address (where the OLCC will send your mail):

PO Box, Number, Street, Rural Route	<u>329 NE Couch St #209</u>
City	<u>Portland</u>
State	<u>OR</u>
ZIP	<u>97232</u>

6. Phone Number of the Business Location: 503-250-4055

7. Contact Person for this Application:

Name	<u>Michael Etter</u>	Phone Number	<u>503-250-4055</u>
Mailing Address, City, State, ZIP	<u>329 NE Couch St, Suite 209, Portland OR, 97232</u>		
Email	<u>michael@freepublic.co</u>		

I understand that marijuana (such as use, consumption, ingestion, inhalation, samples, give-away, sale, etc.) is prohibited on the licensed premises.

Signature of Applicant #1 <u>Michael Etter</u>	Signature of Applicant #2 <u>[Signature]</u>
Signature of Applicant #3	Signature of Applicant #4

RECEIVED



OREGON LIQUOR CONTROL COMMISSION
BUSINESS INFORMATION

Please Print or Type

Applicant Name: Free Public, SPC Phone: 503.250-4055
Trade Name (dba): Free Public Wines
Business Location Address: 329 NE Couch St
City: Portland ZIP Code: 97232

DAYS AND HOURS OF OPERATION

Business Hours:

Sunday _____ to _____
Monday _____ to _____
Tuesday _____ to _____
Wednesday _____ to _____
Thursday _____ to _____
Friday _____ to _____
Saturday _____ to _____

Outdoor Area Hours:

Sunday _____ to _____
Monday _____ to _____
Tuesday N/A to N/A
Wednesday N/A to N/A
Thursday _____ to _____
Friday _____ to _____
Saturday _____ to _____

The outdoor area is used for:

Food service Hours: _____ to _____
 Alcohol service Hours: _____ to _____
 Enclosed, how _____

The exterior area is adequately viewed and/or supervised by Service Permittees.

(Investigator's Initials)

Seasonal Variations: Yes No If yes, explain: _____

ENTERTAINMENT

Check all that apply:

- Live Music
- Recorded Music
- DJ Music N
- Dancing N
- Nude Entertainers
- Karaoke
- Coin-operated Games
- Video Lottery Machines
- Social Gaming
- Pool Tables
- Other: _____

DAYS & HOURS OF LIVE OR DJ MUSIC

Sunday _____ to _____
Monday _____ to _____
Tuesday _____ to _____
Wednesday N/A to N/A
Thursday _____ to _____
Friday _____ to _____
Saturday _____ to _____

SEATING COUNT

Restaurant: _____ Outdoor: _____
Lounge: _____ Other (explain): _____
Banquet: _____ Total Seating: _____

OLCC USE ONLY	
Investigator Verified Seating: _____(Y) _____(N)	
Investigator Initials: _____	
Date: _____	

I understand if my answers are not true and complete, the OLCC may deny my license application.

Applicant Signature: [Signature] Date: 9-19-17



OREGON LIQUOR CONTROL COMMISSION CORPORATION QUESTIONNAIRE

135984792

Please Print or Type

Corporation Name: Free Public, SPC Year Incorporated: ~~2016~~ 2017

Trade Name (dba): Free Public, SPC

Business Location Address: 329 NE Couch

City: Portland ZIP Code: 97232

List Corporate Officers:

<u>Michael Etter</u> (name)	<u>Founder</u> (title)
<u>Matt Lounsbury</u>	<u>CEO/COO</u>
_____	_____
_____	_____

List Board of Directors:

Michael Etter

(name)
Matt Lounsbury

Ron Penner-Ash

Gerald Chew, Robert Greenberg

List Stockholders: (Note: If any stockholder is another legal entity, that entity may also need to complete another Corporation Questionnaire. See Liquor License Application Guide for more information.)

<u>Stockholders:</u>	<u>Number of Shares Held:</u>	Number of Stock Shares:
<u>Michael Etter</u>	<u>2,500,000</u>	Issued: _____ Unissued: _____ Total Shares Authorized to Issue: _____
<u>Matt Lounsbury</u>	<u>352,201</u>	
<u>Ron Penner-Ash</u>	<u>88,050</u>	
<u>Robert Greenberg</u>	<u>88,050</u>	

Server Education Designee: N/A DOB: 05/30/67
(See Liquor License Application Guide for more information)

I understand that if my answers are not true and complete, the OLCC may deny my license application.

Officer's Signature: [Signature] (name) Founder/President (title) Date: 09/17/17

CITY OF PORTLAND LIQUOR OUTLET INFORMATION FORM

PLEASE SUBMIT TO: Liquor Licensing Notification Program, 1221 SW 4th Avenue, Suite #110, Portland OR 97204

On New Outlet applications, property owners within 300 feet of the location, the Portland Police Bureau and all interested parties are notified by mail (with a copy of this form) and given an opportunity to comment on your application. The OLCC allows the City at least 45 days to complete the recommendation process. Submission of a complete operating plan can expedite the time required to process. A City liquor endorsement is not a confirmation that the property is properly zoned. Call (503) - 823-7526 to confirm that the property is properly zoned.

On submission of this form, you must also include the following:

- OLCC Liquor Application Form, initialed by your OLCC License Investigator
- OLCC Individual History Forms (all persons anticipated to have a financial interest, or key personnel are required)
- City Endorsement Fees

City Endorsement Fees are payable at the beginning of the application process (please make checks payable to City of Portland): New outlets are \$100.00, all others are \$75.00. All blank sections must be filled in. If the question does not apply, write "N/A" in the space.

LEGAL NAME OF BUSINESS: Free Public, SPC

DBA OR TRADE NAME: Free Public Wines PHONE: 503.250.4055 FAX: _____

BUSINESS ADDRESS (Including ZIP Code): 329 NE Couch St. Portland, OR 97232

WHAT TYPE OF LIQUOR ARE YOU APPLYING FOR? (Change of owner, new outlet, beer & wine, etc.): New Outlet, WMBW

CONTACT PERSON: Michael Etter PHONE: 503.250.4055 EMAIL: mhet@freepublic.co
Math Lunsbury 503.7404460

DESCRIPTION OF OUTLET

TYPE OF OPERATION (CHECK ALL THAT APPLY)

- Food Cart Night Club
 Restaurant Sports Bar
 Convenience Store Other: Wholesale

SIZE OF SERVICE AREA: N/A

EXISTING BUILDING: Yes No

ZONING: _____

STRUCTURAL CHANGES (DESCRIBE): _____

RESTAURANT SEATING CAPACITY: N/A LOUNGE SEATING CAPACITY: N/A OUTSIDE SEATING CAPACITY: N/A

DESCRIBE SECURITY: N/A

HAS AN APPLICATION FOR A LIQUOR LICENSE AT THIS LOCATION BEEN RECEIVED BY THE CITY OF PORTLAND IN THE LAST TWO (2) YEARS?
 Yes No I Don't Know

HOURS OF OPERATION

SUNDAY - THURSDAY OPEN: N/A CLOSE: N/A FRIDAY & SATURDAY OPEN: N/A CLOSE: _____

HOW LATE WILL THERE BE OUTSIDE SEATING? N/A HOW LATE WILL THERE BE ENTERTAINMENT? _____

HISTORY OF LOCATION

PREVIOUS BUSINESS NAME OF THIS LOCATION: N/A

NAME & ADDRESS OF PROPERTY OWNER: _____

ENTERTAINMENT

TYPE OF ENTERTAINMENT (CHECK ALL THAT APPLY)

- Dancing Video Poker Live Music Nude Dancers
 Karaoke Video Games/Pinball Recorded Music DJ Entertainment
 Pool Tables (How Many): _____ Events (Describe): _____ Other: _____

The City requires an **Amusement Location Permit** for all locations with amusement devices or pool tables. **Contact the Revenue Bureau for rules and an Amusement Location Permit application form now.** Permits are non-transferable from one owner to another and must be paid before games are placed on the premises. Contact Anne Holm at 503-865-2488. The City of Portland will notify affected nearby neighbors and a copy of this form will be included in our mailing.

Use this area to provide any additional information that you wish to be considered on this liquor application

A false answer or omission of any requested information may result in an unfavorable City recommendation.

SIGNATURE: [Signature] DATE: 10-3-17

Property Search

Owner Nan 2125 ARIZONA LP
 S#Address 111 NE 6TH AVE
 State ID IN1E35CB 4301
 Account # R645281

Search Clear PortlandMaps
 Geocode Address When Taxlot Not
 Search is Based on Active Field Only
 Hide Personal Property Accounts
 Display Taxlot Detail Window

Owner Site Address State
 2125 ARIZONA 111 NE 6TH IN1E

SITE ZONED EX -
 CENTRAL EMPLOYMENT
 WHOLESALE SALES
 IS A USE ALLOWED
 BY RIGHT.

1 copy by Rivette
 CITY PLANNER
 503.823.7919
 10/3/17

City of Portland
 Bureau of Development Services
 Land Use Service Division
 1900 SW 4th Ave. Suite 5000
 Portland, OR 97201

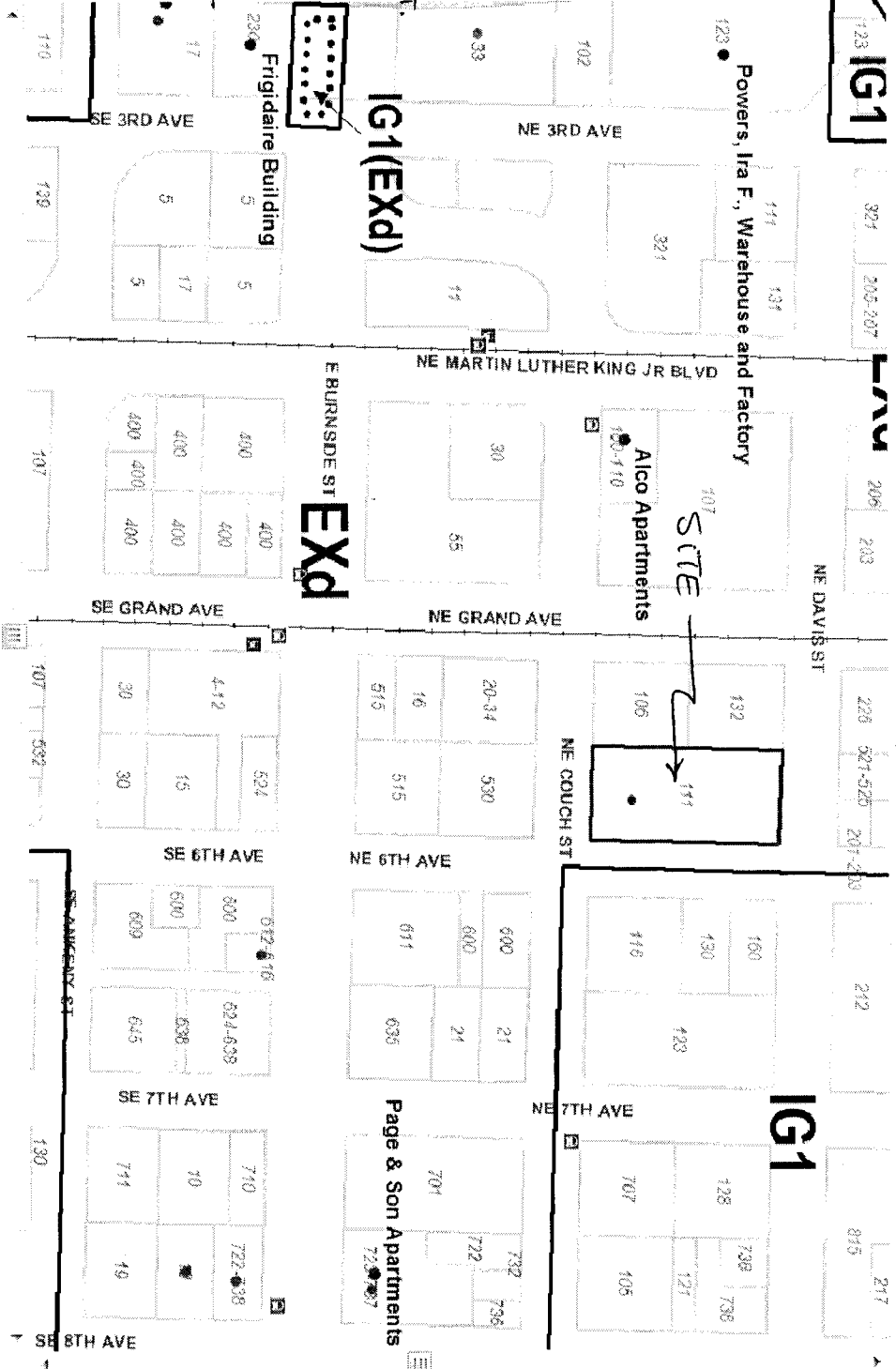

Taxlot Details
 Lot Size: 20001 sqft
 Building Size: 61327 sqft
 Map Number: 3031
 Zoning Code(s): Exd
 Legal Description: PARTITION PLAT 2011-46, LOT 1
 Lot & Block: 1

Map Information:
 2125 ARIZONA LP
 528 ARIZONA AVE #316
 Jurisdiction: Portland

1/4 Section Tax Map Zoning Map
 Plan District: CENTRAL CITY
 Subdistrict: CENTRAL EASTSIDE
 LUR Case Hist (11 Cases)
 EA 09-100900
 EA 09-107291
 EA 10-192612 DAR
 LU 05-168266
 NRMPP: Draw LURS LUR