

PR



OREGON LIQUOR CONTROL COMMISSION

LIQUOR LICENSE APPLICATION

LICENSE FEE: Do not include the license fee with the application (the license fee will be collected at a later time).

APPLICATION: Application is being made for:

- Brewery
- Brewery-Public House
- Distillery
- Full On-Premises, Commercial
- Full On-Premises, Caterer
- Full On-Premises, Passenger Carrier
- Full On-Premises, Other Public Location
- Full On-Premises, Nonprofit Private Club
- Full On-Premises, For-Profit Private Club
- Grower Sales Privilege
- Limited On-Premises
- Off-Premises
- Off-Premises with Fuel Pumps
- Warehouse
- Wholesale Malt Beverage & Wine (WMBW)
- Winery

CITY AND COUNTY USE ONLY

Date application received _____

Name of City or County _____

Recommends this license be ___ Granted ___ Denied

By _____

Date _____

OLCC USE

Application received by *[Signature]*

Date 10-11-17

License Action:

n/o

1. LEGAL ENTITY (example: corporation or LLC) or INDIVIDUAL(S) applying for the license:

Applicant #1 FAT Hospitality Group 2, LLC	Applicant #2	Rec'd by Portland Liquor Licenses
Applicant #3	Applicant #4	OCT 20 2017

*PDJW \$5000 \$500 cash
#CC054704*

2. Trade Name of the Business (the name customers will see):
Sweet Jam

3. Business Location: Number and Street **5237 NE Martin Luther King Jr BLVD**

City **Portland** County **Mult** ZIP **97211**

4. Is the business at this location currently licensed by the OLCC? Yes No

5. Mailing Address (where the OLCC will send your mail):

PO Box, Number, Street, Rural Route **5237 NE Martin Luther King Jr BLVD**
City **Portland** State **OR** ZIP **97211**

6. Phone Number of the Business Location: **(503) 477-8341**

7. Contact Person for this Application:

Name **Frank Taylor** Phone Number **(503) 807-6864**

Mailing Address, City, State, ZIP
5237 NE Martin Luther King Jr BLVD, Portland, OR, 97211

Email **FrankTPortlandSweetJam@gmail.com**

I understand that marijuana (such as use, consumption, ingestion, inhalation, samples, give-away, sale, etc.) is prohibited on the licensed premises.

Signature of Applicant #1
[Signature] 9/20/17

Signature of Applicant #2

Signature of Applicant #3

Signature of Applicant #4

OLCC Liquor License Application (Rev. 12/10)

RECEIVED

OCT 04 2017



OREGON LIQUOR CONTROL COMMISSION BUSINESS INFORMATION

Please Print or Type

Applicant Name: FAT Hospitality Group 2, LLC Phone: 503-477-8341

Trade Name (dba): Sweet Jam

Business Location Address: 5237 NE Martin Luther King Jr Blvd

City: Portland, OR ZIP Code: 97221

DAYS AND HOURS OF OPERATION

Business Hours:

Sunday 8am to 4pm
 Monday 7am to 10pm
 Tuesday 7am to 10pm
 Wednesday 7am to 10pm
 Thursday 7am to 10pm
 Friday 7am to 10pm
 Saturday 5am to 10pm

Outdoor Area Hours:

Sunday — to —
 Monday — to —
 Tuesday — to —
 Wednesday — to —
 Thursday — to —
 Friday — to —
 Saturday — to —

The outdoor area is used for:

- Food service Hours: — to —
 Alcohol service Hours: — to —
 Enclosed, how —

The exterior area is adequately viewed and/or supervised by Service Permittees.

(Investigator's Initials)

Seasonal Variations: Yes No If yes, explain: _____

ENTERTAINMENT

Check all that apply:

- Live Music Karaoke
 Recorded Music Coin-operated Games
 DJ Music Video Lottery Machines
 Dancing Social Gaming
 Nude Entertainers Pool Tables
 Other: _____

DAYS & HOURS OF LIVE OR DJ MUSIC

Sunday 11am to 3pm
 Monday — to —
 Tuesday — to —
 Wednesday — to —
 Thursday — to —
 Friday — to —
 Saturday 11am to 3pm

SEATING COUNT

Restaurant: 90 Outdoor: _____
 Lounge: _____ Other (explain): _____
 Banquet: _____ Total Seating: 90

OLCC USE ONLY

Investigator Verified Seating: ____ (Y) ____ (N)

Investigator Initials: _____

Date: _____

I understand if my answers are not true and complete, the OLCC may deny my license application.

Applicant Signature: [Signature] Date: 9/22/17

1-800-452-OLCC (6522)

www.oregon.gov/olcc

(rev. 12/07)

OREGON LIQUOR CONTROL COMMISSION
LIMITED LIABILITY COMPANY QUESTIONNAIRE



1352771-92

Please Print or Type

LLC Name: FAT Hospitality Group 2, LLC Year Filed: 2017 ✓

Trade Name (dba): Sweet Jam

Business Location Address: 5237 Multa Lotberling Jr. Blvd

City: Portland, OR ZIP Code: 97211

List Members of LLC:

Percentage of Membership Interest:

- | | |
|--|-------------|
| 1. <u>Frank A. Taylor</u>
(managing member) | <u>75 %</u> |
| 2. <u>Angela Green</u>
(members) | <u>25 %</u> |
| 3. _____ | _____ |
| 4. _____ | _____ |
| 5. _____ | _____ |
| 6. _____ | _____ |

(Note: If any LLC member is another legal entity, that entity must also complete an LLC, Limited Partnership or Corporation Questionnaire. If the LLC has officers, please list them on a separate sheet of paper with their titles.)

Server Education Designee: [Signature] DOB: 6-4-1965

I understand that if my answers are not true and complete, the OLCC may deny my license application.

Signature: [Signature] (name) owner/managing member (title) Date: 9/20/17

CITY OF PORTLAND LIQUOR OUTLET INFORMATION FORM

PLEASE SUBMIT TO: Liquor Licensing Notification Program, 1221 SW 4th Avenue, Suite #110, Portland OR 97204

On New Outlet applications, property owners within 300 feet of the location, the Portland Police Bureau and all interested parties are notified by mail (with a copy of this form) and given an opportunity to comment on your application. The OLCC allows the City at least 45 days to complete the recommendation process. Submission of a complete operating plan can expedite the time required to process. A City liquor endorsement is not a confirmation that the property is properly zoned. Call (503) - 823-7526 to confirm that the property is properly zoned.

On submission of this form, you must also include the following:

- OLCC Liquor Application Form, initialed by your OLCC License Investigator
- OLCC Individual History Forms (all persons anticipated to have a financial interest, or key personnel are required)
- City Endorsement Fees

City Endorsement Fees are payable at the beginning of the application process (please make checks payable to City of Portland): New outlets are \$100.00, all others are \$75.00. All blank sections must be filled in. If the question does not apply, write "N/A" in the space.

LEGAL NAME OF BUSINESS: FAT Hospitalite Group 2

DBA OR TRADE NAME: Sweet Jam PHONE: 503-477-8341 FAX: _____

BUSINESS ADDRESS (Including ZIP Code): 5237 NE MLK Jr Blvd Portland OR 97211

WHAT TYPE OF LIQUOR ARE YOU APPLYING FOR? (Change of owner, new outlet, beer & wine, etc.): _____

CONTACT PERSON: Frank Tat PHONE: 503-807-6864 EMAIL: FrankTat@SweetJam.com

DESCRIPTION OF OUTLET

TYPE OF OPERATION (CHECK ALL THAT APPLY)

<input type="checkbox"/> Food Cart	<input type="checkbox"/> Night Club	SIZE OF SERVICE AREA: _____
<input checked="" type="checkbox"/> Restaurant	<input type="checkbox"/> Sports Bar	EXISTING BUILDING: <input type="checkbox"/> Yes <input type="checkbox"/> No
<input type="checkbox"/> Convenience Store	<input type="checkbox"/> Other: _____	ZONING: _____
STRUCTURAL CHANGES (DESCRIBE): _____		

RESTAURANT SEATING CAPACITY: _____ LOUNGE SEATING CAPACITY: _____ OUTSIDE SEATING CAPACITY: _____

DESCRIBE SECURITY: _____

HAS AN APPLICATION FOR A LIQUOR LICENSE AT THIS LOCATION BEEN RECEIVED BY THE CITY OF PORTLAND IN THE LAST TWO (2) YEARS?
 Yes No I Don't Know

HOURS OF OPERATION

SUNDAY - THURSDAY OPEN: 8am CLOSE: 10pm FRIDAY & SATURDAY OPEN: _____ CLOSE: _____

HOW LATE WILL THERE BE OUTSIDE SEATING? 10pm HOW LATE WILL THERE BE ENTERTAINMENT? _____

HISTORY OF LOCATION

PREVIOUS BUSINESS NAME OF THIS LOCATION: _____

NAME & ADDRESS OF PROPERTY OWNER: _____

ENTERTAINMENT

TYPE OF ENTERTAINMENT (CHECK ALL THAT APPLY)

<input type="checkbox"/> Dancing	<input type="checkbox"/> Video Poker	<input type="checkbox"/> Live Music	<input type="checkbox"/> Nude Dancers
<input type="checkbox"/> Karaoke	<input type="checkbox"/> Video Games/Pinball	<input type="checkbox"/> Recorded Music	<input type="checkbox"/> DJ Entertainment
<input type="checkbox"/> Pool Tables (How Many): _____	<input type="checkbox"/> Events (Describe): _____	<input type="checkbox"/> Other: _____	

The City requires an Amusement Location Permit for all locations with amusement devices or pool tables. Contact the Revenue Bureau for rules and an Amusement Location Permit application form now. Permits are non-transferable from one owner to another and must be paid before games are placed on the premises. Contact Anne Holm at 503-865-2488. The City of Portland will notify affected nearby neighbors and a copy of this form will be included in our mailing.

Use this area to provide any additional information that you wish to be considered on this liquor application

A false answer or omission of any requested information may result in an unfavorable City recommendation.

SIGNATURE: [Signature] DATE: 10/17/12

Owner: Narr 5225 COMPANY LLC
 Site Address: 5237 NE M L KING BLVD, L
 State ID: 1N1E22AA-80004
 Account #: R610992

Search Clear Portland Maps

Geocode Address When Taxlot Not
 Search is Based on Active Field Only
 Hide Personal Property Accounts
 Display Taxlot Detail Window

Navigate Query Re: [Left Arrow] [Right Arrow]

Owner	Site Address	State
5225 COMP	5237 NE M L KING	1N1E
5TH QUADR...	5229 NE M L...	1N1E
H & J LLC	5213 NE M L...	1N1E
KAISER VAN...	5229 NE M L...	1N1E
MARCO PRO...	5261 NE M L...	1N1E
MARCO PRO...	5265 NE M L...	1N1E
POINT WES...	5257 NE M L...	1N1E
RANETTIES ...	5233 NE M L...	1N1E
RLBZJ LLC	5257 NE M L...	1N1E
TESOROS IN...	5257 NE M L...	1N1E
THUNDEREG...	5231 NE M L...	1N1E
VANPORT B...	5257 NE M L...	1N1E
VANPORT H...	5201 NE M L...	1N1E
VANPORT S...	5225 NE M L...	1N1E
VANPORT S...	5225 NE M L...	1N1E
VIETTRAN V...	5263 NE M L...	1N1E
VSS PROPE...	5229 NE M L...	1N1E
YOUSUFS E...	5237 NE M L...	1N1E

Exdh zone allows for Retail Sales and Service Uses.

City of Portland
 Bureau of Development Services
 Land Use Services Division

1900 SW 4th Ave, Suite 5000

Portland, OR 97201

*J Malia Slysarenko, City Planner
 J Malia Slysarenko*

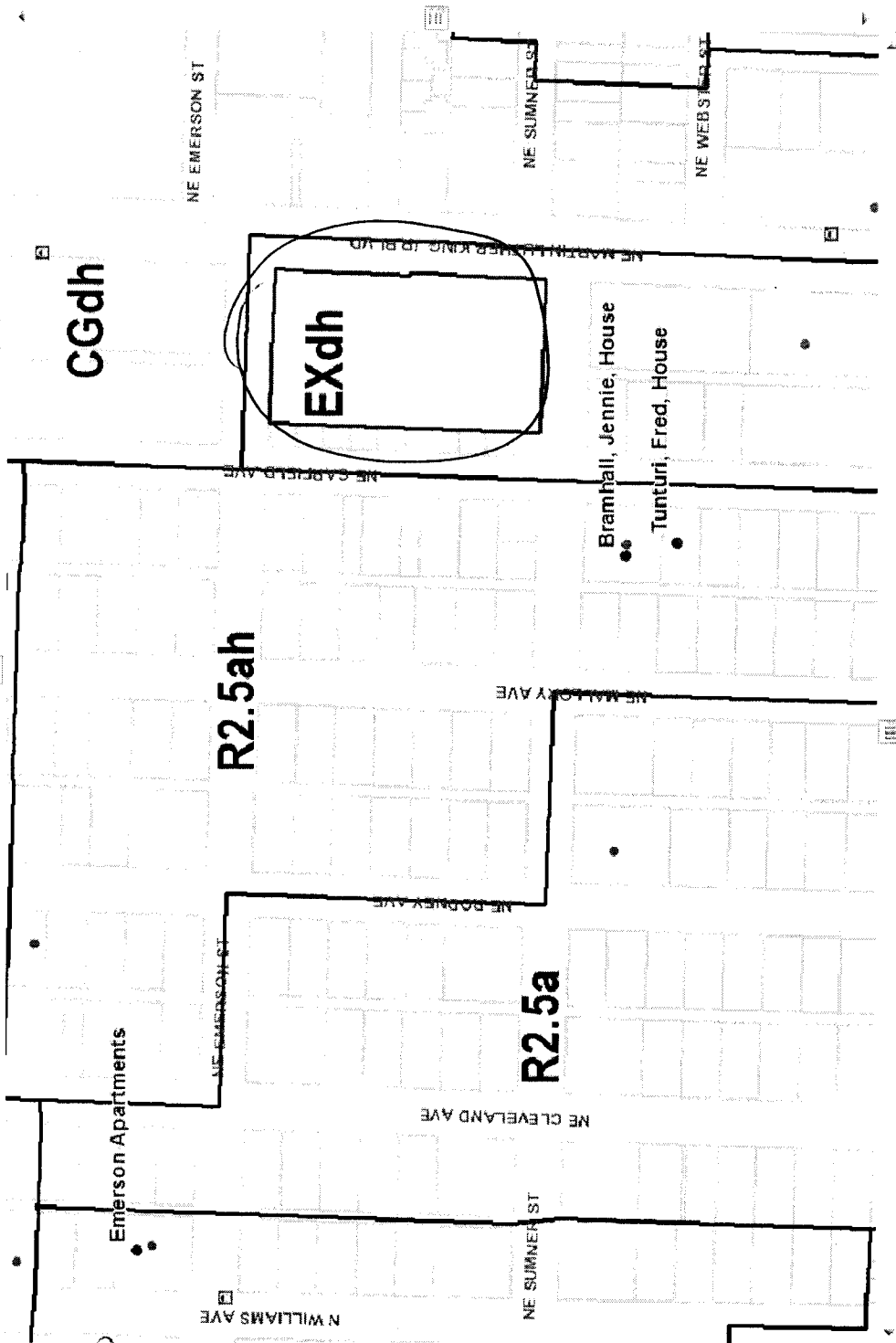

Taxlot Details

Lot Size: Building Size: 3280 sqft
 Map Number: 2530
 Zoning Code(s): Exdh

Legal Description: VANPORT SQUARE CONDOMINIUMS, LOT 3
 Lot & Block: 3
 Historic District:

Conservation District:
 Jurisdiction: Portland

LUR Case History (11 Cases)
 150771 CP
 152268 CP
 EA 07-156880
 FP 05-181774

SubArea: LUR
 Draw LURS