



OREGON LIQUOR CONTROL COMMISSION
LIQUOR LICENSE APPLICATION

DM

Application is being made for: LICENSE TYPES ACTIONS CITY AND COUNTY USE ONLY
[ ] Full On-Premises Sales (\$402.60/yr)
[ ] Commercial Establishment
[ ] Caterer
[ ] Passenger Carrier
[ ] Other Public Location
[ ] Private Club
[ ] Limited On-Premises Sales (\$202.60/yr)
[ ] Off-Premises Sales (\$100/yr)
[ ] with Fuel Pumps
[ ] Brewery Public House (\$252.60)
[ ] Winery (\$250/yr)
[ ] Other:
[ ] Change Ownership
[ ] New Outlet
[ ] Greater Privilege
[ ] Additional Privilege
[ ] Other
Date application received:
The City Council or County Commission:
recommends that this license be:
[ ] Granted [ ] Denied
By: (signature) (date)
Name:
Title:
OLCC USE ONLY
Application Rec'd by:
Date: 9-5-17
90-day authority: [ ] Yes [ ] No

Rec'd by Portland Liquor Licenses
OCT 31 2017
PD \$1000
# 514

1. Entity or Individuals applying for the license: [See SECTION 1 of the Guide]
1. Rocking Frog, INC.
2. Trade Name (dba): Rocking Frog Cafe
3. Business Location: 2511 SE Belmont St. Portland, Multnomah OR 97214
4. Business Mailing Address: 2511 SE Belmont St. Portland OR 97214
5. Business Numbers: (503) 230-8914
6. Is the business at this location currently licensed by OLCC? [ ] Yes [X] No
7. If yes to whom: Type of License:
8. Former Business Name:
9. Will you have a manager? [ ] Yes [X] No Name:
10. What is the local governing body where your business is located? Multnomah Portland
11. Contact person for this application: Kenneth Louis Pico (415) 671-5343
1834 NE Prescott St. PDX 97211 rockingfrogpdx@gmail.com

I understand that if my answers are not true and complete, the OLCC may deny my license application.
Applicant(s) Signature(s) and Date:
1. [Signature] Date 8/8/17
2. [Signature] Date
Initials:
Oregon Liquor Control Commission

RECEIVED
AUG 25 2017



# OREGON LIQUOR CONTROL COMMISSION BUSINESS INFORMATION

Please Print or Type

Applicant Name: Rocking Frog, INC. Phone: 503-230-8914

Trade Name (dba): Rocking Frog Cafe

Business Location Address: 2511 SE Belmont St

City: Portland ZIP Code: 97214

## DAYS AND HOURS OF OPERATION

### Business Hours:

Sunday	<u>8A</u> to <u>6P</u>
Monday	<u>7A</u> to <u>6P</u>
Tuesday	<u>7A</u> to <u>6P</u>
Wednesday	<u>7A</u> to <u>6P</u>
Thursday	<u>7A</u> to <u>6P</u>
Friday	<u>7A</u> to <u>6P</u>
Saturday	<u>8A</u> to <u>6P</u>

### Outdoor Area Hours:

Sunday	<u>8A</u> to <u>6P</u>
Monday	<u>7A</u> to <u>6P</u>
Tuesday	<u>7A</u> to <u>6P</u>
Wednesday	<u>7A</u> to <u>6P</u>
Thursday	<u>7A</u> to <u>6P</u>
Friday	<u>7A</u> to <u>6P</u>
Saturday	<u>8A</u> to <u>6P</u>

The outdoor area is used for:

- Food service Hours: open to close
- Alcohol service Hours: open to close
- Enclosed, how \_\_\_\_\_

The exterior area is adequately viewed and/or supervised by Service Permittees.

\_\_\_\_\_  
(Investigator's Initials)

Seasonal Variations:  Yes  No If yes, explain: \_\_\_\_\_

## ENTERTAINMENT

Check all that apply:

- |  |   |
|--|---|
| <input type="checkbox"/> Live Music        | <input type="checkbox"/> Karaoke                |
| <input type="checkbox"/> Recorded Music    | <input type="checkbox"/> Coin-operated Games    |
| <input type="checkbox"/> DJ Music          | <input type="checkbox"/> Video Lottery Machines |
| <input type="checkbox"/> Dancing           | <input type="checkbox"/> Social Gaming          |
| <input type="checkbox"/> Nude Entertainers | <input type="checkbox"/> Pool Tables            |
|  | <input type="checkbox"/> Other: _____           |

## DAYS & HOURS OF LIVE OR DJ MUSIC

Sunday	_____ to _____
Monday	_____ to _____
Tuesday	_____ to _____
Wednesday	_____ to _____
Thursday	_____ to _____
Friday	_____ to _____
Saturday	_____ to _____

## SEATING COUNT

Restaurant: 23 Outdoor: 40  
 Lounge: \_\_\_\_\_ Other (explain): \_\_\_\_\_  
 Banquet: \_\_\_\_\_ Total Seating: 73

OLCC USE ONLY	
Investigator Verified Seating: _____(Y) _____(N)	
Investigator Initials: _____	
Date: _____	

I understand if my answers are not true and complete, the OLCC may deny my license application.

Applicant Signature: [Signature] Date: 8/9/17

1-800-452-OLCC (6522)

www.oregon.gov/olcc

(rev. 12/07)



OREGON LIQUOR CONTROL COMMISSION  
CORPORATION QUESTIONNAIRE

506428-92

Please Print or Type

Corporation Name: Rocking Frog, INC. Year Incorporated: 2008 ✓

Trade Name (dba): Rocking Frog Cafe

Business Location Address: 2511 SE Belmont St

City: Portland ZIP Code: 97214

List Corporate Officers:

Kenneth L. Pico  
(name)

owner  
(title)

List Board of Directors:

Kenneth L. Pico  
(name)

List Stockholders: (Note: If any stockholder is another legal entity, that entity may also need to complete another Corporation Questionnaire. See Liquor License Application Guide for more information.)

Stockholders:	Number of Shares Held:	Number of Stock Shares:
_____	_____	Issued: _____
_____	_____	Unissued: _____
_____	_____	Total Shares Authorized to Issue: _____
_____	_____	

Server Education Designee: Kenneth L. Pico DOB: 02/28/1990  
(See Liquor License Application Guide for more information)

I understand that if my answers are not true and complete, the OLCC may deny my license application.

Officer's Signature: Kenneth L. Pico owner Date: 8/9/17  
(name) (title)

# CITY OF PORTLAND LIQUOR OUTLET INFORMATION FORM

PLEASE SUBMIT TO: Liquor Licensing Notification Program, 1221 SW 4<sup>th</sup> Avenue, Suite #110, Portland OR 97204

On New Outlet applications, property owners within 300 feet of the location, the Portland Police Bureau and all interested parties are notified by mail (with a copy of this form) and given an opportunity to comment on your application. The OLCC allows the City at least 45 days to complete the recommendation process. Submission of a complete operating plan can expedite the time required to process. A City liquor endorsement is not a confirmation that the property is properly zoned. Call (503) - 823-7526 to confirm that the property is properly zoned.

**On submission of this form, you must also include the following:**

- OLCC Liquor Application Form, initialed by your OLCC License Investigator
- OLCC Individual History Forms (all persons anticipated to have a financial interest, or key personnel are required)
- City Endorsement Fees

City Endorsement Fees are payable at the beginning of the application process (please make checks payable to City of Portland): New outlets are \$100.00, all others are \$75.00. All blank sections must be filled in. If the question does not apply, write "N/A" in the space.

LEGAL NAME OF BUSINESS: Rocking Frog, INC.

DBA OR TRADE NAME: Rocking Frog Cafe PHONE: (415) 671-5343 FAX: \_\_\_\_\_

BUSINESS ADDRESS (Including ZIP Code): 2511 SE Belmont St. Portland, OR 97214

WHAT TYPE OF LIQUOR ARE YOU APPLYING FOR? (Change of owner, new outlet, beer & wine, etc.): New Outlet

CONTACT PERSON: Kenneth Piro PHONE: (415) 671-5343 EMAIL: rockingfrogpdx@gmail.com

**DESCRIPTION OF OUTLET**

**TYPE OF OPERATION (CHECK ALL THAT APPLY)**

- |  |   |
|--|---|
| <input type="checkbox"/> Food Cart         | <input type="checkbox"/> Night Club                           |
| <input type="checkbox"/> Restaurant        | <input type="checkbox"/> Sports Bar                           |
| <input type="checkbox"/> Convenience Store | <input checked="" type="checkbox"/> Other: <u>coffee shop</u> |

SIZE OF SERVICE AREA: \_\_\_\_\_

EXISTING BUILDING:  Yes  No

ZONING: Commercial

STRUCTURAL CHANGES (DESCRIBE): None

RESTAURANT SEATING CAPACITY: 20 LOUNGE SEATING CAPACITY: N/A OUTSIDE SEATING CAPACITY: 40

DESCRIBE SECURITY: external cameras

HAS AN APPLICATION FOR A LIQUOR LICENSE AT THIS LOCATION BEEN RECEIVED BY THE CITY OF PORTLAND IN THE LAST TWO (2) YEARS?  
 Yes  No  I Don't Know

**HOURS OF OPERATION**

SUNDAY - THURSDAY OPEN: 8am CLOSE: 6pm FRIDAY & SATURDAY OPEN: 8am CLOSE: 6pm

HOW LATE WILL THERE BE OUTSIDE SEATING? 6pm HOW LATE WILL THERE BE ENTERTAINMENT? 6pm

**HISTORY OF LOCATION**

PREVIOUS BUSINESS NAME OF THIS LOCATION: Rocking Frog, Inc.

NAME & ADDRESS OF PROPERTY OWNER: Jennifer Adams 18109 NW Sawie Island Road Portland, OR 97231

**ENTERTAINMENT**

**TYPE OF ENTERTAINMENT (CHECK ALL THAT APPLY)**

- |  |   |  |   |
|--|---|--|---|
| <input type="checkbox"/> Dancing                       | <input type="checkbox"/> Video Poker  | <input checked="" type="checkbox"/> Live Music | <input type="checkbox"/> Nude Dancers     |
| <input type="checkbox"/> Karaoke                       | <input type="checkbox"/> Video Games/Pinball                                    | <input type="checkbox"/> Recorded Music        | <input type="checkbox"/> DJ Entertainment |
| <input type="checkbox"/> Pool Tables (How Many): _____ | <input checked="" type="checkbox"/> Events (Describe): <u>open mic / poetry</u> | <input type="checkbox"/> Other: _____          |   |

The City requires an Amusement Location Permit for all locations with amusement devices or pool tables. Contact the Revenue Bureau for rules and an Amusement Location Permit application form now. Permits are non-transferable from one owner to another and must be paid before games are placed on the premises. Contact Anne Holm at 503-865-2488. The City of Portland will notify affected nearby neighbors and a copy of this form will be included in our mailing.

Use this area to provide any additional information that you wish to be considered on this liquor application  
We are a small coffee shop applying for limited on-premises sales for small live music and poetry events.

A false answer or omission of any requested information may result in an unfavorable City recommendation.

SIGNATURE: [Signature] DATE: 09/29/17

**Property Search**

Owner Name: ADAMS, JENNIFER R  
 Site Address: 2511 SE BELMONT ST  
 State ID: 151E01BB 9300  
 Account #: R287786

Search  Clear  Portland Maps

Geocode Address When Taxlot Not  
 Search is Based on Active Field Only  
 Hide Personal Property Accounts  
 Display Taxlot Detail Window

Navigate Query Re:

Owner: ADAMS, JEN. 2511 SE BELMONT ST  
 Site Address: 2511 SE BELMONT ST

**Search Legend Add Data**

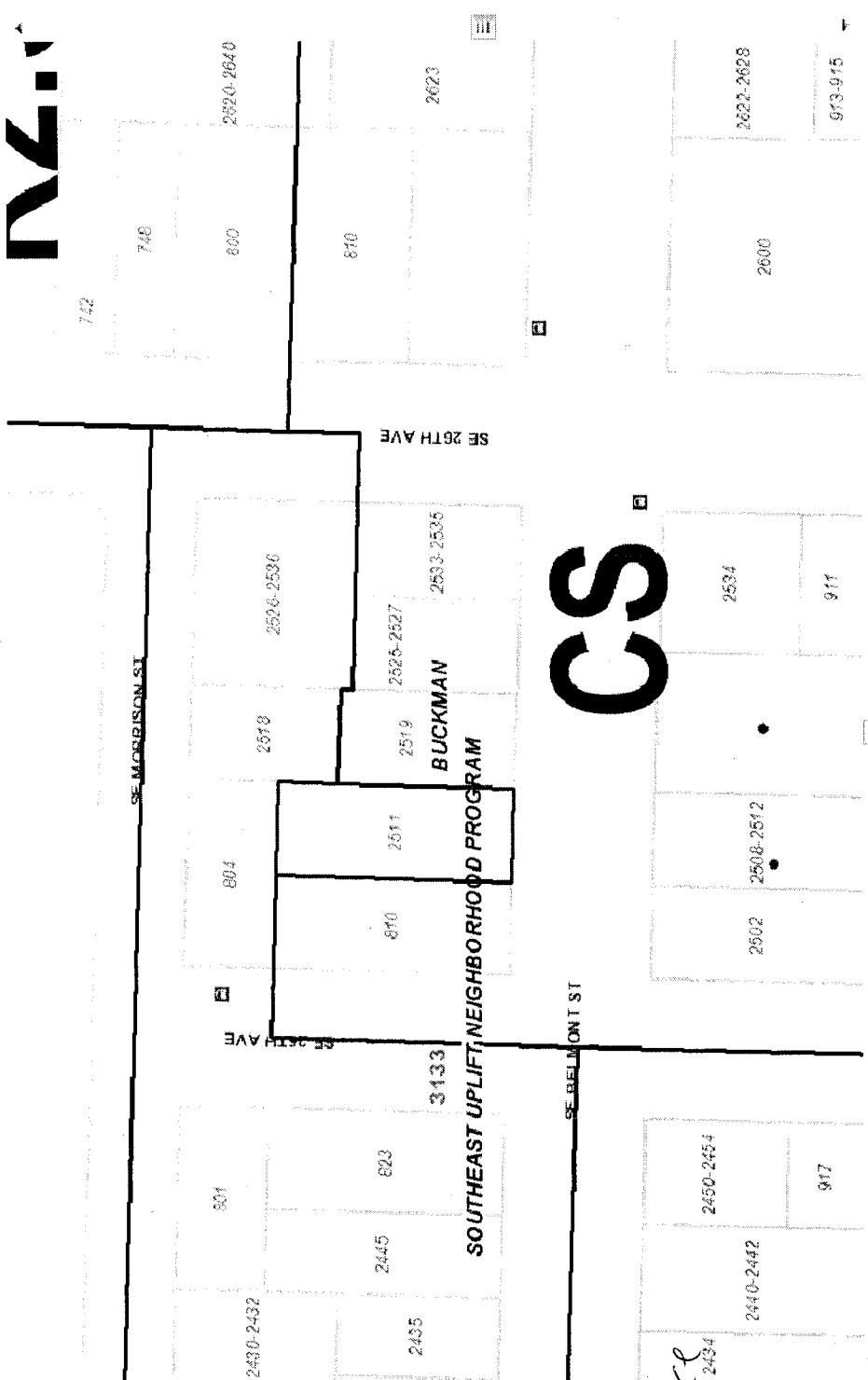

**Taxlot Details**

Lot Size: 4000 sqft Building Size: 975 sqft Map Number: 3133 Zoning Code(S): CS  
 Legal Description: TILTONS ADD, BLOCK 1, S 4 100' OF LOT 4 Lot & Block: 4  
 Historic District: Conservation District: Jurisdiction: Portland  
 Mailing Information: ADAMS, JENNIFER R 18109 NW SALVIE ISLAND RD  
 Plan District: Sub District: Sub Area: NRMP: Draw LURs LUR

Bureau of Development Services  
 Land Use Review  
 1900 SW 4th Ave, Suite 5000  
 Portland, OR 97201

*Detail Sales + Service  
 allowed by right  
 in CS zone*