



LIQUOR LICENSE APPLICATION

Dm

LICENSE FEE: Do not include the license fee with the application (the license fee will be collected at a later time).

APPLICATION: Application is being made for:

- Brewery
- Brewery-Public House
- Distillery
- Full On-Premises, Commercial
- Full On-Premises, Caterer
- Full On-Premises, Passenger Carrier
- Full On-Premises, Other Public Location
- Full On-Premises, Nonprofit Private Club
- Full On-Premises, For-Profit Private Club
- Grower Sales Privilege
- Limited On-Premises
- Off-Premises
- Off-Premises with Fuel Pumps
- Warehouse
- Wholesale Malt Beverage & Wine (WMBW)
- Winery

CITY AND COUNTY USE ONLY

Date application received _____

Name of City or County _____

Recommends this license be ___ Granted ___ Denied

By _____

Date _____

OLCC USE

Application received by *[Signature]* Rec'd by Portland
Liquor Licenses

Date 10-31-17 NOV 03 2017

License Action: n/o PD 106⁰⁰
075518

1. LEGAL ENTITY (example: corporation or LLC) or INDIVIDUAL(S) applying for the license:

Applicant #1 <i>The Peoples Pig, LLC</i>	Applicant #2
Applicant #3	Applicant #4

2. Trade Name of the Business (the name customers will see): *The Peoples Pig*

3. Business Location: Number and Street *3004 E Burnside St.*

City *Portland* County *Multnomah* ZIP *97214*

4. Is the business at this location currently licensed by the OLCC? Yes No

5. Mailing Address (where the OLCC will send your mail):

PO Box, Number, Street, Rural Route *5265 NE 23rd Ave*

City *Portland* State *OR* ZIP *97211*

6. Phone Number of the Business Location:

7. Contact Person for this Application:

Name *Cliff Allen* Phone Number *503-347-2357*

Mailing Address, City, State, ZIP *5265 NE 23rd Ave Portland OR 97211*

Email *PeoplesPig@gmail.com*

I understand that marijuana (such as use, consumption, ingestion, inhalation, samples, give-away, sale, etc.) is prohibited on the licensed premises.

Signature of Applicant #1 <i>[Signature]</i>	Signature of Applicant #2
Signature of Applicant #3	Signature of Applicant #4

RECEIVED



OREGON LIQUOR CONTROL COMMISSION
BUSINESS INFORMATION

Please Print or Type

Applicant Name: The Peoples Pro LLC Phone: 503.347.7557
Trade Name (dba): The Peoples Pro
Business Location Address: 3004 E Burnside ST.
City: Portland ZIP Code: 97214

DAYS AND HOURS OF OPERATION

Business Hours:

Sunday 11 to 9
Monday 11 to 9
Tuesday 11 to 9
Wednesday 11 to 9
Thursday 11 to 7
Friday 11 to 10
Saturday 11 to 10

Outdoor Area Hours:

Sunday _____ to _____
Monday _____ to _____
Tuesday _____ to _____
Wednesday _____ to _____
Thursday _____ to _____
Friday _____ to _____
Saturday _____ to _____

The outdoor area is used for:

- Food service Hours: _____ to _____
- Alcohol service Hours: _____ to _____
- Enclosed, how _____

The exterior area is adequately viewed and/or supervised by Service Permittees.

(Investigator's Initials)

Seasonal Variations: Yes No If yes, explain: _____

ENTERTAINMENT

Check all that apply:

- Live Music
- Recorded Music
- DJ Music
- Dancing
- Nude Entertainers
- Karaoke
- Coin-operated Games
- Video Lottery Machines
- Social Gaming
- Pool Tables
- Other: _____

DAYS & HOURS OF LIVE OR DJ MUSIC

Sunday _____ to _____
Monday _____ to _____
Tuesday _____ to _____
Wednesday _____ to _____
Thursday _____ to _____
Friday _____ to _____
Saturday _____ to _____

SEATING COUNT

Restaurant: 39 Outdoor: _____
Lounge: _____ Other (explain): _____
Banquet: _____ Total Seating: _____

OLCC USE ONLY

Investigator Verified Seating: ____ (Y) ____ (N)
Investigator Initials: _____
Date: _____

I understand if my answers are not true and complete, the OLCC may deny my license application.

Applicant Signature: [Signature] Date: 10.16.17



OREGON LIQUOR CONTROL COMMISSION
LIMITED LIABILITY COMPANY QUESTIONNAIRE

122 4734-99

Please Print or Type

LLC Name: The Peoples PTY, LLC Year Filed: 2016 ✓

Trade Name (dba): The Peoples PTY

Business Location Address: 3004 E Burnside ST

City: Portland ZIP Code: 97214

List Members of LLC:

Percentage of Membership Interest:

1. Cliff Allen
(managing member)

100%

2. _____
(members)

3. _____

4. _____

5. _____

6. _____

(Note: If any LLC member is another legal entity, that entity must also complete an LLC, Limited Partnership or Corporation Questionnaire. If the LLC has officers, please list them on a separate sheet of paper with their titles.)

Server Education Designee: Cliff Allen DOB: 9.27.1971

I understand that if my answers are not true and complete, the OLCC may deny my license application.

Signature: [Signature] owner Date: 10.16.17
(name) (title)

CITY OF PORTLAND LIQUOR OUTLET INFORMATION FORM

PLEASE SUBMIT TO: Liquor Licensing Notification Program, 1221 SW 4th Avenue, Suite #110, Portland OR 97204

On New Outlet applications, property owners within 300 feet of the location, the Portland Police Bureau and all interested parties are notified by mail (with a copy of this form) and given an opportunity to comment on your application. The OLCC allows the City at least 45 days to complete the recommendation process. Submission of a complete operating plan can expedite the time required to process. A City liquor endorsement is not a confirmation that the property is properly zoned. Call (503) - 823-7526 to confirm that the property is properly zoned.

On submission of this form, you must also include the following:

- OLCC Liquor Application Form, initialed by your OLCC License Investigator
- OLCC Individual History Forms (all persons anticipated to have a financial interest, or key personnel are required)
- City Endorsement Fees

City Endorsement Fees are payable at the beginning of the application process (please make checks payable to City of Portland): New outlets are \$100.00, all others are \$75.00. All blank sections must be filled in. If the question does not apply, write "N/A" in the space.

LEGAL NAME OF BUSINESS: The Peoples Pig LLC

DBA OR TRADE NAME: The Peoples Pig PHONE: 503-347-2357 FAX: _____

BUSINESS ADDRESS (Including ZIP Code): 3004 E. Burnside St 97214

WHAT TYPE OF LIQUOR ARE YOU APPLYING FOR? (Change of owner, new outlet, beer & wine, etc.): New outlet / full

CONTACT PERSON: Cliff Allen PHONE: 503-347-2357 EMAIL: PeoplesPig@gmail.com

DESCRIPTION OF OUTLET

TYPE OF OPERATION (CHECK ALL THAT APPLY)

- Food Cart
- Restaurant
- Convenience Store
- Night Club
- Sports Bar
- Other: _____

SIZE OF SERVICE AREA: _____

EXISTING BUILDING: Yes No

ZONING: _____

STRUCTURAL CHANGES (DESCRIBE): _____

RESTAURANT SEATING CAPACITY: 36 LOUNGE SEATING CAPACITY: - OUTSIDE SEATING CAPACITY: -

DESCRIBE SECURITY: _____

HAS AN APPLICATION FOR A LIQUOR LICENSE AT THIS LOCATION BEEN RECEIVED BY THE CITY OF PORTLAND IN THE LAST TWO (2) YEARS?
 Yes No I Don't Know

HOURS OF OPERATION

SUNDAY - THURSDAY OPEN: 11 CLOSE: 9 FRIDAY & SATURDAY OPEN: 11 CLOSE: 10

HOW LATE WILL THERE BE OUTSIDE SEATING? N.A. HOW LATE WILL THERE BE ENTERTAINMENT? N.A.

HISTORY OF LOCATION

PREVIOUS BUSINESS NAME OF THIS LOCATION: Subway

NAME & ADDRESS OF PROPERTY OWNER: Leuba R. Rich on 13700 NW Salmon Creek Ave #110 Vancouver WA 98686

ENTERTAINMENT

TYPE OF ENTERTAINMENT (CHECK ALL THAT APPLY)

- Dancing
- Karaoke
- Pool Tables (How Many): _____
- Video Poker
- Video Games/Pinball
- Events (Describe): _____
- Live Music
- Recorded Music
- Other: _____
- Nude Dancers
- DJ Entertainment

The City requires an Amusement Location Permit for all locations with amusement devices or pool tables. Contact the Revenue Bureau for rules and an Amusement Location Permit application form now. Permits are non-transferable from one owner to another and must be paid before games are placed on the premises. Contact Anne Holm at 503-865-2488. The City of Portland will notify affected nearby neighbors and a copy of this form will be included in our mailing.

Use this area to provide any additional information that you wish to be considered on this liquor application
This is a small restaurant (not a bar) that wishes to offer beer, wine and cocktails to seated customers during their meal.

A false answer or omission of any requested information may result in an unfavorable City recommendation.

SIGNATURE: _____ DATE: 11.3.17

Property Search
 Owner: **HAIR-RAUCHENSTEIN, TERESA M**
 Address: 3004 E BURNSIDE ST
 State ID: 1N1E36CD 21200
 Account #: R214651

- Search
- Clear
- Portland Maps
- Geocode Address When Taxlot Not
- Search is Based on Active Field Only
- Hide Personal Property Accounts
- Display Taxlot Detail Window

Owner: RAUCHENSTEIN, TERESA M
 Site Address: 3004 E BURN
 State: WA

*CS zone allows
 for Retail Sales
 & Service uses.
 J. Maria Susaranta
 J. Maria Susaranta
 503-823-7353*

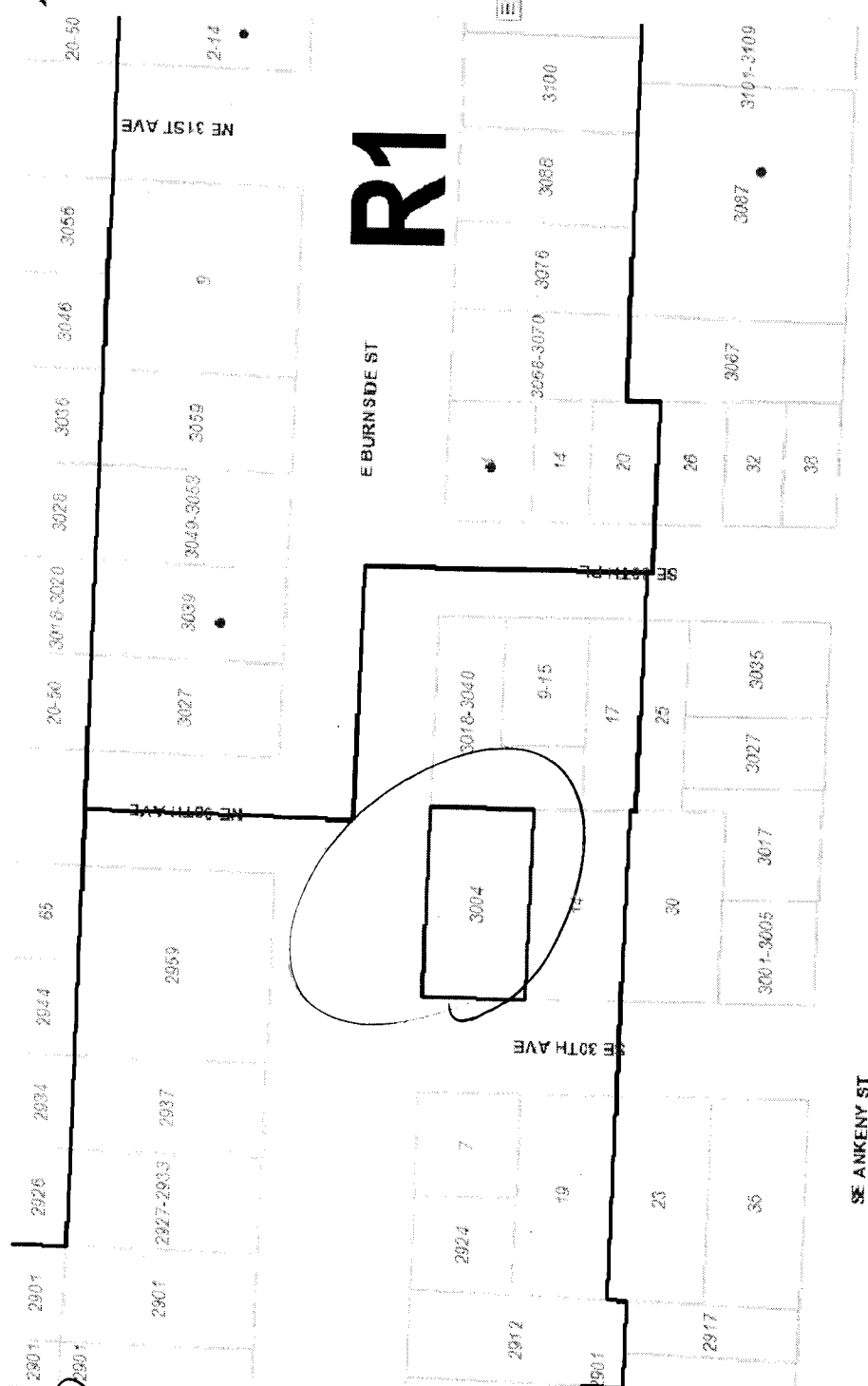

Taxlot Details

Lot Size: 5372 sqft | Building Size: 1992 sqft | Map Number: 3033 | Zoning Code(s): CS

Legal Description: MAYOR GATES ADD, BLOCK 8, LOT 4, LOT 5, LOT 6, LOT 7, LOT 8

Map Information: 1/4 Section: [] | Tax Map: [] | Zoning Map: []

Plan District: [] | LUR Case History: []

Historic District: [] | Subdistrict: []

Conservation District: [] | SubArea: []

Mailing Information: RAUCHENSTEIN, TERESA M TR | Jurisdiction: Portland

Address: 13700 NE SALMON CRK AVE #112 | NRMP: [] | Draw LURs: []

Search Legend Add Data Sel