



LIQUOR LICENSE APPLICATION

DT

LICENSE FEE: Do not include the license fee with the application (the license fee will be collected at a later time).

APPLICATION: Application is being made for:

- Brewery
- Brewery-Public House
- Distillery
- Full On-Premises, Commercial
- Full On-Premises, Caterer
- Full On-Premises, Passenger Carrier
- Full On-Premises, Other Public Location
- Full On-Premises, Nonprofit Private Club
- Full On-Premises, For-Profit Private Club
- Grower Sales Privilege
- Limited On-Premises
- Off-Premises
- Off-Premises with Fuel Pumps
- Warehouse
- Wholesale Malt Beverage & Wine (WMBW)
- Winery

CITY AND COUNTY USE ONLY

Date application received _____

Name of City or County _____

Recommends this license be ___ Granted ___ Denied

By _____

Date _____

OLCC USE

Application received by [Signature]

Date 1-30-18

License Action: 40 c/n

Rec'd by Portland Liquor Licenses
 JAN 30 2018
 PD # 75
[Signature]

1. LEGAL ENTITY (example: corporation or LLC) or INDIVIDUAL(S) applying for the license:

Applicant #1 <u>Vegas Chinese Restaurant, zmc.</u>	Applicant #2
Applicant #3	Applicant #4

2. Trade Name of the Business (the name customers will see):
Vegas Chinese Restaurant Lounge

3. Business Location: Number and Street 12424 SE DIVISION ST.
 City Portland County Multnomah ZIP 97236

4. Is the business at this location currently licensed by the OLCC? Yes No

5. Mailing Address (where the OLCC will send your mail):
 PO Box, Number, Street, Rural Route 12949 SE Raymond CT
 City Portland State Oregon ZIP 97236

6. Phone Number of the Business Location: 503-761-2200

7. Contact Person for this Application:

Name <u>Jianwei Ma</u>	Phone Number <u>503-265-9001</u>
Mailing Address, City, State, ZIP <u>12949 SE Raymond CT Portland Oregon 97236</u>	
Email <u>Andy.ma1975789@gmail.com</u>	

I understand that marijuana (such as use, consumption, ingestion, inhalation, samples, give-away, sale, etc.) is prohibited on the licensed premises.

Signature of Applicant #1 <u>Jianwei Ma</u>	Signature of Applicant #2
Signature of Applicant #3	Signature of Applicant #4



OREGON LIQUOR CONTROL COMMISSION
BUSINESS INFORMATION

Please Print or Type

Applicant Name: Vegas Chinese Restaurant INC. Phone: 503-761-2200

Trade Name (dba): Vegas Chinese Restaurant Lounge

Business Location Address: 12424 SE Division St.

City: Portland, Oregon ZIP Code: 97236

DAYS AND HOURS OF OPERATION

Business Hours:

Sunday 11:00 AM to 10 PM
Monday 11 AM to 10 PM
Tuesday 11 AM to 10 PM
Wednesday 11 AM to 10 PM
Thursday 11 AM to 10 PM
Friday 11:30 AM to 11 PM
Saturday 11:30 AM to 11 PM

Outdoor Area Hours:

Sunday to
Monday to
Tuesday to
Wednesday to
Thursday to
Friday to
Saturday to

The outdoor area is used for:

- Food service Hours: to
Alcohol service Hours: to
Enclosed, how

The exterior area is adequately viewed and/or supervised by Service Permittees.

(Investigator's Initials)

Seasonal Variations: Yes No If yes, explain:

ENTERTAINMENT

- Live Music
Recorded Music
DJ Music
Dancing
Nude Entertainers

Check all that apply:

- Karaoke
Coin-operated Games
Video Lottery Machines
Social Gaming
Pool Tables
Other: TV For Sports

DAYS & HOURS OF LIVE OR DJ MUSIC

Sunday to
Monday to
Tuesday to
Wednesday to
Thursday to
Friday to
Saturday to

SEATING COUNT

Restaurant: 2 Outdoor:
Lounge: 2 Other (explain):
Banquet: Total Seating: 89

OLCC USE ONLY
Investigator Verified Seating: (Y) (N)
Investigator Initials:
Date:

I understand if my answers are not true and complete, the OLCC may deny my license application.

Applicant Signature: Joan Verma Pres Date: 1/10/2018



OREGON LIQUOR CONTROL COMMISSION CORPORATION QUESTIONNAIRE

1384809-91

Please Print or Type

Corporation Name: Vegas Chinese Restaurant, INC Year Incorporated: 2017 ✓

Trade Name (dba): Vegas Chinese Restaurant Lounge

Business Location Address: 12424 SE Division St.

City: Portland OR ZIP Code: 97236

List Corporate Officers:

(name) Jianwei ma (title) President

List Board of Directors:

(name) Jianwei ma President

List Stockholders: (Note: If any stockholder is another legal entity, that entity may also need to complete another Corporation Questionnaire. See Liquor License Application Guide for more information.)

Stockholders:	Number of Shares Held:
<u>Jianwei ma</u>	<u>100</u>
_____	_____
_____	_____
_____	_____

Number of Stock Shares:	
Issued:	<u>100</u>
Unissued:	_____
Total Shares Authorized to Issue:	<u>100</u>

Server Education Designee: Jianwei ma DOB: 11/13/1975
(See Liquor License Application Guide for more information)

I understand that if my answers are not true and complete, the OLCC may deny my license application.

Officer's Signature: Jianwei ma President Date: 11/10/2018
(name) (title)

CITY OF PORTLAND LIQUOR OUTLET INFORMATION FORM

PLEASE SUBMIT TO: Liquor Licensing Notification Program, 1221 SW 4th Avenue, Suite #110, Portland OR 97204

On New Outlet applications, property owners within 300 feet of the location, the Portland Police Bureau and all interested parties are notified by mail (with a copy of this form) and given an opportunity to comment on your application. The OLCC allows the City at least 45 days to complete the recommendation process. Submission of a complete operating plan can expedite the time required to process. A City liquor endorsement is not a confirmation that the property is properly zoned. Call (503) - 823-7526 to confirm that the property is properly zoned.

On submission of this form, you must also include the following:

- OLCC Liquor Application Form, initialed by your OLCC License Investigator
- OLCC Individual History Forms (all persons anticipated to have a financial interest, or key personnel are required)
- City Endorsement Fees

City Endorsement Fees are payable at the beginning of the application process (please make checks payable to City of Portland): New outlets are \$100.00, all others are \$75.00. All blank sections must be filled in. If the question does not apply, write "N/A" in the space.

LEGAL NAME OF BUSINESS: vegas Chinese Restaurant, ZNC

DBA OR TRADE NAME: vegas Chinese Restaurant Lounge PHONE: 503-761-2200 FAX: _____

BUSINESS ADDRESS (Including ZIP Code): 12424 SE Division St

WHAT TYPE OF LIQUOR ARE YOU APPLYING FOR? (Change of owner, new outlet, beer & wine, etc.): Full on - Premises

CONTACT PERSON: Juanwei Ma PHONE: 503-265-9001 EMAIL: Andy.ma1975789@gmail.com

DESCRIPTION OF OUTLET

TYPE OF OPERATION (CHECK ALL THAT APPLY)

- | | |
|--|---------------------------------------|
| <input type="checkbox"/> Food Cart | <input type="checkbox"/> Night Club |
| <input checked="" type="checkbox"/> Restaurant | <input type="checkbox"/> Sports Bar |
| <input type="checkbox"/> Convenience Store | <input type="checkbox"/> Other: _____ |

SIZE OF SERVICE AREA: _____

EXISTING BUILDING: Yes No

ZONING: _____

STRUCTURAL CHANGES (DESCRIBE): _____

RESTAURANT SEATING CAPACITY: 60 LOUNGE SEATING CAPACITY: 39 OUTSIDE SEATING CAPACITY: _____

DESCRIBE SECURITY: ADT

HAS AN APPLICATION FOR A LIQUOR LICENSE AT THIS LOCATION BEEN RECEIVED BY THE CITY OF PORTLAND IN THE LAST TWO (2) YEARS?
 Yes No I Don't Know

HOURS OF OPERATION

SUNDAY - THURSDAY OPEN: 11am CLOSE: 10pm FRIDAY & SATURDAY OPEN: 11:30am CLOSE: 11pm

HOW LATE WILL THERE BE OUTSIDE SEATING? _____ HOW LATE WILL THERE BE ENTERTAINMENT? 1pm-2pm

HISTORY OF LOCATION

PREVIOUS BUSINESS NAME OF THIS LOCATION: East Garden Restaurant + Lounge

NAME & ADDRESS OF PROPERTY OWNER: Wai Yun Wong 2023 SE 117th ave Portland Oregon 97216

ENTERTAINMENT

TYPE OF ENTERTAINMENT (CHECK ALL THAT APPLY)

- | | | | |
|--|---|---|---|
| <input type="checkbox"/> Dancing | <input checked="" type="checkbox"/> Video Poker | <input type="checkbox"/> Live Music | <input type="checkbox"/> Nude Dancers |
| <input checked="" type="checkbox"/> Karaoke | <input type="checkbox"/> Video Games/Pinball | <input type="checkbox"/> Recorded Music | <input type="checkbox"/> DJ Entertainment |
| <input checked="" type="checkbox"/> Pool Tables (How Many): <u>2</u> | <input type="checkbox"/> Events (Describe): _____ | <input type="checkbox"/> Other: _____ | |

The City requires an Amusement Location Permit for all locations with amusement devices or pool tables. Contact the Revenue Bureau for rules and an Amusement Location Permit application form now. Permits are non-transferable from one owner to another and must be paid before games are placed on the premises. Contact Anne Holm at 503-865-2488. The City of Portland will notify affected nearby neighbors and a copy of this form will be included in our mailing.

Use this area to provide any additional information that you wish to be considered on this liquor application

A false answer or omission of any requested information may result in an unfavorable City recommendation.

SIGNATURE: Juanwei Ma DATE: 1/30/2018

Property Search 2411

Owner Name JBZ LLC
 Site Address 12424 SE DIVISION ST
 State ID 1S2E11B8 6100
 Account # R334057

Search Clear PortlandMaps

- Geocode Address When Taxlot Not Found
- Search is Based on Active Field Only
- Hide Personal Property Accounts
- Display Taxlot Detail Window

Navigate Query Results

Owner Site Address State
 JBZ LLC 12424 SE DIVISION ST 1S2E11B8 6100

Zoning: CG - General Commercial

RETAIL SALES AND SERVICE IS ALLOWED BY RIGHT.

Jayko Smith
 CITY PLANNER
 303.823.7919
 1/30/18

Bureau of Development Services
 Land Use Review
 1900 SW 4th Ave, Suite 5000
 Portland, OR 97201

Search Legend Add Data Selection

1" = 167'
 Scale:
 [Navigation icons]

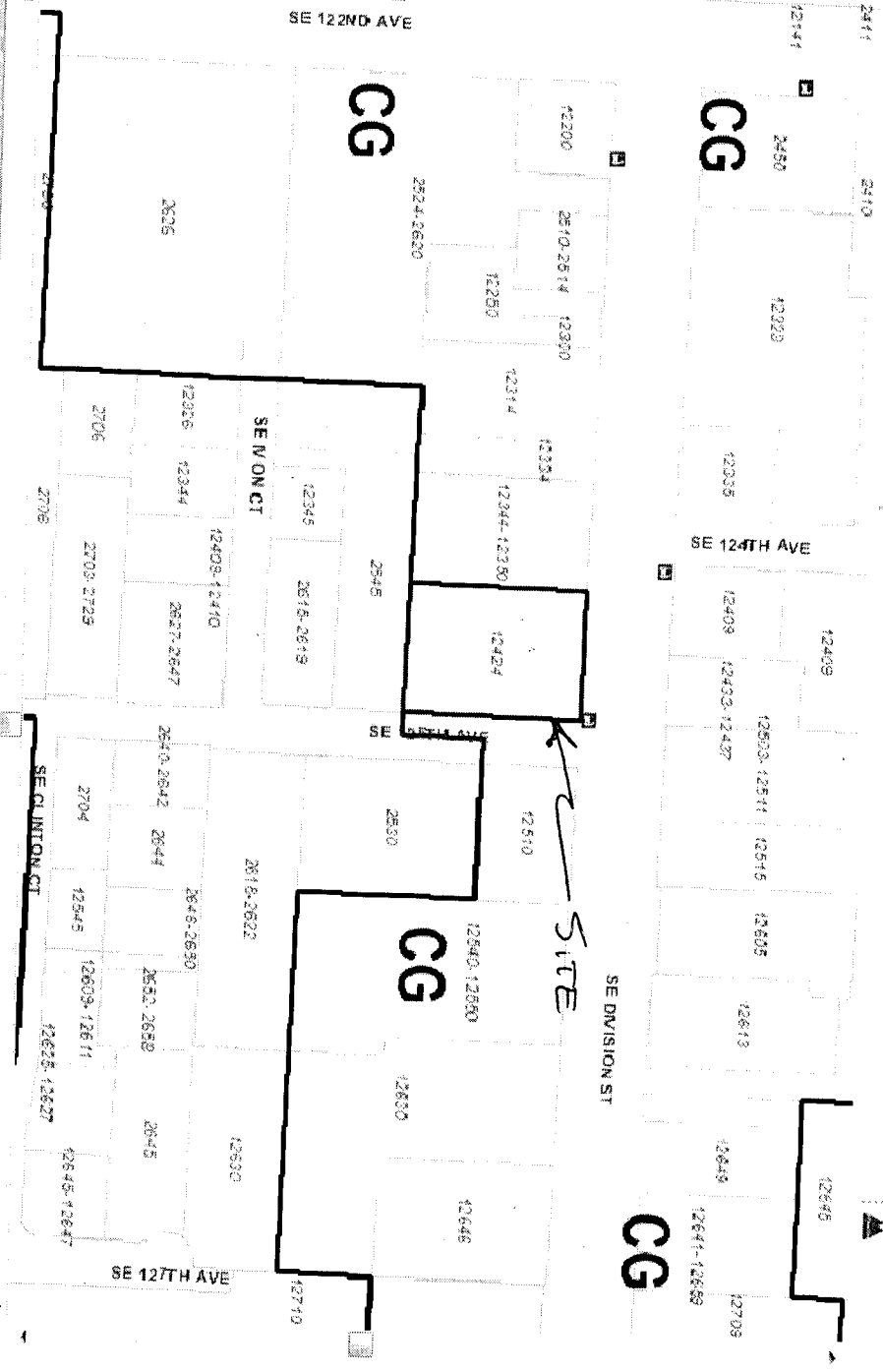

Taxlot Details

Lot Size: 24829 sqft
 Building Size: 4581 sqft
 Map Number: 3343
 Legal Description: SECTION 11 1S 2E, TL 6100 0.57 ACRES
 Lot & Block: TL 6100
 Mailing Information: JBZ LLC, 13839 SE SIERRA DR, CLACKAMAS, OR 97015-7532

Building Size: 4581 sqft
 Map Number: 3343
 Zoning Code(s): CG

Plan District: JOHNSON CREEK BASIN
 Subdistrict:
 Subarea:
 Jurisdiction: Portland
 NRMP:

1/4 Section Map Tax Map Zoning Map

LUR Case History:
 Draw LURS
 LUR Search