



LIQUOR LICENSE APPLICATION

DM

LICENSE FEE: Do not include the license fee with the application (the license fee will be collected at a later time).

APPLICATION: Application is being made for:

- Brewery
- Brewery-Public House
- Distillery
- Full On-Premises, Commercial
- Full On-Premises, Caterer
- Full On-Premises, Passenger Carrier
- Full On-Premises, Other Public Location
- Full On-Premises, Nonprofit Private Club
- Full On-Premises, For-Profit Private Club
- Grower Sales Privilege
- Limited On-Premises
- Off-Premises
- Off-Premises with Fuel Pumps
- Warehouse
- Wholesale Malt Beverage & Wine (WMBW)
- Winery

CITY AND COUNTY USE ONLY

Date application received _____

Name of City or County _____

Recommends this license be ___ Granted ___ Denied

By _____

Date _____

OLCC USE

Application received by *[Signature]*

Date 1-9-18

License Action: n/o

Rec'd by Portland
Liquor Licenses

JAN 30 2018

PD 100 00
005932

1. LEGAL ENTITY (example: corporation or LLC) or INDIVIDUAL(S) applying for the license:

Applicant #1

McCubs LLC

Applicant #2

Applicant #3

Applicant #4

2. Trade Name of the Business (the name customers will see):
Sammich

3. Business Location: Number and Street **2137 East Burnside Street** *Ste D*

City **Portland**

County **Multnomah**

ZIP **97214**

4. Is the business at this location currently licensed by the OLCC? Yes No

5. Mailing Address (where the OLCC will send your mail):

PO Box, Number, Street, Rural Route **2137 East Burnside Street**

City **Portland**

State **OR**

ZIP **97211**

6. Phone Number of the Business Location: 541-301-8167

7. Contact Person for this Application:

Name **Lacey Hudgins**

Phone Number **602-820-8660**

Mailing Address, City, State, ZIP

2137 East Burnside Street, Portland, OR, 97214

Email **lhudgins@gmail.com**

I understand that marijuana (such as use, consumption, ingestion, inhalation, samples, give-away, sale, etc.) is prohibited on the licensed premises.

Signature of Applicant #1

Signature of Applicant #3

Signature of Applicant #2

Signature of Applicant #4

RECEIVED

NOV 28 2017



OREGON LIQUOR CONTROL COMMISSION BUSINESS INFORMATION

Please Print or Type

Applicant Name: McCUBS LLC Phone: 541-301-8167

Trade Name (dba): SAMMICH

Business Location Address: 2137 E. BURNSIDE ST.

City: PORTLAND ZIP Code: 97214

DAYS AND HOURS OF OPERATION

Business Hours:

Sunday 11AM to 8PM
 Monday 11AM to 8PM
 Tuesday 11AM to 8PM
 Wednesday 11AM to 8PM
 Thursday 11AM to 8PM
 Friday 11AM to 8PM
 Saturday 11AM to 8PM

Outdoor Area Hours:

Sunday 11AM to 8PM
 Monday 11AM to 8PM
 Tuesday 11AM to 8PM
 Wednesday 11AM to 8PM
 Thursday 11AM to 8PM
 Friday 11AM to 8PM
 Saturday 11AM to 8PM

The outdoor area is used for:

- Food service Hours: 11AM to 8PM
- Alcohol service Hours: 11AM to 8PM
- Enclosed, how _____

The exterior area is adequately viewed and/or supervised by Service Permittees.
 _____ (Investigator's Initials)

Seasonal Variations: Yes No If yes, explain: _____

ENTERTAINMENT

Check all that apply:

- Live Music
- Recorded Music
- DJ Music
- Dancing
- Nude Entertainers
- Karaoke
- Coin-operated Games
- Video Lottery Machines
- Social Gaming
- Pool Tables
- Other: _____

DAYS & HOURS OF LIVE OR DJ MUSIC

Sunday _____ to _____
 Monday _____ to _____
 Tuesday _____ to _____
 Wednesday _____ to _____
 Thursday _____ to _____
 Friday _____ to _____
 Saturday _____ to _____

SEATING COUNT

Restaurant: _____ Outdoor: _____
 Lounge: _____ Other (explain): _____
 Banquet: _____ Total Seating: _____

OLCC USE ONLY

Investigator Verified Seating: ____ (Y) ____ (N)

Investigator Initials: _____

Date: _____

I understand if my answers are not true and complete, the OLCC may deny my license application.

Applicant Signature: [Signature] Date: 11/20/17

OREGON LIQUOR CONTROL COMMISSION
LIMITED LIABILITY COMPANY QUESTIONNAIRE



1372367-90

Please Print or Type

LLC Name: McCubs LLC Year Filed: 2017 ✓

Trade Name (dba): Sammich

Business Location Address: 2137 East Burnside Street

City: Portland ZIP Code: 97214

List Members of LLC:

Percentage of Membership Interest:

1. <u>Melissa McMillan</u> (managing member)	<u>50%</u>
2. <u>Timothy McMillan</u> (members)	<u>50%</u>
3. _____	_____
4. _____	_____
5. _____	_____
6. _____	_____

(Note: If any LLC member is another legal entity, that entity must also complete an LLC, Limited Partnership or Corporation Questionnaire. If the LLC has officers, please list them on a separate sheet of paper with their titles.)

Server Education Designee: Lacey Hudgins DOB: 01/24/1983

I understand that if my answers are not true and complete, the OLCC may deny my license application.

Signature: [Signature] owner Date: Nov 13, 2017
(name) (title)

1-800-452-OLCC (6522)
www.olcc.state.or.us

(rev. 8/11)

CITY OF PORTLAND LIQUOR OUTLET INFORMATION FORM

PLEASE SUBMIT TO: Liquor Licensing Notification Program, 1221 SW 4th Avenue, Suite #110, Portland OR 97204

On New Outlet applications, property owners within 300 feet of the location, the Portland Police Bureau and all interested parties are notified by mail (with a copy of this form) and given an opportunity to comment on your application. The OLCC allows the City at least 45 days to complete the recommendation process. Submission of a complete operating plan can expedite the time required to process. A City liquor endorsement is not a confirmation that the property is properly zoned. Call (503) - 823-7526 to confirm that the property is properly zoned.

On submission of this form, you must also include the following:

- OLCC Liquor Application Form, initialed by your OLCC License Investigator
- OLCC Individual History Forms (all persons anticipated to have a financial interest, or key personnel are required)
- City Endorsement Fees

City Endorsement Fees are payable at the beginning of the application process (please make checks payable to City of Portland): New outlets are \$100.00, all others are \$75.00. All blank sections must be filled in. If the question does not apply, write "N/A" in the space.

LEGAL NAME OF BUSINESS: McCUBS LLO
DBA OR TRADE NAME: SAMMICH PHONE: 503.477.4393 FAX: N/A
BUSINESS ADDRESS (Including ZIP Code): 2137 E. BURNSIDE ST. SUITE D 97214
WHAT TYPE OF LIQUOR ARE YOU APPLYING FOR? (Change of owner, new outlet, beer & wine, etc.): FULL-ON PREMISES
CONTACT PERSON: LACEY HUDGINS PHONE: 503.820.8660 EMAIL: lhudgins@gmail.com

DESCRIPTION OF OUTLET

TYPE OF OPERATION (CHECK ALL THAT APPLY)

- Food Cart Night Club
 Restaurant Sports Bar
 Convenience Store Other: _____

SIZE OF SERVICE AREA: _____

EXISTING BUILDING: Yes No

ZONING: _____

STRUCTURAL CHANGES (DESCRIBE): N/A

RESTAURANT SEATING CAPACITY: 20 LOUNGE SEATING CAPACITY: _____ OUTSIDE SEATING CAPACITY: 8

DESCRIBE SECURITY: N/A

HAS AN APPLICATION FOR A LIQUOR LICENSE AT THIS LOCATION BEEN RECEIVED BY THE CITY OF PORTLAND IN THE LAST TWO (2) YEARS?

Yes No I Don't Know

HOURS OF OPERATION

SUNDAY - THURSDAY OPEN: 11 AM CLOSE: 8 PM FRIDAY & SATURDAY OPEN: 11 AM CLOSE: 8 PM

HOW LATE WILL THERE BE OUTSIDE SEATING? 8 PM HOW LATE WILL THERE BE ENTERTAINMENT? N/A

HISTORY OF LOCATION

PREVIOUS BUSINESS NAME OF THIS LOCATION: _____

NAME & ADDRESS OF PROPERTY OWNER: _____

ENTERTAINMENT

TYPE OF ENTERTAINMENT (CHECK ALL THAT APPLY)

- Dancing Video Poker Live Music Nude Dancers
 Karaoke Video Games/Pinball Recorded Music DJ Entertainment
 Pool Tables (How Many): _____ Events (Describe): _____ Other: _____

The City requires an **Amusement Location Permit** for all locations with amusement devices or pool tables. **Contact the Revenue Bureau for rules and an Amusement Location Permit application form now.** Permits are non-transferable from one owner to another and must be paid before games are placed on the premises. Contact Anne Holm at 503-865-2488. The City of Portland will notify affected nearby neighbors and a copy of this form will be included in our mailing.

Use this area to provide any additional information that you wish to be considered on this liquor application

A false answer or omission of any requested information may result in an unfavorable City recommendation.

SIGNATURE: _____

DATE: _____

- Add Layers To Map**
- BODS Frequently Used Layers
 - Boundaries (phasing out please use Code Overlays (phasing out please use Environment (phasing out please use FEMA BIOP Inspection Districts New Layers for review
 - PDC (phasing out please use Enterp Permit Activity
 - Permit Activity (to be deleted) - cont
 - Phased LURs (phasing out please use Transit-TSP (phasing out please use Utilities (phasing out please use Ent Zoning Code (phasing out please use Enterprise GIS Hub - All Layers

RETAIL SALES & SERVICE ALLOWED BY RIGHT.
1/30/18
503.823.7919.
Jodylynn Smith
CITY PLANNER

Bureau of Development Services
 1900 SW 4th Ave., Suite 5000
 Portland, OR 97201

Find layers or groups by name:
 Show legend when layer is set to visible
 Search Legend Add Data Selection

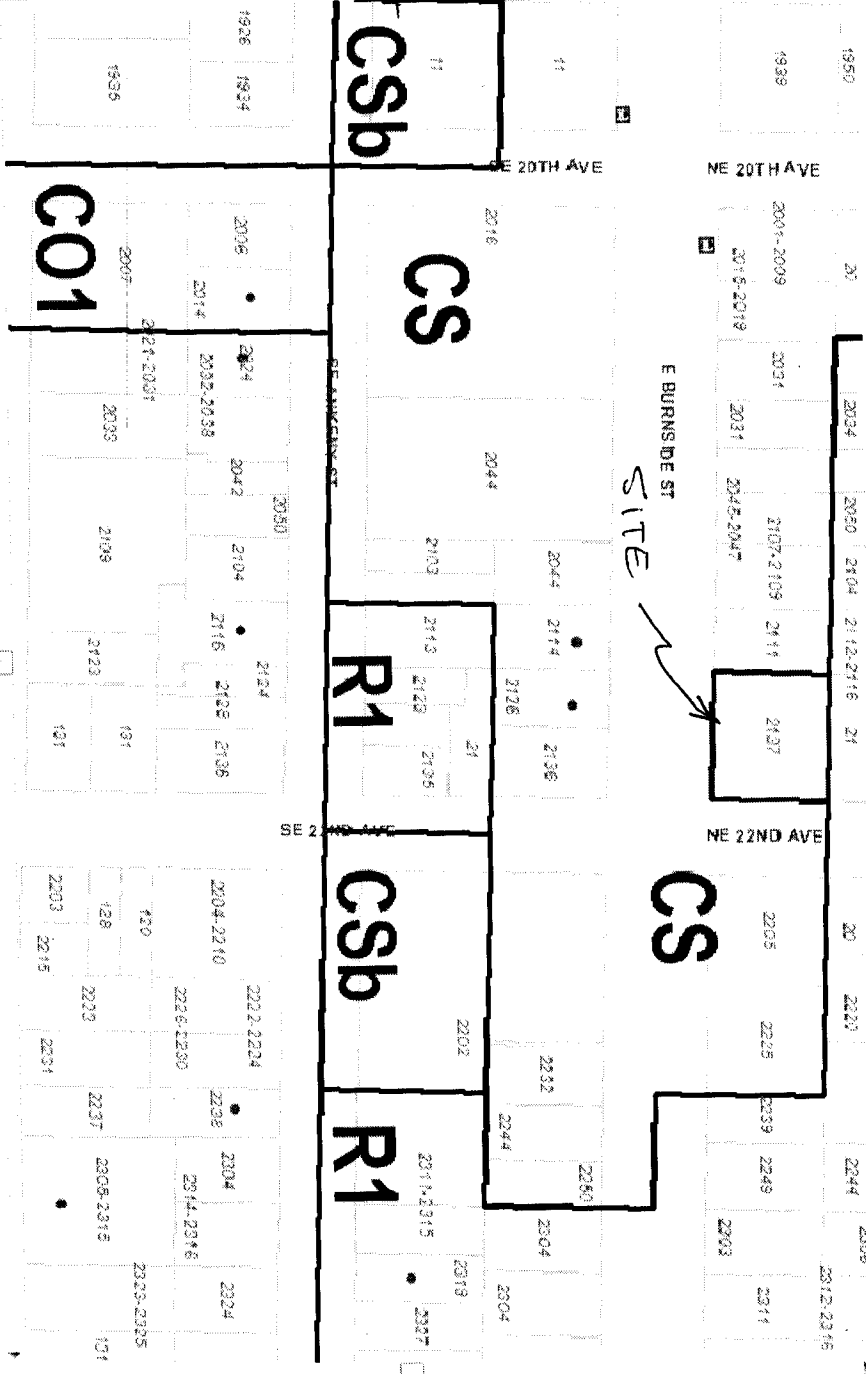

Taxlot Details

Lot Size: 4200 sqft
 Building Size: 3032
 Map Number: 3032
 Zoning Code(s): CS

Legal Description: DURNS ADD, BLOCK 6, LOT 182 EXC PT IN ST
 Lot & Block: 182 6
 Historic District:
 Conservation District:

Mailing Information:
 PATINO, AMY
 2403 SE HAWTHORNE BLVD #8
 PORTLAND, OR 97214

Jurisdiction: Portland

SubArea:
 SubDistrict:
 Plan District:
 1/4 Section Map Tax Map Zoning Map
 LUR Case History: (1 Case)
 VZ 293-60

Draw LURs LUR Search

Scale 1 inch = 125 Feet