



OREGON LIQUOR CONTROL COMMISSION

LIQUOR LICENSE APPLICATION

Pending

LICENSE FEE: Do not include the license fee with the application (the license fee will be collected at a later time).

APPLICATION: Application is being made for:

- Brewery
- Brewery-Public House
- Distillery
- Full On-Premises, Commercial
- Full On-Premises, Caterer
- Full On-Premises, Passenger Carrier
- Full On-Premises, Other Public Location
- Full On-Premises, Nonprofit Private Club
- Full On-Premises, For-Profit Private Club
- Grower Sales Privilege
- Limited On-Premises
- Off-Premises
- Off-Premises with Fuel Pumps
- Warehouse
- Wholesale Malt Beverage & Wine (WMBW)
- Winery

L266676

CITY AND COUNTY USE ONLY

Date application received _____

Name of City or County _____

Recommends this license be Granted Denied

By _____

Date _____

OLCC USE

Application received by *[Signature]*

Date *1-24-18*

License Action:

c/o

Rec'd by Portland
Liquor Licenses

1. LEGAL ENTITY (example: corporation or LLC) or INDIVIDUAL(S) applying for the license:

Applicant #1

Helsinc, LLC

Applicant #2

FEB 01 2018

Applicant #3

Applicant #4

PD *\$75*
CF 10008

2. Trade Name of the Business (the name customers will see):

HEISER'S ON ALBERTA

3. Business Location: Number and Street

1538 NE ALBERTA ST

City *PORTLAND*

County *MULTNOMAH*

ZIP *97211*

4. Is the business at this location currently licensed by the OLCC? Yes No

5. Mailing Address (where the OLCC will send your mail): *1538 NE ALBERTA ST.*

PO Box, Number, Street, Rural Route

City *PORTLAND*

State *OREGON*

ZIP *97211*

6. Phone Number of the Business Location: *503 - 281 - 1477*

7. Contact Person for this Application:

Name *SARAH WENTZ*

Phone Number *971-506-0913*

Mailing Address, City, State, ZIP

1614 NE ROSA PARKS WAY PORTLAND, OR 97211

Email *Sarah.WENTZ@OUTLOOK.COM*

I understand that marijuana (such as use, consumption, ingestion, inhalation, samples, give-away, sale, etc.) is **prohibited** on the licensed premises.

Signature of Applicant #1

[Signature of Sarah Wentz]

Signature of Applicant #2

Signature of Applicant #3

Signature of Applicant #4

RECEIVED

JAN 16 2018

Initials: *[Signature]*
Oregon Liquor Control Commission



OREGON LIQUOR CONTROL COMMISSION
BUSINESS INFORMATION

Please Print or Type

503-281-1477

Applicant Name: HEISINC, LLC Phone: 971-506-0913

Trade Name (dba): HEISER'S ON ALBERTA

Business Location Address: 1538 NE ALBERTA ST.

City: PORTLAND ZIP Code: 97211

DAYS AND HOURS OF OPERATION

Business Hours:

Sunday 7am to 3pm
Monday 7am to 3pm
Tuesday 7am to 3pm
Wednesday 7am to 3pm
Thursday 7am to 3pm
Friday 7am to 3pm
Saturday 7am to 3pm

Outdoor Area Hours:

Sunday 7am to 3pm
Monday 7am to 3pm
Tuesday 7am to 3pm
Wednesday 7am to 3pm
Thursday 7am to 3pm
Friday 7am to 3pm
Saturday 7am to 3pm

The outdoor area is used for:

Food service Hours: 7am to 3pm
Alcohol service Hours: 7am to 3pm
Enclosed, how

The exterior area is adequately viewed and/or supervised by Service Permittees. (Investigator's Initials)

Seasonal Variations: Yes No If yes, explain: OUTDOOR AREA IS WEATHER PERMITTING (THIS AREA IS NOT COVERED/ENCLOSED) IT IS A SIDEWALK CAFE

ENTERTAINMENT

Check all that apply:

- Live Music, Recorded Music, DJ Music, Dancing, Nude Entertainers, Karaoke, Coin-operated Games, Video Lottery Machines, Social Gaming, Pool Tables, Other

DAYS & HOURS OF LIVE OR DJ MUSIC

Sunday to
Monday to
Tuesday to
Wednesday to
Thursday to
Friday to
Saturday to

SEATING COUNT

Restaurant: 40 Outdoor: 8
Lounge: Other (explain):
Banquet: Total Seating: 48

OLCC USE ONLY

Investigator Verified Seating: (Y) (N)
Investigator Initials:
Date:

I understand if my answers are not true and complete, the OLCC may deny my license application.

Applicant Signature: [Signature] Date: 1-13-18

OREGON LIQUOR CONTROL COMMISSION
LIMITED LIABILITY COMPANY QUESTIONNAIRE



1394311-91

Please Print or Type

LLC Name: HEISINC, LLC Year Filed: 2018 ✓

Trade Name (dba): HEISER'S ON Alberta

Business Location Address: 1538 NE Alberta SA.

City: Portland ZIP Code: 97211

List Members of LLC:

Percentage of Membership Interest:

1. <u>SARAH WENTZ</u> (managing member)	<u>10.72 %</u>
2. <u>Christie Griffin</u> (members)	<u>10.72 %</u>
3. <u>Denise Perez</u>	<u>28.56 %</u>
4. <u>Roslyn Hill</u>	<u>50 %</u>
5. _____	_____
6. _____	_____

(Note: If any LLC member is another legal entity, that entity must also complete an LLC, Limited Partnership or Corporation Questionnaire. If the LLC has officers, please list them on a separate sheet of paper with their titles.)

Server Education Designee: SARAH WENTZ DOB: 10/19/1979

I understand that if my answers are not true and complete, the OLCC may deny my license application.

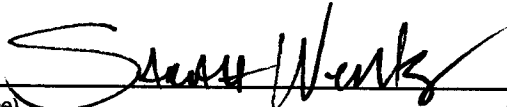
Signature:  Date: 1.13.18
(name) (title)

CITY OF PORTLAND LIQUOR OUTLET INFORMATION FORM

PLEASE SUBMIT TO: Liquor Licensing Notification Program, 1221 SW 4th Avenue, Suite #110, Portland OR 97204

On New Outlet applications, property owners within 300 feet of the location, the Portland Police Bureau and all interested parties are notified by mail (with a copy of this form) and given an opportunity to comment on your application. The OLCC allows the City at least 45 days to complete the recommendation process. Submission of a complete operating plan can expedite the time required to process. A City liquor endorsement is not a confirmation that the property is properly zoned. Call (503) - 823-7526 to confirm that the property is properly zoned.

On submission of this form, you must also include the following:

- OLCC Liquor Application Form, initialed by your OLCC License Investigator
- OLCC Individual History Forms (all persons anticipated to have a financial interest, or key personnel are required)
- City Endorsement Fees

City Endorsement Fees are payable at the beginning of the application process (please make checks payable to City of Portland): New outlets are \$100.00, all others are \$75.00. All blank sections must be filled in. If the question does not apply, write "N/A" in the space.

LEGAL NAME OF BUSINESS: Helpline, LLC

DBA OR TRADE NAME: Helser's on Alberta PHONE: 503-201-1477 FAX: _____

BUSINESS ADDRESS (Including ZIP Code): 1538 NE Alberta St. Portland, OR 97211

WHAT TYPE OF LIQUOR ARE YOU APPLYING FOR? (Change of owner, new outlet, beer & wine, etc.): Change of owner!

CONTACT PERSON: Sarah Wentz PHONE: 971-506-0913 EMAIL: Sarah.wentz@outlook.com

DESCRIPTION OF OUTLET

TYPE OF OPERATION (CHECK ALL THAT APPLY)

- | | |
|--|---------------------------------------|
| <input type="checkbox"/> Food Cart | <input type="checkbox"/> Night Club |
| <input checked="" type="checkbox"/> Restaurant | <input type="checkbox"/> Sports Bar |
| <input type="checkbox"/> Convenience Store | <input type="checkbox"/> Other: _____ |

SIZE OF SERVICE AREA: 640 sq ft

EXISTING BUILDING: Yes No

ZONING: _____

STRUCTURAL CHANGES (DESCRIBE): _____

RESTAURANT SEATING CAPACITY: 45 LOUNGE SEATING CAPACITY: 0 OUTSIDE SEATING CAPACITY: 10

DESCRIBE SECURITY: Double Dead bolts / Gristers.

HAS AN APPLICATION FOR A LIQUOR LICENSE AT THIS LOCATION BEEN RECEIVED BY THE CITY OF PORTLAND IN THE LAST TWO (2) YEARS?
 Yes No I Don't Know

HOURS OF OPERATION

SUNDAY - THURSDAY OPEN: 7am CLOSE: 3pm FRIDAY & SATURDAY OPEN: 7am CLOSE: 3pm

HOW LATE WILL THERE BE OUTSIDE SEATING? 3pm HOW LATE WILL THERE BE ENTERTAINMENT? N/A

HISTORY OF LOCATION

PREVIOUS BUSINESS NAME OF THIS LOCATION: HELSEK'S on Alberta.

NAME & ADDRESS OF PROPERTY OWNER: Alex Helser 1538 NE Alberta St. Portland, OR 97211

ENTERTAINMENT no entertainment.

TYPE OF ENTERTAINMENT (CHECK ALL THAT APPLY)

- | | | | |
|--|---|---|---|
| <input type="checkbox"/> Dancing | <input type="checkbox"/> Video Poker | <input type="checkbox"/> Live Music | <input type="checkbox"/> Nude Dancers |
| <input type="checkbox"/> Karaoke | <input type="checkbox"/> Video Games/Pinball | <input type="checkbox"/> Recorded Music | <input type="checkbox"/> DJ Entertainment |
| <input type="checkbox"/> Pool Tables (How Many): _____ | <input type="checkbox"/> Events (Describe): _____ | <input type="checkbox"/> Other: _____ | |

The City requires an Amusement Location Permit for all locations with amusement devices or pool tables. Contact the Revenue Bureau for rules and an Amusement Location Permit application form now. Permits are non-transferable from one owner to another and must be paid before games are placed on the premises. Contact Anne Holm at 503-865-2488. The City of Portland will notify affected nearby neighbors and a copy of this form will be included in our mailing.

Use this area to provide any additional information that you wish to be considered on this liquor application

A false answer or omission of any requested information may result in an unfavorable City recommendation.

SIGNATURE: [Signature] DATE: 1/26/18



City of Portland, Oregon - Bureau of Development Services
 1900 SW Fourth Avenue · Portland, Oregon 97201 | 503-823-7300 | www.portlandoregon.gov/bds



ZONING VERIFICATION

Address: 1520-1538 NE ALBERTA ST

R#: R295456

State ID: 1N1E23AC 5400

Zone: CSh

Plan District: NONE

Proposed Use: RETAIL SALES AND SERVICE

RETAIL SALES AND SERVICE is an ALLOWED use in the CSh zone

Additional Comments:

Retail Sales and Service Use allowed by right per 33.130.100 and Table 130-1.

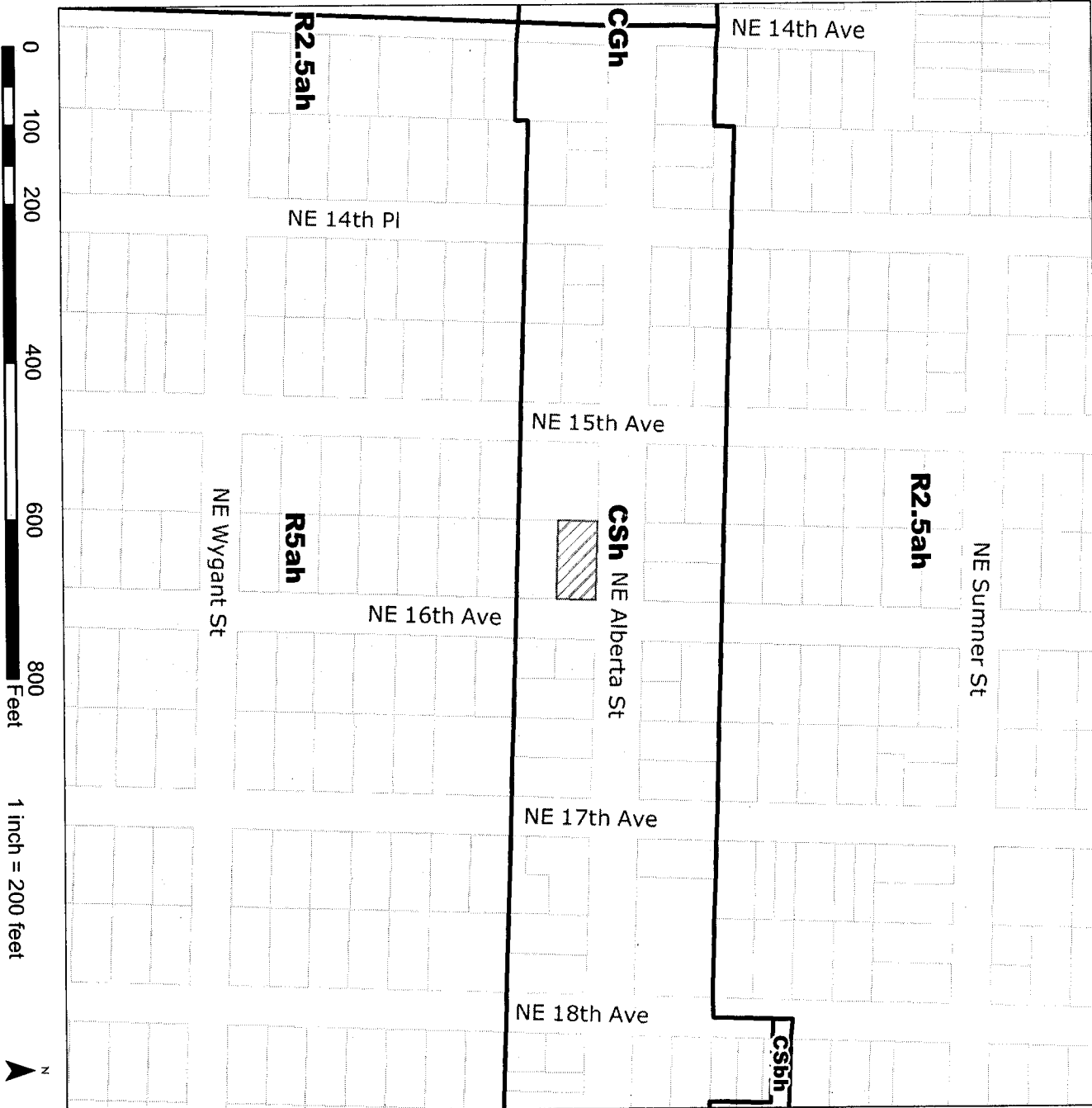

Tammy Boren-King
 Name of City Official

City Planner
 Title

503-823-5765
 Contact Number

Signature of Official
Tammy Boren-King

1 / **29** / **2018**
 Date