



OREGON LIQUOR CONTROL COMMISSION

LIQUOR LICENSE APPLICATION

DM

LICENSE FEE: Do not include the license fee with the application (the license fee will be collected at a later time).

APPLICATION: Application is being made for:

- Brewery
- Brewery-Public House
- Distillery
- Full On-Premises, Commercial
- Full On-Premises, Caterer
- Full On-Premises, Passenger Carrier
- Full On-Premises, Other Public Location
- Full On-Premises, Nonprofit Private Club
- Full On-Premises, For-Profit Private Club
- Grower Sales Privilege
- Limited On-Premises
- Off-Premises
- Off-Premises with Fuel Pumps
- Warehouse
- Wholesale Malt Beverage & Wine (WMBW)
- Winery

25571

CITY AND COUNTY USE ONLY

Date application received _____

Name of City or County _____

Recommends this license be ___ Granted ___ Denied

By _____

Date _____

OLCC USE

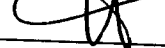
Application received by 

Date 2-12-18

License Action: C/O

Rec'd by Portland
Liquor Licenses

FEB 26 2018
PD # 75 2018
006876

1. LEGAL ENTITY (example: corporation or LLC) or INDIVIDUAL(S) applying for the license:

Applicant #1

ARTEMIS SKYE LLC.

Applicant #2

Applicant #3

Applicant #4

2. Trade Name of the Business (the name customers will see):

THE EASTBURN

3. Business Location: Number and Street

City **Portland**

County **Multnomah**

ZIP **97214**

4. Is the business at this location currently licensed by the OLCC? Yes No

5. Mailing Address (where the OLCC will send your mail):

PO Box, Number, Street, Rural Route **7436 SE Hawthorne Blvd**

City **Portland**

State **OR**

ZIP **97215**

6. Phone Number of the Business Location: **503-998-7067**

7. Contact Person for this Application:

Name **Michael Albert Fritz**

Phone Number **503-998-7067**

Mailing Address, City, State, ZIP

7436 SE Hawthorne Blvd, Portland OR. 97215

Email **eastburnpublichouse@gmail.com**

I understand that marijuana (such as use, consumption, ingestion, inhalation, samples, give-away, sale, etc.) is prohibited on the licensed premises.

Signature of Applicant #1

Signature of Applicant #2

Signature of Applicant #3

Signature of Applicant #4

RECEIVED

FEB 02 2018



OREGON LIQUOR CONTROL COMMISSION BUSINESS INFORMATION

Please Print or Type

Applicant Name: ARTEMIS SKYE LLC Phone: (503) 998-7067

Trade Name (dba): THE EASTBURN

Business Location Address: 1800 E. EASTBURN ST.

City: PORTLAND ZIP Code: 97214

DAYS AND HOURS OF OPERATION

Business Hours:

Sunday	<u>10 AM</u> to <u>2:00 AM</u>
Monday	<u>11 AM</u> to <u>12 AM</u>
Tuesday	<u>11 AM</u> to <u>12 AM</u>
Wednesday	<u>11 AM</u> to <u>12 AM</u>
Thursday	<u>11 AM</u> to <u>12 AM</u>
Friday	<u>11 AM</u> to <u>12 AM</u>
Saturday	<u>10 AM</u> to <u>2:00 AM</u>

Outdoor Area Hours:

Sunday	<u>10 AM</u> to <u>10 PM</u>
Monday	<u>11 AM</u> to <u>10 PM</u>
Tuesday	<u>11 AM</u> to <u>10 PM</u>
Wednesday	<u>11 AM</u> to <u>10 PM</u>
Thursday	<u>11 AM</u> to <u>10 PM</u>
Friday	<u>11 AM</u> to <u>10 PM</u>
Saturday	<u>10 AM</u> to <u>10 PM</u>

The outdoor area is used for:

Food service Hours: 11 AM to 10 PM
 Alcohol service Hours: 11 AM to 10 PM
 Enclosed, how _____

The exterior area is adequately viewed and/or supervised by Service Permittees.

(Investigator's Initials)

Seasonal Variations: Yes No If yes, explain: _____

ENTERTAINMENT

Check all that apply:

- | | |
|----------------------------------------------------|------------------------------------------------------------------------------------------|
| <input type="checkbox"/> Live Music | <input checked="" type="checkbox"/> Karaoke |
| <input checked="" type="checkbox"/> Recorded Music | <input checked="" type="checkbox"/> Coin-operated Games |
| <input type="checkbox"/> DJ Music | <input type="checkbox"/> Video Lottery Machines |
| <input checked="" type="checkbox"/> Dancing | <input type="checkbox"/> Social Gaming |
| <input type="checkbox"/> Nude Entertainers | <input type="checkbox"/> Pool Tables |
| | <input checked="" type="checkbox"/> Other: <u>TRIVIA NIGHT</u>
<u>OPEN MIC COMIDY</u> |

DAYS & HOURS OF LIVE OR DJ MUSIC

Sunday	_____ to _____
Monday	_____ to _____
Tuesday	_____ to _____
Wednesday	_____ to _____
Thursday	_____ to _____
Friday	_____ to _____
Saturday	_____ to _____

SEATING COUNT

Restaurant: 97 Outdoor: 20
 Lounge: 36 Other (explain): ANNIX 25
 Banquet: _____ Total Seating: 178

OLCC USE ONLY

Investigator Verified Seating: ____ (Y) ____ (N)
 Investigator Initials: _____
 Date: _____

I understand if my answers are not true and complete, the OLCC may deny my license application.

Applicant Signature: [Signature] Date: 1/31/18

1-800-452-OLCC (6522)

www.oregon.gov/olcc

(rev. 12/07)

OREGON LIQUOR CONTROL COMMISSION
LIMITED LIABILITY COMPANY QUESTIONNAIRE



1394373-96

Please Print or Type

LLC Name: ARTEMIS SKYE LLC Year Filed: 2018 ✓

Trade Name (dba): THE EASTBURN

Business Location Address: 1800 E. BURNSIDE ST.

City: PORTLAND ZIP Code: 97214

List Members of LLC:

Percentage of Membership Interest:

- | | |
|----------------------------------------------------------------|------------|
| 1. <u>MICHAEL A. FRITZ</u>
<small>(managing member)</small> | <u>60%</u> |
| 2. <u>COZETTE M. PARKER</u>
<small>(members)</small> | <u>40%</u> |
| 3. _____ | _____ |
| 4. _____ | _____ |
| 5. _____ | _____ |
| 6. _____ | _____ |

(Note: If any LLC member is another legal entity, that entity must also complete an LLC, Limited Partnership or Corporation Questionnaire. If the LLC has officers, please list them on a separate sheet of paper with their titles.)

Server Education Designee: MICHAEL A. FRITZ DOB: 12/02/1970

I understand that if my answers are not true and complete, the OLCC may deny my license application.

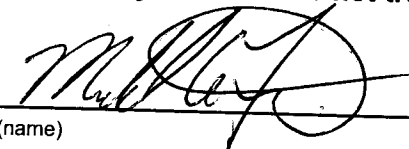
Signature:  OWNER Date: 1/31/18
(name) (title)

CITY OF PORTLAND LIQUOR OUTLET INFORMATION FORM

PLEASE SUBMIT TO: Liquor Licensing Notification Program, 1221 SW 4th Avenue, Suite #110, Portland OR 97204

On New Outlet applications, property owners within 300 feet of the location, the Portland Police Bureau and all interested parties are notified by mail (with a copy of this form) and given an opportunity to comment on your application. The OLCC allows the City at least 45 days to complete the recommendation process. Submission of a complete operating plan can expedite the time required to process. A City liquor endorsement is not a confirmation that the property is properly zoned. Call (503) - 823-7526 to confirm that the property is properly zoned.

On submission of this form, you must also include the following:

- OLCC Liquor Application Form, initialed by your OLCC License Investigator
- OLCC Individual History Forms (all persons anticipated to have a financial interest, or key personnel are required)
- City Endorsement Fees

City Endorsement Fees are payable at the beginning of the application process (please make checks payable to City of Portland): New outlets are \$100.00, all others are \$75.00. All blank sections must be filled in. If the question does not apply, write "N/A" in the space.

LEGAL NAME OF BUSINESS: ARTEMIS SKYE LLC.
DBA OR TRADE NAME: THE EASTBURN PHONE: (503) 998-7067 FAX: _____
BUSINESS ADDRESS (Including ZIP Code): 1800 E BURNSIDE ST PORTLAND, OR. 97214
WHAT TYPE OF LIQUOR ARE YOU APPLYING FOR? (Change of owner, new outlet, beer & wine, etc.): CHANGE OF OWNER
CONTACT PERSON: MICHAEL A. FRITZ PHONE: (503) 998-7067 EMAIL: EASTBURN PUBLIC HOUSE@GMAIL.COM

DESCRIPTION OF OUTLET

TYPE OF OPERATION (CHECK ALL THAT APPLY)

- Food Cart Night Club
 Restaurant Sports Bar
 Convenience Store Other: TAP ROOM BAR

SIZE OF SERVICE AREA: 7,000 SQ FEET
EXISTING BUILDING: Yes No
ZONING: CS - STORE FRONT COMMERCIAL
STRUCTURAL CHANGES (DESCRIBE): NONE

RESTAURANT SEATING CAPACITY: 97 LOUNGE SEATING CAPACITY: 36 OUTSIDE SEATING CAPACITY: 20

DESCRIBE SECURITY: FLOOR MANAGERS ANNEX SEATING: 25

HAS AN APPLICATION FOR A LIQUOR LICENSE AT THIS LOCATION BEEN RECEIVED BY THE CITY OF PORTLAND IN THE LAST TWO (2) YEARS?
 Yes No I Don't Know

HOURS OF OPERATION

SUNDAY - THURSDAY OPEN: 10 AM CLOSE: 12 AM FRIDAY & SATURDAY OPEN: 11 AM CLOSE: 2 AM
HOW LATE WILL THERE BE OUTSIDE SEATING? 10 PM HOW LATE WILL THERE BE ENTERTAINMENT? 12 AM

HISTORY OF LOCATION

PREVIOUS BUSINESS NAME OF THIS LOCATION: SAME: THE EASTBURN
NAME & ADDRESS OF PROPERTY OWNER: MICHAEL PRATT 2807 SE ASH ST PORTLAND OR. 97214

ENTERTAINMENT

TYPE OF ENTERTAINMENT (CHECK ALL THAT APPLY)

- Dancing Video Poker Live Music Nude Dancers
 Karaoke Video Games/Pinball Recorded Music DJ Entertainment
 Pool Tables (How Many): _____ Events (Describe): OPEN MIC COMEDY ONCE A WEEK Other: TRIVIA NIGHT ONCE A WEEK

The City requires an **Amusement Location Permit** for all locations with amusement devices or pool tables. **Contact the Revenue Bureau for rules and an Amusement Location Permit application form now.** Permits are non-transferable from one owner to another and must be paid before games are placed on the premises. Contact Anne Holm at 503-865-2488. The City of Portland will notify affected nearby neighbors and a copy of this form will be included in our mailing.

Use this area to provide any additional information that you wish to be considered on this liquor application

THIS RESTAURANT & LOCATION HAS BEEN IN OPERATION FOR 10 YEARS
THIS IS ONLY A OWNER CHANGE NO CHANGE TO OPERATION OR SERVICE STYLE

A false answer or omission of any requested information may result in an unfavorable City recommendation.

SIGNATURE: [Signature] DATE: 2/22/18

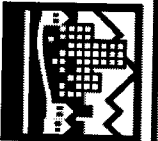

ZONING VERIFICATION

Address: 1800 E BURNSIDE ST

R#: R123153

State ID: 1N1E35DC 400

Zone: CS

Plan District: NONE

Proposed Use: **RETAIL SALES AND SERVICE**

RETAIL SALES AND SERVICE is an ALLOWED use in the CS zone

Additional Comments:

Retail Sales and Service is allowed by right in the CS zone, per 33.130.100, Table 130-1. This business is not a convenience store.

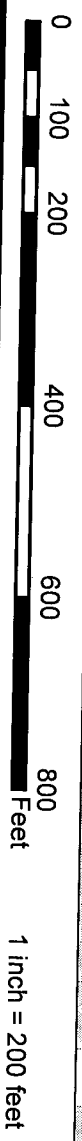
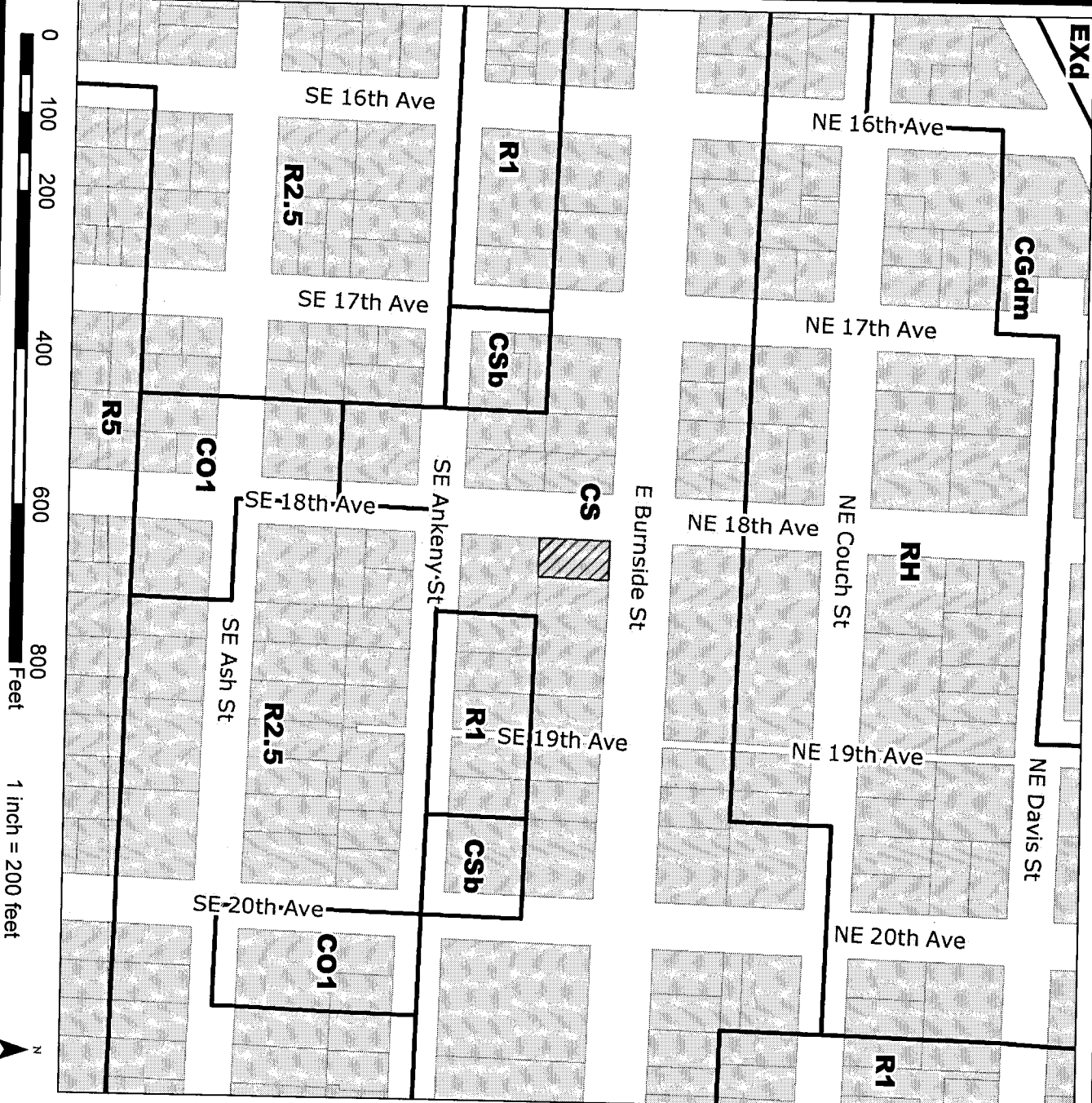

Tammy Boren-King
 Name of City Official

City Planner
 Title

503-823-5765
 Contact Number

Tammy Boren-King
 Signature of Official

2 / **26** / **2018**
 Date