



# LIQUOR LICENSE APPLICATION

DT

<p><b>LICENSE FEE:</b> Do not include the license fee with the application (the license fee will be collected at a later time).</p> <p><b>APPLICATION:</b> Application is being made for:</p> <p><input type="checkbox"/> Brewery</p> <p><input type="checkbox"/> Brewery-Public House</p> <p><input type="checkbox"/> Distillery</p> <p><input type="checkbox"/> Full On-Premises, Commercial</p> <p><input type="checkbox"/> Full On-Premises, Caterer</p> <p><input type="checkbox"/> Full On-Premises, Passenger Carrier</p> <p><input type="checkbox"/> Full On-Premises, Other Public Location</p> <p><input type="checkbox"/> Full On-Premises, Nonprofit Private Club</p> <p><input type="checkbox"/> Full On-Premises, For-Profit Private Club</p> <p><input type="checkbox"/> Grower Sales Privilege</p> <p><input checked="" type="checkbox"/> Limited On-Premises</p> <p><input checked="" type="checkbox"/> Off-Premises</p> <p><input type="checkbox"/> Off-Premises with Fuel Pumps</p> <p><input type="checkbox"/> Warehouse</p> <p><input type="checkbox"/> Wholesale Malt Beverage &amp; Wine (WMBW)</p> <p><input type="checkbox"/> Winery</p>	<p align="center"><b>CITY AND COUNTY USE ONLY</b></p> <p>Date application received _____</p> <p>Name of City or County _____</p> <p>Recommends this license be ___ Granted ___ Denied</p> <p>By _____</p> <p>Date _____</p> <hr/> <p align="center"><b>OLCC USE</b></p> <p>Application received by <u><i>[Signature]</i></u></p> <p>Date <u>2-9-18</u></p> <p>License Action: <u>N/O</u></p>
---	--

<b>1. LEGAL ENTITY (example: corporation or LLC) or INDIVIDUAL(S) applying for the license:</b>			
Applicant #1 <b>Film Action Oregon</b>	Applicant #2	Applicant #3	Applicant #4 Rec'd by <u>ADN-Profit</u> Portland Liquor Licenses
			<b>MAR 05 2018</b> PD \$100 ck # <u>16406</u>
<b>2. Trade Name of the Business (the name customers will see):</b> <b>Hollywood Theatre's Movie Madness</b>			
<b>3. Business Location: Number and Street</b> <u>4320 SE Belmont Ave</u> <i>SK</i>			
City <b>Portland</b>	County <b>Multnomah</b>	ZIP <b>97215</b>	
<b>4. Is the business at this location currently licensed by the OLCC?</b> <input type="checkbox"/> Yes <input checked="" type="checkbox"/> No			
<b>5. Mailing Address (where the OLCC will send your mail):</b> PO Box, Number, Street, Rural Route <b>4320 SE Belmont Ave</b>			
City <b>Portland</b>	State <b>OR</b>	ZIP <b>97215</b>	
<b>6. Phone Number of the Business Location: 503-234-4363</b>			
<b>7. Contact Person for this Application:</b>			
Name <b>Doug Whyte</b>		Phone Number <b>503-281-1142</b>	
Mailing Address, City, State, ZIP <b>4035 NE Sandy Blvd #212, Portland, OR 97212</b>			
Email <b>doug@hollywoodtheatre.org</b>			
I understand that marijuana (such as use, consumption, ingestion, inhalation, samples, give-away, sale, etc.) is <b>prohibited on the licensed premises.</b>			
Signature of Applicant #1 <i>[Signature]</i>		Signature of Applicant #2	
Signature of Applicant #3		Signature of Applicant #4	

**RECEIVED**  
**FEB 01 2018**



# OREGON LIQUOR CONTROL COMMISSION BUSINESS INFORMATION

Please Print or Type

Applicant Name: Film Action Oregon Phone: 503-281-1142

Trade Name (dba): Hollywood Theatre's Movie Madness

Business Location Address: 4320 SE Belmont Ave

City: Portland ZIP Code: 97215

### DAYS AND HOURS OF OPERATION

**Business Hours:**

Sunday 11am to 11pm  
 Monday 11am to 11pm  
 Tuesday 11am to 11pm  
 Wednesday 11am to 11pm  
 Thursday 11am to 11pm  
 Friday 11am to 11pm  
 Saturday 11am to 11pm

**Outdoor Area Hours:**

Sunday \_\_\_\_\_ to \_\_\_\_\_  
 Monday \_\_\_\_\_ to \_\_\_\_\_  
 Tuesday \_\_\_\_\_ to \_\_\_\_\_  
 Wednesday \_\_\_\_\_ to \_\_\_\_\_  
 Thursday \_\_\_\_\_ to \_\_\_\_\_  
 Friday \_\_\_\_\_ to \_\_\_\_\_  
 Saturday \_\_\_\_\_ to \_\_\_\_\_

The outdoor area is used for:

Food service Hours: \_\_\_\_\_ to \_\_\_\_\_  
 Alcohol service Hours: \_\_\_\_\_ to \_\_\_\_\_  
 Enclosed, how \_\_\_\_\_

The exterior area is adequately viewed and/or supervised by Service Permittees.  
 \_\_\_\_\_ (Investigator's Initials)

Seasonal Variations:  Yes  No If yes, explain: \_\_\_\_\_

### ENTERTAINMENT

Check all that apply:

Live Music  Karaoke  
 Recorded Music  Coin-operated Games  
 DJ Music  Video Lottery Machines  
 Dancing  Social Gaming  
 Nude Entertainers  Pool Tables  
 Other: Museum / Movies  
Video Store

### DAYS & HOURS OF LIVE OR DJ MUSIC

Sunday \_\_\_\_\_ to \_\_\_\_\_  
 Monday \_\_\_\_\_ to \_\_\_\_\_  
 Tuesday \_\_\_\_\_ to \_\_\_\_\_  
 Wednesday \_\_\_\_\_ to \_\_\_\_\_  
 Thursday \_\_\_\_\_ to \_\_\_\_\_  
 Friday \_\_\_\_\_ to \_\_\_\_\_  
 Saturday \_\_\_\_\_ to \_\_\_\_\_

### SEATING COUNT

Restaurant: \_\_\_\_\_ Outdoor: \_\_\_\_\_  
 Lounge: \_\_\_\_\_ Other (explain): \_\_\_\_\_  
 Banquet: \_\_\_\_\_ Total Seating: 0

**OLCC USE ONLY**

Investigator Verified Seating: \_\_\_\_\_ (Y) \_\_\_\_\_ (N)  
 Investigator Initials: \_\_\_\_\_  
 Date: \_\_\_\_\_

I understand if my answers are not true and complete, the OLCC may deny my license application.

Applicant Signature: [Signature] Date: 1/29/18

1-800-452-OLCC (6522)  
www.oregon.gov/olcc

# CITY OF PORTLAND LIQUOR OUTLET INFORMATION FORM

PLEASE SUBMIT TO: Liquor Licensing Notification Program, 1221 SW 4<sup>th</sup> Avenue, Suite #110, Portland OR 97204

On New Outlet applications, property owners within 300 feet of the location, the Portland Police Bureau and all interested parties are notified by mail (with a copy of this form) and given an opportunity to comment on your application. The OLCC allows the City at least 45 days to complete the recommendation process. Submission of a complete operating plan can expedite the time required to process. A City liquor endorsement is not a confirmation that the property is properly zoned. Call (503) - 823-7526 to confirm that the property is properly zoned.

On submission of this form, you must also include the following:

- OLCC Liquor Application Form, initialed by your OLCC License Investigator
- OLCC Individual History Forms (all persons anticipated to have a financial interest, or key personnel are required)
- City Endorsement Fees

City Endorsement Fees are payable at the beginning of the application process (please make checks payable to City of Portland): New outlets are \$100.00, all others are \$75.00. All blank sections must be filled in. If the question does not apply, write "N/A" in the space.

LEGAL NAME OF BUSINESS: Film Action Oregon

DBA OR TRADE NAME: Movie Madness PHONE: 503-234-4363 FAX: N/A

BUSINESS ADDRESS (Including ZIP Code): 4320 SE Belmont St, Portland, OR 97215

WHAT TYPE OF LIQUOR ARE YOU APPLYING FOR? (Change of owner, new outlet, beer & wine, etc.): Limited On and Off-Premises

CONTACT PERSON: Doug Whyte PHONE: 503-281-1142 EMAIL: doug@hollywoodtheatre.org

### DESCRIPTION OF OUTLET

TYPE OF OPERATION (CHECK ALL THAT APPLY)

- Food Cart  Night Club  
 Restaurant  Sports Bar  
 Convenience Store  Other: Video Store

SIZE OF SERVICE AREA: 4,350 sq ft

EXISTING BUILDING:  Yes  No

ZONING: CM

STRUCTURAL CHANGES (DESCRIBE): N/A

RESTAURANT SEATING CAPACITY: N/A LOUNGE SEATING CAPACITY: N/A OUTSIDE SEATING CAPACITY: N/A

DESCRIBE SECURITY: Alarm system, surveillance cameras, 2 to 3 staff members on duty at all times

HAS AN APPLICATION FOR A LIQUOR LICENSE AT THIS LOCATION BEEN RECEIVED BY THE CITY OF PORTLAND IN THE LAST TWO (2) YEARS?  
 Yes  No  I Don't Know

### HOURS OF OPERATION

SUNDAY - THURSDAY OPEN: 11:00am CLOSE: 11:00pm FRIDAY & SATURDAY OPEN: 11:00am CLOSE: 11:00pm

HOW LATE WILL THERE BE OUTSIDE SEATING? N/A HOW LATE WILL THERE BE ENTERTAINMENT? N/A

### HISTORY OF LOCATION

PREVIOUS BUSINESS NAME OF THIS LOCATION: Movie Madness Video & More, Inc.

NAME & ADDRESS OF PROPERTY OWNER: Michael Clark, 13483 SE 124th Ave, Clackamas, OR 97015

### ENTERTAINMENT

TYPE OF ENTERTAINMENT (CHECK ALL THAT APPLY)

- Dancing  Video Poker  Live Music  Nude Dancers  
 Karaoke  Video Games/Pinball  Recorded Music  DJ Entertainment  
 Pool Tables (How Many): \_\_\_\_\_  Events (Describe): \_\_\_\_\_  Other: \_\_\_\_\_

The City requires an **Amusement Location Permit** for all locations with amusement devices or pool tables. **Contact the Revenue Bureau for rules and an Amusement Location Permit application form now.** Permits are non-transferable from one owner to another and must be paid before games are placed on the premises. Contact Anne Holm at 503-865-2488. The City of Portland will notify affected nearby neighbors and a copy of this form will be included in our mailing.

Use this area to provide any additional information that you wish to be considered on this liquor application

N/A

A false answer or omission of any requested information may result in an unfavorable City recommendation.

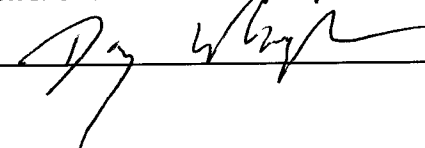
SIGNATURE:  DATE: 2/20/18

Property Search

Owner: **Narr CLARK, MICHAEL R**  
 Site Address: **4320 SE BELMONT ST**  
 State ID: **1S2E068B 13400**  
 Account #: **R169540**

Search:

Geocode Address When Taxlot Not  
 Search is Based on Active Field Only  
 Hide Personal Property Accounts  
 Display Taxlot Detail Window

Navigate Query Re:

Owner: **CLARK, MICHAEL R** Site Address: **4320 SE BELMONT ST** State: **OR**

Site is split zoned,  
 Building is in  
 the CPM zone.  
 The CPM zone allows  
 the CPM zone allows  
 retail sales & service  
 with limits  
 Permit of 119929-00  
 permitted the first  
 floor as retail sales  
 and service with  
 Herb and living the  
 on 2nd floor.

J. BRENN - BUS 2/20/18  
 503-823-5705

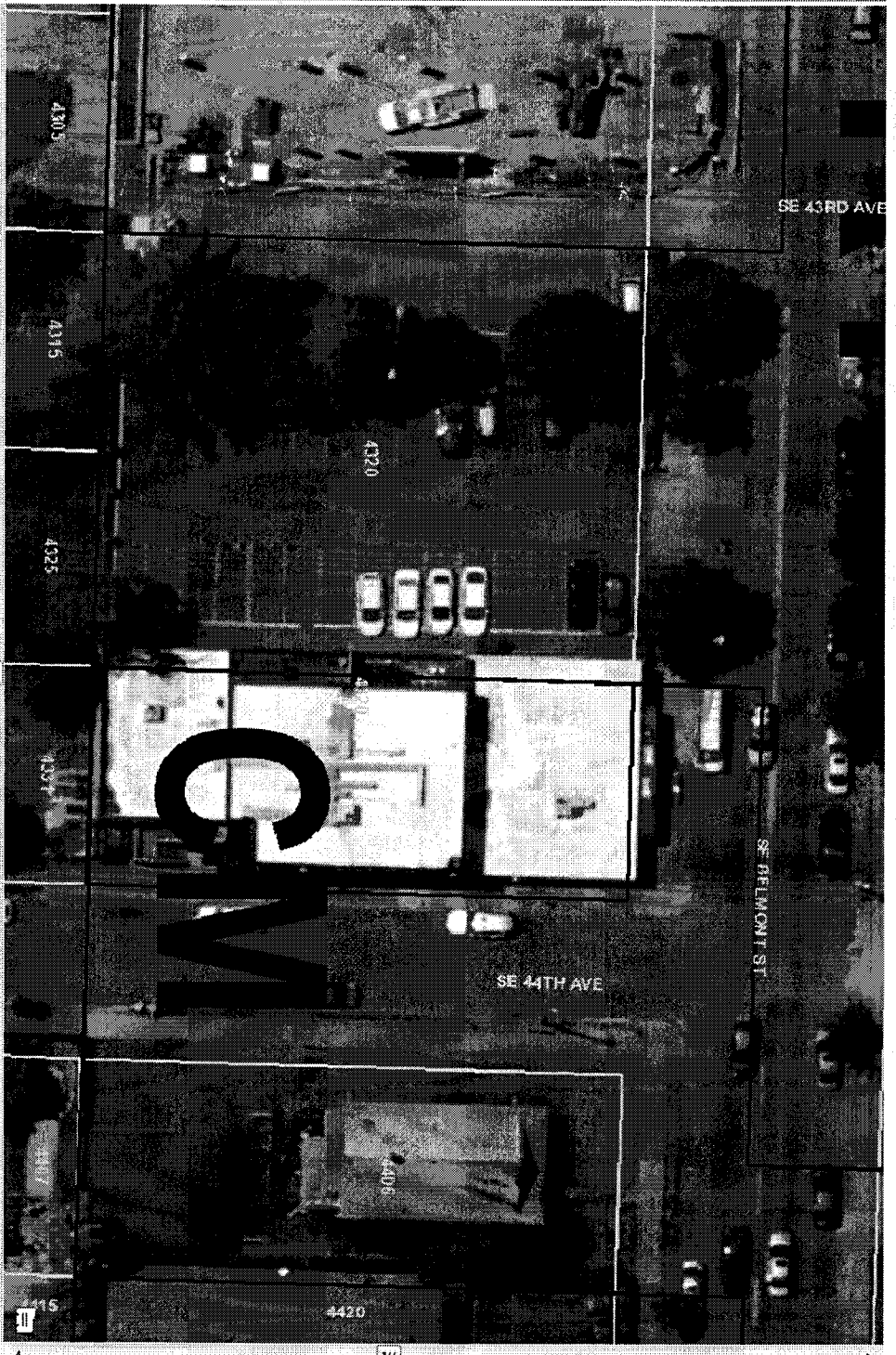

**Taxlot Details**

Lot Size: 6201 sqft Building Size: 8540 sqft Man Number: 3135 Zoning Code(s): CM

Legal Description: GLENCOE PK, BLOCK 3, INC STRIP N OF & ADJ, N 3

Map Information: CLARK, MICHAEL R 13483 SE 124TH AVE

Jurisdiction: Portland

1/2 Section:  Tax Map:  Zoning Map:

Plan District:  LUR Case Hist (4 Cases): LU 07-130141  
 SubDistrict:  VZ 10-86  
 SubArea:  VZ 272-64  
 NRMMP:  Draw LURs:  LUR:  VZ 280-63

Bureau of Development Services  
 1900 SW 4th Ave., Suite 5000  
 Portland, OR 97201