



LIQUOR LICENSE APPLICATION

DM

LICENSE FEE: Do not include the license fee with the application (the license fee will be collected at a later time).

APPLICATION: Application is being made for:

- Brewery
- Brewery-Public House
- Distillery
- Full On-Premises, Commercial
- Full On-Premises, Caterer
- Full On-Premises, Passenger Carrier
- Full On-Premises, Other Public Location
- Full On-Premises, Nonprofit Private Club
- Full On-Premises, For-Profit Private Club
- Grower Sales Privilege
- Limited On-Premises
- Off-Premises
- Off-Premises with Fuel Pumps
- Warehouse
- Wholesale Malt Beverage & Wine (WMBW)
- Winery

256702

CITY AND COUNTY USE ONLY

Date application received _____

Name of City or County _____

Recommends this license be ___ Granted ___ Denied

By _____

Date _____

OLCC USE

Application received by [Signature]

Date 3-23-18

License Action:

4/0 A/Priv.

1. LEGAL ENTITY (example: corporation or LLC) or INDIVIDUAL(S) applying for the license:

Applicant #1

Rilivia Corp

Applicant #2

/

Rec'd by Portland Liquor Licenses

Applicant #3

/

Applicant #4

/

APR 06 2018

PD CC \$75.00 (20/2)
029660

2. Trade Name of the Business (the name customers will see):

TINY'S COFFEE

3. Business Location: Number and Street

1412 SE 12th Ave

City Portland

OR

County Mult.

ZIP 97214

4. Is the business at this location currently licensed by the OLCC? Yes No

5. Mailing Address (where the OLCC will send your mail):

1412 SE 12th Ave

PO Box, Number, Street, Rural Route

City Portland

State OR

ZIP 97214

6. Phone Number of the Business Location:

7. Contact Person for this Application:

Name Matthew Henne

Phone Number 408-209-9460

Mailing Address, City, State, ZIP

6244 Frost Ln Lake Oswego OR 97035

Email matt@rilivia.com

I understand that marijuana (such as use, consumption, ingestion, inhalation, samples, give-away, sale, etc.) is prohibited on the licensed premises.

Signature of Applicant #1

[Signature]

Signature of Applicant #2

Signature of Applicant #3

Signature of Applicant #4

RECEIVED MAR 14 2018



OREGON LIQUOR CONTROL COMMISSION BUSINESS INFORMATION

Please Print or Type

Applicant Name: Lilivia Corp
Matthew Henne Phone: 408-209-9460
 Trade Name (dba): Tiny's Coffee
 Business Location Address: 1412 SE 12th Ave
 City: Portland OR ZIP Code: 97214

DAYS AND HOURS OF OPERATION

Business Hours:

Sunday 7:00 to 7:00
 Monday 6:00 to 7
 Tuesday 6 to 7
 Wednesday 6 to 7
 Thursday 6 to 7
 Friday 6 to 7
 Saturday 7:00 to 7:00

Outdoor Area Hours:

Sunday _____ to _____
 Monday _____ to _____
 Tuesday SAME to _____
 Wednesday _____ to _____
 Thursday _____ to _____
 Friday _____ to _____
 Saturday _____ to _____

The outdoor area is used for:

Food service Hours: 6 to 7
 Alcohol service Hours: 7 to 7
 Enclosed, how overhang

The exterior area is adequately viewed and/or supervised by Service Permittees.

(Investigator's Initials)

Seasonal Variations: Yes No If yes, explain: _____

ENTERTAINMENT

Check all that apply:

- Live Music
- Recorded Music
- DJ Music
- Dancing
- Nude Entertainers
- Karaoke
- Coin-operated Games
- Video Lottery Machines
- Social Gaming
- Pool Tables
- Other: _____

DAYS & HOURS OF LIVE OR DJ MUSIC

Sunday _____ to _____
 Monday _____ to _____
 Tuesday _____ to _____
 Wednesday _____ to _____
 Thursday _____ to _____
 Friday _____ to _____
 Saturday _____ to _____

SEATING COUNT

Restaurant: 30 Outdoor: 30
 Lounge: _____ Other (explain): _____
 Banquet: _____ Total Seating: 60

OLCC USE ONLY

Investigator Verified Seating: ____ (Y) ____ (N)
 Investigator Initials: _____
 Date: _____

I understand if my answers are not true and complete, the OLCC may deny my license application.

Applicant Signature: Matthew Henne Date: 3/2/18

1-800-452-OLCC (6522)

www.oregon.gov/olcc

(rev. 12/07)



OREGON LIQUOR CONTROL COMMISSION
CORPORATION QUESTIONNAIRE

1371890-98

Please Print or Type

Corporation Name: RILVIA CORP Year Incorporated: 2017 ✓

Trade Name (dba): TINY'S COFFEE

Business Location Address: 1412 SE 12th Ave

City: Portland ZIP Code: 97214

List Corporate Officers:

Matthew Henne
(name)

President
(title)

List Board of Directors:

(name)

List Stockholders: (Note: If any stockholder is another legal entity, that entity may also need to complete another Corporation Questionnaire. See Liquor License Application Guide for more information.)

Stockholders:	Number of Shares Held:	Number of Stock Shares:
<u>Matthew Henne</u>	<u>250,000</u>	Issued: <u>250,000</u>
_____	_____	Unissued: <u>250,000</u>
_____	_____	Total Shares Authorized to Issue: <u>500,000</u>
_____	_____	

Server Education Designee: Matthew Henne DOB: 02/19/1969
(See Liquor License Application Guide for more information)

I understand that if my answers are not true and complete, the OLCC may deny my license application.

Officer's Signature: Matthew Henne President Date: 2/9/10
(name) (title)

CITY OF PORTLAND LIQUOR OUTLET INFORMATION FORM

PLEASE SUBMIT TO: Liquor Licensing Notification Program, 1221 SW 4th Avenue, Suite #110, Portland OR 97204

On New Outlet applications, property owners within 300 feet of the location, the Portland Police Bureau and all interested parties are notified by mail (with a copy of this form) and given an opportunity to comment on your application. The OLCC allows the City at least 45 days to complete the recommendation process. Submission of a complete operating plan can expedite the time required to process. A City liquor endorsement is not a confirmation that the property is properly zoned. Call (503) - 823-7526 to confirm that the property is properly zoned.

On submission of this form, you must also include the following:

- OLCC Liquor Application Form, initialed by your OLCC License Investigator
- OLCC Individual History Forms (all persons anticipated to have a financial interest, or key personnel are required)
- City Endorsement Fees

City Endorsement Fees are payable at the beginning of the application process (please make checks payable to City of Portland): New outlets are \$100.00, all others are \$75.00. All blank sections must be filled in. If the question does not apply, write "N/A" in the space.

LEGAL NAME OF BUSINESS: Rilivia Corp
DBA OR TRADE NAME: Tiny's Coffee PHONE: 503-239-5859 FAX: _____
BUSINESS ADDRESS (Including ZIP Code): 1412 SE 12th Ave Portland OR 97214
WHAT TYPE OF LIQUOR ARE YOU APPLYING FOR? (Change of owner, new outlet, beer & wine, etc.): Change of Owner
CONTACT PERSON: Matthew Henne PHONE: 408-209-9460 EMAIL: matt@rilivia.com

DESCRIPTION OF OUTLET

TYPE OF OPERATION (CHECK ALL THAT APPLY)

- Food Cart Night Club
 Restaurant Sports Bar
 Convenience Store Other: _____

SIZE OF SERVICE AREA: ≈ 1,200 sq

EXISTING BUILDING: Yes No

ZONING: _____

STRUCTURAL CHANGES (DESCRIBE): ∅

RESTAURANT SEATING CAPACITY: 60 LOUNGE SEATING CAPACITY: 30 OUTSIDE SEATING CAPACITY: 30

DESCRIBE SECURITY: All areas have line-of-sight visibility by baristas

HAS AN APPLICATION FOR A LIQUOR LICENSE AT THIS LOCATION BEEN RECEIVED BY THE CITY OF PORTLAND IN THE LAST TWO (2) YEARS?
 Yes No I Don't Know

HOURS OF OPERATION

SUNDAY - THURSDAY OPEN: 6:00 CLOSE: 7:00 FRIDAY & SATURDAY OPEN: 6:00 CLOSE: 7:00

HOW LATE WILL THERE BE OUTSIDE SEATING? 7:00 HOW LATE WILL THERE BE ENTERTAINMENT? 7:00

HISTORY OF LOCATION

PREVIOUS BUSINESS NAME OF THIS LOCATION: Tiny's Coffee
NAME & ADDRESS OF PROPERTY OWNER: Matthew Henne 6244 Frost Ln Lake Oswego OR 97035

ENTERTAINMENT

TYPE OF ENTERTAINMENT (CHECK ALL THAT APPLY)

- Dancing Video Poker Live Music Nude Dancers
 Karaoke Video Games/Pinball Recorded Music DJ Entertainment
 Pool Tables (How Many): _____ Events (Describe): _____ Other: _____

The City requires an **Amusement Location Permit** for all locations with amusement devices or pool tables. **Contact the Revenue Bureau for rules and an Amusement Location Permit application form now.** Permits are non-transferable from one owner to another and must be paid before games are placed on the premises. Contact Anne Holm at 503-865-2488. The City of Portland will notify affected nearby neighbors and a copy of this form will be included in our mailing.

Use this area to provide any additional information that you wish to be considered on this liquor application

A false answer or omission of any requested information may result in an unfavorable City recommendation.

SIGNATURE: Matthew Henne DATE: 3/29/18

Property Search

Owner Name RAGAWAY, PHILIP
 Site Address 1408 SE 12TH AVE
 State ID 151E02BD 10300
 Account # R176911

- Geocode Address When Taxlot Not
- Search is Based on Active Field Only
- Hide Personal Property Accounts
- Display Taxlot Detail Window

Owner Site Address State
 RAGAWAY, P. 1408 SE 12TH 151E

Navigation: CS
 STOREFRONT
 COMMERCIAL
 RETAIL SALES AND
 SERVICE ALLOWED
 BY RIGHT.

1/24/18
4/3/18
 503, 823, 7919
 CITY PLANNER I

Bureau of Development Services
 1900 SW 4th Ave., Suite 5000
 Portland, OR 97201

Search Legend Add Data Sel < >

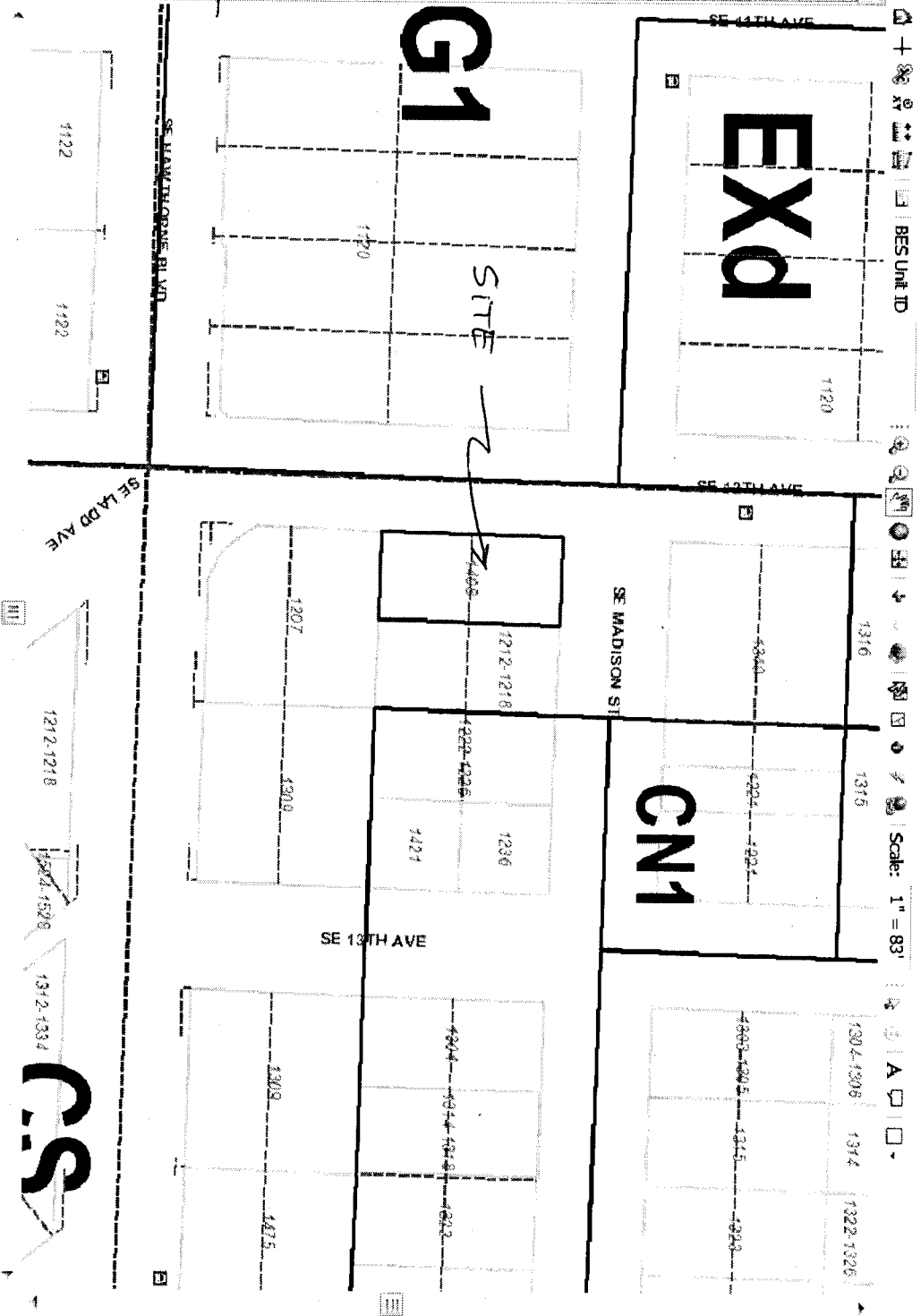

Taxlot Details

Lot Size: 5000 sqft
 Building Size: 3000 sqft
 Map Number: 3131
 Zoning Code(s): CS
 Legal Description: HAWTHORNE PK, BLOCK 252, W 1/2 OF LOT 182
 Lot & Block: 182
 Historic District: 252
 Conservation District: 252

Map Information:
 RAGAWAY, PHILIP
 1601 SE 11TH AVE
 Jurisdiction: Portland

1/4 Section Tax Map Zoning Map
 Plan District: LUR Case History:
 Subarea: Draw LURS
 NRMIP: LUR