



OREGON LIQUOR CONTROL COMMISSION

LIQUOR LICENSE APPLICATION

**LICENSE FEE:** Do not include the license fee with the application (the license fee will be collected at a later time).

**APPLICATION:** Application is being made for:

- Brewery
- Brewery-Public House
- Distillery
- Full On-Premises, Commercial
- Full On-Premises, Caterer
- Full On-Premises, Passenger Carrier
- Full On-Premises, Other Public Location
- Full On-Premises, Nonprofit Private Club
- Full On-Premises, For-Profit Private Club
- Grower Sales Privilege
- Limited On-Premises
- Off-Premises
- Off-Premises with Fuel Pumps
- Warehouse
- Wholesale Malt Beverage & Wine (WMBW)
- Winery

**CITY AND COUNTY USE ONLY**

Date application received \_\_\_\_\_

Name of City or County \_\_\_\_\_

Recommends this license be \_\_\_\_\_ Granted \_\_\_\_\_ Denied \_\_\_\_\_

By \_\_\_\_\_

Date \_\_\_\_\_

**OLCC USE**

Application received by \_\_\_\_\_

Date 3/7/18

License Action: C/O, C/TN, Add/Priv.

**1. LEGAL ENTITY (example: corporation or LLC) or INDIVIDUAL(S) applying for the license:**

Applicant #1 <u>The Main Attraction</u> <u>MICHAEL JAY BRASS LLC</u>	Applicant #2	Rec'd by Portland Liquor Licenses
Applicant #3	Applicant #4	APR 09 2018 PD <u>Cash 75.00</u> <sup>(u)</sup>

**2. Trade Name of the Business (the name customers will see):**  
THE MAIN ATTRACTION

**3. Business Location: Number and Street** 13550 SE Powell Blvd  
 City Portland County MULTNOMAH ZIP 97236

**4. Is the business at this location currently licensed by the OLCC?**  Yes  No

**5. Mailing Address (where the OLCC will send your mail):**  
 PO Box, Number, Street, Rural Route P.O. box 2271  
 City Gig Harbor State WA ZIP 98335

**6. Phone Number of the Business Location:**

**7. Contact Person for this Application:**  
 Name MICHAEL JAY BRASS Phone Number (253) 549-8445  
 Mailing Address, City, State, ZIP P.O. box 2271 Gig Harbor, WA 98335  
 Email STR8UPHITE TEETH @ YAHOO . COM

I understand that marijuana (such as use, consumption, ingestion, inhalation, samples, give-away, sale, etc.) is prohibited on the licensed premises.

Signature of Applicant #1 <u>MJBRASS</u>	Signature of Applicant #2
Signature of Applicant #3	Signature of Applicant #4



OREGON LIQUOR CONTROL COMMISSION  
BUSINESS INFORMATION

Please Print or Type

Applicant Name: MICHAEL J. BRASS Phone: (253) 549-8445

Trade Name (dba): THE MAIN ATTRACTION

Business Location Address: 13550 SE POWELL ST

City: PORTLAND ZIP Code: 97236

**DAYS AND HOURS OF OPERATION**

Business Hours:

Sunday 2pm to 2:30 AM  
Monday 2pm to 2:30 AM  
Tuesday 2pm to 2:30 AM  
Wednesday 2pm to 2:30 AM  
Thursday 2pm to 2:30 AM  
Friday 2pm to 2:30 AM  
Saturday 2pm to 2:30 AM

Outdoor Area Hours:

Sunday \_\_\_\_\_ to \_\_\_\_\_  
Monday \_\_\_\_\_ to \_\_\_\_\_  
Tuesday \_\_\_\_\_ to \_\_\_\_\_  
Wednesday \_\_\_\_\_ to \_\_\_\_\_  
Thursday \_\_\_\_\_ to \_\_\_\_\_  
Friday \_\_\_\_\_ to \_\_\_\_\_  
Saturday \_\_\_\_\_ to \_\_\_\_\_

The outdoor area is used for:

Food service Hours: \_\_\_\_\_ to \_\_\_\_\_  
 Alcohol service Hours: \_\_\_\_\_ to \_\_\_\_\_  
 Enclosed, how \_\_\_\_\_  
The exterior area is adequately viewed and/or supervised by Service Permittees.  
\_\_\_\_\_  
(Investigator's Initials)

Seasonal Variations:  Yes  No If yes, explain: OUTDOOR PATIO ONLY USED DURING SPRING & SUMMER

**ENTERTAINMENT**

Check all that apply:

- Live Music
- Recorded Music
- DJ Music
- Dancing
- Nude Entertainers
- Karaoke
- Coin-operated Games
- Video Lottery Machines
- Social Gaming
- Pool Tables
- Other: \_\_\_\_\_

**DAYS & HOURS OF LIVE OR DJ MUSIC**

Sunday 11AM to 2 AM  
Monday 11AM to 2 AM  
Tuesday 11AM to 2 AM  
Wednesday 11AM to 2 AM  
Thursday 11AM to 2 AM  
Friday 11AM to 2 AM  
Saturday 11AM to 2 AM

**SEATING COUNT**

Restaurant: \_\_\_\_\_ Outdoor: \_\_\_\_\_  
Lounge: 30 Other (explain): 30  
Banquet: 12 Total Seating: 72  
BAR

**OLCC USE ONLY**

Investigator Verified Seating: \_\_\_\_ (Y) \_\_\_\_ (N)

Investigator Initials: \_\_\_\_\_

Date: \_\_\_\_\_

I understand if my answers are not true and complete, the OLCC may deny my license application.

Applicant Signature: [Signature] Date: 3-7-2018

OREGON LIQUOR CONTROL COMMISSION  
LIMITED LIABILITY COMPANY QUESTIONNAIRE



Please Print or Type

LLC Name: THE MAIN ATTRACTION LLC Year Filed: 2018

Trade Name (dba): THE MAIN ATTRACTION

Business Location Address: \_\_\_\_\_

City: \_\_\_\_\_ ZIP Code: \_\_\_\_\_

List Members of LLC:

Percentage of Membership Interest:

1. MICHAEL JAY BRASS  
(managing member)

100%

2. \_\_\_\_\_  
(members)

3. \_\_\_\_\_

4. \_\_\_\_\_

5. \_\_\_\_\_

6. \_\_\_\_\_

(Note: If any LLC member is another legal entity, that entity must also complete an LLC, Limited Partnership or Corporation Questionnaire. If the LLC has officers, please list them on a separate sheet of paper with their titles.)

Server Education Designee: MICHAEL J. BRASS DOB: 10-10-1959

I understand that if my answers are not true and complete, the OLCC may deny my license application.

Signature: BRASS  
(name)

OWNER  
(title)

Date: 3-7-2018

# CITY OF PORTLAND LIQUOR OUTLET INFORMATION FORM

PLEASE SUBMIT TO: Liquor Licensing Notification Program, 1221 SW 4<sup>th</sup> Avenue, Suite #110, Portland OR 97204

On New Outlet applications, property owners within 300 feet of the location, the Portland Police Bureau and all interested parties are notified by mail (with a copy of this form) and given an opportunity to comment on your application. The OLCC allows the City at least 45 days to complete the recommendation process. Submission of a complete operating plan can expedite the time required to process. A City liquor endorsement is not a confirmation that the property is properly zoned. Call (503) - 823-7526 to confirm that the property is properly zoned.

**On submission of this form, you must also include the following:**

- OLCC Liquor Application Form, initialed by your OLCC License Investigator
- OLCC Individual History Forms (all persons anticipated to have a financial interest, or key personnel are required)
- City Endorsement Fees

City Endorsement Fees are payable at the beginning of the application process (please make checks payable to City of Portland): New outlets are \$100.00, all others are \$75.00. All blank sections must be filled in. If the question does not apply, write "N/A" in the space.

LEGAL NAME OF BUSINESS: THE MAIN ATTRACTION LLC

DBA OR TRADE NAME: THE MAIN ATTRACTION PHONE: (253) 549-8445 FAX: \_\_\_\_\_

BUSINESS ADDRESS (Including ZIP Code): 13550 SE POWELL BLVD. PORTLAND, OR. 97236

WHAT TYPE OF LIQUOR ARE YOU APPLYING FOR? (Change of owner, new outlet, beer & wine, etc.): NEW OUTLET

CONTACT PERSON: MICHAEL J. BRAS PHONE: (253) 549-8445 EMAIL: STRBWHITE@STANCO.COM

**DESCRIPTION OF OUTLET**

**TYPE OF OPERATION (CHECK ALL THAT APPLY)**

- Food Cart  Night Club  
 Restaurant  Sports Bar  
 Convenience Store  Other Strip Club

SIZE OF SERVICE AREA: \_\_\_\_\_

EXISTING BUILDING:  Yes  No

ZONING: \_\_\_\_\_

STRUCTURAL CHANGES (DESCRIBE): \_\_\_\_\_

RESTAURANT SEATING CAPACITY: 76 LOUNGE SEATING CAPACITY: \_\_\_\_\_ OUTSIDE SEATING CAPACITY: \_\_\_\_\_

DESCRIBE SECURITY: SINGLE GUARD WED, THURS, DOUBLE ON FRI & SAT

HAS AN APPLICATION FOR A LIQUOR LICENSE AT THIS LOCATION BEEN RECEIVED BY THE CITY OF PORTLAND IN THE LAST TWO (2) YEARS?  
 Yes  No  I Don't Know

**HOURS OF OPERATION**

SUNDAY - THURSDAY OPEN: 2:00 PM CLOSE: 2:30 AM FRIDAY & SATURDAY OPEN: 2:00 PM CLOSE: 2:30 AM

HOW LATE WILL THERE BE OUTSIDE SEATING? NO AMPLIFIED MUSIC AFTER 11 PM HOW LATE WILL THERE BE ENTERTAINMENT? 2:00 AM

**HISTORY OF LOCATION**

PREVIOUS BUSINESS NAME OF THIS LOCATION: KING'S WILD

NAME & ADDRESS OF PROPERTY OWNER: ANDY MAES

**ENTERTAINMENT**

**TYPE OF ENTERTAINMENT (CHECK ALL THAT APPLY)**

- Dancing  Video Poker  Live Music  Nude Dancers  
 Karaoke  Video Games/Pinball  Recorded Music  DJ Entertainment  
 Pool Tables (How Many): 2  Events (Describe): KARAOKE  Other: \_\_\_\_\_

The City requires an **Amusement Location Permit** for all locations with amusement devices or pool tables. **Contact the Revenue Bureau for rules and an Amusement Location Permit application form now.** Permits are non-transferable from one owner to another and must be paid before games are placed on the premises. Contact Anne Holm at 503-865-2488. The City of Portland will notify affected nearby neighbors and a copy of this form will be included in our mailing.

Use this area to provide any additional information that you wish to be considered on this liquor application

\_\_\_\_\_

**A false answer or omission of any requested information may result in an unfavorable City recommendation.**

SIGNATURE: MICHAEL J. BRAS DATE: \_\_\_\_\_

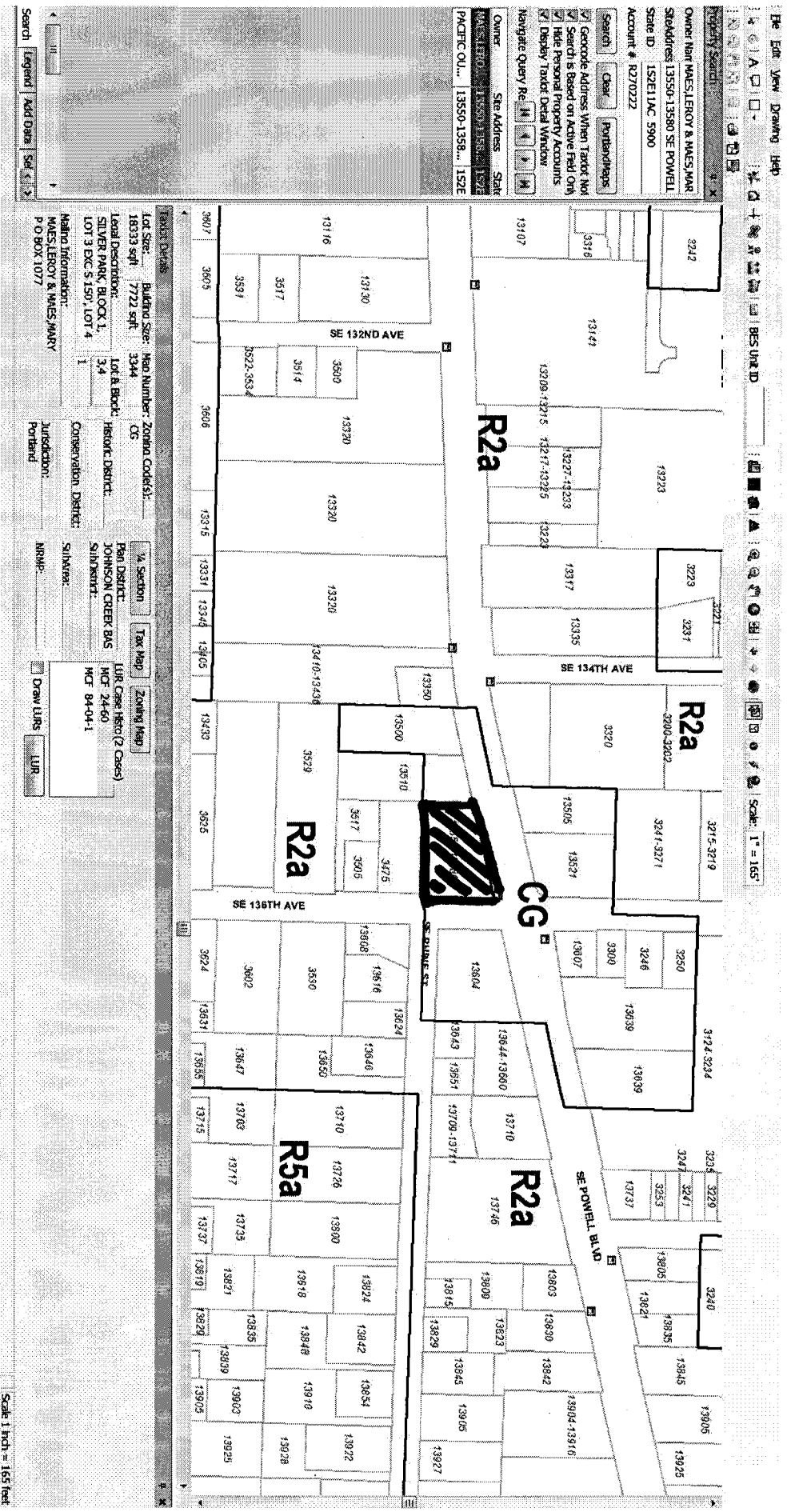

Retail Sales and Service is an allowed use in the CG zone.  
 Breah Pike-Salas, City Planner 503.823.7389  
 City of Portland, Oregon 97201



Bureau of Development Services  
 1900 SW 4th Ave., Suite 5000  
 Portland, OR 97201