



OREGON LIQUOR CONTROL COMMISSION

LIQUOR LICENSE APPLICATION

Pending

LICENSE FEE: Do not include the license fee with the application (the license fee will be collected at a later time).

APPLICATION: Application is being made for:

- Brewery
- Brewery-Public House
- Distillery
- Full On-Premises, Commercial
- Full On-Premises, Caterer
- Full On-Premises, Passenger Carrier
- Full On-Premises, Other Public Location
- Full On-Premises, Nonprofit Private Club
- Full On-Premises, For-Profit Private Club
- Grower Sales Privilege
- Limited On-Premises
- Off-Premises
- Off-Premises with Fuel Pumps
- Warehouse
- Wholesale Malt Beverage & Wine (WMBW)
- Winery

CITY AND COUNTY USE ONLY

Date application received _____

Name of City or County _____

Recommends this license be ___ Granted ___ Denied

By _____

Date _____

OLCC USE

Application received by 

Date 6-8-18

License Action: n10

1. LEGAL ENTITY (example: corporation or LLC) or INDIVIDUAL(S) applying for the license: Rec'd by Portland Liquor Licenses

| | |
|---------------------------------------|--------------|
| Applicant #1 <u>Lulu Pearl Inc</u> | Applicant #2 |
| Applicant #3 | Applicant #4 |

JUL 02 2018
PD CK #180⁰⁰ ADM
1636

2. Trade Name of the Business (the name customers will see): Artemis Foods

3. Business Location: Number and Street 914 NW Everett St.
 City Portland County Multnomah ZIP 97209

4. Is the business at this location currently licensed by the OLCC? Yes No

5. Mailing Address (where the OLCC will send your mail): 1610 SE 3rd Ave
 PO Box, Number, Street, Rural Route
 City Portland State OR ZIP 97214

6. Phone Number of the Business Location:

7. Contact Person for this Application:
 Name Lauren Carr Phone Number 503-233-8539
 Mailing Address, City, State, ZIP 1610 SE 3rd Ave Portland, OR 97214
 Email lauren@artemisfoods.com

I understand that marijuana (such as use, consumption, ingestion, inhalation, samples, give-away, sale, etc.) is prohibited on the licensed premises.

| | |
|--|---------------------------|
| Signature of Applicant #1  | Signature of Applicant #2 |
| Signature of Applicant #3 | Signature of Applicant #4 |

RECEIVED MAY 21 2018



OREGON LIQUOR CONTROL COMMISSION
BUSINESS INFORMATION

Please Print or Type

Applicant Name: Lulupearl Inc Phone: 503-233-8539
Trade Name (dba): Artemis Foods
Business Location Address: 914 NW Everett St.
City: Portland ZIP Code: 97209

DAYS AND HOURS OF OPERATION

Business Hours:

Sunday 8am to 10pm
Monday 8am to 10pm
Tuesday 8am to 10pm
Wednesday 8am to 10pm
Thursday 8am to 10pm
Friday 8am to 10pm
Saturday 8am to 10pm

Outdoor Area Hours:

Sunday to
Monday to
Tuesday to
Wednesday to
Thursday to
Friday to
Saturday to

The outdoor area is used for:

- Food service Hours: to
Alcohol service Hours: to
Enclosed, how

The exterior area is adequately viewed and/or supervised by Service Permittees.

(Investigator's Initials)

Seasonal Variations: Yes No If yes, explain:

ENTERTAINMENT

Check all that apply:

- Live Music Karaoke
Recorded Music Coin-operated Games
DJ Music Video Lottery Machines
Dancing Social Gaming
Nude Entertainers Pool Tables
Other:

DAYS & HOURS OF LIVE OR DJ MUSIC

Sunday to
Monday to
Tuesday to
Wednesday to
Thursday to
Friday to
Saturday to

SEATING COUNT

Restaurant: Outdoor:
Lounge: Other (explain): private events
Banquet: Total Seating: 300

OLCC USE ONLY
Investigator Verified Seating: (Y) (N)
Investigator Initials:
Date:

I understand if my answers are not true and complete, the OLCC may deny my license application.

Applicant Signature: Date: 5-8-18



OREGON LIQUOR CONTROL COMMISSION
CORPORATION QUESTIONNAIRE

1309 865-99

Please Print or Type

Corporation Name: Lulupearl, Inc Year Incorporated: 2017 ✓

Trade Name (dba): Artemis Foods

Business Location Address: 914 NW Everett St.

City: Portland ZIP Code: 97209

List Corporate Officers:

Lauren Carr

(name) Gail Carr

President

(title) Secretary

List Board of Directors:

William A Carr

(name) Gail Carr

Lauren Carr

List Stockholders: (Note: If any stockholder is another legal entity, that entity may also need to complete another Corporation Questionnaire. See Liquor License Application Guide for more information.)

Stockholders: Number of Shares Held:

William A Carr 100,000

Number of Stock Shares:

Issued: 0

Unissued: 100,000

Total Shares Authorized to Issue: 100,000

Server Education Designee: Lauren Carr DOB: 11/19/72
(See Liquor License Application Guide for more information)

I understand that if my answers are not true and complete, the OLCC may deny my license application.

Officer's Signature: [Signature] (name) president (title) Date: 5-8-18

CITY OF PORTLAND LIQUOR OUTLET INFORMATION FORM

PLEASE SUBMIT TO: Liquor Licensing Notification Program, 1221 SW 4th Avenue, Suite #110, Portland OR 97204

On New Outlet applications, property owners within 300 feet of the location, the Portland Police Bureau and all interested parties are notified by mail (with a copy of this form) and given an opportunity to comment on your application. The OLCC allows the City at least 45 days to complete the recommendation process. Submission of a complete operating plan can expedite the time required to process. A City liquor endorsement is not a confirmation that the property is properly zoned. Call (503) - 823-7526 to confirm that the property is properly zoned.

On submission of this form, you must also include the following:

- OLCC Liquor Application Form, initialed by your OLCC License Investigator
- OLCC Individual History Forms (all persons anticipated to have a financial interest, or key personnel are required)
- City Endorsement Fees

City Endorsement Fees are payable at the beginning of the application process (please make checks payable to City of Portland): New outlets are \$100.00, all others are \$75.00. All blank sections must be filled in. If the question does not apply, write "N/A" in the space.

LEGAL NAME OF BUSINESS: Lulupearl, Inc

DBA OR TRADE NAME: Artemis Foods PHONE: 503-233-8539 FAX: _____

BUSINESS ADDRESS (Including ZIP Code): 914 NW Everett St.

WHAT TYPE OF LIQUOR ARE YOU APPLYING FOR? (Change of owner, new outlet, beer & wine, etc.): New outlet

CONTACT PERSON: Lauren Carr PHONE: 503-233-8539 EMAIL: _____

DESCRIPTION OF OUTLET

TYPE OF OPERATION (CHECK ALL THAT APPLY)

- Food Cart Night Club
 Restaurant Sports Bar
 Convenience Store Other: Event Space

SIZE OF SERVICE AREA: 4,000 sqft.

EXISTING BUILDING: Yes No

ZONING: _____

STRUCTURAL CHANGES (DESCRIBE): NO

RESTAURANT SEATING CAPACITY: 300 LOUNGE SEATING CAPACITY: _____ OUTSIDE SEATING CAPACITY: _____

DESCRIBE SECURITY: Security cameras

HAS AN APPLICATION FOR A LIQUOR LICENSE AT THIS LOCATION BEEN RECEIVED BY THE CITY OF PORTLAND IN THE LAST TWO (2) YEARS?
 Yes No I Don't Know

HOURS OF OPERATION

SUNDAY - THURSDAY OPEN: 8am CLOSE: 10pm FRIDAY & SATURDAY OPEN: 8am CLOSE: 10pm

HOW LATE WILL THERE BE OUTSIDE SEATING? 10pm HOW LATE WILL THERE BE ENTERTAINMENT? 10pm

HISTORY OF LOCATION

PREVIOUS BUSINESS NAME OF THIS LOCATION: Bella Casa

NAME & ADDRESS OF PROPERTY OWNER: _____

ENTERTAINMENT

TYPE OF ENTERTAINMENT (CHECK ALL THAT APPLY)

- Dancing Video Poker Live Music Nude Dancers
 Karaoke Video Games/Pinball Recorded Music DJ Entertainment
 Pool Tables (How Many): _____ Events (Describe): Weddings, Social Dimmers Other: _____

The City requires an Amusement Location Permit for all locations with amusement devices or pool tables. Contact the Revenue Bureau for rules and an Amusement Location Permit application form now. Permits are non-transferable from one owner to another and must be paid before games are placed on the premises. Contact Anne Holm at 503-865-2488. The City of Portland will notify affected nearby neighbors and a copy of this form will be included in our mailing.

Use this area to provide any additional information that you wish to be considered on this liquor application

A false answer or omission of any requested information may result in an unfavorable City recommendation.

SIGNATURE: [Signature] DATE: 9/25/18

Property Search

Owner Name: HEART OF THE PEARL LLC %JA
 Site Address: 223-233 NW 9TH AVE
 State ID: 1N1E34CB 6200
 Account #: R140574

Search Clear PortlandMaps

Geocode Address When Taxlot Not
 Search is Based on Active Field Only
 Hide Personal Property Accounts
 Display Taxlot Detail Window

Navigate Query Re

| Owner | Site Address | State ID |
|---------------|--------------|----------|
| HEART OF T... | 223-233 N... | 1N1E34CB |

*SITE IS ZONED EXd -
 CENTRAL EMPLOYMENT.
 RETAIL SALES AND
 SERVICE IS ALLOWED
 BY RIGHT.*

*Tom G. Proctor
 CITY PLANNER I
 503.823.7919
 6/26/2018*

Bureau of Development Services
 1900 SW 4th Ave., Suite 5000
 Portland, OR 97201

Search Legend Add Data Selection

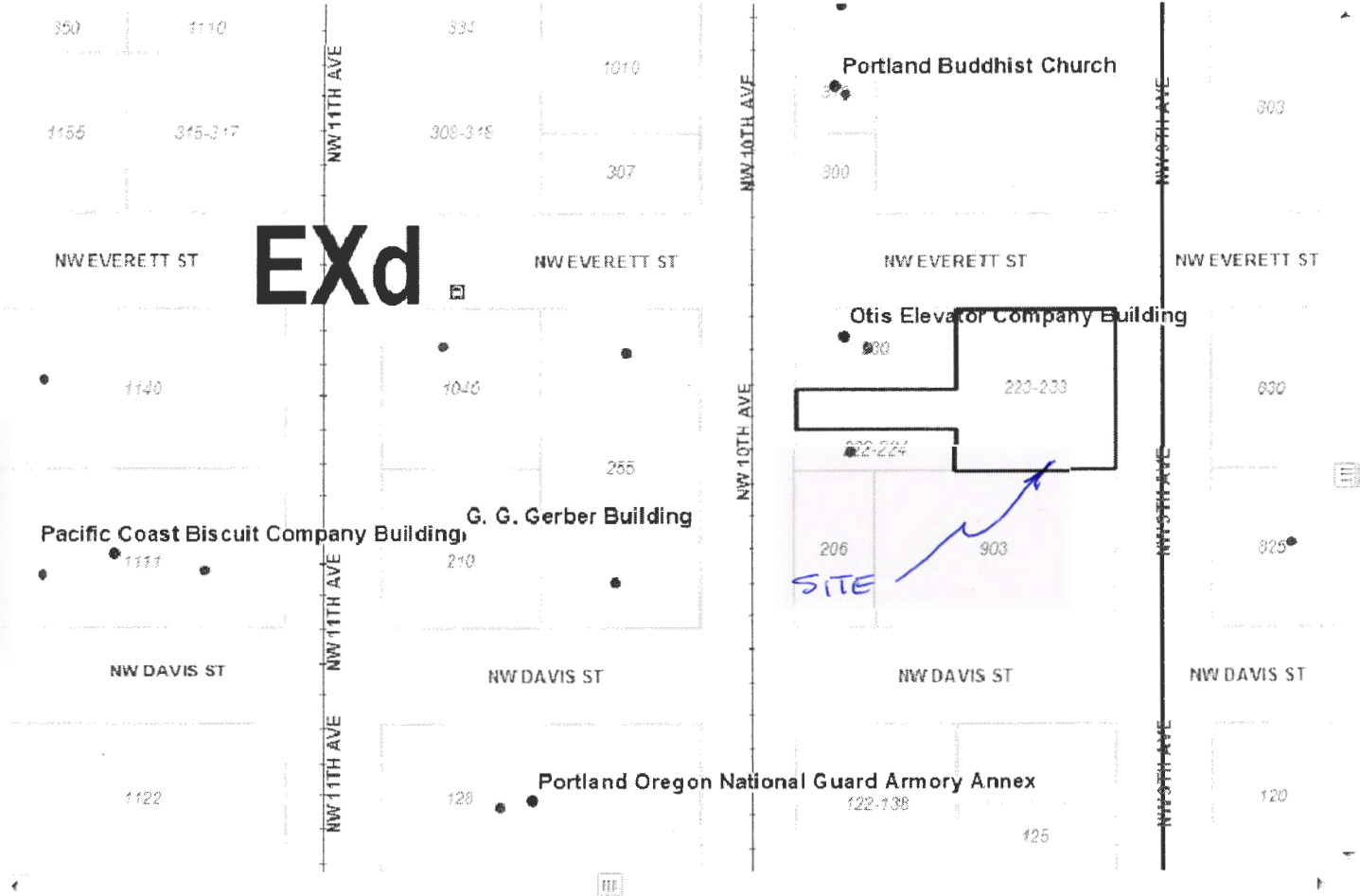

Taxlot Details

Lot Size: 12500 sqft Building Size: 10000 sqft Map Number: 3029 Zoning Code(s): EXd

Legal Description: COUCHS ADD, BLOCK 63, LOT 5&8, N 1/2 OF LOT 6 Lot & Block: 5&8,6 63

Map Number: 3029 Zoning Code(s): EXd

Plan District: Central City SubDistrict: RIVER DISTRICT SubArea:

Historic District: Conservation District: Jurisdiction: Portland NRMP:

LUR Case Histo (6 Cases): LU 02-132820 LU 02-142861 LU 10-145173 DZ LU 16-133961 DZ

Draw LURs LUR