



Gateway Green Design Workshop

December 12, 2017, 5:30-8:30pm

Meeting Summary/Notes

Meeting Outcomes/Goals

The purpose of this meeting was to engage the PAC and community in a creative work session with hands-on exercises to consider design ideas for improvements to Gateway Green. The goal of the meeting was to understand community perspectives, needs, and suggestions, and discuss ways to incorporate these ideas into a design for an improved park.

Participants

PAC Members: Evan C Burton, Anne Duston, Kathy Gillette, Kelley Goodwin, Ciela Heiles, Chelsea Hendriks, Arlene Kimura, Robert Alan Ping, Jeremy Robbins, Kate Walker, Jennifer Wilde

Technical Advisors: Scott Domine (PP&R), Mary Rose Navarro (Metro), Allan Schmidt (Metro), PPR Staff: Hailee Vandiver, Ross Swanson, Elizabeth Kennedy-Wong

Presenters: Ben Johnson, GreenWorks Paul Dickow, FOGG

Community: Ben Harrison, Regina Blake, Bika La (Youth Ambassador), Anisha Ghisig (Youth Ambassador), Khan Le (Youth Ambassador), Linda Robinson (FOGG)

Activity I: Reflections on the Place



- Impressions of Gateway Green- the space and place
 - How do you feel as you move through the site?
 - Noisy
 - Concerns about tagging, camping and lighting
 - What is special, unique, impressive about the character of the place?
 - The location presents a challenge, but also an opportunity



PORTLAND PARKS & RECREATION

Healthy Parks, Healthy Portland

- Cycling opportunity
- Inclusion of other government organizations in nearby locations
 - ODOT
 - Railway
 - PBOT
- What do you want to protect, highlight, resolve?
 - Natural habitat
 - Accessibility
 - ADA
 - Pedestrian
- Group Sharing
 - Pros
 - The size
 - Feels remote, but is in the city
 - Improvement since 2015
 - Gravel Road Spine
 - Great View from Highpoint
 - Great for mountain biking
 - Skills and pump track
 - Family and youth friendly once you are inside the park
 - Potential!
 - Running/walking trails
 - cyclocross
 - Cons
 - Needs signage
 - Gravel spine needs to be ADA accessible
 - Security
 - Parking
 - Access by foot is challenging
 - Sense of disruption between nature and highways
 - Noisy!
 - More shade needed
 - Grade change is challenging for ADA access
 - You can see the freeway
 - Needs more natural elements
 - Better drainage in jump areas
 - Fence locks potential hillside access
 - Lack of fast trails
 - Trail quality for bikes and pedestrians needs improvement
 - Neutral / Questions
 - Multiple recreation options
 - Family focused



- What is the best location for a bathroom?
- What entrance is the main entrance? Can there be multiple entrances?
- Will there be lighting?
- Service road is helpful but not for recreational purposes

Activity II: Design Exercise

- Entries & Gathering Spaces: the basic frame for the park
- Nature & Environment: restoration, planting, preservation
- Active Recreation: activities and features compatible with cycling focus

Table #1

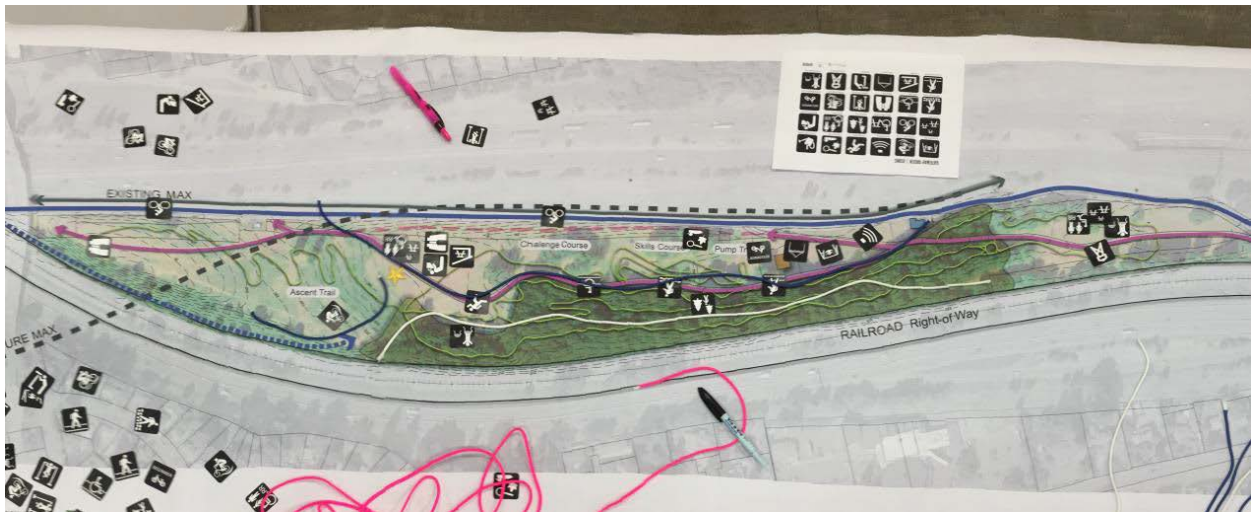

- Cluster uses: most event uses at the middle terrace
- Provide heavy native veg buffer along west edge of cluster
- Be aware of noise and which clusters will make/don't mind noise
- Main entry at loud/active event area
- Turn spine into a bike/ped trail along the tree line
- Move spine to East perimeter
- Quiet node at North end
- Restrooms at both main area and north end
- Focus on big moves but keep it simple

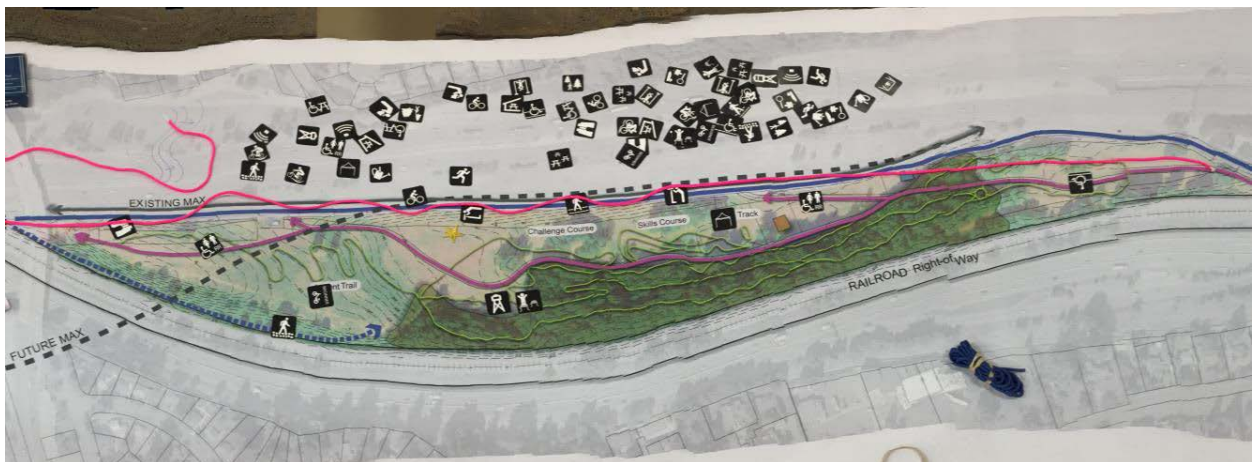

Table #2



- Move spine to east perimeter
- Make tree line trail multi-use path (can this be ADA? Hard Surface?)
- 3 Entries (bottom of the bowl, north end and THOP entry)
- Art or sculpture at high point to see from highway
- Bike tech station at main entry in the bowl
- Multiple Outward Bound locations of varying sizes
- Restrooms at each entry
- Loop walking/running path along the bench at West perimeter
- ADA parking and access at north end to low spot

Table #3



- ADA opportunity at South entry
- Include switchbacks on the north end for ADA access



- Include side door entries along I-205 Path
- Consider lighting

Common Themes

- Outward Bound at North: include discovery moments throughout park
- Main spine along West perimeter
- Explore ADA path from North
- Multi-Use path replaces current main spine
- Consider user groups and noise
- Separate path uses
- One main gateway at middle (either lower in the bowl or at the second terrace)
- Multiple restrooms ideal: located at main gateway and entries
- Looped trail for running
- Create a sequential experience
- Cluster family oriented areas
- Iconic moment at South high point
- Keep it simple but think of growing population and needs

Wrap-up and Evaluation

- Define technical terms and acronyms
- Use less jargon