

ODOT PERMIT # \_\_\_\_\_

OWNER: <b>PGE (Oregon City LCC)</b>	PROJECT/JOB NUMBER: <b>M2633348</b>
PROJECT NUMBER/LOCATION: <b>3034 SE Tacoma St</b>	CITY/STATE: <b>Portland, OR</b>
PRIME CONTRACTOR: <b>PGE</b>	
CONTACT NAME/NUMBER: <b>Mohammed Felemban/503-718-5693</b>	EMAIL: <b>mohammed.felemban@pgn.com</b>
PREPARED BY: <b>C Borden</b>	TRAFFIC CONTROL CONTRACTOR : <b>Potelco Inc.</b>



Tail closure should be limited to weekdays between 9:00 AM - 4:00 PM, and the dates and hours of closure should be posted on the signs.

Vehicles will park on the asphalt trail; detour provided 2nd page of TCP;

Detour provided on SE Sherret Street



Place sign at trail entrance located on SE Johnson Creek Blvd.

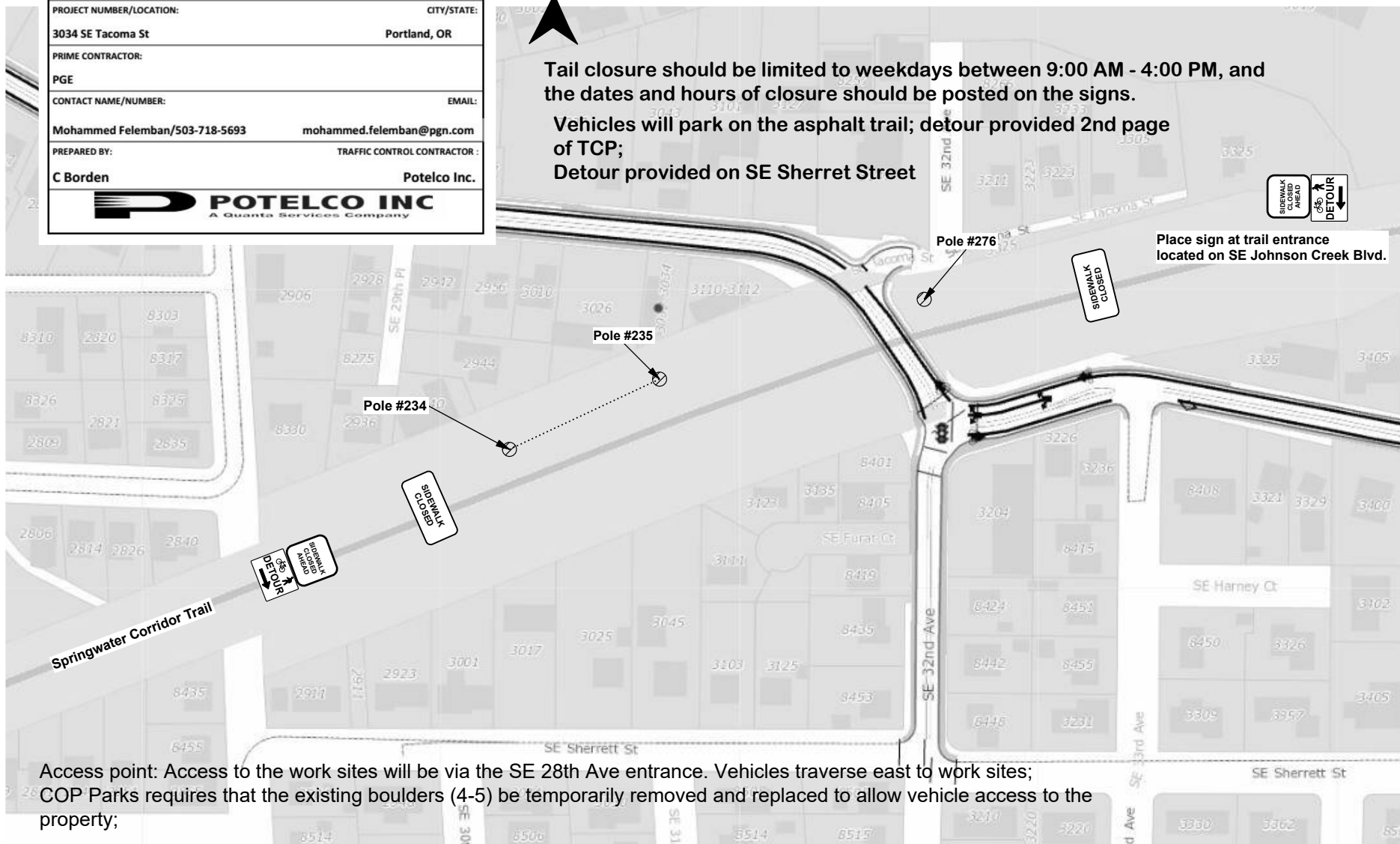

Access point: Access to the work sites will be via the SE 28th Ave entrance. Vehicles traverse east to work sites; COP Parks requires that the existing boulders (4-5) be temporarily removed and replaced to allow vehicle access to the property;

All signs and devices SHALL conform to the MUTCD/OTTC and PBOT Traffic Manual.  
Will adjust to fit field conditions as needed for safety.  
Plan not to scale.

Vehicles will park on the asphalt trail; detour provided 2nd page of TCP;  
 Detour provided on SE Sherret Street.

Tail closure should be limited to weekdays between 9:00 AM - 4:00 PM,  
 and the dates and hours of closure should be posted on the signs.



ODOT PERMIT # _____	
OWNER: <b>PGE (Oregon City LCC)</b>	PROJECT/JOB NUMBER: <b>M2633348</b>
PROJECT NUMBER/LOCATION: <b>3034 SE Tacoma St</b>	CITY/STATE: <b>Portland, OR</b>
PRIME CONTRACTOR: <b>PGE</b>	
CONTACT NAME/NUMBER: <b>Mohammed Felemban/503-718-5693</b>	EMAIL: <b>mohammed.felemban@pgn.com</b>
PREPARED BY: <b>C Borden</b>	TRAFFIC CONTROL CONTRACTOR : <b>Potelco Inc.</b>
 <b>POTELCO INC</b> <small>A Quanta Services Company</small>	

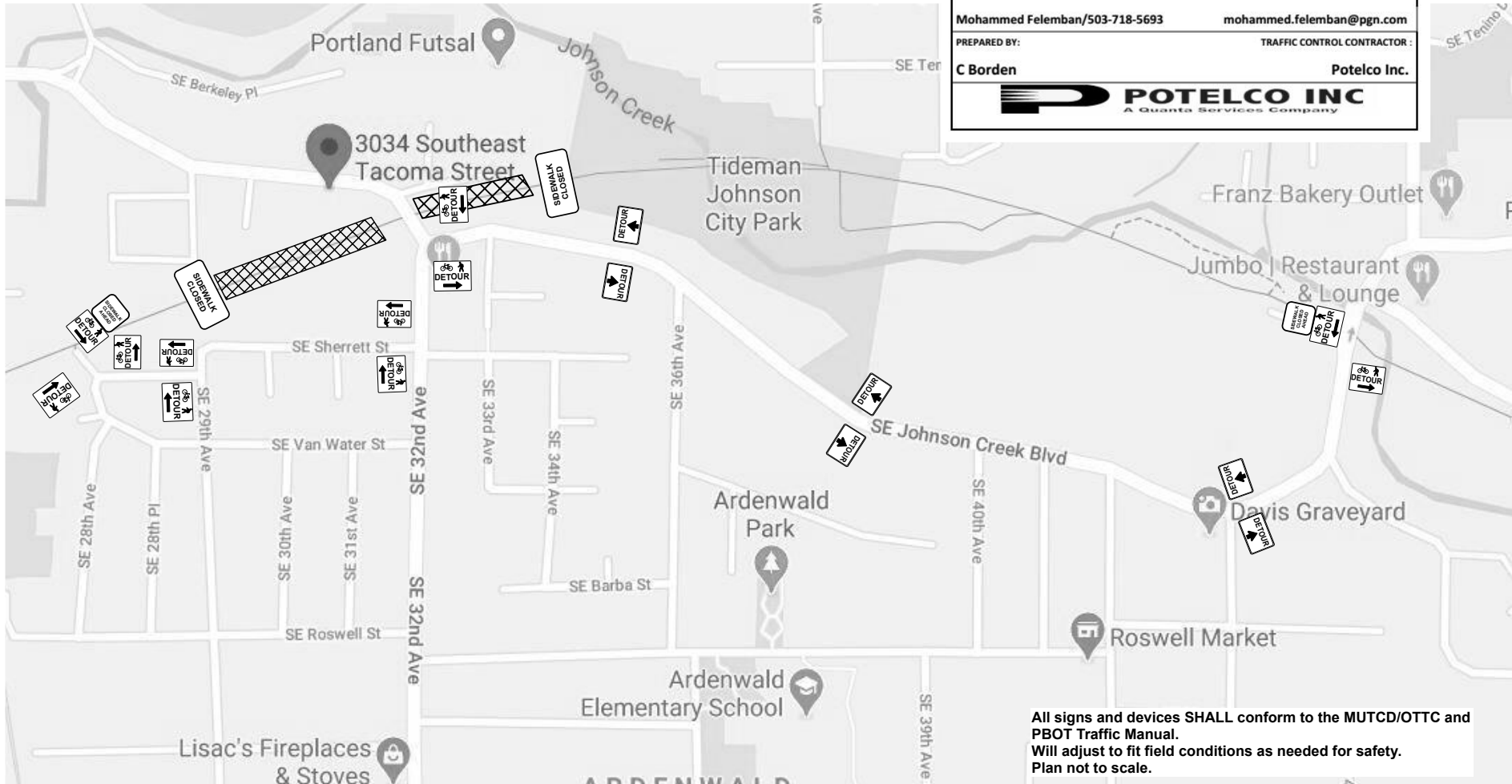

All signs and devices SHALL conform to the MUTCD/OTTC and PBOT Traffic Manual.  
 Will adjust to fit field conditions as needed for safety.  
 Plan not to scale.