



Burnside and Couch from NW 10th Avenue west to I-405.

CENTRAL WEST BURNSIDE AND COUCH

8TH TO 16TH AVENUE

On Burnside from the North Park Blocks to West 16th Avenue, wider sidewalks, curb extensions, on-street parking and traffic signals at every intersection will provide improved access and a more balanced transportation system. Couch, while experiencing more vehicular traffic, will gain curb extensions, twin ornamental street lights, street trees and traffic signals at every intersection.

RECOMMENDATIONS

The design refinements include the following elements:

- Convert Burnside to two lanes, one-way eastbound with:
 - Traffic signals at every intersection beginning at West 8th Avenue
 - Add full time on-street parking on both sides of street
 - Rebuild sidewalks, expanded to 12 feet
 - Curb extensions at all intersection
 - Install new street trees and ornamental street lights
 - Widen sidewalks on the I-405 bridge
- Grind and overlay Burnside Street pavement section
- Convert Couch to two one-way westbound lanes with:
 - Traffic signals at every intersection
 - Preserve on-street parking, existing sidewalks and healthy existing street trees
 - Widen sidewalks on the I-405 bridge
 - Curb extensions at all intersections
 - Rebuild Couch Street pavement section
- Enhance the pedestrian crossings at W 8th and W Park on Burnside
- Close Oak Street between Burnside and SW 10th Avenue
- Stripe angled parking on the north side of SW Oak Street between SW 9th and SW 10th Avenues
- Transition westbound Couch traffic to Burnside at 15th Avenue
- Rebuild SW 16th Avenue to align with NW 16th Avenue
- Preserve Couch right-of-way between NW 15th and NW 16th for pedestrian and bicycle access
- Create gateway feature opportunities at 15th and Burnside
- Use sustainable practices in street and pedestrian area design including stormwater management, porous paving and street tree species diversity

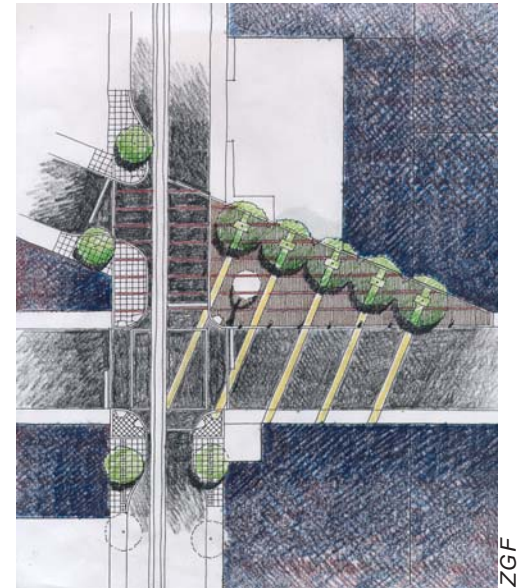

The project enables the removal of the existing "jughandle" at 10th, Burnside and Oak. Development of a small plaza provides a foreground to Powell's City of Books, an enhanced bus stop and better viewing of the existing public sculpture.

TYPICAL DETAILS - CENTRAL WEST BURNSIDE

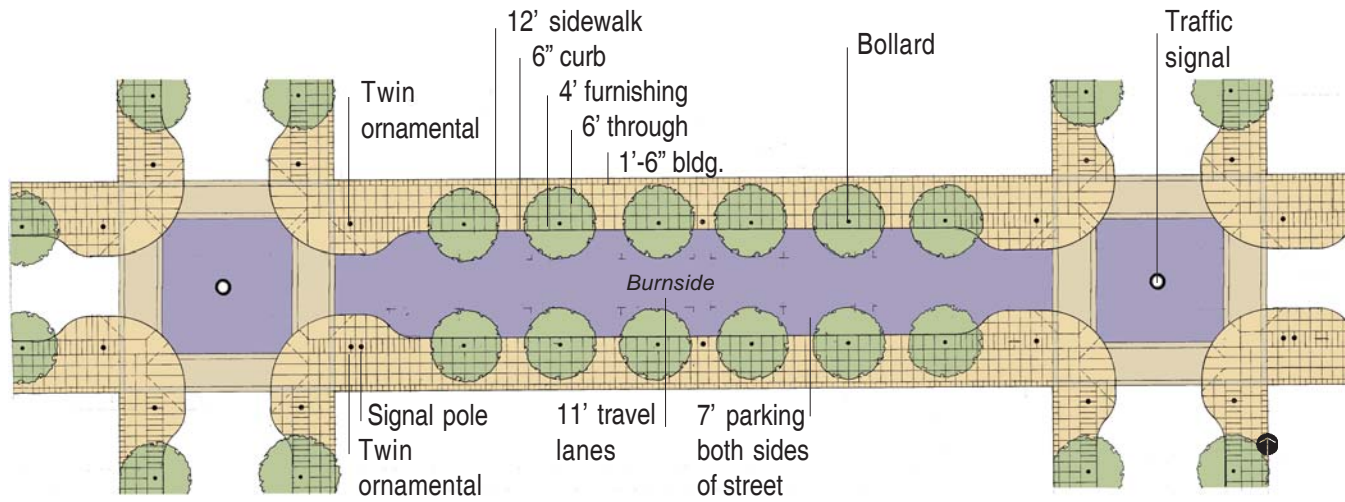

Typical West Burnside from West Park Avenue to West 14th Avenue

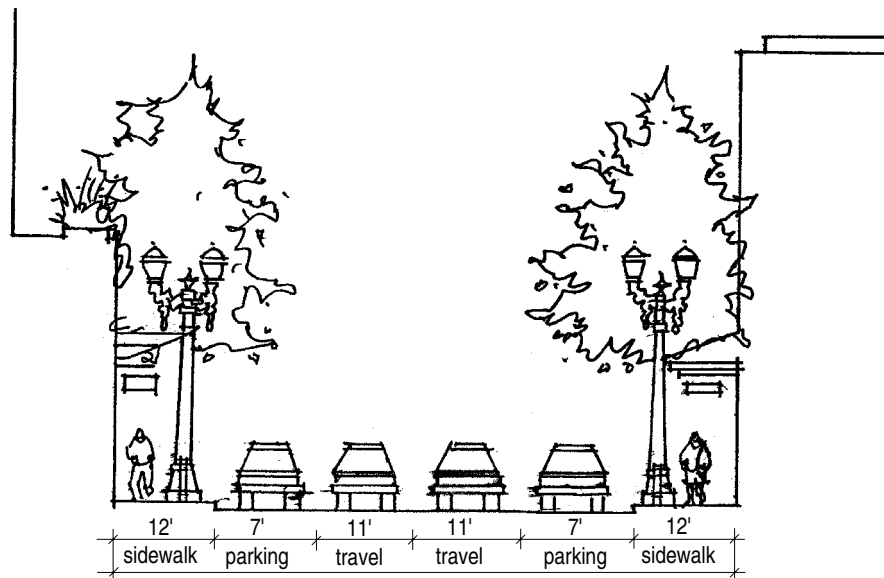

Typical West Burnside from West 8th to 14th Avenue looking west.

TYPICAL DETAILS - CENTRAL WEST COUCH

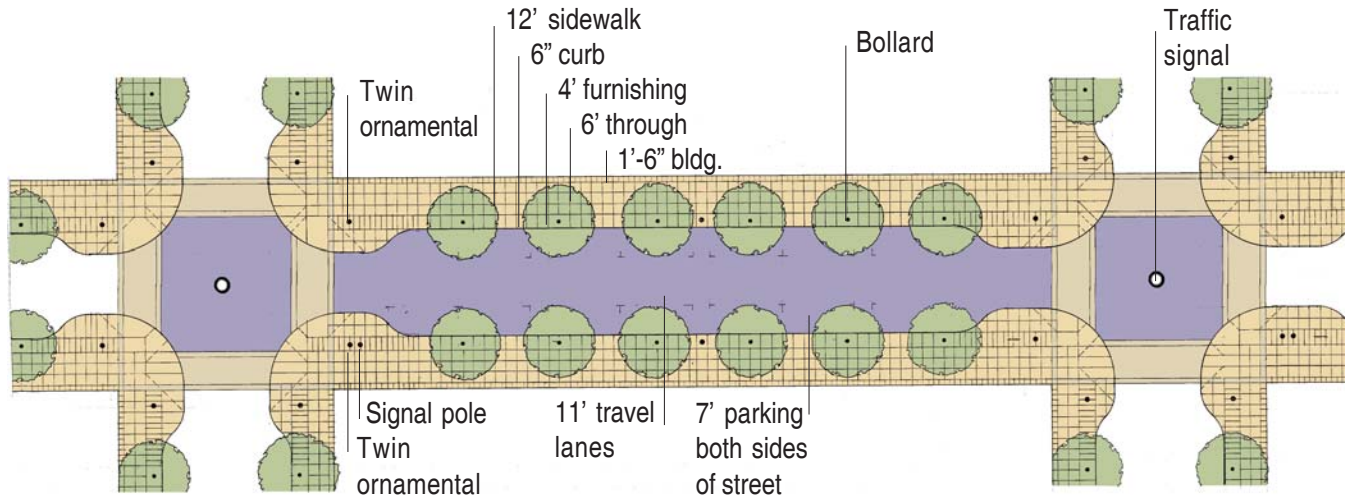

Typical West Couch plan from NW Park to 14th Avenue

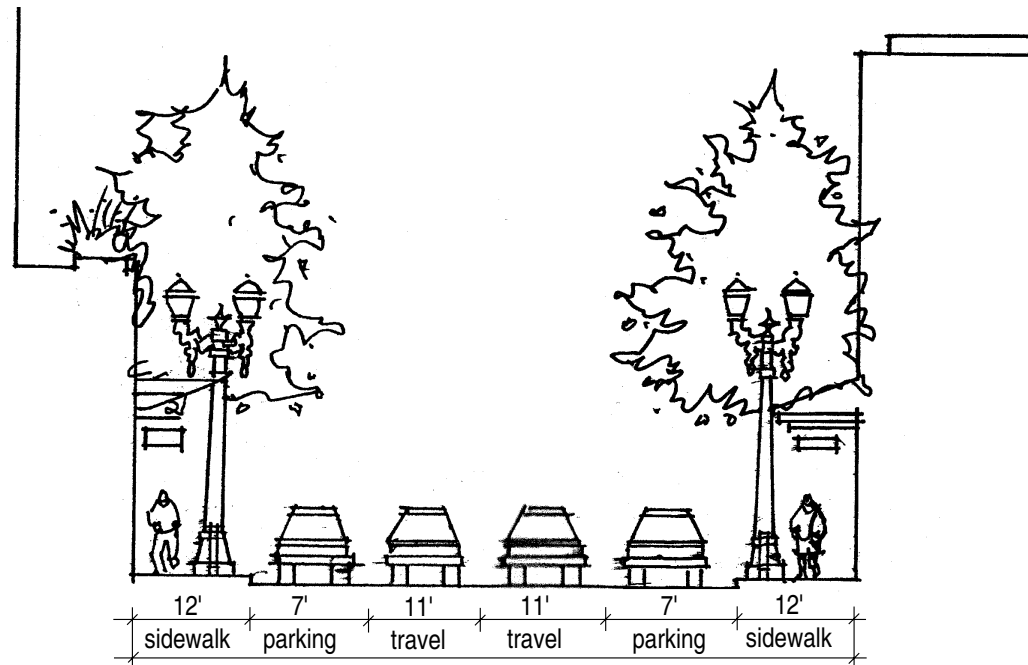

Typical NW Couch section from NW Park to 14th Avenue looking west.

BURNSIDE AND COUCH AT I-405

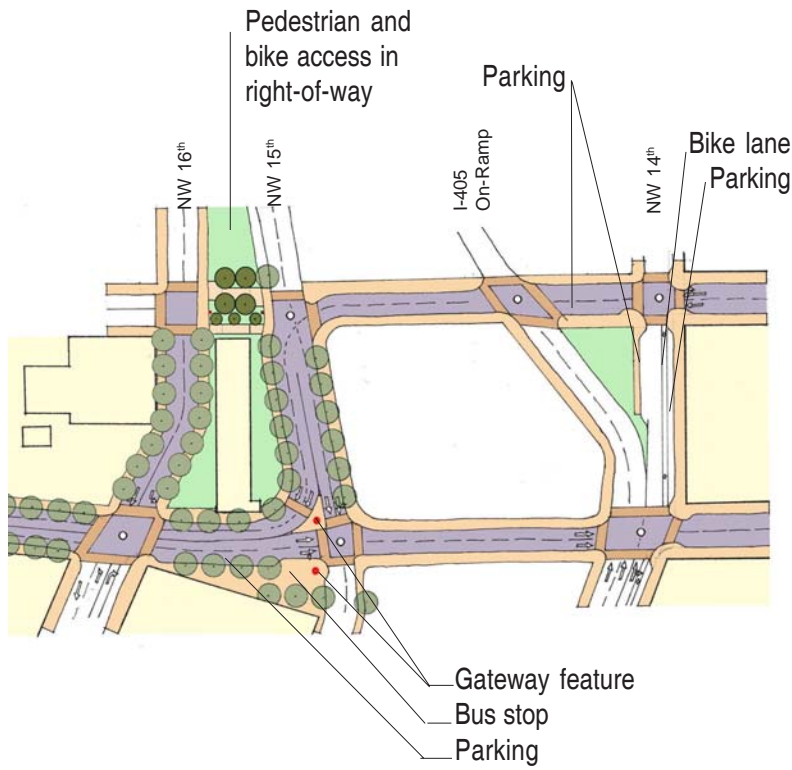

Burnside and Couch between 14th and 16th Avenues plan showing a gateway feature and bus stop at SW 15th Avenue.

PARK BLOCKS CROSSING

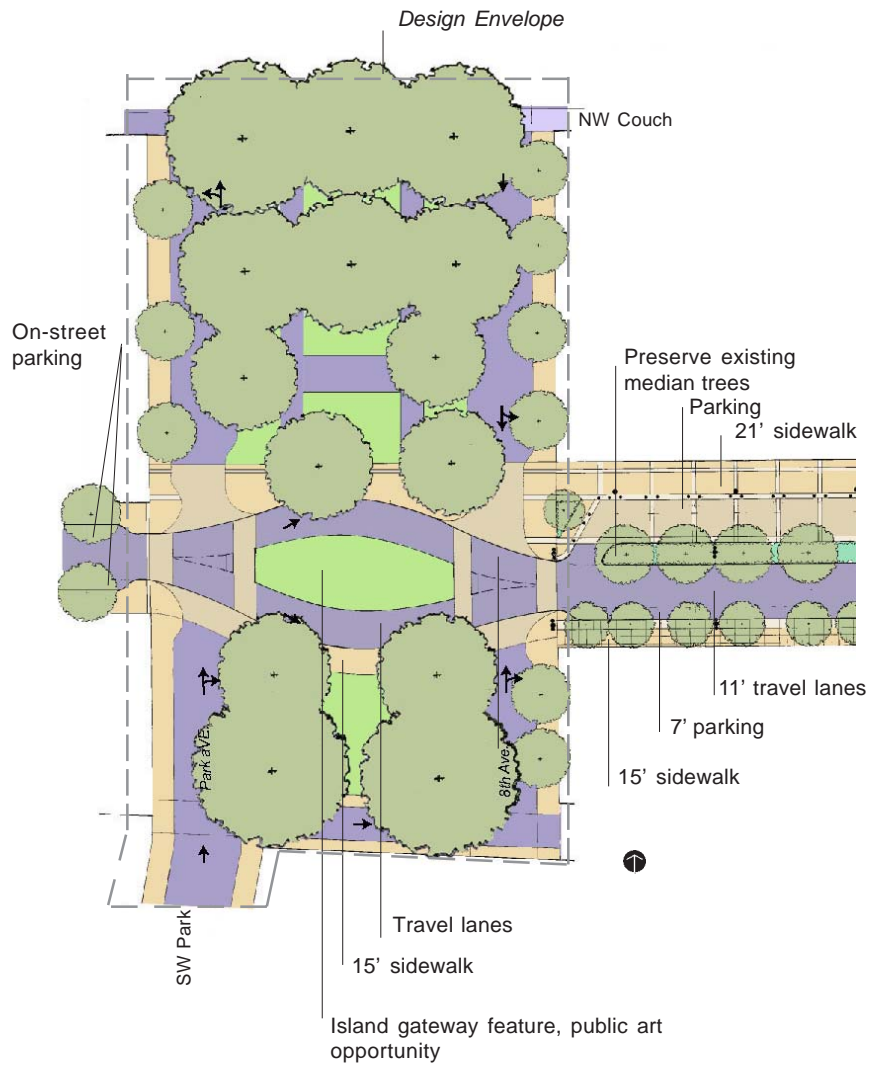

Park Blocks crossing at Burnside showing park and open space between Ankeny, Park and 8th Avenues.

STREET DESIGN STANDARDS TABLE
CENTRAL WEST BURNSIDE AND COUCH

STREET SECTION	Right-of-Way	Curb-to-Curb	Travel lanes width/quantity	Bike lane	Parking	Curb	Sidewalk	Furnishing Zone	Through Zone	Building frontage zone	Tree Well
Burnside W 8 th to Park	100	24	12/2	0	0	.5	15/15	5	8	1.5	5 ¹
Burnside Park to W 14 th	60	36	11/2	0	7	.5	12/12	4	6	1.5	4x6
Burnside W 14 th to W 15 th	*	*	11/2	0	0	.5	12	4	6	1.5	0
Couch NW 8 th to Park	60	22	11/2	0	0	.5	12	4	6	1.5	0
Couch NW Park to NW 14 th	60	36	11/2	0	7	.5	12	4	6	1.5	4x6
Couch NW 14 th to NW 15 th	*	*	11/2	0	0	.5	12	4	6	1.5	0
W 14 th Burnside to Couch	60	36 ²	11/2	0	7	.5	12	4	6	1.5	4 ¹
W 15 th Burnside to Couch	72	48	12/4	0	0	.5	12	4	6	1.5	4 ¹
W 16 th Burnside to Couch	60	36	11/2	0	7	.5	12	4	6	1.5	4 ²

Refer to sections and plan for configuration

Footnotes

- ¹ Continuous planting strip
- ² Combined PDOT and ODOT right-of-way
- * I-405 bridge

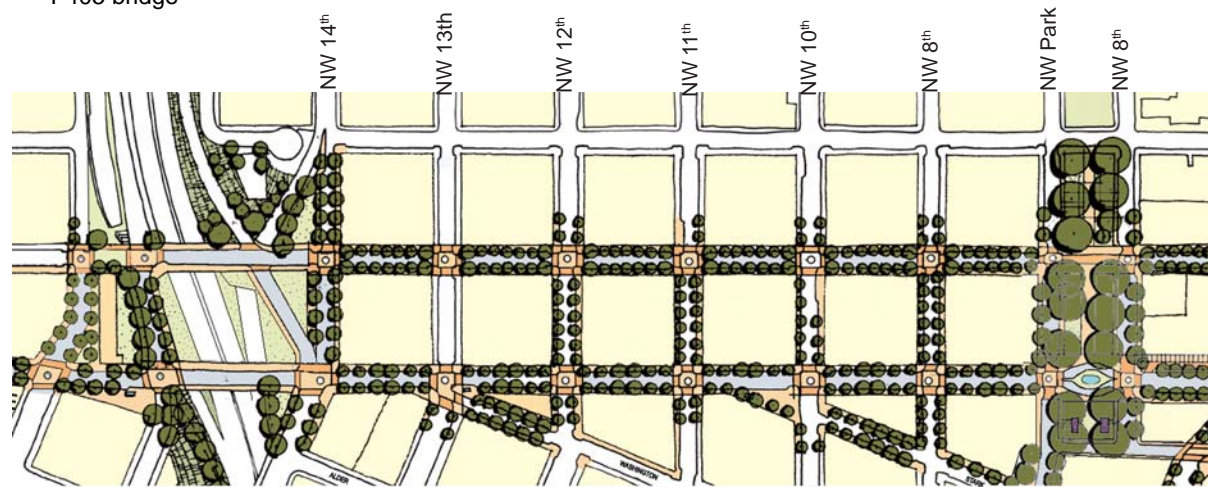

CENTRAL WEST BURNSIDE AND COUCH