

Plot Date: 2/4/2015 10:18:50 AM File Name: S:_il\Design\100338 - 20's Bikeway, Harney-Lombard SE NE\CAD\PLAN-SHEETS\SH T S-09 PERMANENT SIGNING AND STRIPING PLAN\LOT_SHT_S-09.dgn

2ND UTILITY NOTIFICATION
30% DESIGN

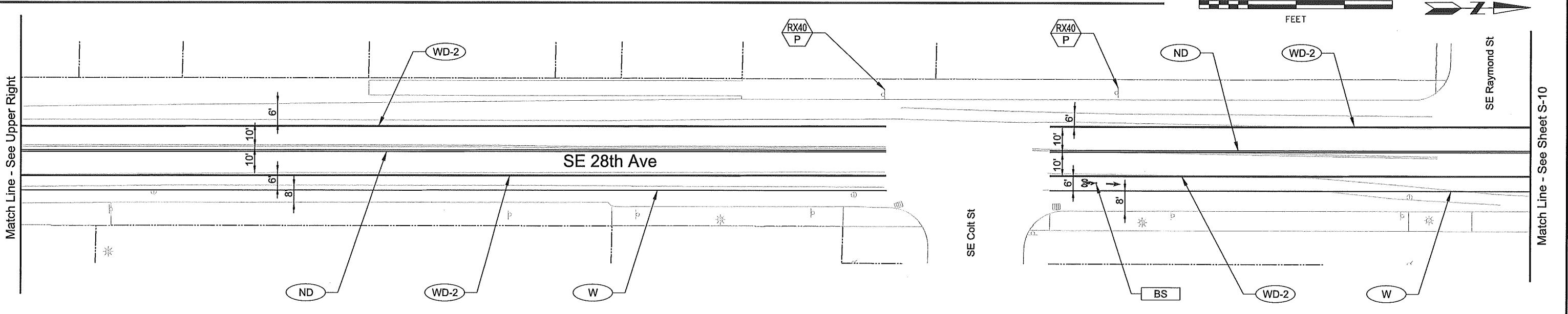
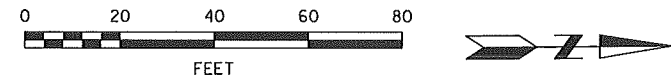
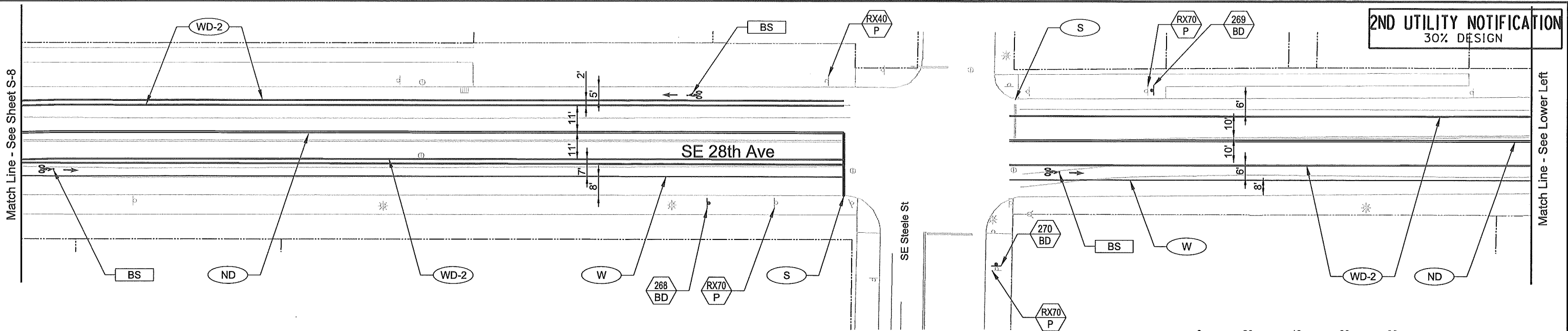

- Signing Notes:**
- 1) Refer to traffic sign bubble shown on sht S-xx.
 - 4) Refer top traffic sign number legend shown on sht S-xx.
 - 3) Refer to signing standard drawings P-400 through P-420.
 - 4) Coordinate with TriMet to relocate bus stop signs. Contact xxxx xxxxxx at Tri-Met 503-962-xxxx.

- Striping Notes:**
- 1) Remove all conflicting striping and pavement markings.
 - 2) Refer to detail blocks on pavement markings TM500 thru TM503 (ODOT) and P-434 thru P-435 (City).
 - 3) All longitudinal line work to be non-profile, 120 mil, extruded thermoplastic.
 - 4) All transverse line work to be Type "A" thermoplastic
 - 5) All legend, symbols and arrows to be 120 mil Type "B-HS" thermoplastic except for bike lane stencils and sharrows which shall be 90 mils.
 - 6) Refer to Std Dwg P-440 for speed bump detail.
 - 7) Repair/replace crosswalk/stop bars if damaged or removed with curb construction. Use detail block CW (or CW-SC) on Std Drg TM503 (ODOT).
 - 8) Refer to speed bump drawing. See Std Drg P-440.

NO.	DATE	DESCRIPTION	APPD.

DESIGNED BY A. Sullivan	DATE APPROVED XXX. 2015
CAD BY P. Ferreira	PROJECT NO. T00338
CHECKED BY L. Wardrip	1/4 SECTION -
PROJECT NUMBER X-STP-5900 (xxx)	

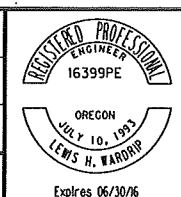

APPROVALS:

SUPERVISING ENGINEER	REG. PROF. ENGR. NO. 16399PE
CITY ENGINEER	REG. PROF. ENGR. NO. 51538PE

CITY OF PORTLAND
BUREAU OF TRANSPORTATION

STEVE NOVICK
STEVE TOWNSEN, P.E.

COMMISSIONER
CITY ENGINEER



Twenties Bikeway: NE Lombard - SE Crystal Springs

MULTNOMAH COUNTY

Permanent Signing & Striping Plan

SHEET NO. **S-9**

Plot Date: 2/4/2015 I:\08150 AM FileNames: S:_I.Design\T00338 - 20's Bikeway-Horney-Lombard_SE_NE\CAD\PLAN_SHEETS\SHT_S-10 PERMANENT SIGNING AND STRIPING PLAN\LOT_SHT_S-10.dgn

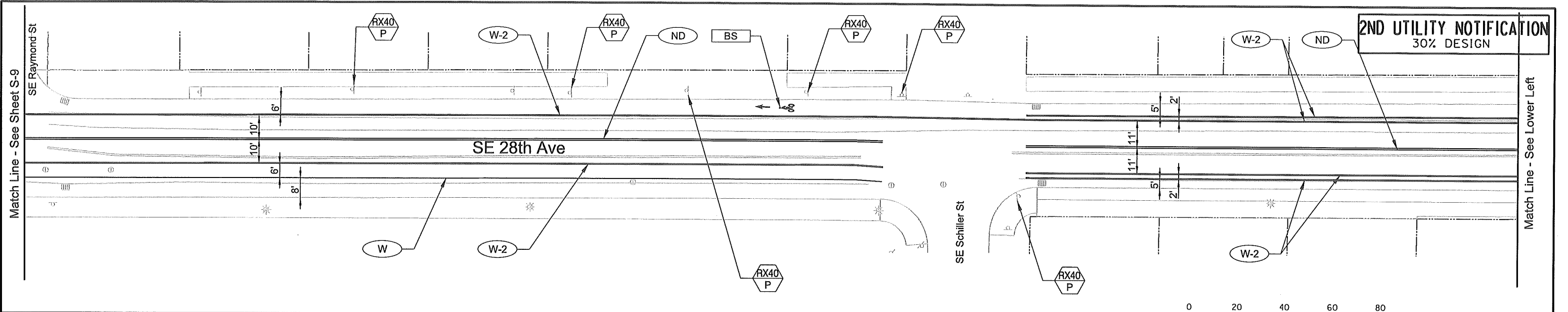

2ND UTILITY NOTIFICATION
30% DESIGN

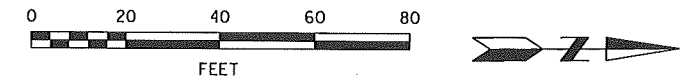
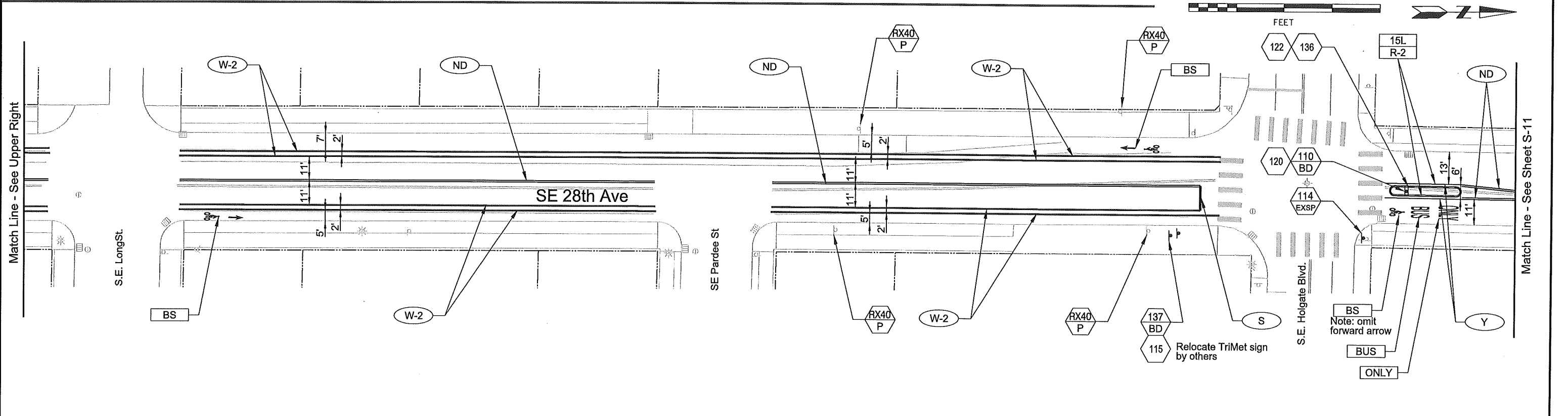

Signing Notes:

- 1) Refer to traffic sign bubble shown on sht S-xx.
- 4) Refer top traffic sign number legend shown on sht S-xx.
- 3) Refer to signing standard drawings P-400 through P-420.
- 4) Coordinate with TriMet to relocate bus stop signs. Contact xxxx xxxxxx at Tri-Met 503-962-xxxx.



Striping Notes:

- 1) Remove all conflicting striping and pavement markings.
- 2) Refer to detail blocks on pavement markings TM500 thru TM503 (ODOT) and P-434 thru P-435 (City).
- 3) All longitudinal line work to be non-profile, 120 mil, extruded thermoplastic.
- 4) All transverse line work to be Type "A" thermoplastic
- 5) All legend, symbols and arrows to be 120 mil Type "B-HS" thermoplastic except for bike lane stencils and sharrows which shall be 90 mils.
- 6) Refer to Std Dwg P-440 for speed bump detail.
- 7) Repair/replace crosswalk/stop bars if damaged or removed with curb construction. Use detail block CW (or CW-SC) on Std Drg TM503 (ODOT).
- 8) Refer to speed bump drawing. See Std Drg P-440.

NO.	DATE	DESCRIPTION	APPRO.
		REVISION	

DESIGNED BY A. Sullivan	DATE APPROVED XXX, 2015
CAD BY P. Ferreira	PROJECT NO. T00338
CHECKED BY L. Wardrip	1/4 SECTION
PROJECT NUMBER X-STP-5900 (xxx)	

APPROVALS:

SUPERVISING ENGINEER	REG. PROF. ENGR. NO. 16399PE
CITY ENGINEER	REG. PROF. ENGR. NO. 51538PE

CITY OF PORTLAND BUREAU OF TRANSPORTATION

STEVE NOVICK
STEVE TOWNSEN, P.E.

COMMISSIONER
CITY ENGINEER



Twenties Bikeway: NE Lombard - SE Crystal Springs
MULTNOMAH COUNTY
Permanent Signing & Striping Plan SHEET NO. **S-10**

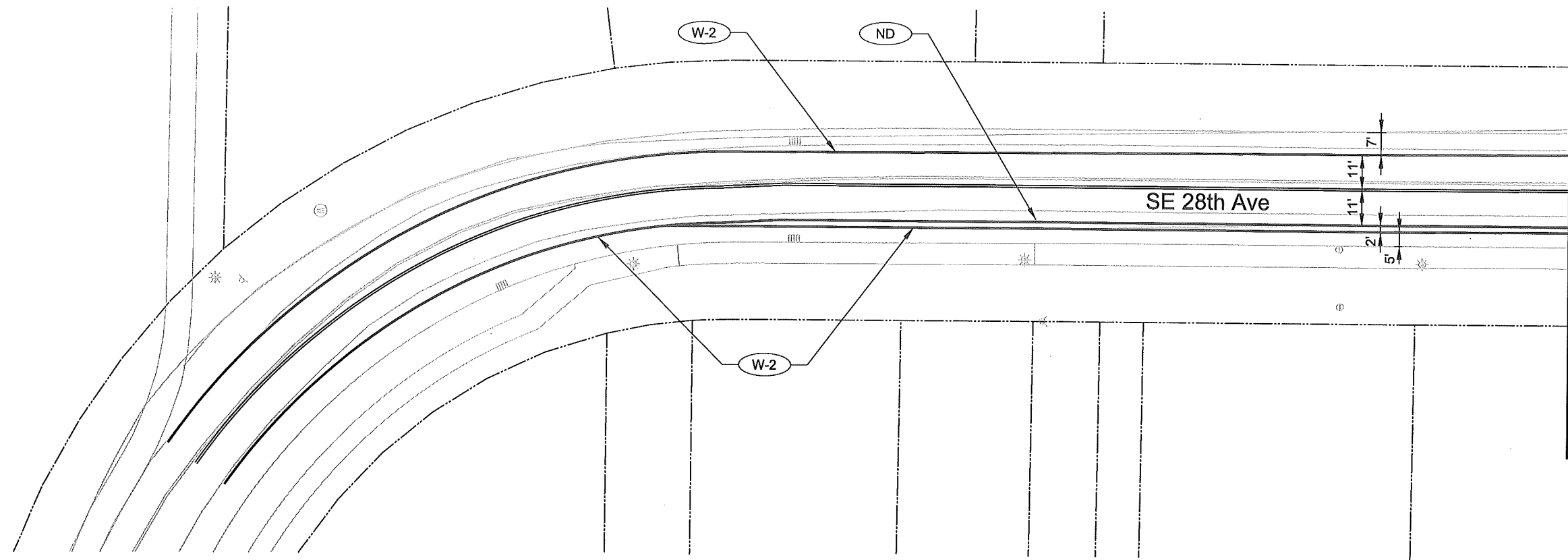

Match Line - See Lower Left

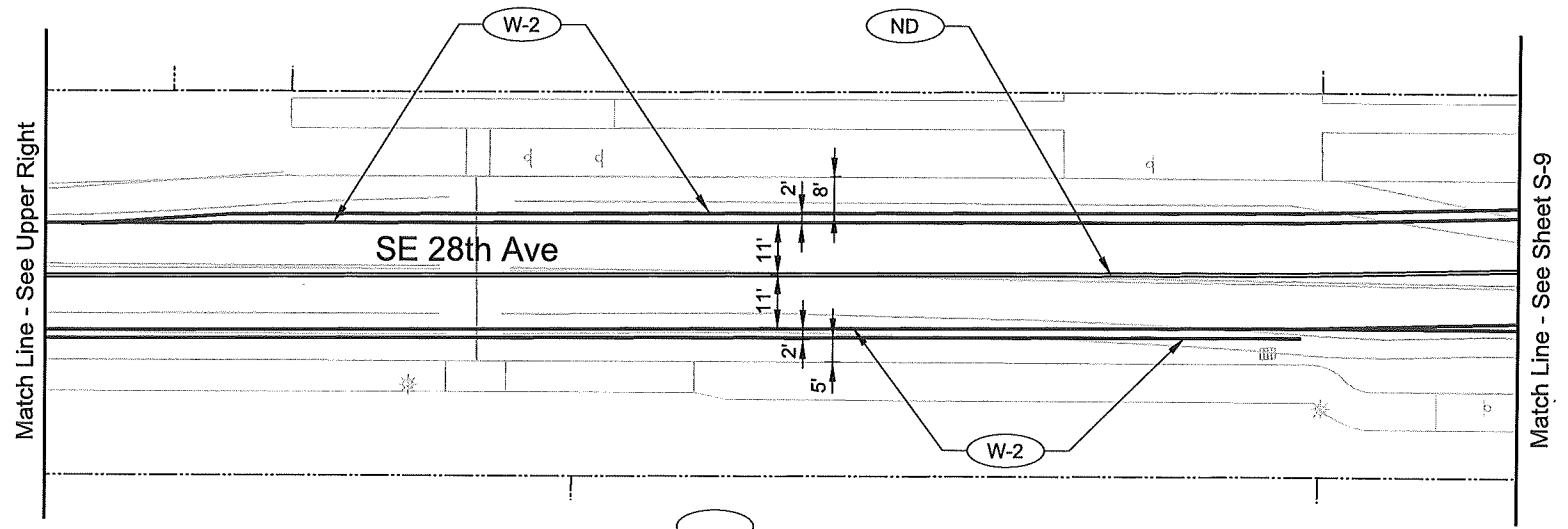
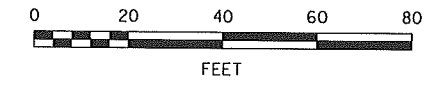

Match Line - See Upper Right

Match Line - See Sheet S-9



Signing Notes:

- 1) Refer to traffic sign bubble shown on sht S-xx.
- 4) Refer top traffic sign number legend shown on sht S-xx.
- 3) Refer to signing standard drawings P-400 through P-420.
- 4) Coordinate with TriMet to relocate bus stop signs. Contact xxxx xxxxxx at Tri-Met 503-962-xxxx.



Striping Notes:

- 1) Remove all conflicting striping and pavement markings.
- 2) Refer to detail blocks on pavement markings TM500 thru TM503 (ODOT) and P-434 thru P-435 (City).
- 3) All longitudinal line work to be non-profile, 120 mil, extruded thermoplastic.
- 4) All transverse line work to be Type "A" thermoplastic
- 5) All legend, symbols and arrows to be 120 mil Type "B-HS" thermoplastic except for bike lane stencils and sharrows which shall be 90 mils.
- 6) Refer to Std Dwg P-440 for speed bump detail.
- 7) Repair/replace crosswalk/stop bars if damaged or removed with curb construction. Use detail block CW (or CW-SC) on Std Drg TM503 (ODOT).
- 8) Refer to speed bump drawing. See Std Drg P-440.

NO.	DATE	DESCRIPTION	APPD.

DESIGNED BY A. Sullivan	DATE APPROVED XXX, 2015
CAD BY P. Ferreira	PROJECT NO. T00338
CHECKED BY L. Wardrip	1/4 SECTION
PROJECT NUMBER X-STP-5900 (xxxx)	

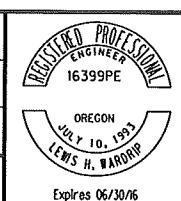

APPROVALS:	
SUPERVISING ENGINEER	REG. PROF. ENGR. NO. 16399PE
CITY ENGINEER	REG. PROF. ENGR. NO. 51538PE

CITY OF PORTLAND
BUREAU OF TRANSPORTATION

STEVE NOVICK
STEVE TOWNSEN, P.E.

COMMISSIONER
CITY ENGINEER



Twenties Bikeway: NE Lombard - SE Crystal Springs

MULTNOMAH COUNTY

Permanent Signing & Striping Plan

SHEET NO. S-8

Plot Date: 2/4/2015 10:48:49 AM Filename: S:_il_Design\T00338 - 20's Bikeway, Horney-Lombard SE \CAD\PLAN_SHEETS\SHT S-08 PERMANENT SIGNING AND STRIPING PLAN\LOT_SHT_S-08.dgn